

LT1A CONSTRUCTION AREAS LEGEND

KEY:-

Footway Construction (Combination of)

Marshalls 600 x 900 x 50 thick and 600 x 600 x 50 thick Conserved Smooth Ground Concrete paving silver grey in colour on 30mm proprietary mortar bedding on 150mm Type 1 GSB and 250mm thick type B1, B2, B4 OR B5.

Bluminox Cycle Lane Construction

20mm AC6 dense surf 70/100p (To be light grey in colour)
50mm AC20 dense bin 70/100p
150mm granular sub base (Type 1)
Note: Where the cycleway is adjacent to the carriageway the sub base is to be replaced with 150mm thick lean mix concrete, if the CBRs are less than 5% or 75mm if the CBRs are more than 5%.

Bluminox Carriageway Construction

40mm HRA 30/14F Surface Course 40/60 With 20mm Precast Chippings.
60mm AC20 Dense HDM 40/60 Binder Course 40/60 to BS EN 13108-1
200mm AC32 Dense HDM Base 40/60 to BS EN13108-1
150mm Type 1 Granular material subbase to clause B03 of The Specification for Highway Works.
600mm Type B2 Capping (Thickness of Capping to be confirmed after results of CBR's obtained at Formation level) with 2.0m long x 75mm upstand ramps constructed in granite sett paving.

Bluminox Carriageway Construction

40mm AC10 Close Surf 40/60 to BS EN13108-1 PSV 55+ Max AN14.
60mm AC20 Dense HDM Binder Course 40/60 Bin 40/60 to BS EN13108-1
200mm AC32 Dense HDM Base Course to BS EN13108-1
150mm Type 1 Granular material subbase to clause B03 of The Specification for Highway Works.
600mm Type B1 or B2 (Site won) or B4 or B5 (Imported) Capping (Thickness of Capping to be confirmed after results of CBR's obtained at Formation level)

Bluminox Footway Construction

20mm AC6 dense surf 70/100 to BS EN13108-1
50mm AC20 dense bin 70/100 to BS EN13108-1
150mm lean mix concrete.
150mm Type 1 GSB beneath the lean mix if the CBRs are less than 5% or 75mm if the CBRs are more than 5%.

Areas of Soft Landscaping Construction

Details of proposed landscaping as per Landscape Architects drawings.

Areas of Hard Landscaping Construction

Details of proposed landscaping as per Landscape Architects drawings.

Proposed Overrun Area

150mm x 150mm granite sett laid on 25mm mortar bedding on 150mm thick Class E concrete foundation laid on 150mm thick Type 1 sub base and 600mm thick Type B2 capping. Over run strip delineated from carriageway by 145 x 145 Marshalls textured kerbing laid flush.

Proposed Porous Paving

100mm x 200mm x 80mm thick permeable paving sett laid on 50mm grit bedding on 500mm thick Occourse graded aggregate laid on an impervious membrane layer laid on 600mm Type B1 or B2 (Site won) or B4 or B5 (Imported) Capping (Thickness of Capping to be confirmed after results of CBR's obtained at Formation level)

Proposed Concrete Footway

2.6m wide footway.
300mm thick C14 concrete with 1 layer A252 mesh with 2no. box / T-section carbon steel rails.

Proposed Tactile Paving

400 x 400 x 50 thick tactile paving, buff in colour. Dropped kerbing to be provided at all pedestrian crossing points with tactile paving.

Phase 1A Construction Boundary

RODNEY HOUSE ROUNDABOUT CONSTRUCTION AREAS LEGEND

KEY

Proposed Paving Type 8. For details refer to Oxfordshire County Council standard detail drawing no.HSD/1100/100

Ribbed Corduroy Tactile Blocks

DK Proposed dropped kerb arrangement at pedestrian crossings to be constructed using Dropkerb Type K10 and Flush Kerb Type K13. For details refer to Oxfordshire County Council standard detail drawing no.HSD/1100/185 and HSD/1100/192.

Proposed illuminated bollard. For details see drawing no. 0308

Proposed carriageway construction. For details see drawing no's 0304, 0308

Proposed footway construction. For details see drawing no's 0304, 0308

Proposed soft verge construction. For details see drawing no 0304

Proposed pedestrian deterrent surfacing. For details see drawing no. 0304

Proposed pedestrian guardrail Type1. For details refer to Oxfordshire County Council standard detail drawing no.HSD/300/475, 0308

Proposed kerb Type K1b. For details refer to Oxfordshire County Council standard detail drawing no.HSD/1100/141, 0308

Proposed F1 kerb. For details refer to Oxfordshire County Council standard detail drawing no. HSD/1100/030, 0308

Proposed Beany Blocks. For details see drawing no. 0308

Existing Highway Boundary

Notes:

- Do not scale from this drawing
- All dimensions are in meters unless specified otherwise.
- For carriageway construction details see drawing number 0304.
- For Footway construction details see drawing number 0304.
- For details of carriageway road markings and signing see drawing number 0306.
- All street furniture to have minimum clearance of 450mm from carriageway channel.
- For proposed traffic signals details see drawing no's 0310, 0311 and 0313
- For proposed CCTV details see drawing no.0312

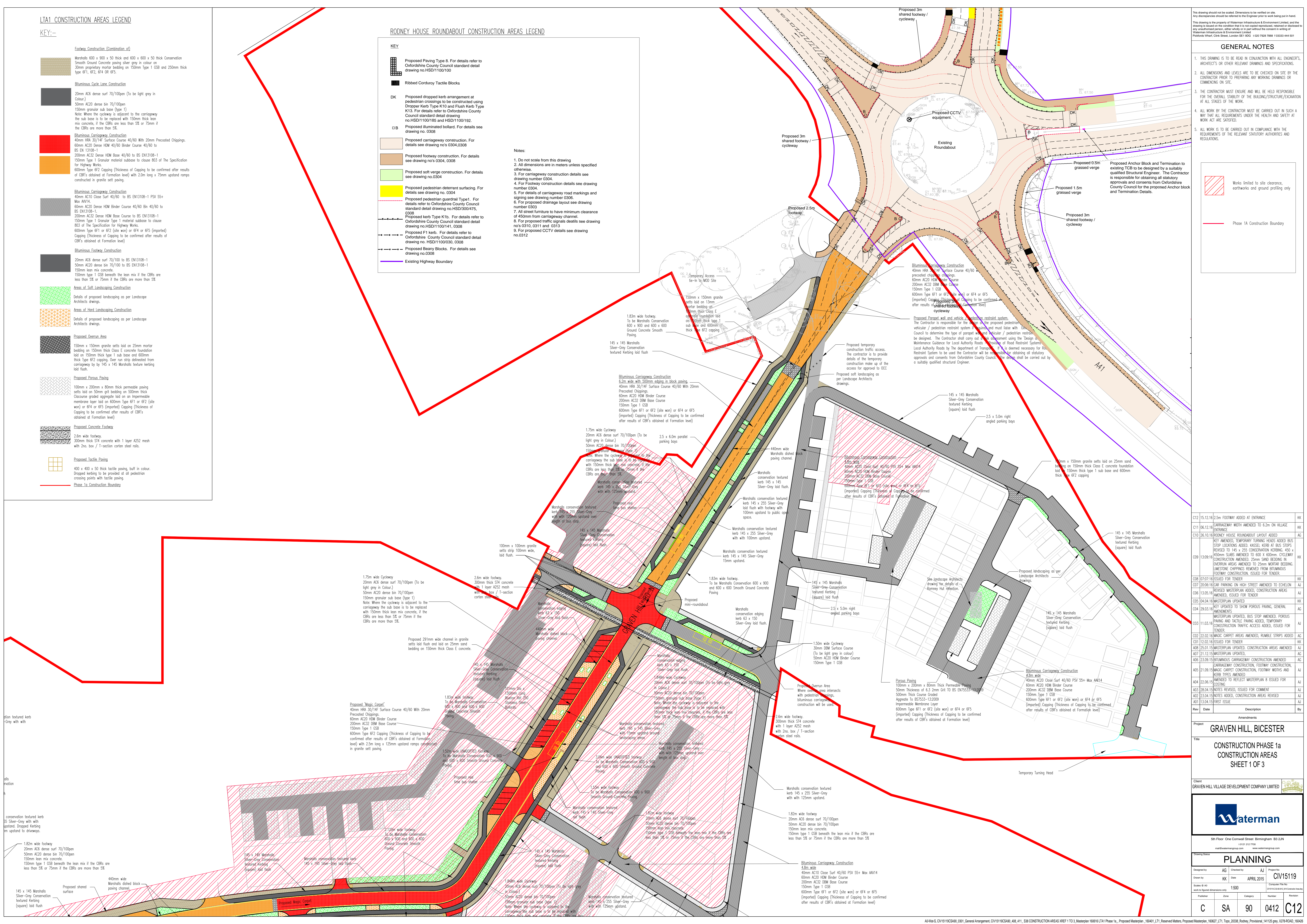

This drawing should not be scaled. Dimensions to be verified on site. Any discrepancies should be referred to the Engineer prior to work being put in hand.

This drawing is the property of Waterman Infrastructure & Environment Limited, and the drawing is issued on the condition that it is not copied, reproduced, related or disclosed in any unauthorized person, either wholly or in part without the consent in writing of Waterman Infrastructure & Environment Limited.

Pickfords Wharf, Clark Street, London SE1 9GG | 020 7928 7888 | 03333 444 501

GENERAL NOTES

- THIS DRAWING IS TO BE READ IN CONJUNCTION WITH ALL ENGINEERS, ARCHITECTS OR OTHER RELEVANT DRAWINGS AND SPECIFICATIONS.
- ALL DIMENSIONS AND LEVELS ARE TO BE CHECKED ON SITE BY THE CONTRACTOR PRIOR TO PREPARING ANY WORKING DRAWINGS OR COMMENCING ON SITE.
- THE CONTRACTOR MUST ENSURE AND WILL BE HELD RESPONSIBLE FOR THE OVERALL STABILITY OF THE BUILDING/STRUCTURE/EXCAVATION AT ALL STAGES OF THE WORK.
- ALL WORK BY THE CONTRACTOR MUST BE CARRIED OUT IN SUCH A WAY THAT ALL REQUIREMENTS UNDER THE HEALTH AND SAFETY AT WORK ACT ARE SATISFIED.
- ALL WORK IS TO BE CARRIED OUT IN COMPLIANCE WITH THE REQUIREMENTS OF THE RELEVANT STATUTORY AUTHORITIES AND REGULATIONS.

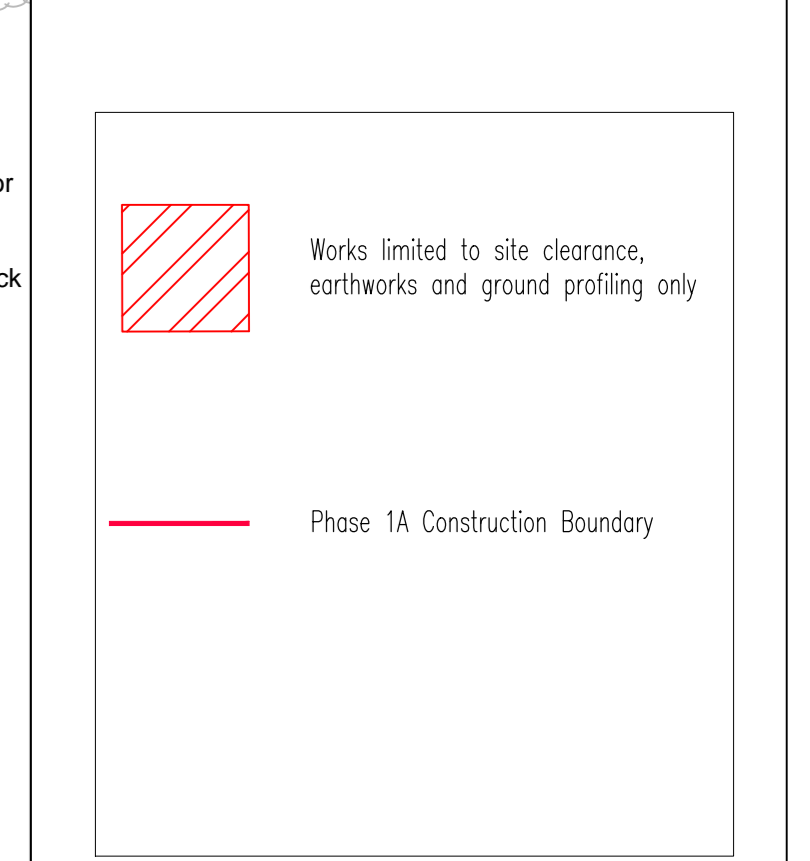

Rev	Date	Description	By
C12	15.12.16	2.5m FOOTWAY ADDED AT ENTRANCE	KX
C11	06.12.16	CARRIAGEWAY WIDTH AMENDED TO 6.2m ON VILLAGE ENTRANCE	KX
C10	26.10.16	RODNEY HOUSE ROUNDABOUT LAYOUT ADDED	AG
C09	13.09.16	KEY AMENDED, TEMPORARY TURNING HEADS ADDED BUS STOP LOCATIONS ADDED, KERBEL KERS AT BUS STOPS REVERSED TO 145 x 255 CONSERVATION KERBELS, 450 x 450mm SLABS AMENDED TO 600 x 600mm, CYCLEWAY CONSTRUCTION AMENDED, 25mm SAND BEDDING IN OVERRUN AREAS AMENDED TO 25mm MORTAR BEDDING, LIMESTONE CHIPPINGS REMOVED FROM STUNNED FOOTWAY CONSTRUCTION, ISSUED FOR TENDER.	KX
C08	07.07.16	ISSUED FOR TENDER	KX
C07	20.06.16	CAR PARKING ON HIGH STREET AMENDED TO ECHELON	AJ
C06	13.05.16	REVERSED WATERSTOP ADDED, CONSTRUCTION AREAS AMENDED, ISSUED FOR TENDER	AJ
C05	04.04.16	MASTERPLAN UPDATED	KX
C04	29.03.16	KEY UPDATED TO SHOW POROUS PAVING, GENERAL AMENDMENTS	AG
C03	11.03.16	MASTERPLAN UPDATED, BUS STOP AMENDED, POROUS PAVING AND TACTILE PAVING ADDED, TEMPORARY CONSTRUCTION TRAFFIC ACCESS ADDED, ISSUED FOR TENDER.	AJ
C02	22.02.16	MAGIC CARPET AREAS AMENDED, RUMBLE STRIPS ADDED	KX
C01	12.02.16	ISSUED FOR TENDER	KX
A08	25.01.15	MASTERPLAN UPDATED, CONSTRUCTION AREAS AMENDED	AJ
A07	21.12.15	MASTERPLAN UPDATED	AG
A06	23.09.15	BLUMINOX CARRIAGEWAY CONSTRUCTION AMENDED	AG
A05	21.09.15	CARRIAGEWAY CONSTRUCTION, FOOTWAY CONSTRUCTION, MAGIC CARPET CONSTRUCTION, FOOTWAY WIDTHS AND KERS TYPES AMENDED	AJ
A04	22.06.15	AMENDED TO REFLECT MASTERPLAN 8 ISSUED FOR CONSULTING	AJ
A03	28.04.15	NOTES REVISED, ISSUED FOR COMMENT	AJ
A02	23.04.15	NOTES ADDED, CONSTRUCTION AREAS REVISED	AJ
A01	13.04.15	FIRST ISSUE	AJ

Project: **GRAVEN HILL, BICESTER**

Title: **CONSTRUCTION PHASE 1a
CONSTRUCTION AREAS
SHEET 1 OF 3**

Client: **GRAVEN HILL VILLAGE DEVELOPMENT COMPANY LIMITED**

5th Floor One Cornhill Street, Birmingham, B3 2JN
0121 212 7790
info@watermangroup.com | www.watermangroup.com

Drawing Status: **PLANNING**

Designed by: **AG** Checked by: **AJ** Project Ref: **CIV15119**

Drawing Title: **KK** Date: **APRIL 2015** Company Ref: **CIV15119**

Scale: @ A3
week 10 (approximate) only 1:500

Author: **C** Zone: **SA** Category: **90** Number: **0412** Revision: **C12**