

**1. TIMBER SWING**  
Russell Play  
00-2 Cattle Seals Timber Swing  
or similar approved



**2. CLIMBING SET**  
Russell Play  
17-1 Bird Climbing Frame  
or similar approved



**3. BALANCING TIMBER EQUIPMENT**  
Russell Play  
H11 Hungry Caterpillar  
or similar approved



**4. THEMATIC SWING**  
name: Gardener's playground:  
Gardener's swing  
order number: 50725200R  
material:R: Robinia/oak glazed

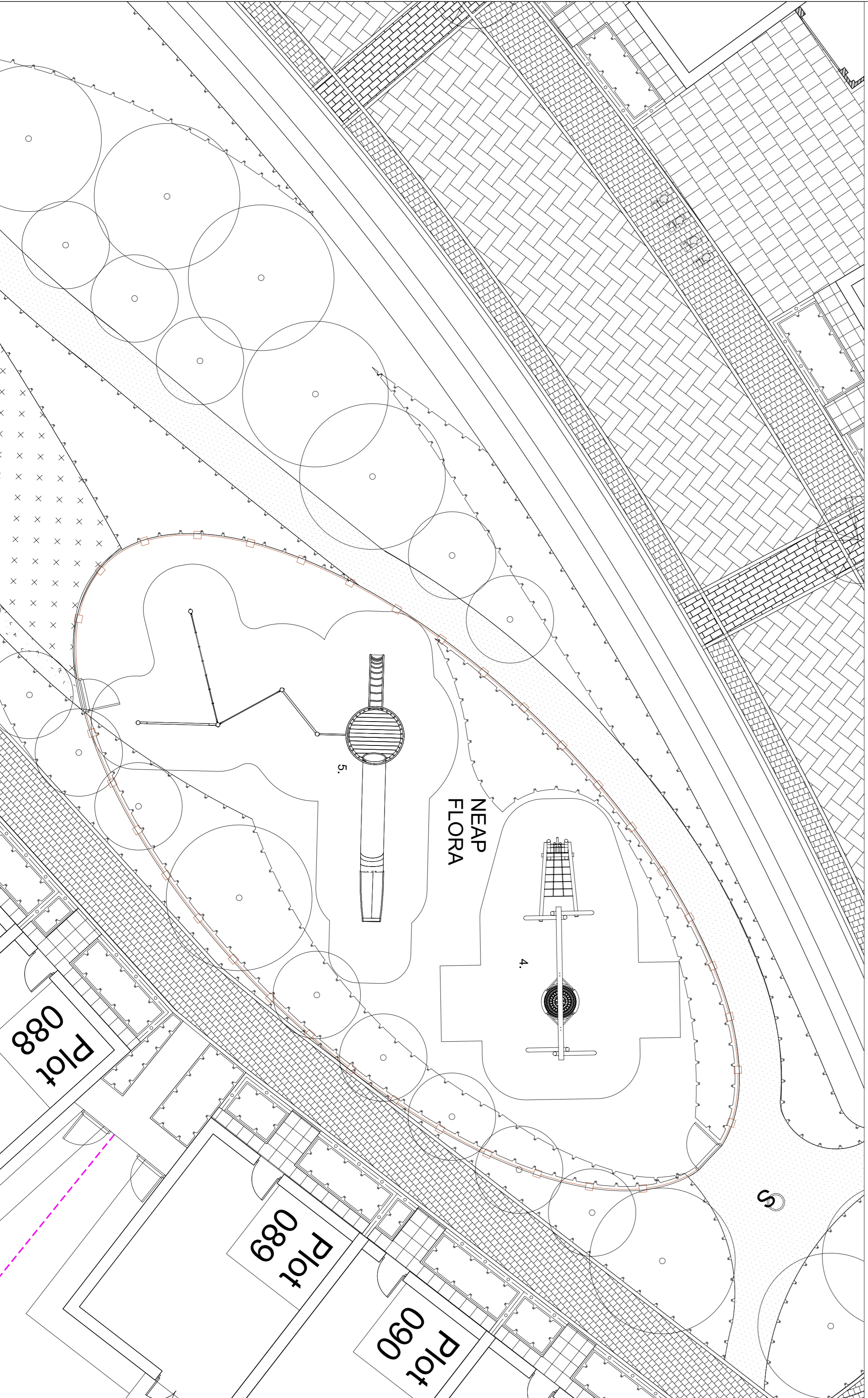

**4. THEMATIC CLIMBING SYSTEM WITH SLIDE**  
name: Gardener's playground: Sunflower climbing  
system order number: 50725250R  
material: R: Robinia/oak glazed

**NOTES**

- The contractor is responsible for checking dimensions, tolerances and references. Any discrepancy to be verified with the Architect before proceeding with the work.
- Where an item is covered by drawings to different scales the larger scale drawing is to be worked to.
- Do not scale drawing. Figure dimensions to be worked to in all cases.

**CDM Regulations 2015**

All current drawings and specifications for the project must be read in conjunction with the Designer's Hazard and Environmental Assessment Record.



date	rev	revision/author/checker
purpose of Issue <b>PLANNING</b>		
project <b>Bicester Phases 3&amp;4</b>		
drawing <b>Natural Play NEAP</b>		
drawing no <b>AL56995/2131</b>	rev	
drawn <b>KJ</b>	checked <b>AGF</b>	
scale @ A1 1:100	date <b>30.09.2015</b>	
PFP Architects © 10 Old London Street London EC1A 9NR T +44 (0)20 7953 1200 F +44 (0)20 7953 1201 info@pfparchitects.co.uk		