

NOTES:

All drawings to be read in conjunction with reference key & CISH notes drawing: AA2699C/4.1/295

Refer to dwgs AA2699C/ 4.1/ 099 - 019 for **Block Plan Setting Out**

Refer to elevation dwgs AA2699C/ 4.1/ 200 - 233 for **window schedule**

Refer to Door Schedule spread sheet for **internal door information**

Refer to dwgs
AA2699C/ 6.1/ 001 for **Ext Wall Types**
AA2699C/ 6.1/ 005 for **House Party Wall Types**
AA2699C/ 6.1/ 018 for **Flat Party Wall Types**
AA2699C/ 6.1/ 019 for **Int Wall Types**
AA2699C/ 6.1/ 017 - 024 for **Ext Wall Section Details**
AA2699C/ 6.1/ 020 - 024 for **Sub floor Details**
AA2699C/ 6.1/ 030 - 047 for **Type 1 Details**
AA2699C/ 6.1/ 050 - 067 for **Type 3 Details**
AA2699C/ 6.1/ 070 - 078 for **Type 7 Details**
AA2699C/ 6.1/ 090 - 097 for **Type 8 Details**

Refer to dwgs
AA2699C/ 9.1/ 001 - 026 for **Bathroom Layouts**

AA2699C/ 7.1/ 001 - 013 for **Staircase Details**

Refer to A2Dominion Finishes Specification for **finishes**

All dims to structure unless otherwise stated. For overall finish dims, refer to wall types and wall type dwgs above (6.1 series)

All movement joints TBC by SE

Where indicated, RWP's to be located 327.5mm (one and a half bricks) from edge of building, or on party wall line, unless otherwise dimensioned

		REVIEWED	
		PRELIMINARY	STATUS
	FOR COMMENT	A	
	FOR CONSTRUCTION	B	
SIGNED		C	
DATE			

notes

- The contractor is responsible for checking dimensions, tolerances and references. Any discrepancy to be verified with the Architect before proceeding with the works.
- Where an item is covered by drawings to different scales the larger scale drawing is to be worked to.
- Do not scale drawing. Figured dimensions to be worked to in all cases.

CDM Regulations 2007
ALL current drawings and specifications for the project must be read in conjunction with the Designer's Hazard and Environmental Assessment Record.

Notes:
For elevations please refer to drawing AA2699C/4.1/217

All drawings to be read in conjunction with reference key & CISH notes drawing: AA2699C/4.1/295

REFERENCE KEY - (Plots 343-348)

ELEVATION TYPE	1	2	3	4	5	6	7	8
PRINCIPLE WALL MATERIALS	BERKSTONE	RENDER	TIMBER	BRICK				
PRINCIPLE ROOF MATERIAL	SLATE	BERKSTONE	OTHER					
TENURE	PRIVATE	S.O.	RENTAL					
VENTILATION STRATEGY	MEV	MVHR						
WINDOW TRICKLE VENTS	YES	NO						
FUTURE LOFT ADAPTATION	YES	NO						
ROOF FORM	LINEAR	GABLE	FLAT					
PV TYPE	INTEGRATED	IN-LAY PANEL	SURFACE FIX					

REFERENCE KEY - (Plots 349-354)

ELEVATION TYPE	1	2	3	4	5	6	7	8
PRINCIPLE WALL MATERIALS	BERKSTONE	RENDER	TIMBER	BRICK				
PRINCIPLE ROOF MATERIAL	SLATE	BERKSTONE	OTHER					
TENURE	PRIVATE	S.O.	RENTAL					
VENTILATION STRATEGY	MEV	MVHR						
WINDOW TRICKLE VENTS	YES	NO						
FUTURE LOFT ADAPTATION	YES	NO						
ROOF FORM	LINEAR	GABLE	FLAT					
PV TYPE	INTEGRATED	IN-LAY PANEL	SURFACE FIX					

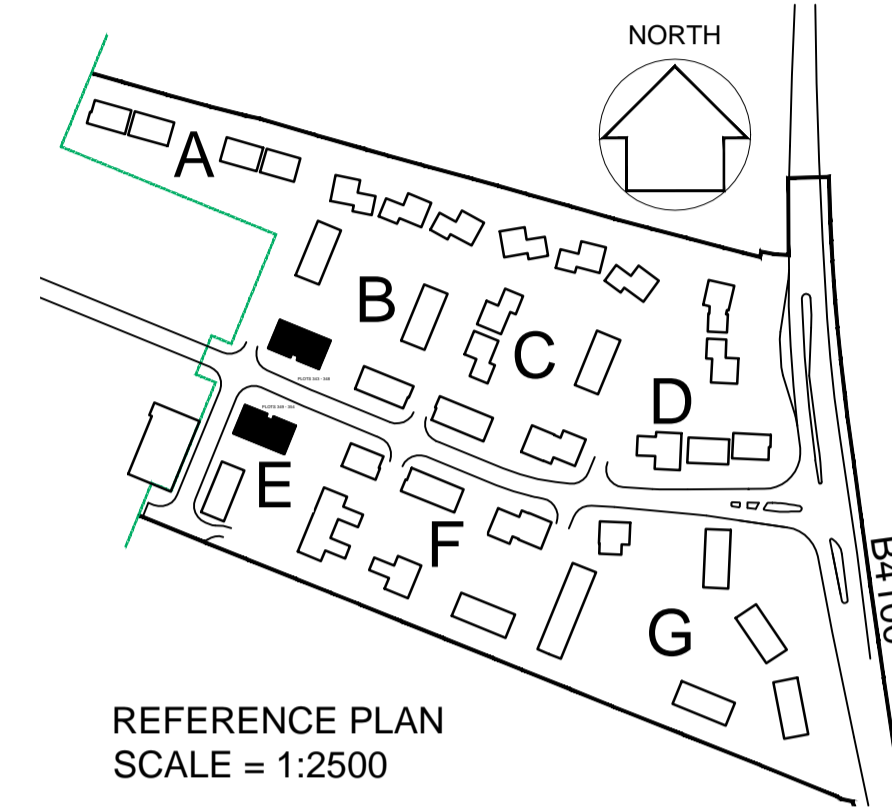
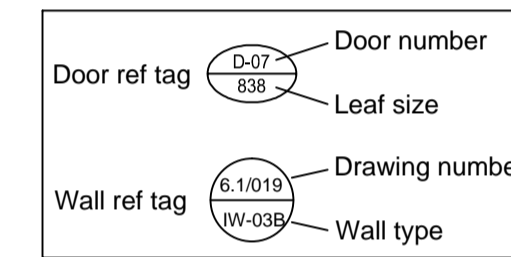

REFERENCE PLAN
SCALE = 1:2500

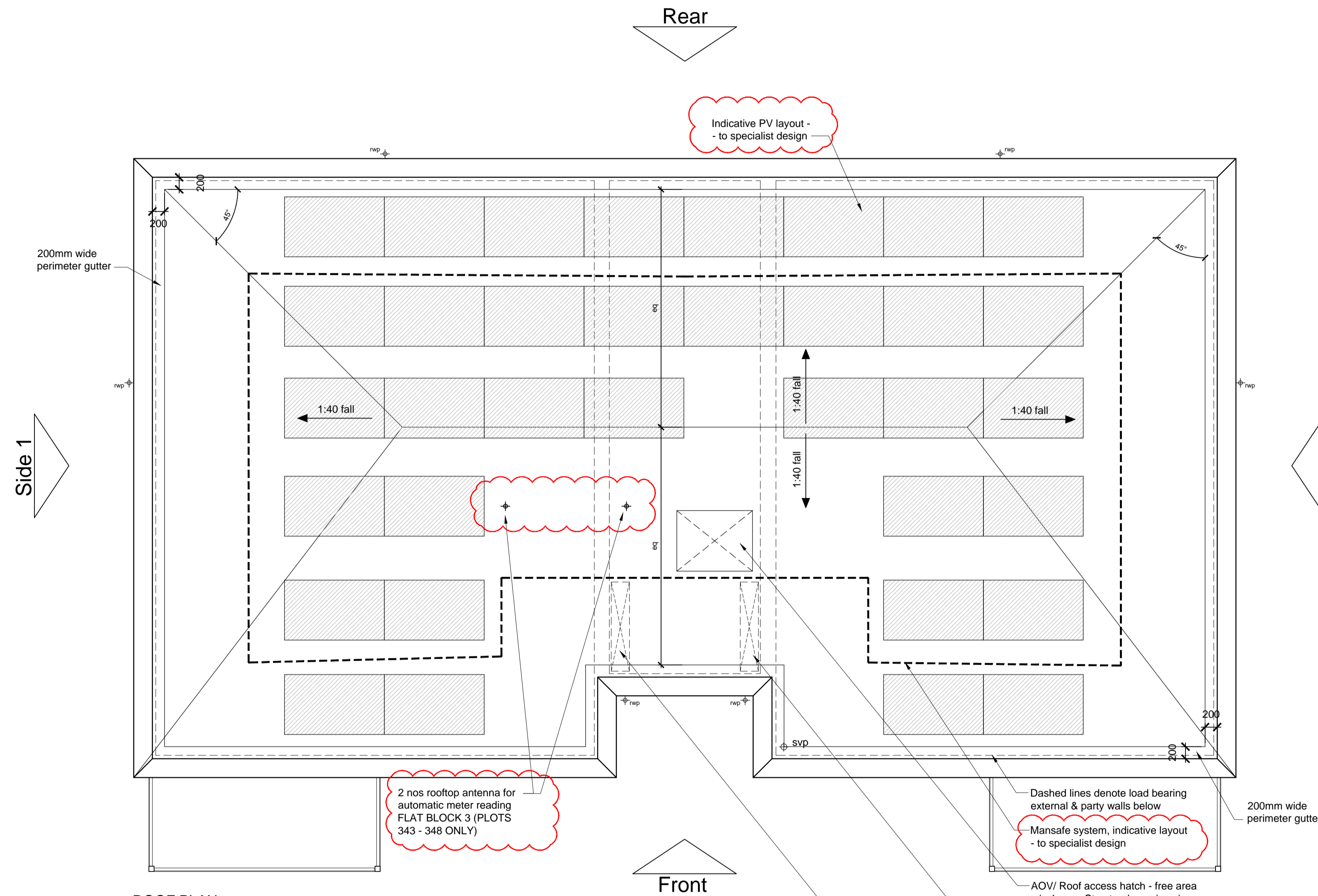

ROOF PLAN

TYPE - 7
WALLS - Render + timber cladding blocks to 1st & 2nd floor
ROOF - Flat

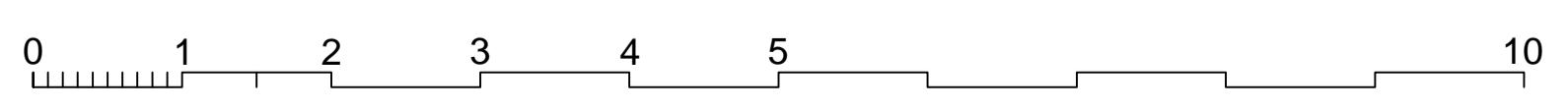

16-11-15	E	2 nos. rooftop antennas added for Flat Block 3 only (Plots 343 - 348), mansafe route updated, PV layout updated. CLRS
20-05-15	D	Drawing updated in line with latest Solar Tech drawings. Falls, perimeter gutter added. DB/CL
29-01-15	C	Drawing updated in line with latest WDH comments, movement joint note added as clouded. CLRS
09-09-13	B	Drawing updated to reflect signed off layout; Dims 1-50 frozen (to be updated later); JW/MD
29-04-13	A	Reference key added; minor adjustments as bubbled DGH/JW

date	rev	revision/author/checker
------	-----	-------------------------

purpose of issue	CONSTRUCTION
project	BICESTER ECO TOWN EXEMPLAR SITE PHASE 1
drawing	ROOF PLAN PLOTS 343 -348 (as drawn) PLOTS 349 - 354 (handed)

drawing no	AA2699C/4.1/317-4	rev	E
drawn	DGH	checked	
scale @ A1	1:50	date	APR 2013