

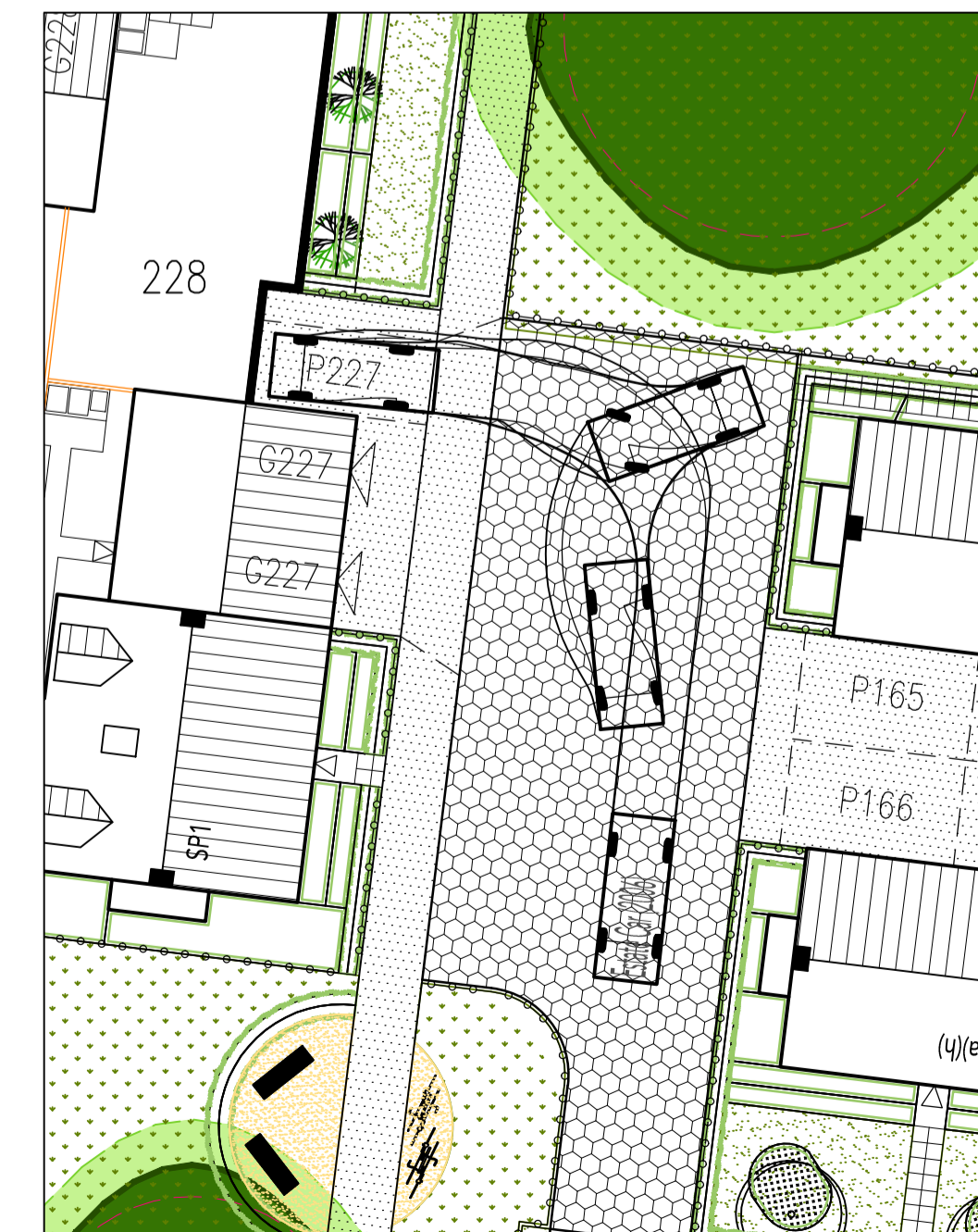

**DORCHESTER GROUP**

REVISIONS:  
 A. 2015-06-30. Plots 160-161, 170-172, 178-181, 183-185, 210 & 223 amended at client's request. Verge widths changed from 1.0m to 0.80m following engineer's comments. Tracking updated to suit. PVA

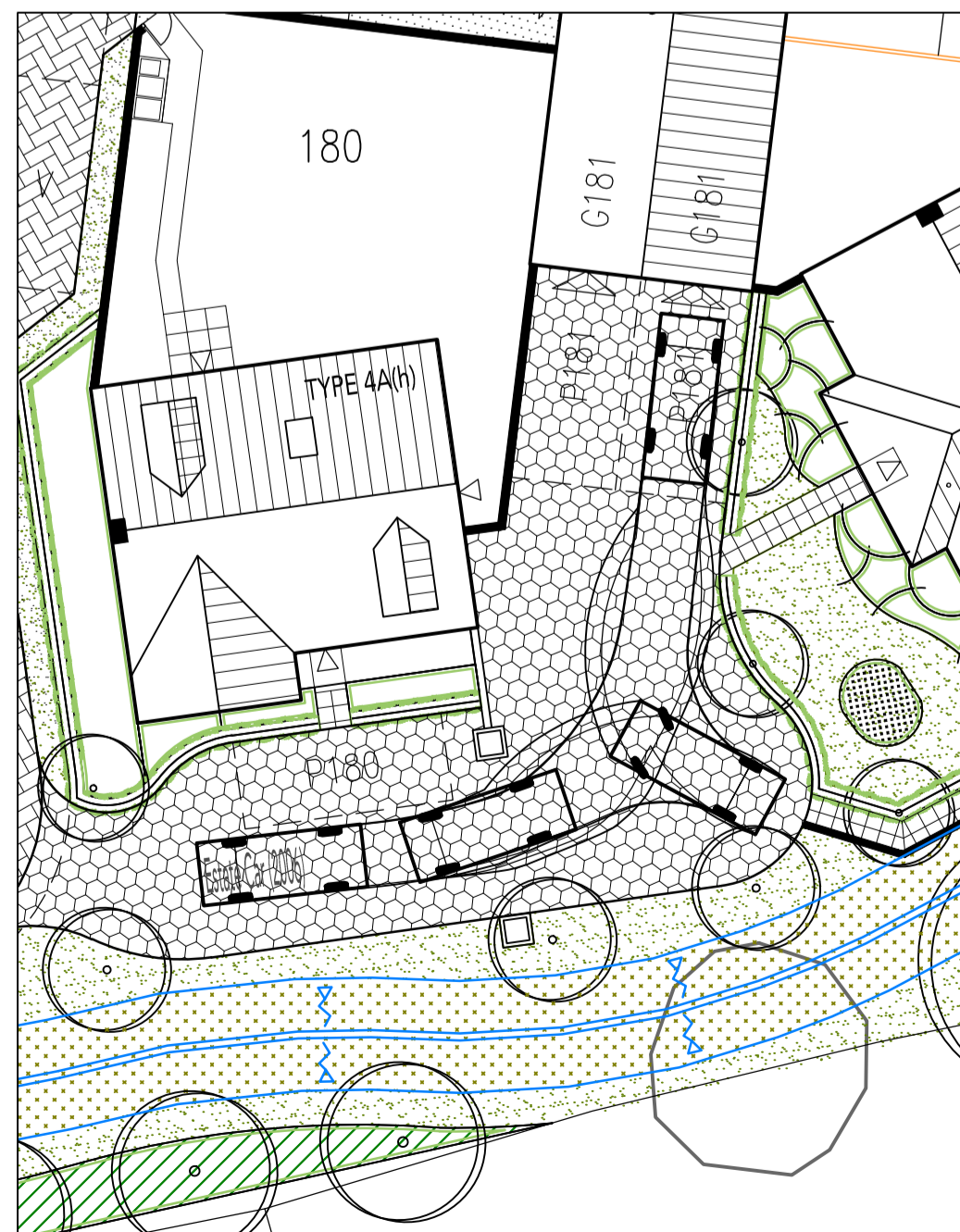
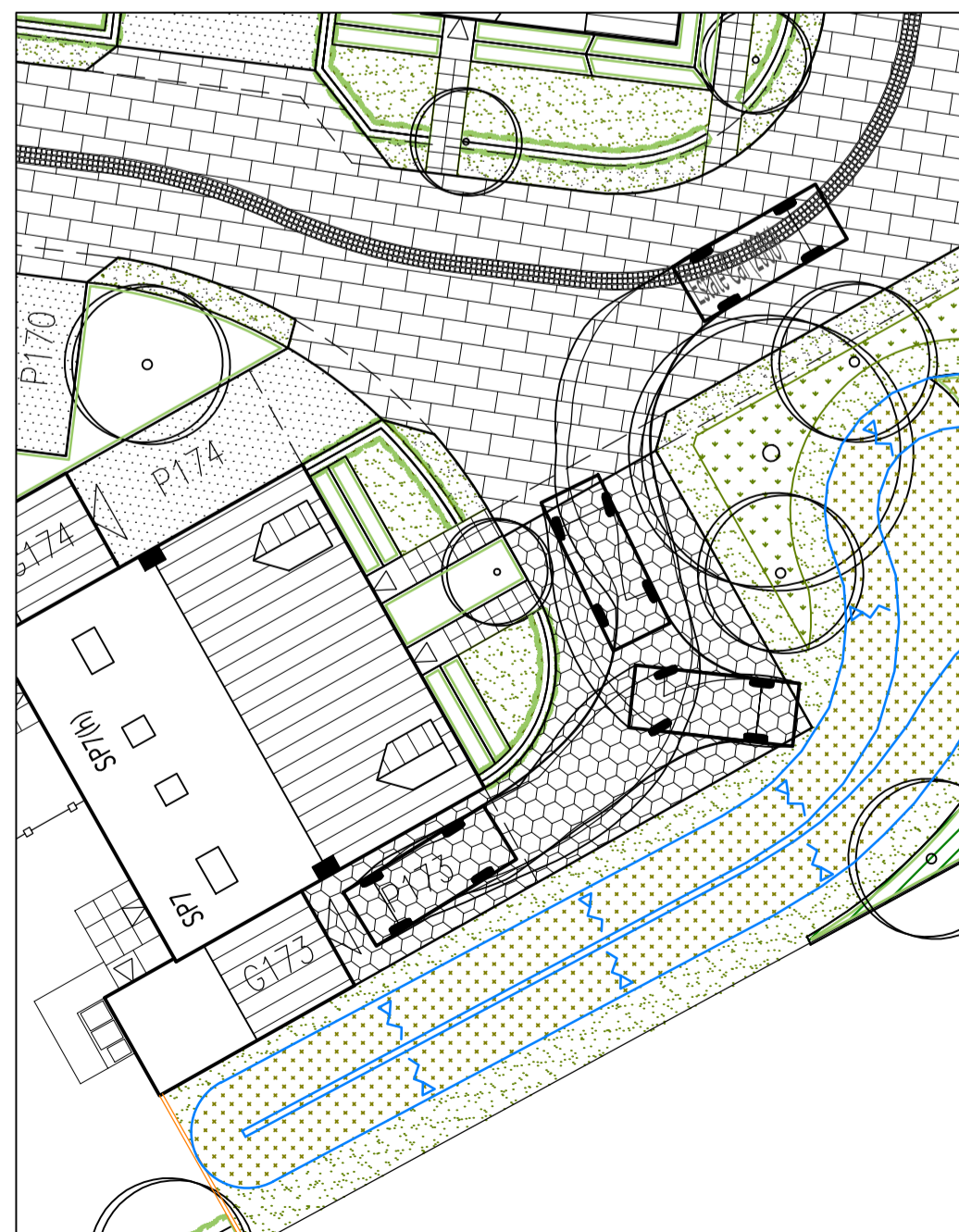
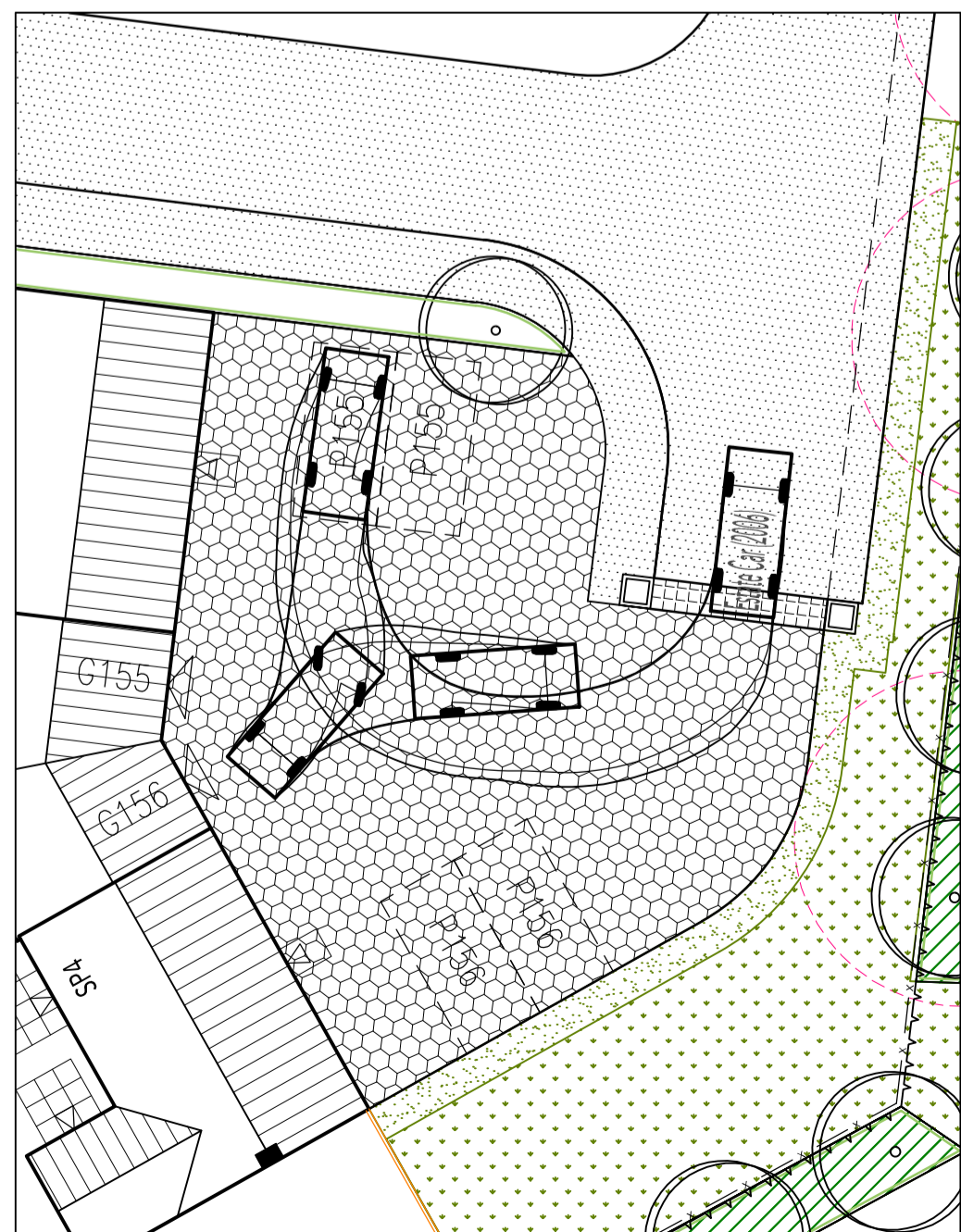

**LEGEND**

Dennis Eagle Olympus Smooth Body RCV EuroSW 6x2RS	Overall Length: 11.390m Overall Width: 2.530m Overall Body Height: 3.751m Min Body Ground Clearance: 0.304m Track Width: 2.500m Lock to Lock Time: 4.00s Kerb to Kerb Turning Radius: 7.500m
Estate Car (2006)	Overall Length: 4.710m Overall Width: 1.804m Overall Body Height: 1.442m Min Body Ground Clearance: 0.207m Max Track Width: 1.756m Lock to Lock Time: 4.00s Kerb to Kerb Turning Radius: 5.950m

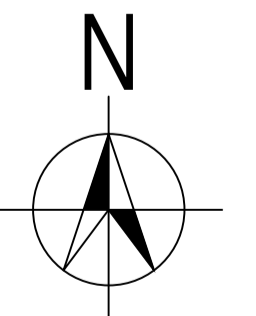

**VEHICLE TRACKING LAYOUT**

SCALE: 1:200 @ A1

DATE: MAY 2015  
 DRAWN: DJE

DRAWING TITLE: VEHICLE TRACKING LAYOUT  
 DRAWING NO: 0521-PH4-5B-105

