

KEY

- Adoptable Macadam Carriageway
- Adoptable Macadam Footpath
- Adoptable Verge
- Half Battered Kerb 125 x 255mm (HB2) laid with 120mm upstand
- Battered Kerb 125 x 150mm (BK) laid at 20mm kerf at crossings and laid with 0mm kerf at tactile from crossing points and where garden paths connect to shared surfaces
- Edging 50 x 150mm (EF)
- Channel kerb
- CK
- Tactile paving with 0mm kerf

Adoptable street lighting and associated buildout positions to be confirmed

- NOTES**
1. CONTRACTORS MUST CHECK ALL DIMENSIONS ON SITE. ONLY FIGURED DIMENSIONS ARE TO BE WORKED FROM. DISCREPANCIES MUST BE REPORTED TO THE ARCHITECT OR ENGINEER BEFORE PROCEEDING. © THIS DRAWING IS COPYRIGHT.
 2. REPRODUCED FROM OS SITEMAP © BY PERMISSION OF ORDNANCE SURVEYS ON BEHALF OF THE CONTROLLER OF HER MAJESTY'S STATIONERY OFFICE. © CROWN COPYRIGHT 2008. ALL RIGHTS RESERVED. LICENCE NUMBER 10007126.
 3. UNTIL TECHNICAL APPROVAL HAS BEEN OBTAINED FROM THE RELEVANT AUTHORITIES, ALL DRAWINGS ARE ISSUED AS PRELIMINARY AND NOT FOR CONSTRUCTION. SHOULD THE CONTRACTOR COMMENCE SITE WORK PRIOR TO APPROVAL BEING GIVEN IT IS ENTIRELY AT HIS OWN RISK.

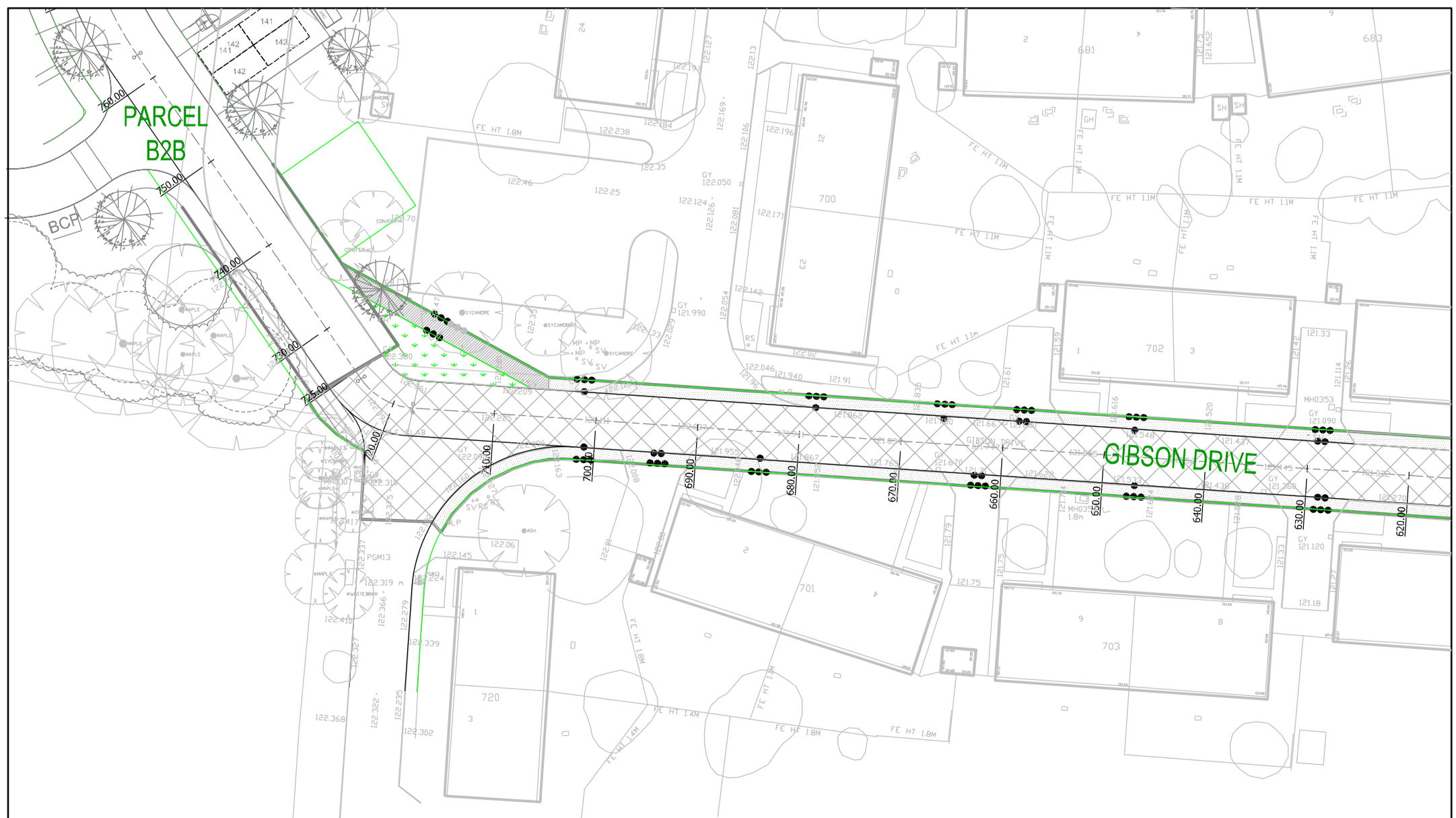

REVISION	DESCRIPTION	AT	DATE
1	SUPERSEDED VILLAGE CENTRE PROPOSALS REMOVED BUS ROUTE BUILDOUT ADDED	AT	08.02.16
2	DESIGN/PROV	AT	03.03.16

PRELIMINARY
 INFORMATION
 TENDER
 CONSTRUCTION
 AS BUILT

WOODS HARDWICK
ARCHITECTS, ENGINEERS AND DEVELOPMENT CONSULTANTS

TITLE: UPPER HEYFORD RMA2 BUS ROUTE
 DETAILS: EXTERNAL FINISHES
 SCALE: A0-1:500 DATE: JANUARY 2016 DRAWN: AT CHK: JF
 15-17 COLCHESTER ROAD, BURNFORD, OXFORD, OX4 2JN
 TEL: 01235 386000
 FAX: 01235 386001
 MAIL@WOODSHARDWICK.COM
 WWW.WOODSHARDWICK.COM

HEYF-5-761 B