



- REVISIONS:
- A. 2015-12-09. Visibility splays added to junctions, landscaping updated. MED
 - B. 2015-12-22. Visibility splays added to legend. SO
 - C. 2016-01-12. Patio length updated for Type 1A, Type 1A-SA, Type 2, SP1, Type 3D, Type 4A & SP6 house types as per client request. SO
 - D. 2016-02-26. Buildouts repositioned and on-street parking spaces amended along the road North East of the site. Vehicle tracking unaffected. PVA
 - E. 2016-03-22. Amended to suit revised Planning Layout. DJE
 - F. 2016-04-19. Amended to suit revised Planning Layout. DJE
 - G. 2016-05-10. Hard-standing around the sub-station and Type 3D footprint amended, tracking unaffected. MED

LEGEND

Estate Car (2006)

Overall Length	4.71m
Overall Width	1.804m
Overall Body Height	1.442m
Min Body Ground Clearance	0.207m
Max Track Width	1.756m
Lock-to-lock time	4.00s
Curb to Curb Turning Radius	5.950m

Dennis Eagle Olympus Smooth Body RCV Euro5W 6x2RS

Overall Length	11.390m
Overall Width	2.530m
Overall Body Height	3.751m
Min Body Ground Clearance	0.304m
Track Width	2.500m
Lock-to-lock time	4.00s
Curb to Curb Turning Radius	7.500m

--- VISIBILITY SPAY

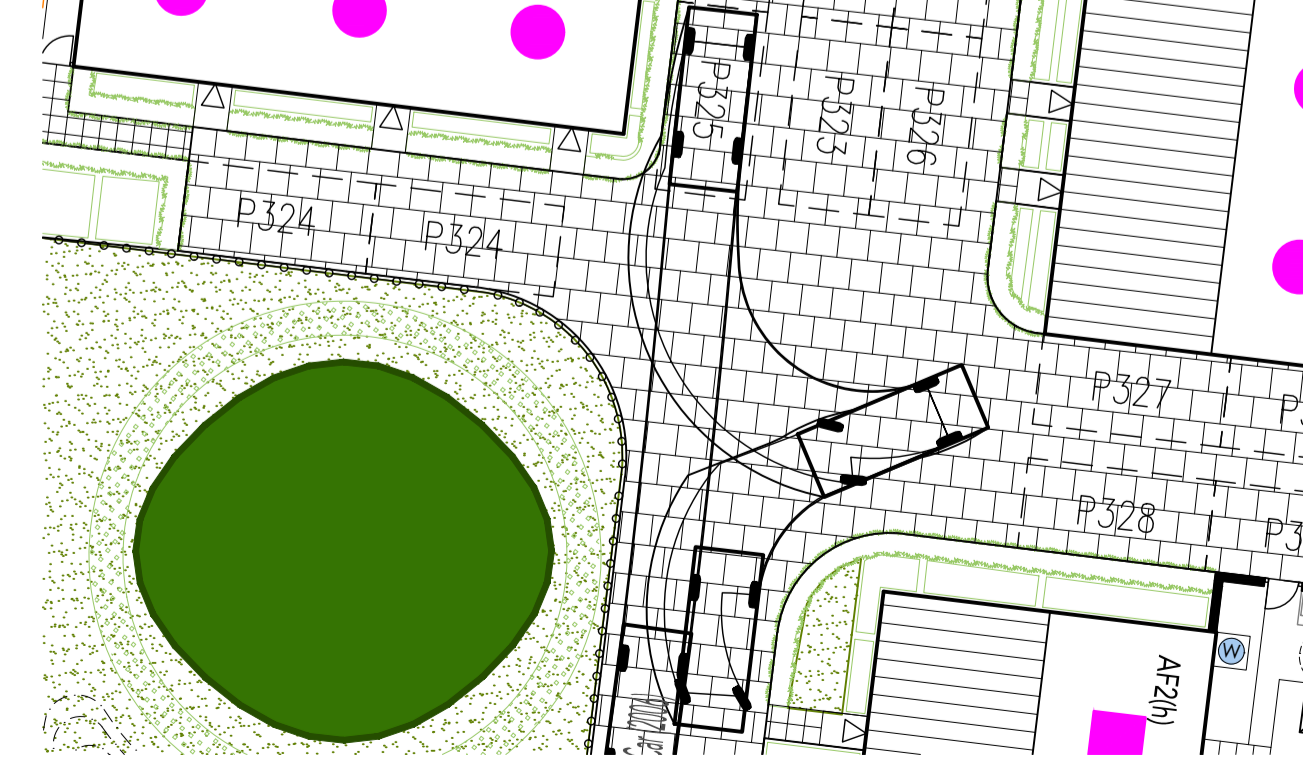
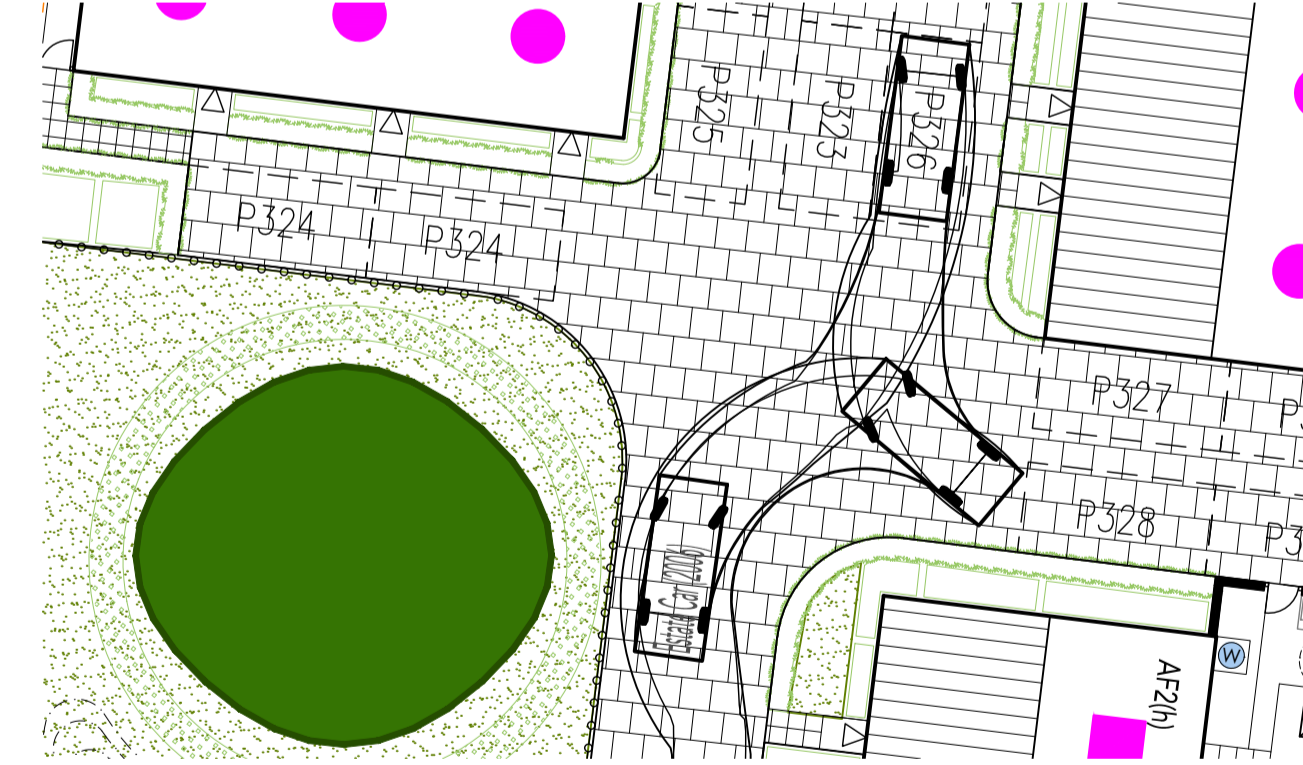
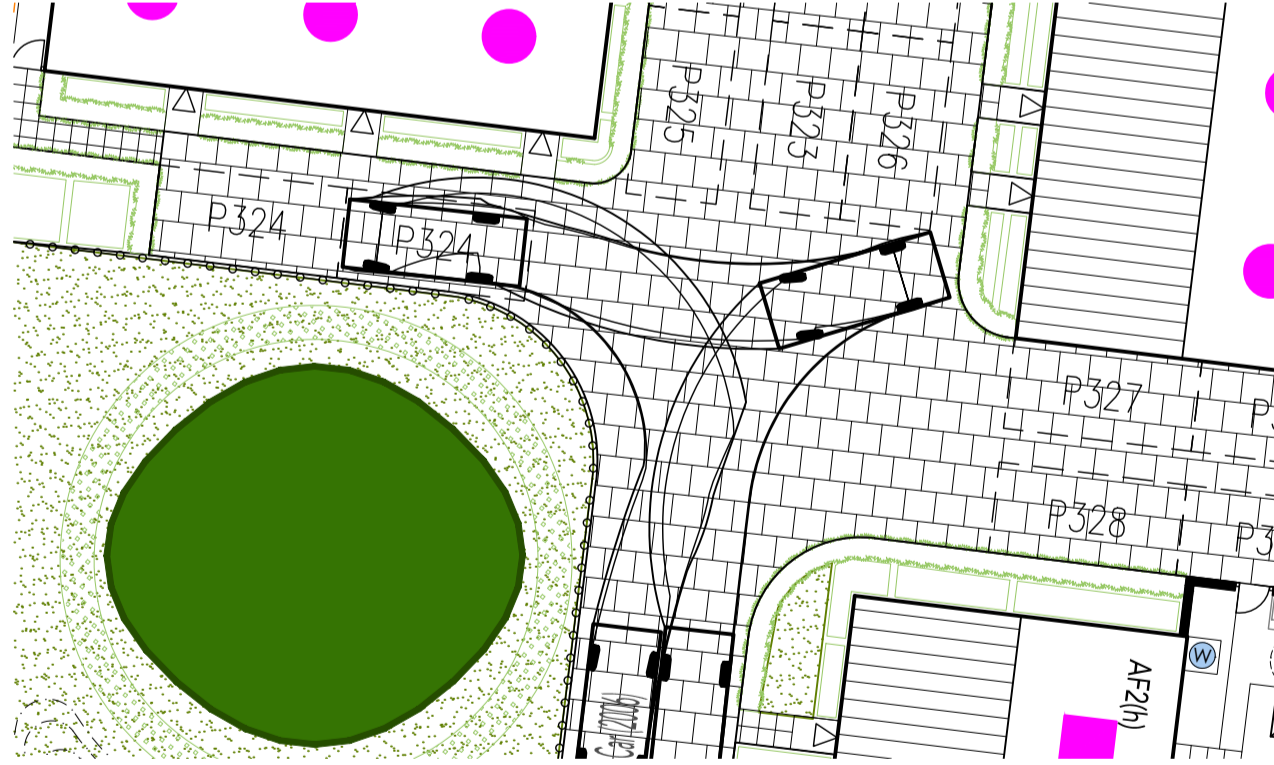
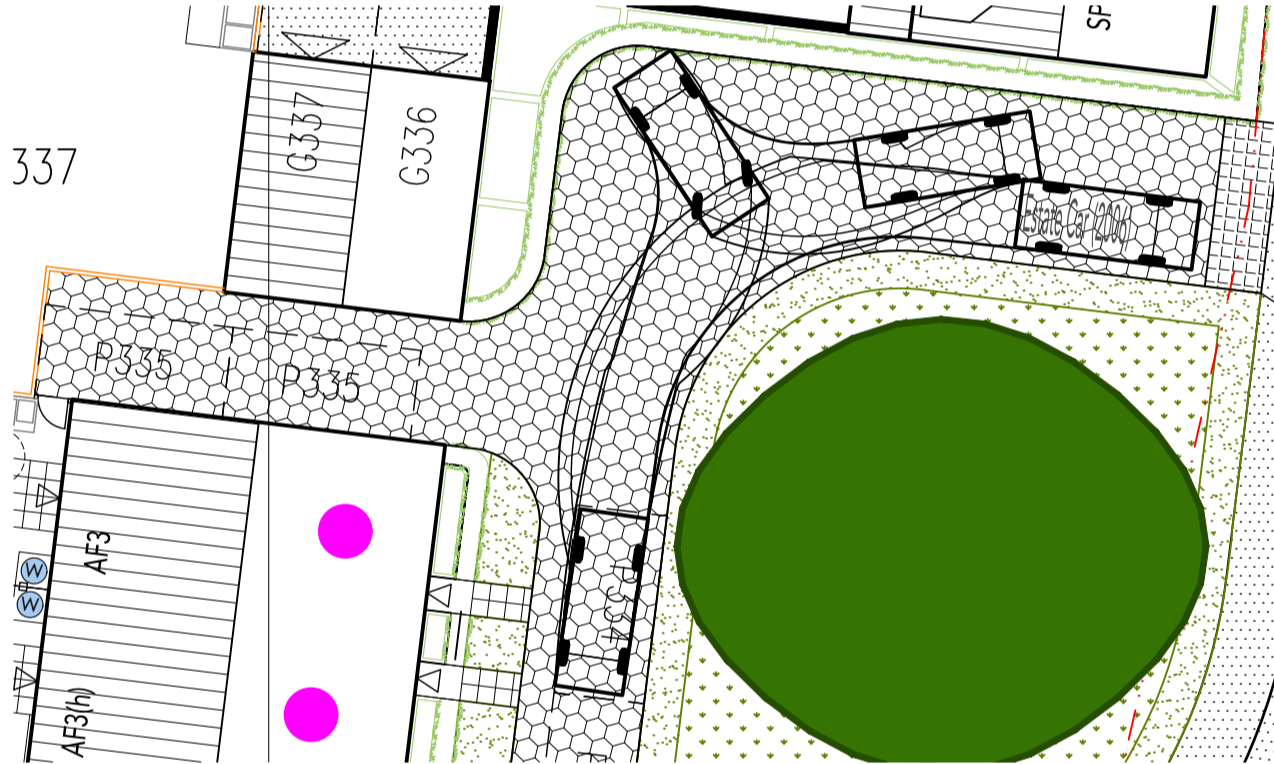
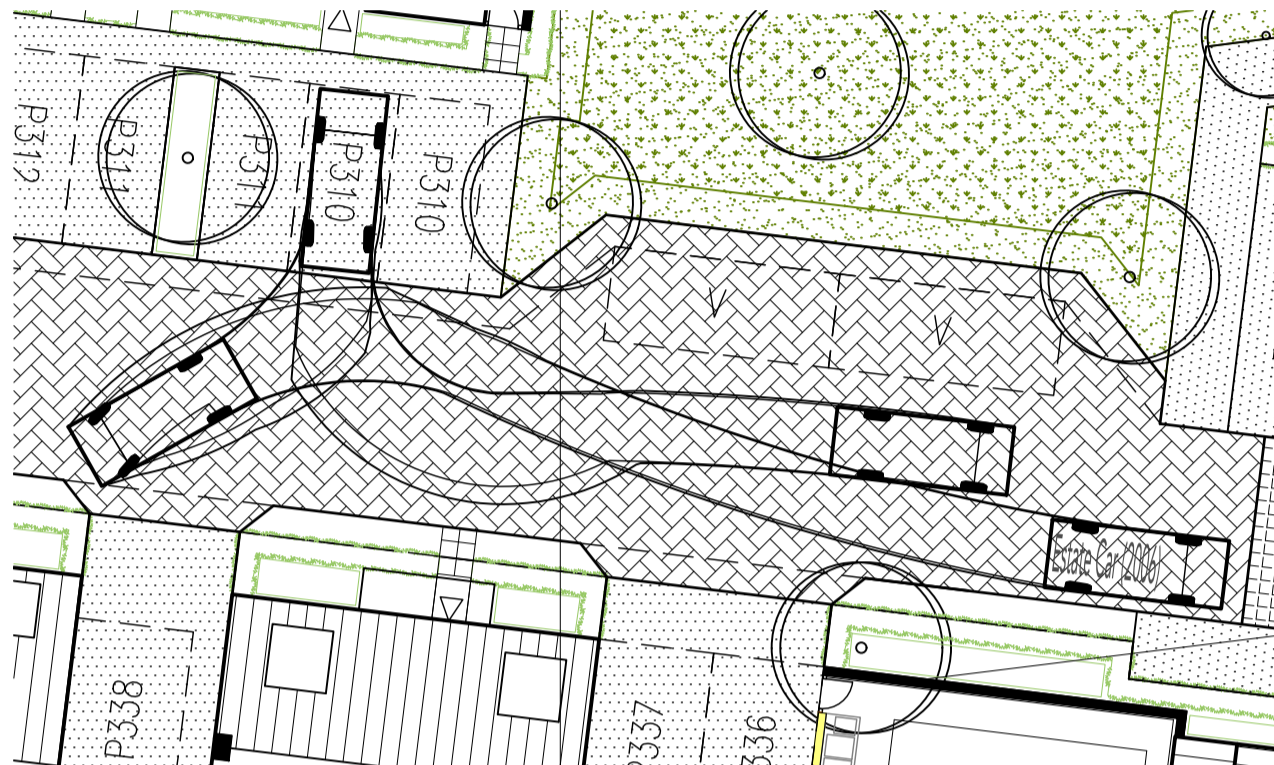
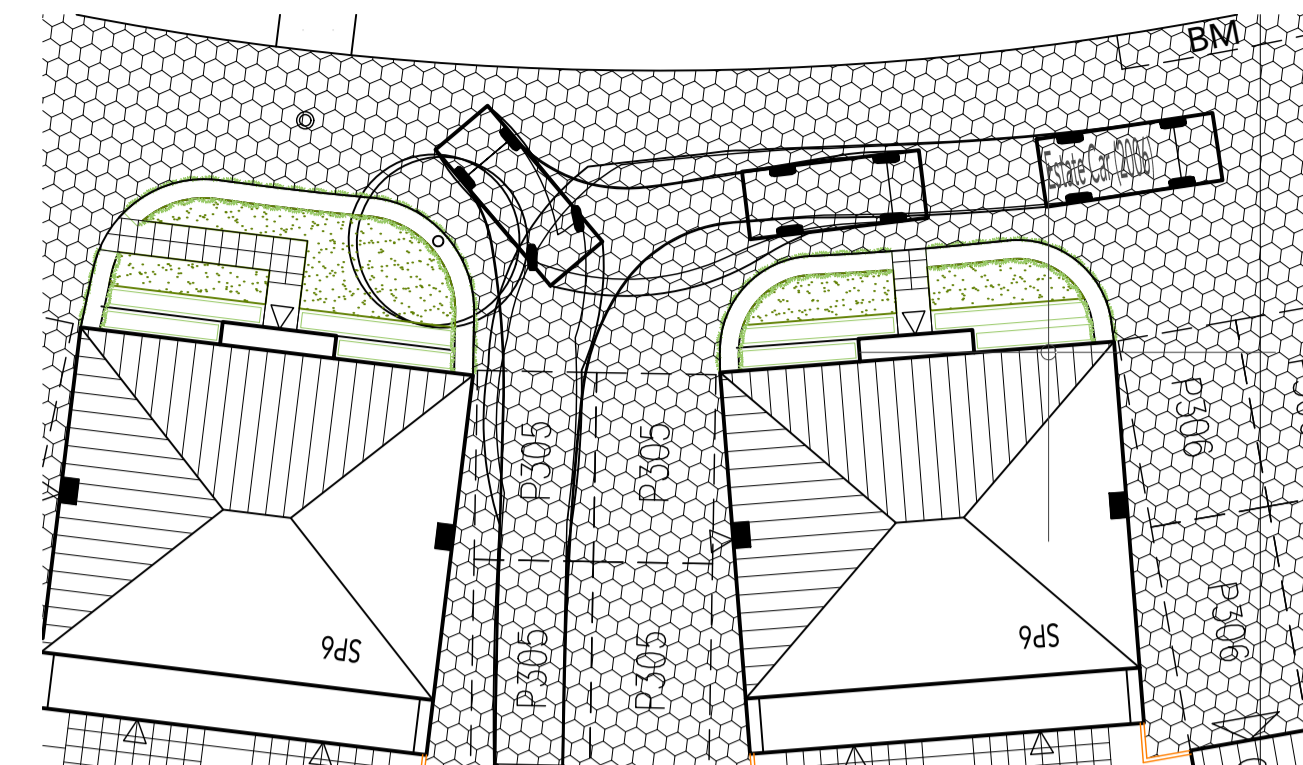
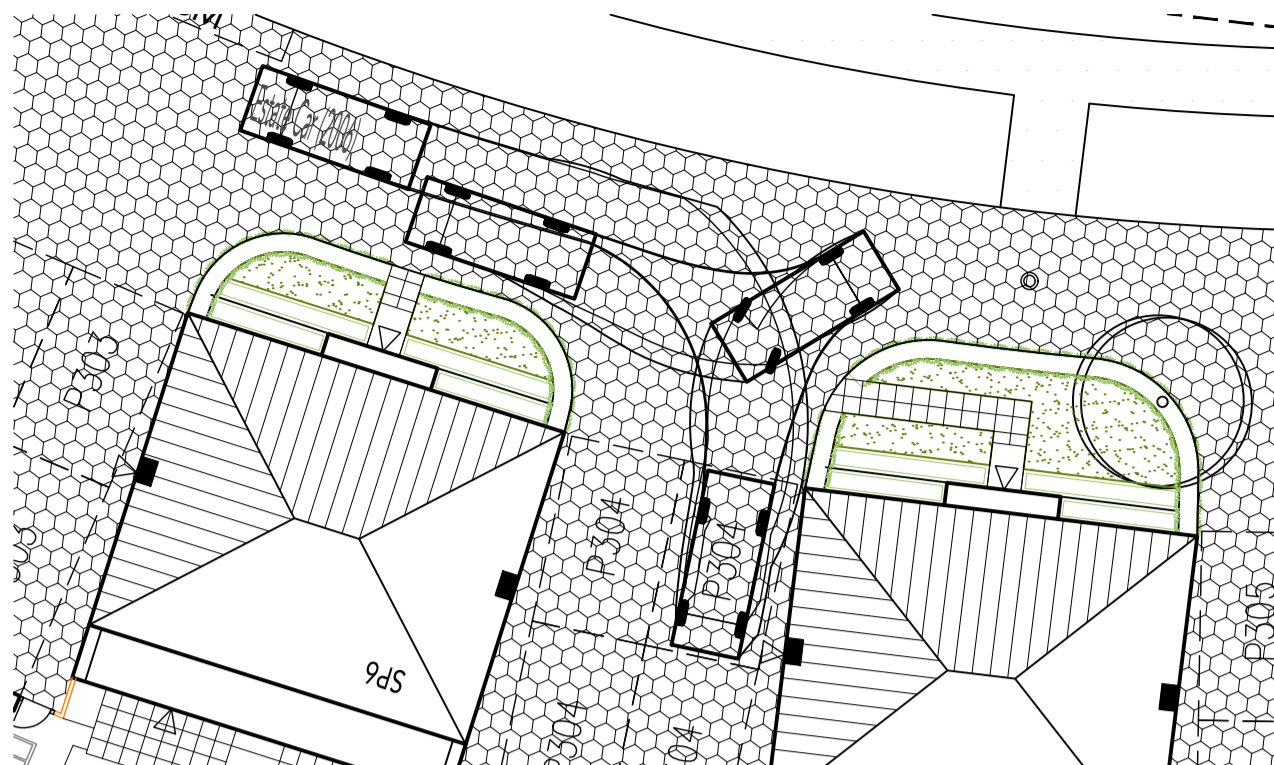

REFUSE VEHICLE TRACKING LAYOUT @ 1:500

VEHICLE TRACKING LAYOUT

SCALE: 1:200 @ A1

DATE: AUGUST 2015

DRAWING TITLE: VEHICLE TRACKING LAYOUT

DRAWN: DJE

DRAWING NO.: 0521-PH6-105

