

IMPLEMENTATION AND MAINTENANCE GUIDELINES

1.0 GENERAL

All plants shall conform to BS 3936 and be in accordance with the National Plant Specification. Supplying nurseries shall be registered under the HTA Nursery Certification Scheme. All plants shall be packed and transported in accordance with the Code of Practice for Plant Handling as produced by CPSE. Planting shall not be carried out when the ground is waterlogged, frostbound or during periods of cold drying winds. All bare root stock shall be root dipped in an approved water-retaining polymer.

If the formation level is compacted it should be ripped through before topsoiling. Recommended topsoil depths are 300mm for shrubs and 150mm for grass.

2.0 ORNAMENTAL SHRUBS

2.1 Ground Preparation
Where necessary treat existing weeds with a glyphosate based herbicide and allow a suitable period as recommended by the manufacturer for this to take effect. A general purpose slow release fertiliser at the rate of 75g/m² and Tree Planting and Mulching Compost at the rate of 20litres/m² are to be incorporated into the top 150mm of topsoil during final cultivations. All extraneous matter such as plastic, wood, metal and stones greater than 50mm in any dimension shall be removed from site.

2.2 Planting
Shrubs are to be set out as shown on the drawing and pit planted into the prepared soil at the specified centres with minimal disturbance to the rootball and well firmed in.

Water in all trees and shrubs at the end of each day of planting.

Spread ornamental pine bark mulch to a depth of 75mm across all new planting areas, ensuring groundcover plants are not buried.

2.3 Maintenance
The landscape contractor shall maintain all areas of new planting for a period of 12 months following practical completion. All stock deemed to be dead, dying or diseased within the defects period shall be replaced by the contractor at his own cost.

The site is to be visited monthly throughout the year to undertake the following operations.
Weed clearance: All planting areas are to be kept weed free by hand weeding or herbicide treatment.
Litter clearance: All litter is to be removed from planting beds.
Watering: Planting areas are to be brought up to field capacity at each visit and each tree is to receive 20 gallons.
Formative pruning: Any damaged shoots/branches are to be pruned back to healthy wood. Plants are to be pruned in accordance with good horticultural practice to maintain healthy well-shaped specimens.

3.0 GRASS

3.1 Preparation
The area to be turfed or seeded shall be sprayed out with a glyphosate herbicide and cultivated to a depth of 100mm removing all weeds, debris and stones over 25mm diameter. The surface shall be raked to smooth flowing contours with a fine tilth, incorporating pre-seeding fertiliser at 70 g/m².

3.2 Delivery and Storage
Turf shall be supplied in accordance with BS3936.
Turf shall be Medallion as supplied by Rowlawn. It shall be close textured and green in colour and be sufficiently fibrous to withstand handling. Turves shall be regular in shape, 300mm wide and of uniform thickness (minimum 25mm). The grass shall be closely mown and shall not exceed 25mm in height.

Turf shall be stacked in piles of up to 1 metre. It shall not be laid in frosty or waterlogged conditions and shall not be stacked in rolls for more than three days.

3.3 Turf
Turfing operations shall be in accordance with BS 4428.

Whole turves shall be laid around the perimeter of the area to be turfed. The central area shall be laid in rows with staggered joints, well butted together, working from planks positioned on turves already laid. The turf shall be watered on completion. Any unevenness shall be made good by lifting the turf and adjusting the levels. Should shrinkage occur, fine topsoil shall be brushed into the joints.

3.4 Seeding
Grass seed shall be sown in April during calm weather and not when the ground is frost bound or waterlogged. Seed shall be sown in two equal sowings in transverse directions at 35 g/m². After sowing the contractor shall lightly rake the seed into intimate contact with the soil.

3.5 Initial cut
When newly seeded and turfed areas reach 50mm they should be lightly rolled and cut to a height of 30mm. All arisings shall be removed. Any bare patches shall be made good at this time. Seeded areas shall be cut for a second time when the sward reaches 50mm high.

NOTES

- All landscape proposals must be referred to by the Structural Engineer during foundation design.
- Soiling operations to be carried out in accordance with the implementation and maintenance guidelines.
- All planting to be in accordance with the implementation and maintenance guidelines.
- No species, variety, size or position to be amended without the Landscape Architects prior approval.
- Before trees are planted, the Landscape Contractor shall ascertain the location of drains from the site manager, and shall if necessary make minor adjustments to tree positions to ensure that they are planted at least 1.5m from drains. They should however be planted no closer to houses/garages than is shown on the drawing, and if shown located in shrub beds, the shape of the latter should be adjusted if necessary to accommodate the revised tree position.
- All planting must be mulched in accordance with the implementation and maintenance guidelines.
- If planting is required outside the October-March season, bare root shrubs will be replaced by 3L pot grown plants, and trees will be replaced by a containerised equivalent to be approved by the project landscape architect.



1. Caterpillar
Play Enrichment: climbing, balancing, crawling, imaginative play
Age group: 1-4 years



2. Snail
Play Enrichment: social, imaginative play, safe climbing, crawling & touching
Age group: 1-4 years

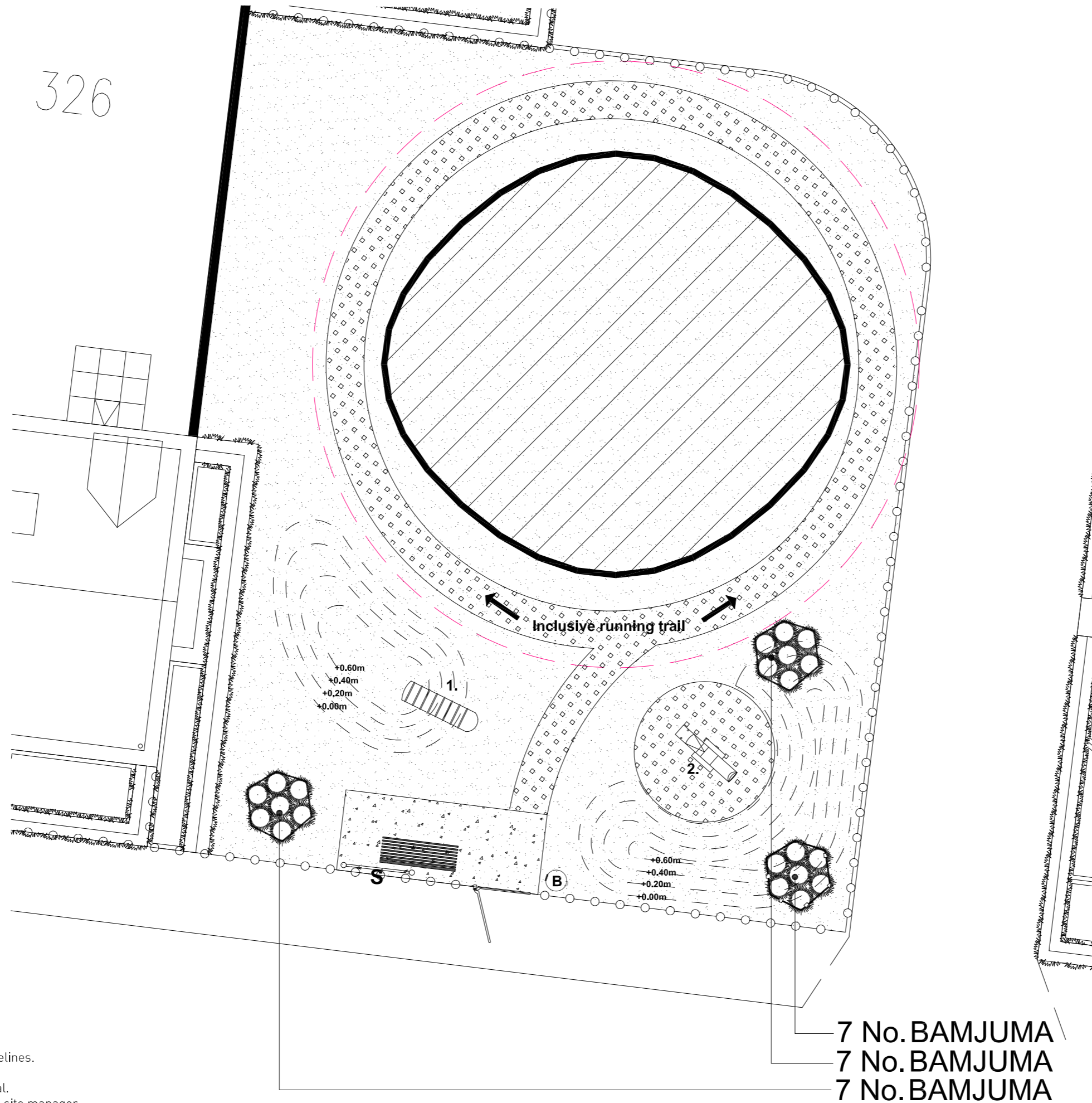

7 No. BAMJUMA
7 No. BAMJUMA
7 No. BAMJUMA

KEY

- Plot soft landscape proposals**
Refer to the latest revision of Liz Lake Associates drawing 'Detailed Landscape Proposals, drawing ref: 1619A201 & 1619A202.
- Existing trees to be retained**
Root protection zone indicated as dashed circular line.

PLAY AREA SCHEDULE

- Bench seat**
Ref: BX17 4001T 'Roslin Seat' (supplied in black) mild steel, timber slat version seat with armrests, as supplied by Broxap or similar approved. Seat to be installed with submerged fixing set in concrete footings to manufacturers specification.
- Litter bin**
Ref: BX45 2596 'Derby Slimline' 90L perforated litter bin, coated in green as supplied by Broxap or similar approved.
- Hard surfaced footpath**
tarmac footpath with pcc edging.
- Play area signage location**
Possible location for play area signage. Sign to be supplied and erected stating that the play area is a 'Dog Free' zone and any other information required. Exact wording to be agreed with the Local Planning Authority.
- Proposed 0.5 metre high timber guard rail to bamboo**
To Local Authority approved specification. Timbers to be machine rounded as supplied by MM Timber or similar approved. Chicane detail to play area entrances.
- Reinforced grass safety surfacing**
Play manufacturers to detail in accordance with EN 1176.
- Proposed ground contouring**
Topsoil shall be spread evenly over the formation levels in layers not exceeding 150mm to a depth of 150mm for grass. All slopes shall be graded with a rigid blade grader and consolidated to proposed levels. **The gradient of the slopes shall be smooth-flowing and marrying with all existing levels. Contours are shown at 0.20m intervals.**
- Play equipment schedule**
 - 1. Caterpillar**
100x150x30cm galvanised steel caterpillar supplied by www.playgroundsculptures.co.uk or similar approved play manufacturer.
 - 2. Snail**
Timber snail play unit supplied by www.timberplay.com or similar approved play manufacturer.

All play equipment and layout proposals to be specified in accordance with the requirements set out under BS EN 1176 and the Disability Discrimination Act. Following the agreement of play equipment and the general arrangement the selected manufacturer's details will be submitted to the local council for approval along with the finalised proposals and accompanying certificates and details.
- Play area boundary fence**
1.0m high bow top railing system finished in black RAL colour. To be manufactured from mild steel. Fencing to accordance with RoSPA guidelines and BS EN 1176.
- Play area pedestrian gate**
1.0m high hydraulic self closing child/pedestrian gate with a closure time of at least 5-8 seconds. Gate to open outwards and finished in bright yellow RAL colour to aid partially sighted users.

PLANT SCHEDULE

SHRUBS/HERBACEOUS	ABBR	SPECIES	SUPPLY	SIZE(cm)	HABIT	CTRS(m)
	BAMJUMA	Fargesia muriellae 'Jumbo'	10L	-	Full Pot	As shown
All shrubs to be planted in accordance with the implementation and maintenance guidelines. No shrub species, size or location should be altered without prior approval from the Landscape Architect.						
	Turf/grass Rowlawn Medallion turf or similar approved.					

Revisions:
First Issue - 28/08/2015 AP



Heyford Park, Upper Heyford
Phase 6 LAP Proposals

Drawing Ref: BIR4322_26
Client: Dorchester Group

Date : 28/08/2015
Drawn by : AP
Checked by : IS
1 : 100 @ A2

