

**SURVEY INFORMATION**  
 MK Surveys - 01908 565561  
 DRG NUMBER: 17523 - Sheets 1-12  
 DATE RECEIVED: 17/12/2014

**ARCHITECT SITE PLAN INFORMATION**  
 PRP Architects - 020 7653 3464  
 DRG NUMBER: AA2699  
 DATE RECEIVED: 22/12/2015

**NOTES**

- All dimensions and levels are in metres unless otherwise noted
- This drawing is to be read in conjunction with the relevant Architects/Engineers drawings, specifications and CDM documentation
- This drawings has been produced electronically and may have been photo reduced or enlarged when copied. Work to figured dimensions only (DO NOT SCALE). All dimensions to be checked on site. Any errors or omissions to be reported to the engineer immediately.
- This drawing contains coloured lines / information that may not be clear if reproduced in black and white.

**DESIGNERS CDM NOTE - RESIDUAL RISKS NOT IDENTIFIED**

The design Engineer(s) has assessed this design as the scheme has been developed in order to identify if there are any residual risk hazards (i.e. unusual, unexpected, abnormal or difficult).

No residual risks have been identified for this scheme and therefore no entries were added to the risk register.

This statement assumes that a competent Contractor with the appropriate qualified staff will be employed for the works, and that they will be familiar with site wide construction risks and hazards that they can reasonably be expected to encounter as part of their work.

**Key**

<span style="color: red;">—</span>	Finished Floor Level
<span style="color: blue;">—</span>	Finished Floor Level set by Hyder spine road design
<span style="border: 1px solid black; padding: 2px;">75mm</span>	Step in building
<span style="border: 1px solid black; padding: 2px;">Retaining Wall</span>	Retaining Wall
<span style="color: red;">- - -</span>	Proposed road contour
<span style="color: red;">—</span>	Existing road contour
<span style="color: blue;">↘</span>	Direction and grade of fall
<span style="color: red;">88.520</span>	Proposed level
<span style="color: green;">88.520</span>	Footway set to fixed Hyder design
<span style="color: red;">+86.16</span>	Survey Levels (December 2015)
<span style="color: red;">-85.22</span>	Existing level
<span style="border: 1px solid red; padding: 2px;">Site Extents</span>	Site Extents
<span style="border: 1px dashed red; padding: 2px;">Underbuild facing brickwork below FFL</span>	Underbuild facing brickwork below FFL
<span style="border: 1px dashed green; padding: 2px;">Overbuild facing brickwork above FFL</span>	Overbuild facing brickwork above FFL

PO1	NJ	TST	Initial issue	03/02/16
Rev	Drawn by	Chk'd by	Comments	Date

**DRAWING TITLE**  
 Existing & Proposed Level Plan  
 Sheet 4/4

**PROJECT**  
 Phase 2  
 Bicester Eco Village  
 Bicester  
 Oxon

DESIGNED BY TST	DRAFTED BY NJ	APPROVED BY DJ
DATE 03/02/2016	STATUS <b>SUBJECT TO TECHNICAL APPROVAL</b>	
SCALE 1:250 @ A1	Scale Bar @ 1:250 0m 4.25m 12.5m	

**CUSTOMER**

**Hill** **Infrastruct CS Ltd**

JOB NUMBER: 15-1859    DRAWING NUMBER: 02-4    REVISION: P01

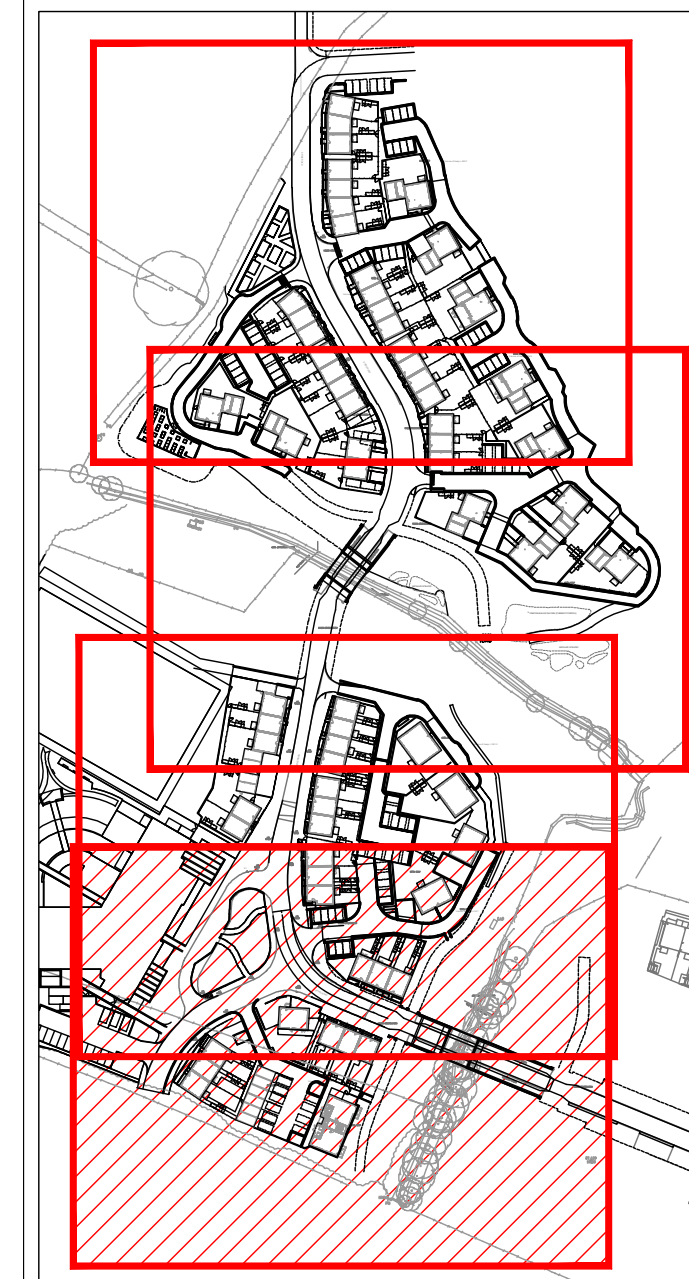

Sheet Arrangement (1:2500)

X:\UCS Jobs\1800 Jobs\15-1859 Bicester Phase 2\01 - Drawings\01 CH\15-1859.dwg