



SURVEY INFORMATION
 MK Surveys - 01908 565561
 DRG NUMBER: 17523 - Sheets 1-12
 DATE RECEIVED: 17/12/2014

ARCHITECT SITE PLAN INFORMATION
 PRP Architects - 020 7653 3464
 DRG NUMBER: AA2699
 DATE RECEIVED: 22/12/2015

- NOTES**
- All dimensions and levels are in metres unless otherwise noted
 - This drawing is to be read in conjunction with the relevant Architects/Engineers drawings, specifications and CDM documentation
 - This drawings has been produced electronically and may have been photo reduced or enlarged when copied. Work to figured dimensions only (DO NOT SCALE). All dimensions to be checked on site. Any errors or omissions to be reported to the engineer immediately.
 - This drawing contains coloured lines / information that may not be clear if reproduced in black and white.

DESIGNERS CDM NOTE - RESIDUAL RISKS NOT IDENTIFIED

The design Engineer(s) have assessed this design as the scheme has been developed in order to identify if there are any residual risk hazards (i.e. unusual, unexpected, abnormal or difficult).

No residual risks have been identified for this scheme and therefore no entries were added to the risk register.

This statement assumes that a competent Contractor with the appropriate qualified staff will be employed for the works, and that they will be familiar with site wide construction risks and hazards that they can reasonably be expected to encounter as part of their work.

Kerb Legend

Kerb Ref	Type	Dimensions	Notes
BN50	BN	125x150	50mm upstand eg shared access kerb edge
BN4	BN	125x150	15mm upstand eg vehicle crossover dropped kerbs
BN6	BN	125x150	6m upstand eg dropped kerbing to dwelling primary access crossover
BND	BN	-	flush kerb laid with slight fall to channels; kerbs laid upside down where permitted as CS2 alternative
CS2	CS2	150x150	Flush kerb laid with slight fall to channel eg Pedestrian crossings
EF	EF	50x150	Square edged path edging laid flush unless otherwise stated

	Permeable concrete block paving Charcon Infiltra Andover textured 100x200mm or similar approved
	Permeable concrete block paving Charcon Infiltra Andover textured 134x134mm or similar approved
	Charcon Eco pave or similar approved to public areas, Charcon Riven or similar approved to private rear gardens
	Soft landscaping - Refer to PRP Architects details
	Private footway - Type 1 Self binding gravel
	Private footway - Type 2 Bitmac footway
	Section 38 footway
	Section 38 works - Refer to Hyder drawings
	River corridor - Refer to Hyder drawings for details

Refer to PRP Architects drawings for all surface finishes colour specifications

P02	NJ	TST	Surface finishes key amended	08/02/16
P01	NJ	TST	Initial issue	05/02/16
Rev	Drawn by	Chk'd by	Comments	Date

DRAWING TITLE
 Surface Finishes & Kerb Type Plan
 Sheet 4/4

PROJECT
 Phase 2
 Bicester Eco Village
 Bicester
 Oxon

DESIGNED BY TST	DRAFTED BY NJ	APPROVED BY DJ
DATE 05/02/2016	STATUS SUBJECT TO TECHNICAL APPROVAL	
SCALE 1:250 @ A1	Scale Bar @ 1:250 0m 4.25m 12.5m	

CUSTOMER

JOB NUMBER 15-1859 **DRAWING NUMBER** 04-4 **REVISION** P02

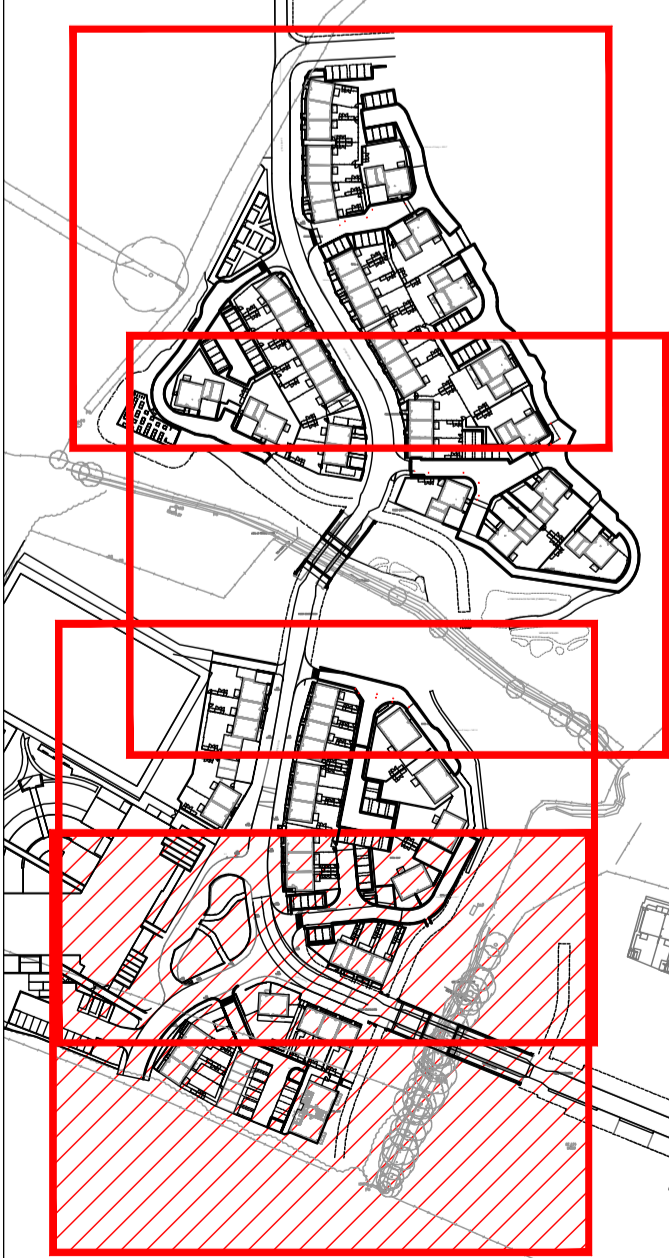

Sheet Arrangement (1:2500)

X:\VCS_jobs\1800_jobs\15-1859 Bicester Phase 2\01 - Drawings\01 CHN\15-1859.dwg