

90.15m AOD CONTOUR EXISTING 13834m²

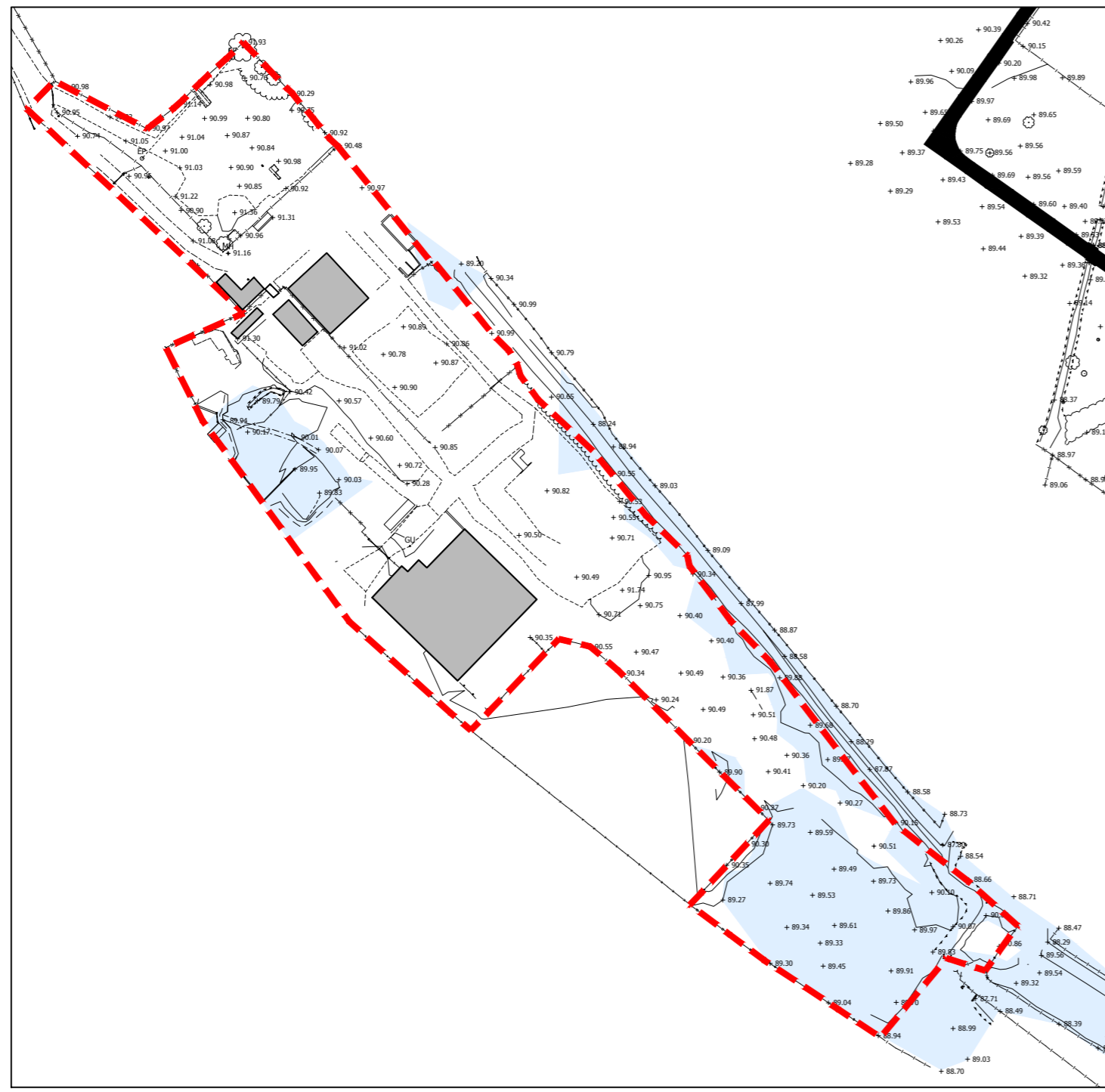

90.15m AOD CONTOUR PROPOSED 17009m²

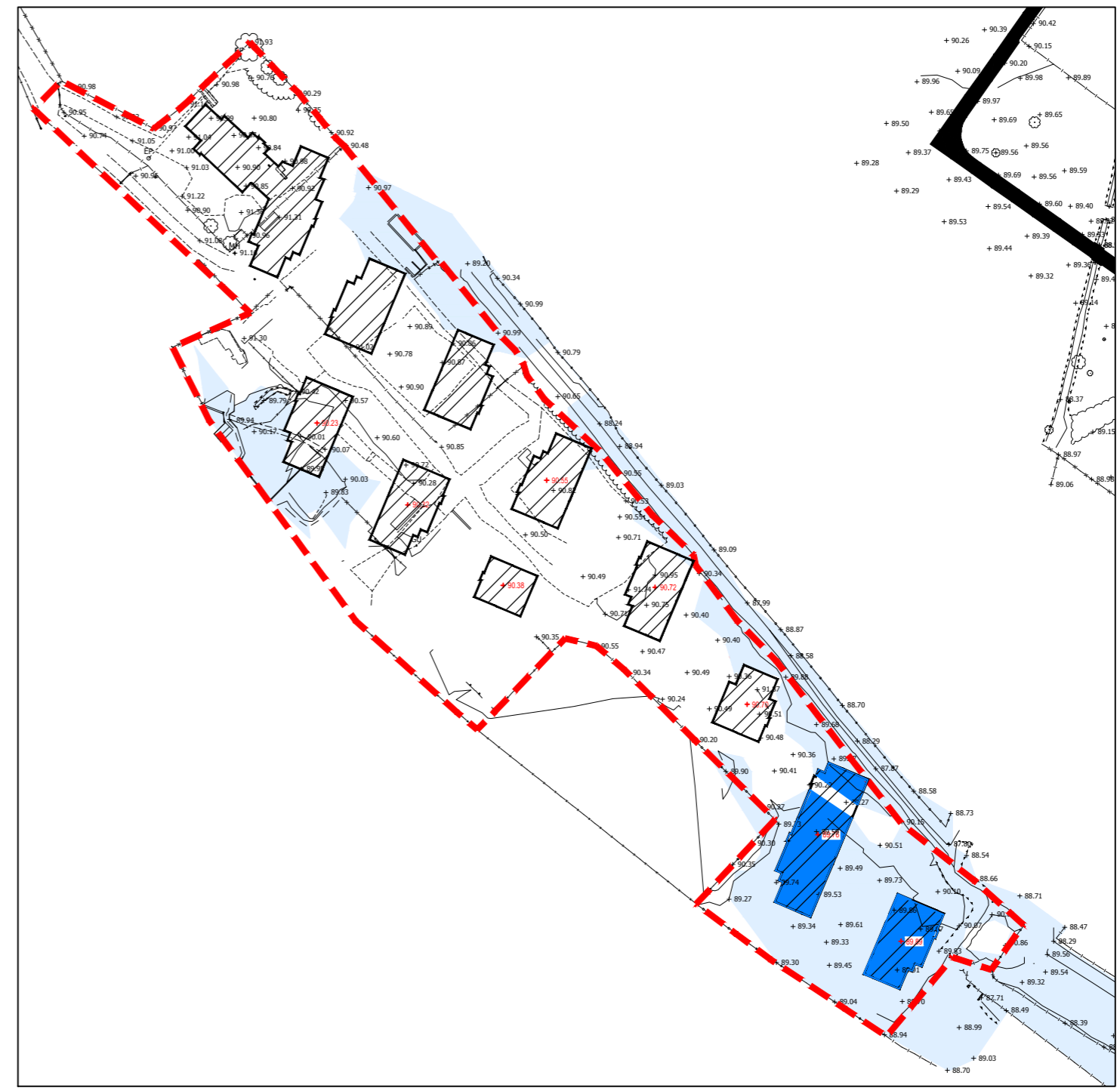

89.95m AOD CONTOUR EXISTING 11040m²



89.95m AOD CONTOUR PROPOSED 10168m²

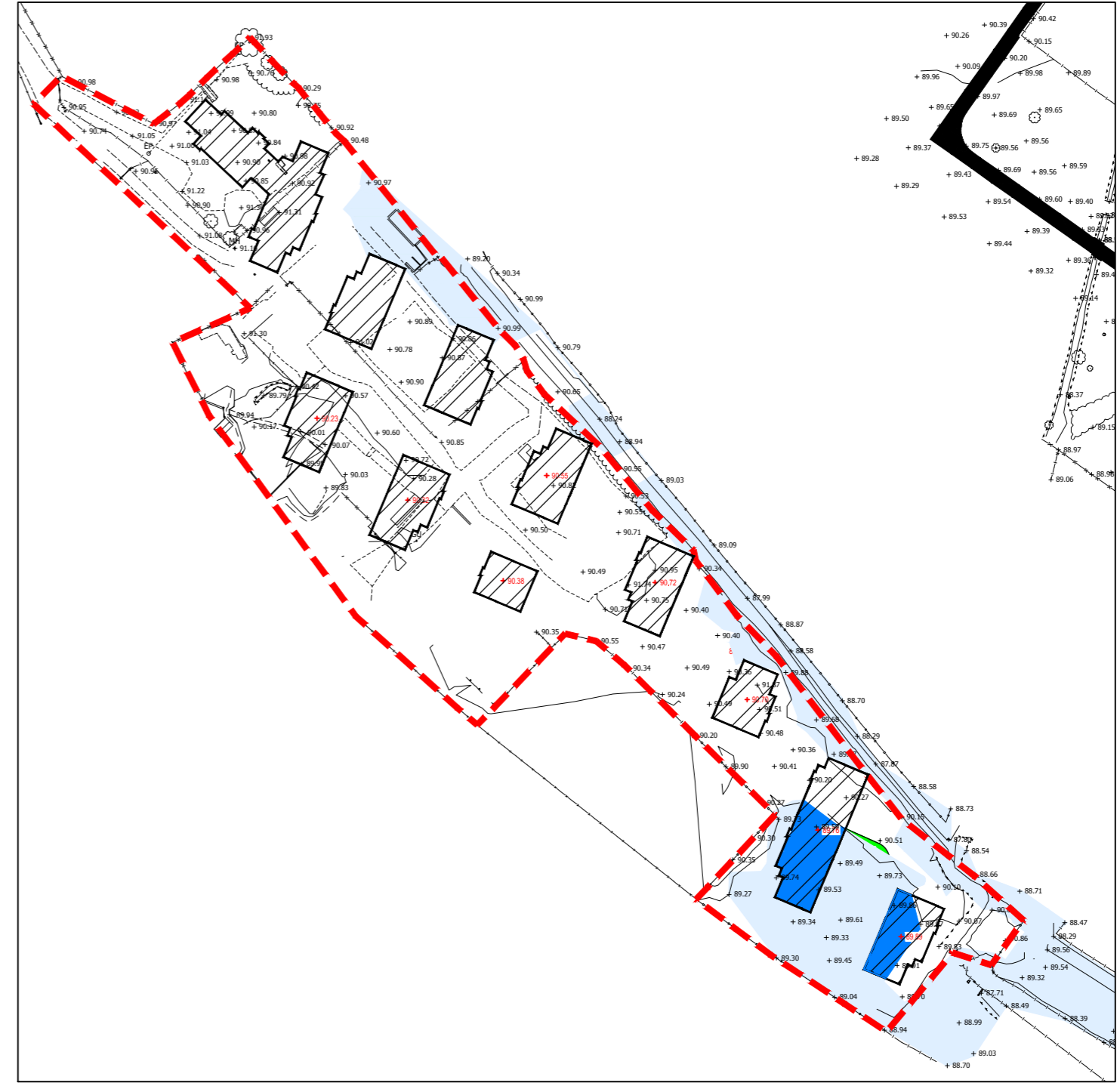

89.75m AOD CONTOUR EXISTING 8337m²



89.75m AOD CONTOUR PROPOSED 8378m²



CONSTRUCTION (DESIGN & MANAGEMENT) REGULATIONS 2015 (CDM REGULATIONS 2015)

THE PROPOSED CONCEPTUAL FLOOD RISK MITIGATION MEASURES ARE BASED ON THE FOLLOWING INFORMATION AVAILABLE AT THE TIME:

- TOPOGRAPHIC SURVEY PROVIDED BY GWP, DRAWING No. BANB1301-1A DATED FEBRUARY 2013.
- FLOOD LEVEL DATA PROVIDED BY ENVIRONMENT AGENCY IN PRODUCT 4 INFORMATION (EA REFERENCE THM, 31184, DATED DECEMBER 2016). FURTHER SITE-SPECIFIC LEVELS EXTRACTED FROM EA 'RIVER CHERWELL MODELLING STUDY' (2015) HYDRAULIC MODEL OUTPUTS (PRODUCED FOR THE BANBURY FLOOD ALLEVIATION SCHEME AS-CONSTRUCTED INVESTIGATIONS), PROVIDED BY THE EA AS PRODUCT 6 AND 7 DATA.
- PROPOSALS TAKEN FROM JSA, DRAWING No. GMSB PL-115, DATED JANUARY 2017.

AT THIS CONCEPT DESIGN STAGE IT HAS NOT BEEN POSSIBLE TO ELIMINATE ALL THE HEALTH AND SAFETY RISKS AND RESIDUAL RISKS TO THE PROPOSED GROUND WORKS, FOR EXAMPLE, IN RELATION TO THE LOCATION OF UNDERGROUND UTILITIES, GROUND CONDITIONS AND SLOPE STABILITY. SUCH RESIDUAL RISKS NEED TO BE MITIGATED AGAINST BY THE CLIENT AND COMMUNICATED TO FUTURE DESIGN TEAMS SO THAT AN ATTEMPT CAN BE MADE TO DESIGN THEM OUT AS THE DETAILED DESIGN IS PROGRESSED AND SITE CONSTRAINTS ARE FULLY UNDERSTOOD. ANY RISKS THAT ARE NOT DESIGNED OUT DURING THE DETAILED DESIGN STAGE MUST BE COMMUNICATED FURTHER TO THE CONSTRUCTION TEAM AND END USER SO THAT ADEQUATE MITIGATION MEASURES CAN BE PLANNED FOR AND MANAGED.

- KEY:**
- FLOOD EXTENT AT CONTOUR (CONTOUR LEVEL DEFINED)
 - EXISTING BUILDING TO BE REMOVED
 - SITE BOUNDARY (SHOWN INDICATIVELY)
 - PROPOSED UNDERCROFTS

- NOTES:**
1. FOR THE PURPOSES OF THE FLOOD COMPENSATION CALCULATIONS, ALL BUILDINGS INCORPORATING UNDERCROFTS (SHOWN WITH A PROPOSED GROUND LEVEL - SEE KEY) ARE ASSUMED TO HAVE 10% SOLID COLUMNS/SUPPORTS AND 90% VOIDS.

Mark	Revision	Date	Drawn	Chkd	Appd

SCALING NOTE: Do not scale from this drawing. If in doubt, ask.
 UTILITIES NOTE: The position of any existing public or private sewers, utility services, plant or apparatus shown on this drawing is believed to be correct, but no warranty to this is expressed or implied. Other such plant or apparatus may also be present but not shown. The Contractor is therefore advised to undertake their own investigation where the presence of any existing sewers, services, plant or apparatus may affect their operations.

Drawing Issue Status
FOR INFORMATION

**GRUNDON WASTE MANAGEMENT DEPOT
 BANBURY
 PROPOSED FLOOD COMPENSATION**

Client				
Date of 1st Issue	Designed	Drawn		
A1 Scale	Checked	Approved		
1:1000	RF	-		
Drawing Number		Revision		
33390/4001/005		-		

Offices throughout the UK and Europe
 www.peterbrett.com
 © Peter Brett Associates LLP
 READING
 Tel: 01189 500 761