

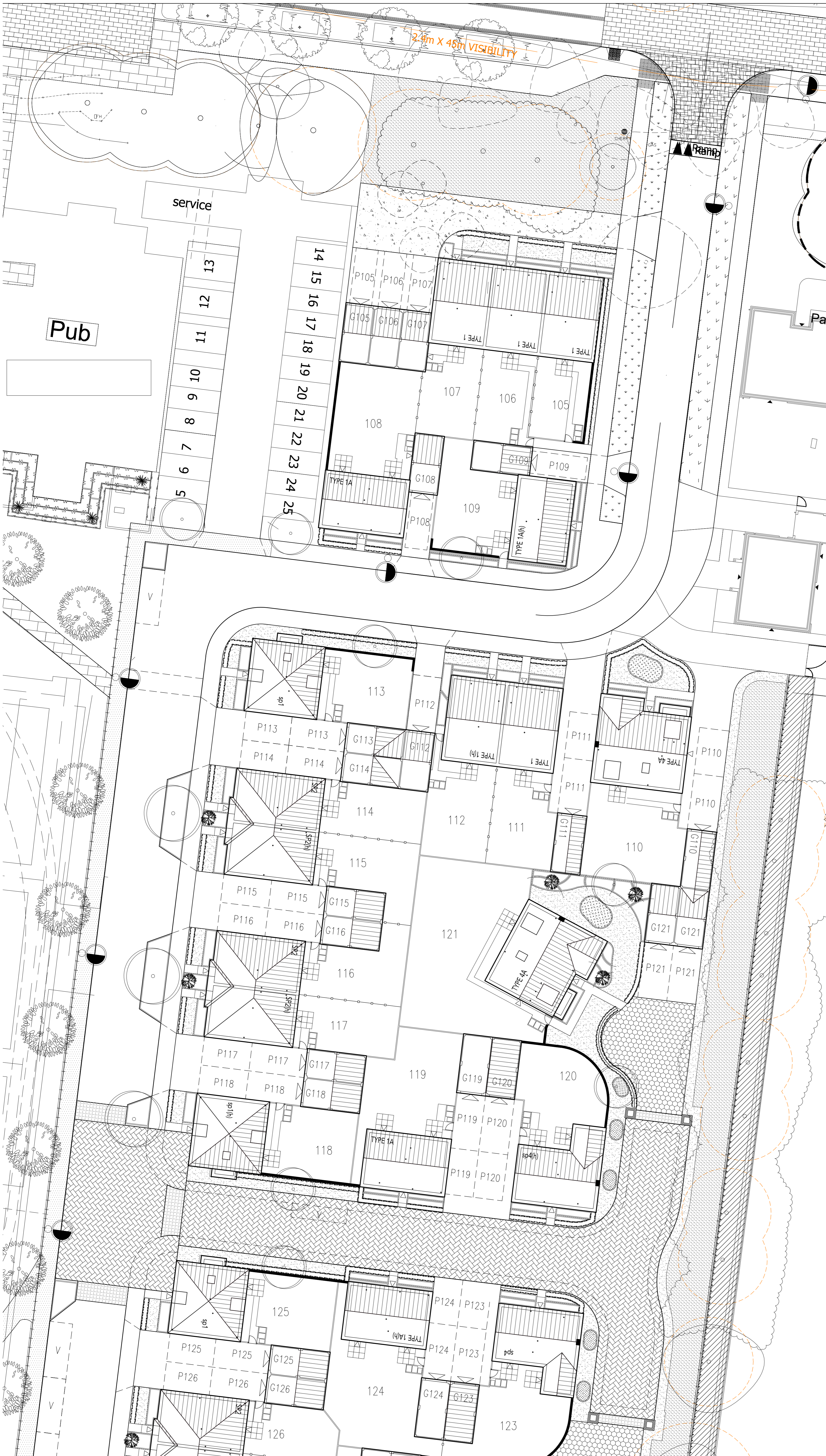

REVISIONS:

- A. 2014-10-20. Plots 9-14, 21-26 & 37-39 re-positioned and road layout in-front of those plots redesigned, sub-station relocated, gravel surface added on the private drive in front of plots 1-3 (now 105-107), shingle/stone rolled tarmac added on the private drives village green design updated, plots 6, 17, 18 swapped with type 4A and side access to plot 29 amended, Plot 20 & 36 handed and plots 1-50 renumbered as 105-154 to suit with other parcels following Local Authority's comments. SRS
- B. 2014-10-29. The frontal projections on plots 114-117, 126-129, 142 & 149 made 300mm wider, garages for plots 115-118, 125-130, 141 & 42 made eaves fronted, roof form on plots 112-114 changed, plot 139 re-aligned and plot 109 handed following Local Authority's comments. SRS
- C. 2014-11-11. The footprints for SP1 on plots 113, 118, 125, 130, 131 & 141 made 350mm wider & deeper, plots 119 & 124 repositioned and the extra visitor's space in front of plot 113 taken off, following client's request. SRS
- D. 2014-11-23. Plot 122 is re-positioned & substituted with a SP5, plot 138 is substituted with a Type 1A, plot 140 is substituted with a SP1, plots 134 & 154 is substituted with a rear version of Type 1A and necessary layout amendment carried out following these amendments, as per Local Authority's comments. SRS
- D. 2014-12-05. Plots 122, 133-135, and 154 repositioned to avoid existing trees at Tree Officer's request. Display of visibility splay with Camp Road clarified. DJE



LEGEND			
EXISTING VEGETATION			
	EXISTING TREE TO BE RETAINED		EXISTING RPA
	EXISTING HEDGEROW		EXISTING HEDGEROW & TREES REMOVED
EXTERNAL BOUNDARY TREATMENTS			
	1800mm HIGH SCREEN WALL (REFER TO MATERIALS LAYOUT 0521-108 FOR MATERIALS)		600mm HIGH SCREEN WALL (REFER TO MATERIALS LAYOUT 0521-108 FOR MATERIALS)
	1800mm HIGH CLOSE BOARD TIMBER FENCE		RETAINING WALL (REFER TO DETAILED ENGINEERING DRAWINGS)
	900mm HIGH PIER (REFER TO MATERIALS LAYOUT 0521-108 FOR MATERIALS)		1800mm HIGH PIER (REFER TO MATERIALS LAYOUT 0521-108 FOR MATERIALS)
	1800mm HIGH PLOT DIVISION PANEL FENCE		1800mm HIGH TIMBER SIDE ACCESS GATE
	1500mm HIGH POST & RAIL FENCE		300mm HIGH TIMBER KNEE RAIL
NUMBERING			
12	PLOT NUMBERS	G12	GARAGE NUMBERS
P12	PARKING NUMBERS	V	VISITOR PARKING
(h)	PLOT HANDING	C	CASUAL PARKING
MISCELLANEOUS			
	CHIMNEY		GARAGE ACCESS
	HANDED UNIT		PERSONNEL ACCESS
GROUND SURFACING			
	BLOCK PAVING-1		RUMBLE STRIP
	TARMAC		SHINGLE / STONE ROLLED TARMAC
	GRAVEL		1800mm x 1800mm PATIO SLABS
	BIN SLAB		
LANDSCAPING			
	PROPOSED NEW TREE (REFER TO SEPARATE LANDSCAPING DRAWINGS FOR EXACT DETAILS)		PROPOSED HEDGEROW (REFER TO SEPARATE LANDSCAPING DRAWINGS FOR EXACT DETAILS)
	PROPOSED SHRUB OR HERBACEOUS PLANTING (REFER TO SEPARATE LANDSCAPING DRAWINGS FOR EXACT DETAILS)		PROPOSED GRASS PLANTING (REFER TO SEPARATE LANDSCAPING DRAWINGS FOR EXACT DETAILS)
ENGINEERING			
	FFL 121.450 (REFER TO DETAILED ENGINEERING DRAWINGS)		PROPOSED DRAINAGE PITS (REFER TO DETAILED ENGINEERING DRAWINGS)
			STORM WATER STORAGE (REFER TO DETAILED ENGINEERING DRAWINGS)

