

PHASE 3, HEYFORD PARK, UPPER HEYFORD, BICESTER

This drawing is the copyright of Focus On Design which is a trading name for Focus Design Partnership Limited. No liability will be accepted for amendments by others to either the printed or digital format.



REVISIONS:

- A. 2014-10-20. Layout amended following changes made to the planning layout REV A. SRS
- B. 2014-10-29. Layout amended following changes made to the planning layout REV B. SRS
- C. 2011-11-23. Layout amended following changes made to the planning layout REV C. SRS
- D. 2014-12-05. Plots 122, 133-135, and 154 repositioned to avoid existing trees at Tree Officer's request. DJE
- E. 2015-01-09. Title amended to Phase 3 from Phase 2 at client's request. AJA
- F. 2015-01-23. Bay window removed from HT 4A at client's request. DJE
- G. 2015-02-24. Layout amended following changes made to the planning layout REV I. SRS
- H. 2015-03-25. Garages for plots 137, 143 & 144 relocated & road layout in front of plots 142-144 amended, following client's comments. SRS

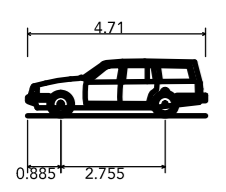
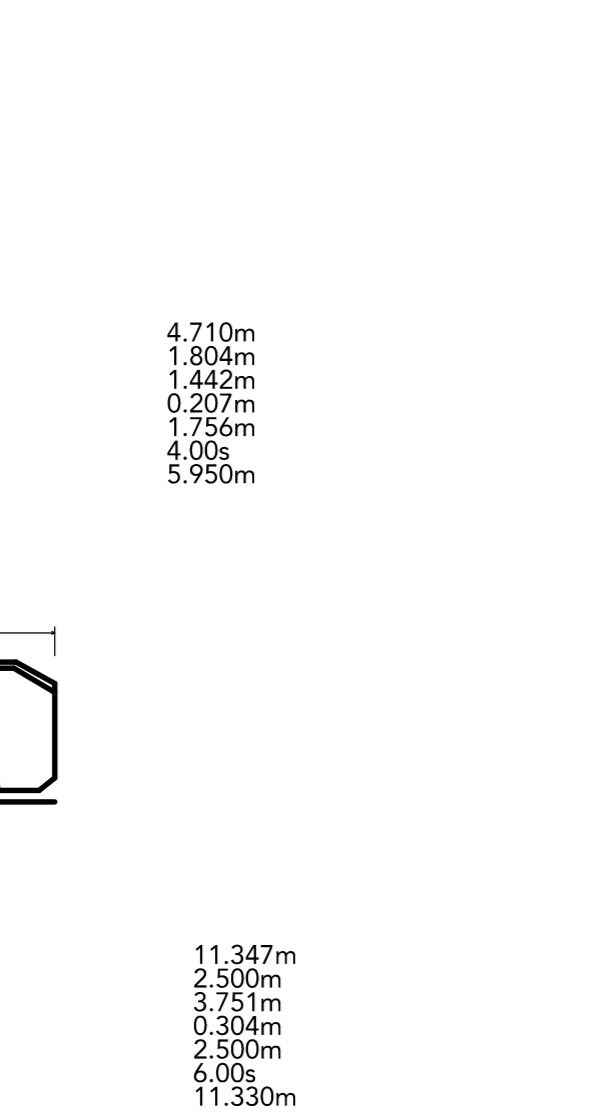
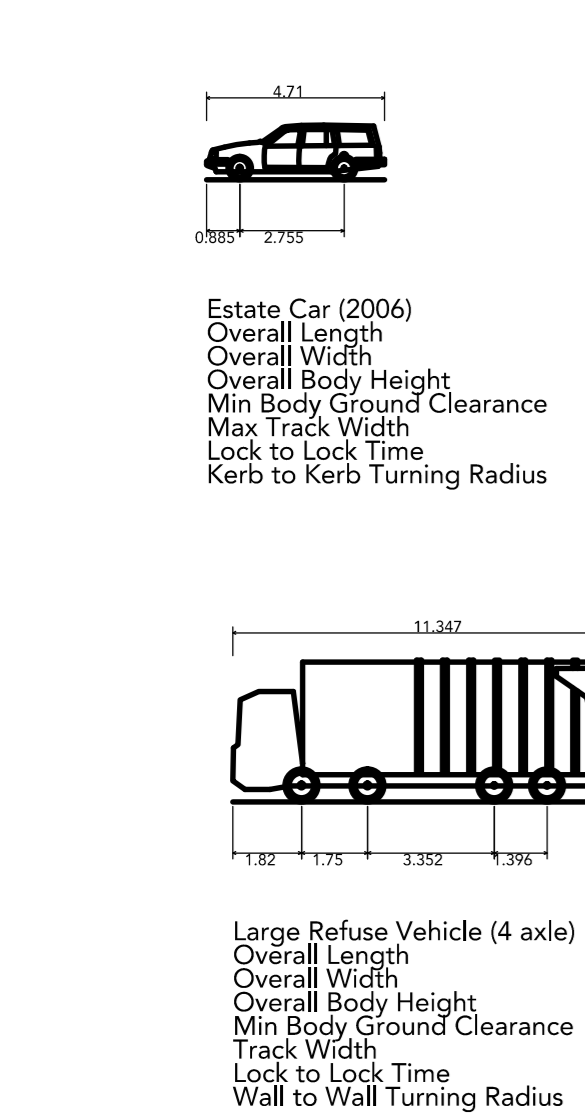
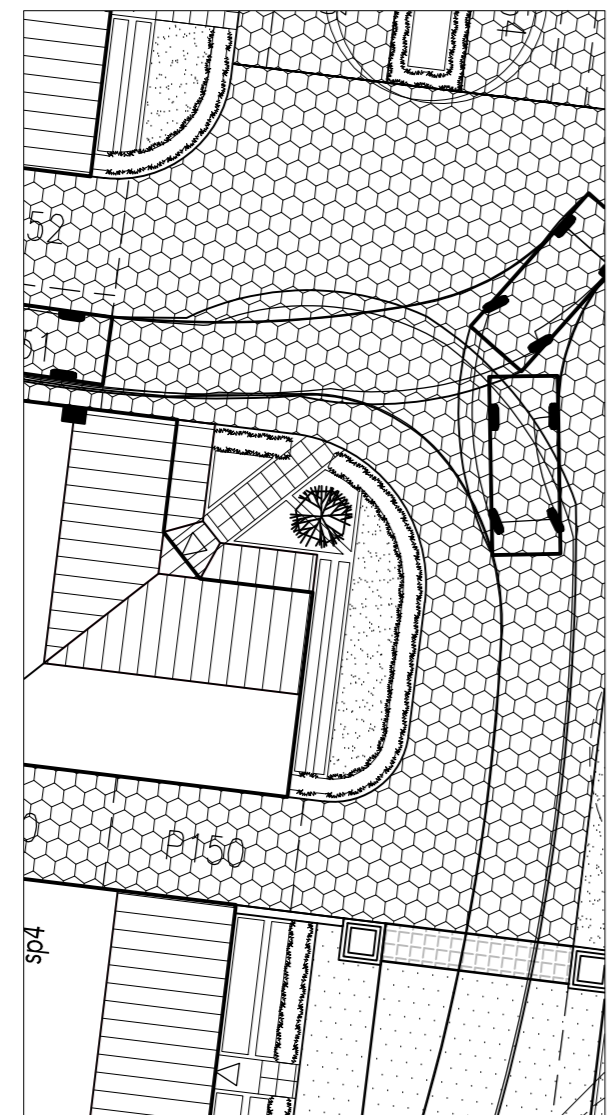
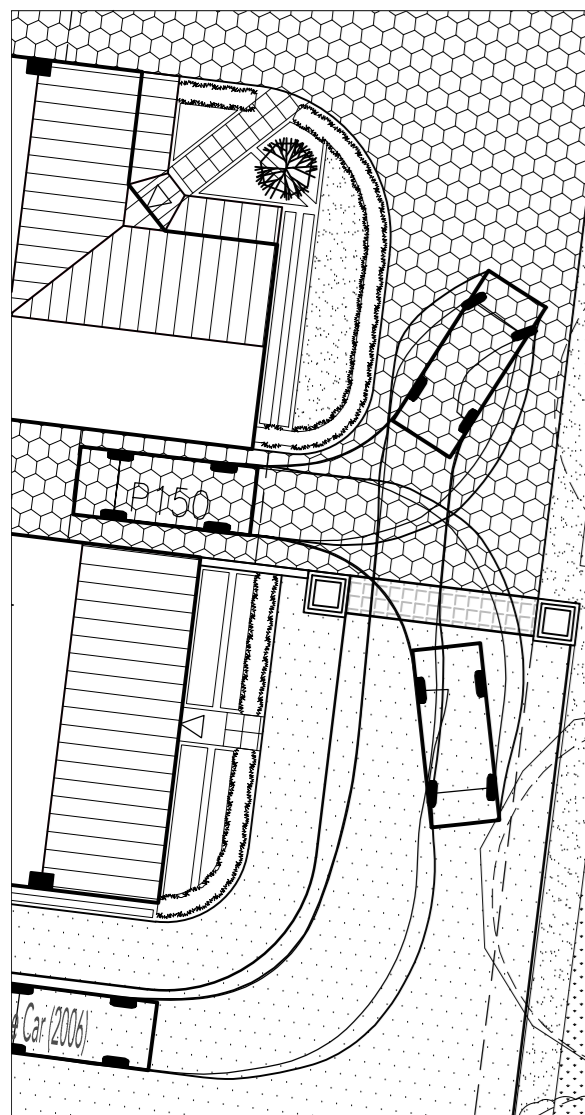
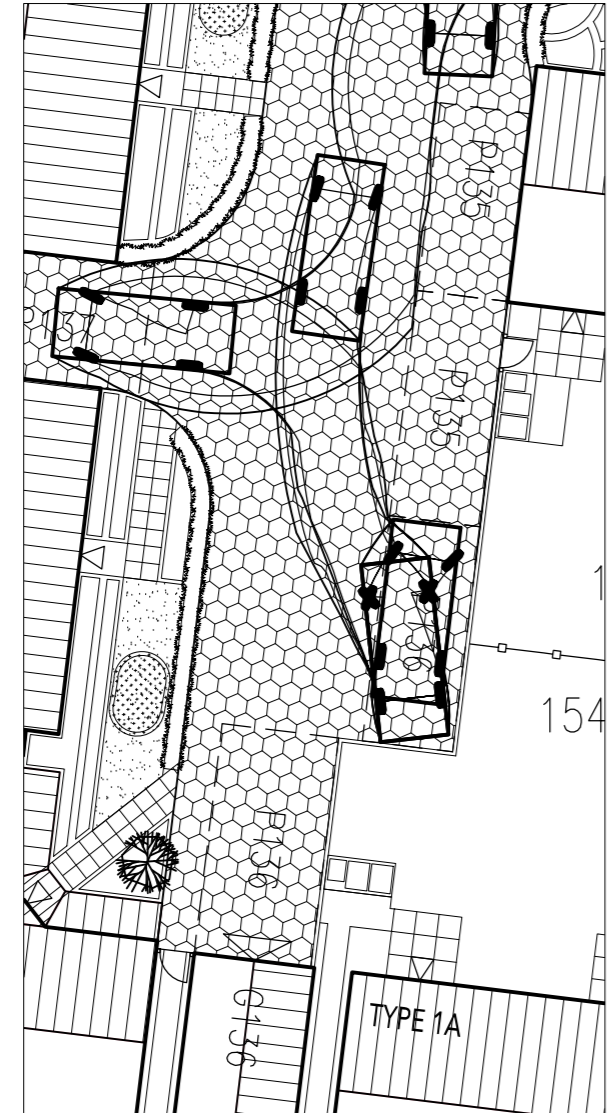
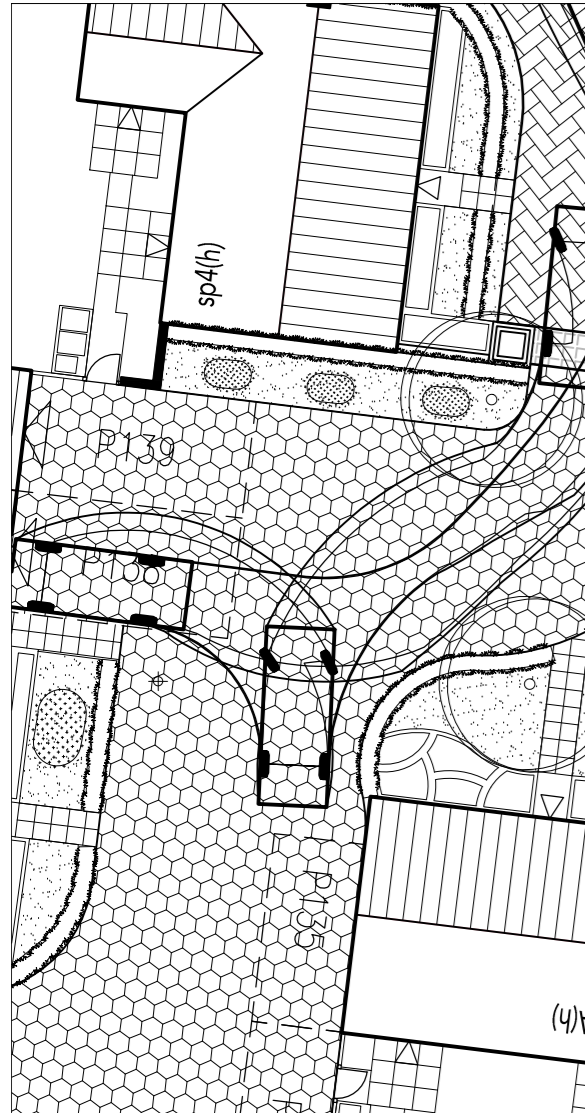
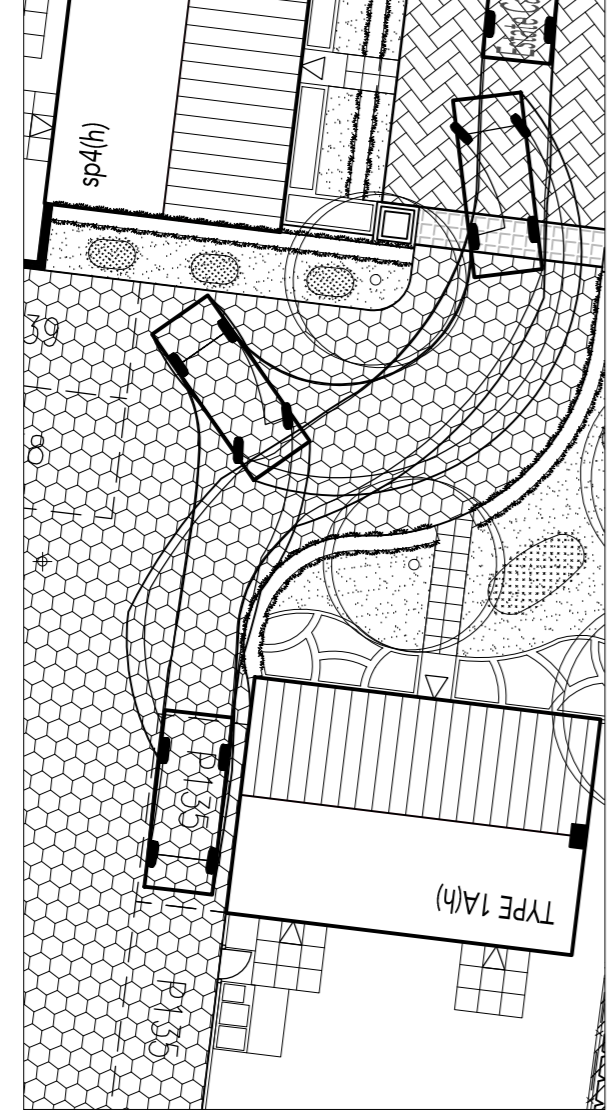
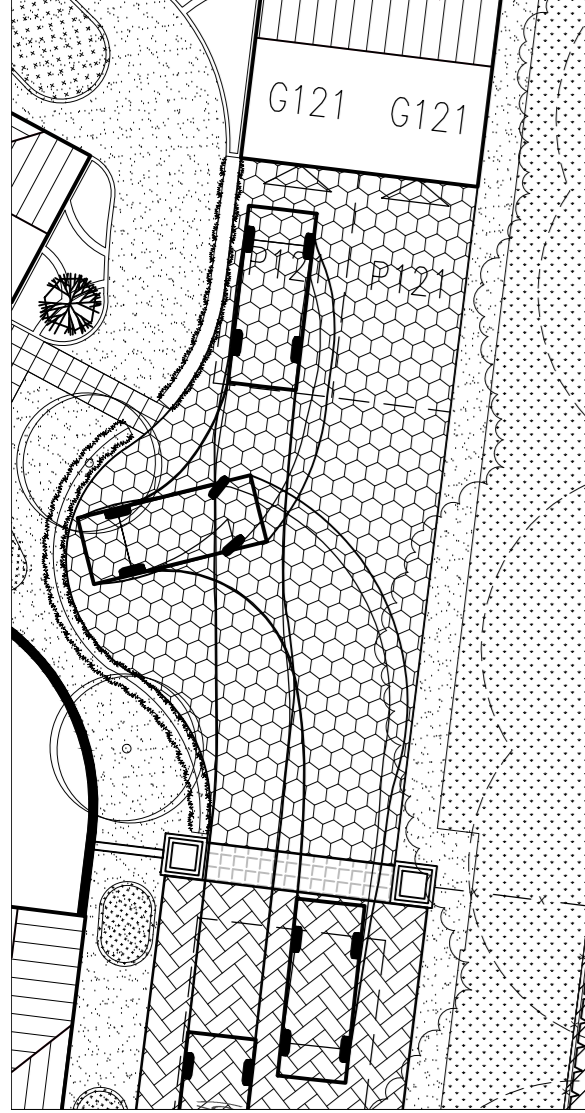

Estate Car (2006)
 Overall Length 4.710m
 Overall Width 1.804m
 Overall Body Height 1.442m
 Min Body Ground Clearance 0.207m
 Max Track Width 1.756m
 Lock to Lock Time 4.00s
 Kerb to Kerb Turning Radius 5.950m

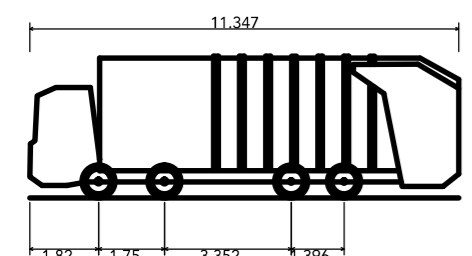

Large Refuse Vehicle (4 axle)
 Overall Length 11.347m
 Overall Width 2.500m
 Overall Body Height 3.751m
 Min Body Ground Clearance 0.304m
 Track Width 2.500m
 Lock to Lock Time 6.00s
 Wall to Wall Turning Radius 11.330m

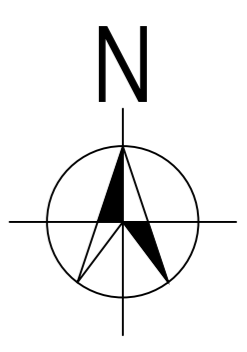

SCALE: 1:500

VEHICLE TRACKING LAYOUT

SCALE: 1:200 @ A1

DATE: AUGUST 2014

DRAWING TITLE: VEHICLE TRACKING LAYOUT

THE OLD BREWERY, LODWAY, PILL, BRISTOL BS20 0DH
 t:01275 813380 f:01275 813381 e:admin@focusdp.com



www.focusdp.com