

# PHASE 2, HEYFORD PARK, UPPER HEYFORD, BICESTER

This drawing is the copyright of Focus On Design which is a trading name for Focus Design Partnership Limited. No liability will be accepted for amendments by others to either the printed or digital format.

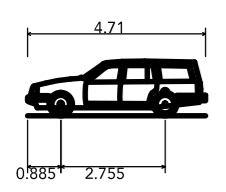

REVISIONS:

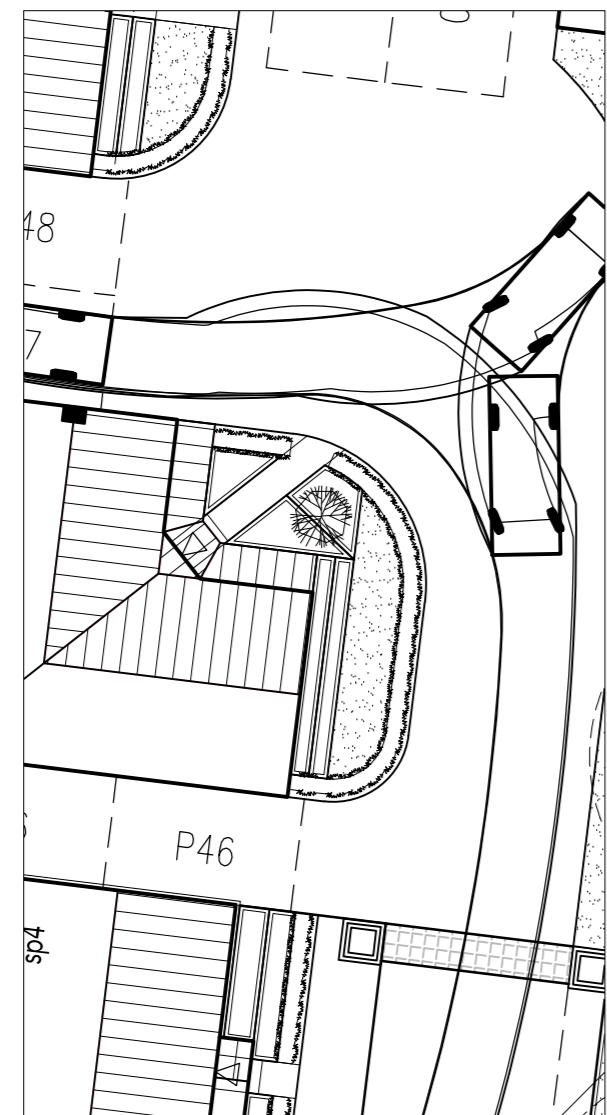
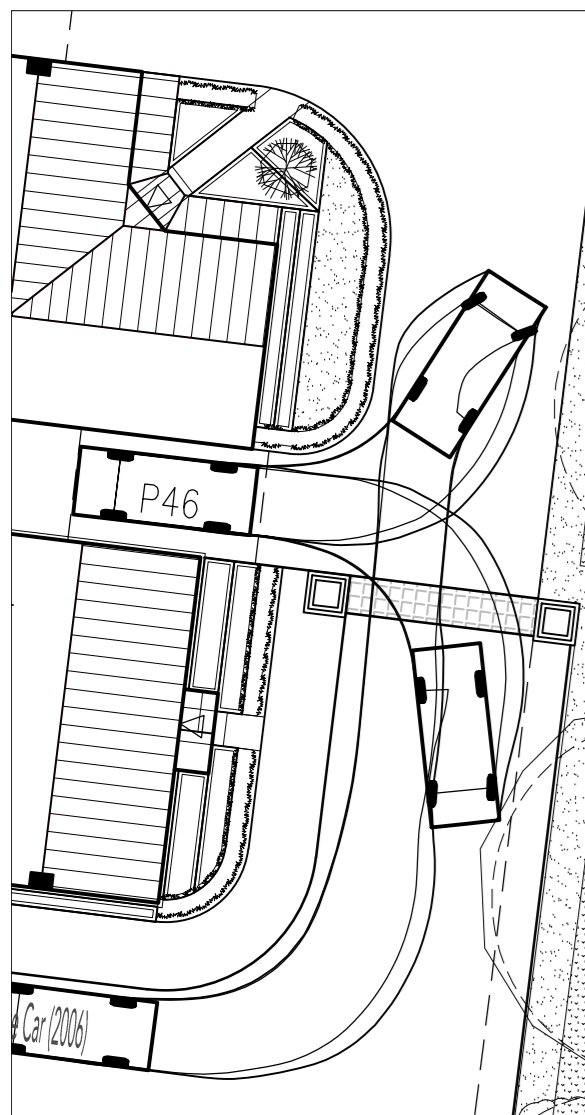
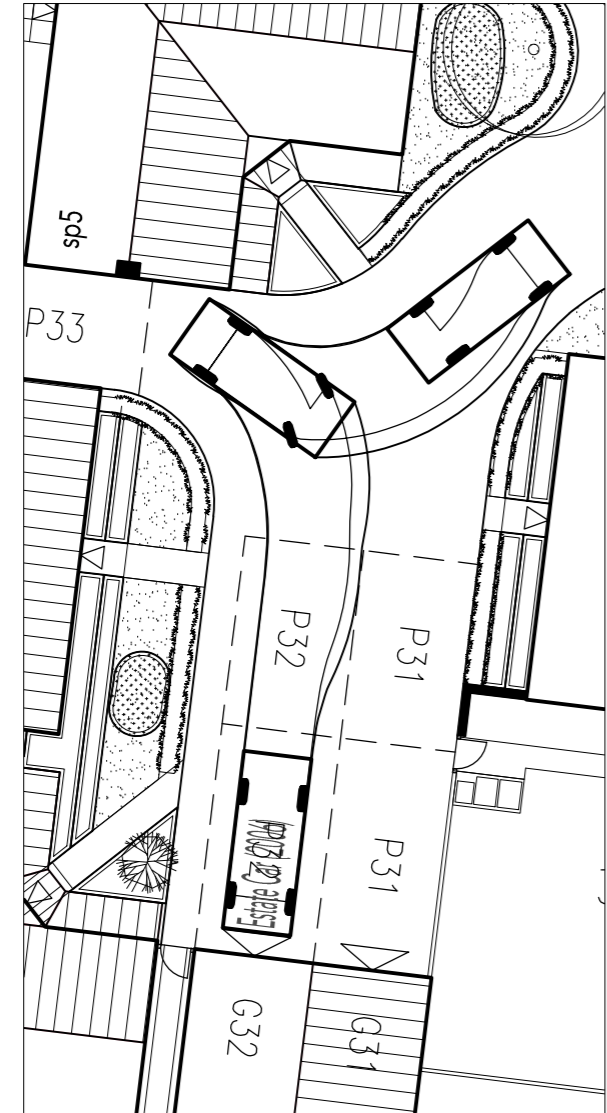
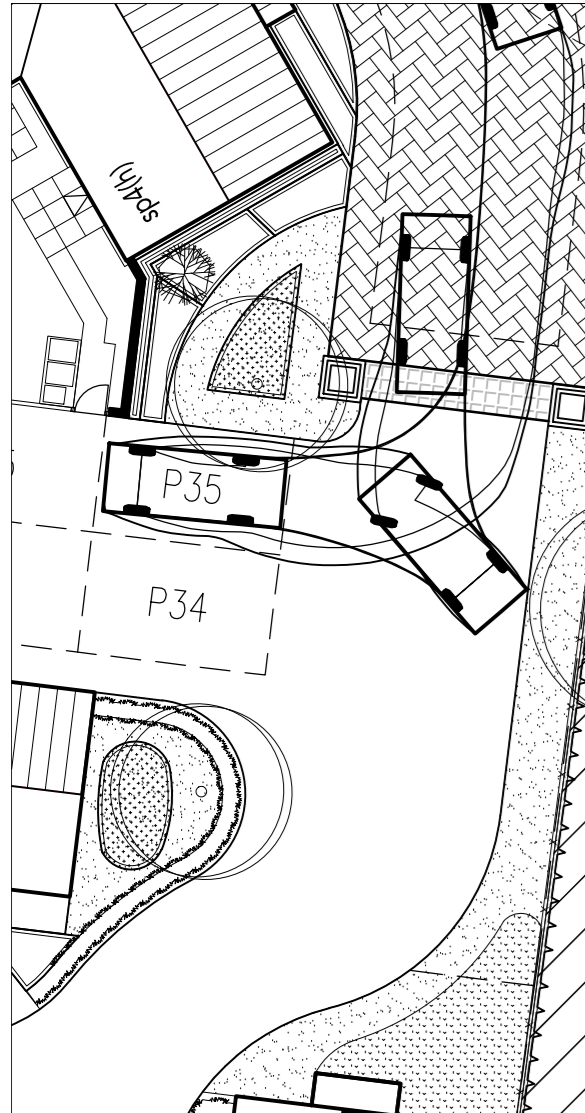
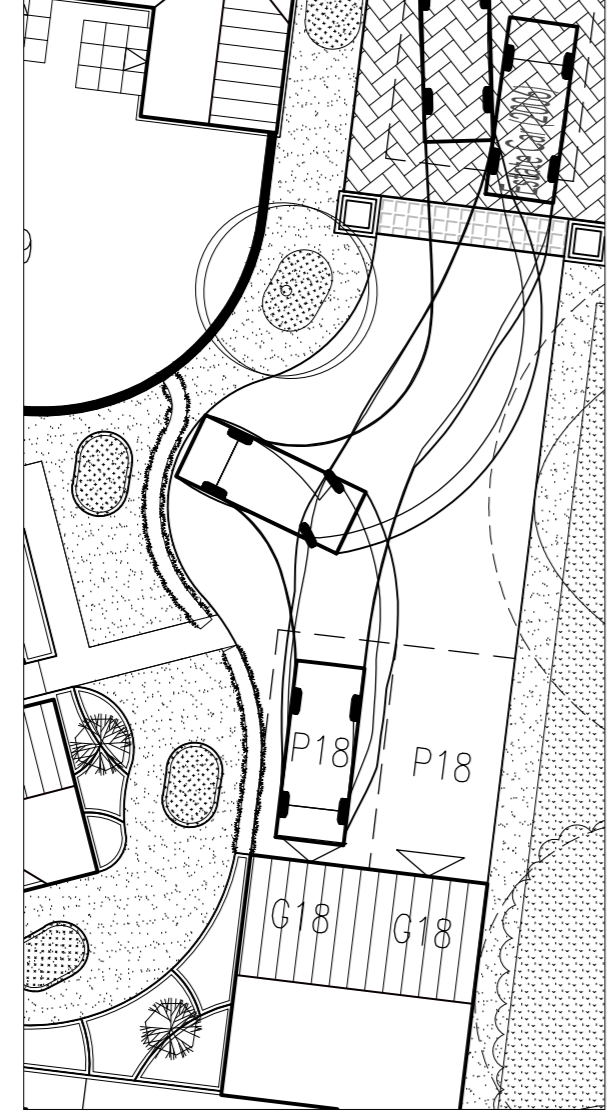
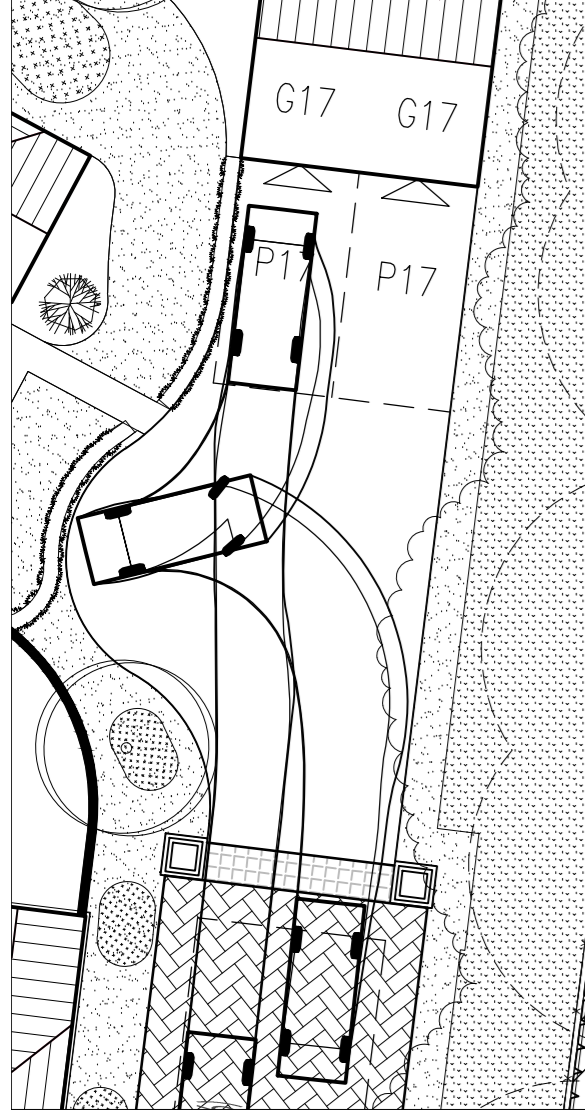

Estate Car (2006)  
 Overall Length 4.710m  
 Overall Width 1.804m  
 Overall Body Height 1.442m  
 Min Body Ground Clearance 0.207m  
 Max Track Width 1.756m  
 Lock to Lock Time 4.00s  
 Kerb to Kerb Turning Radius 5.950m

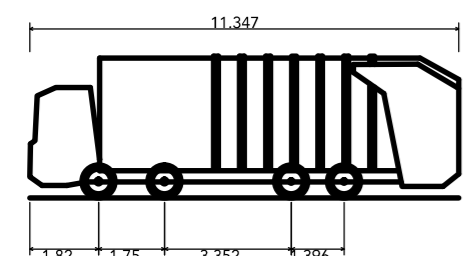

Large Refuse Vehicle (4 axle)  
 Overall Length 11.347m  
 Overall Width 2.500m  
 Overall Body Height 3.751m  
 Min Body Ground Clearance 0.304m  
 Track Width 2.500m  
 Lock to Lock Time 6.00s  
 Wall to Wall Turning Radius 11.330m

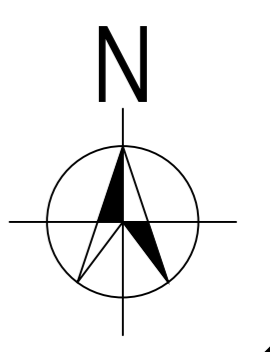

SCALE: 1:500  
 0 5 10m

## VEHICLE TRACKING LAYOUT

SCALE: 1:200 @ A1  
 0 5 10m

DATE: AUGUST 2014  
 DRAWN: SRS

DRAWING TITLE: VEHICLE TRACKING LAYOUT  
 DRAWING NO: 0521-105

THE OLD BREWERY, LODWAY, PILL, BRISTOL BS20 0DH  
 t:01275 813380 f:01275 813381 e:admin@focusdp.com

