

**LEGEND**

- ▲ Category A trees
- ◆ Category B trees
- Category C trees
- Category U trees or trees for removal
- Root Protection Area
- Tree Crown Spread
- Indicative Site Boundary

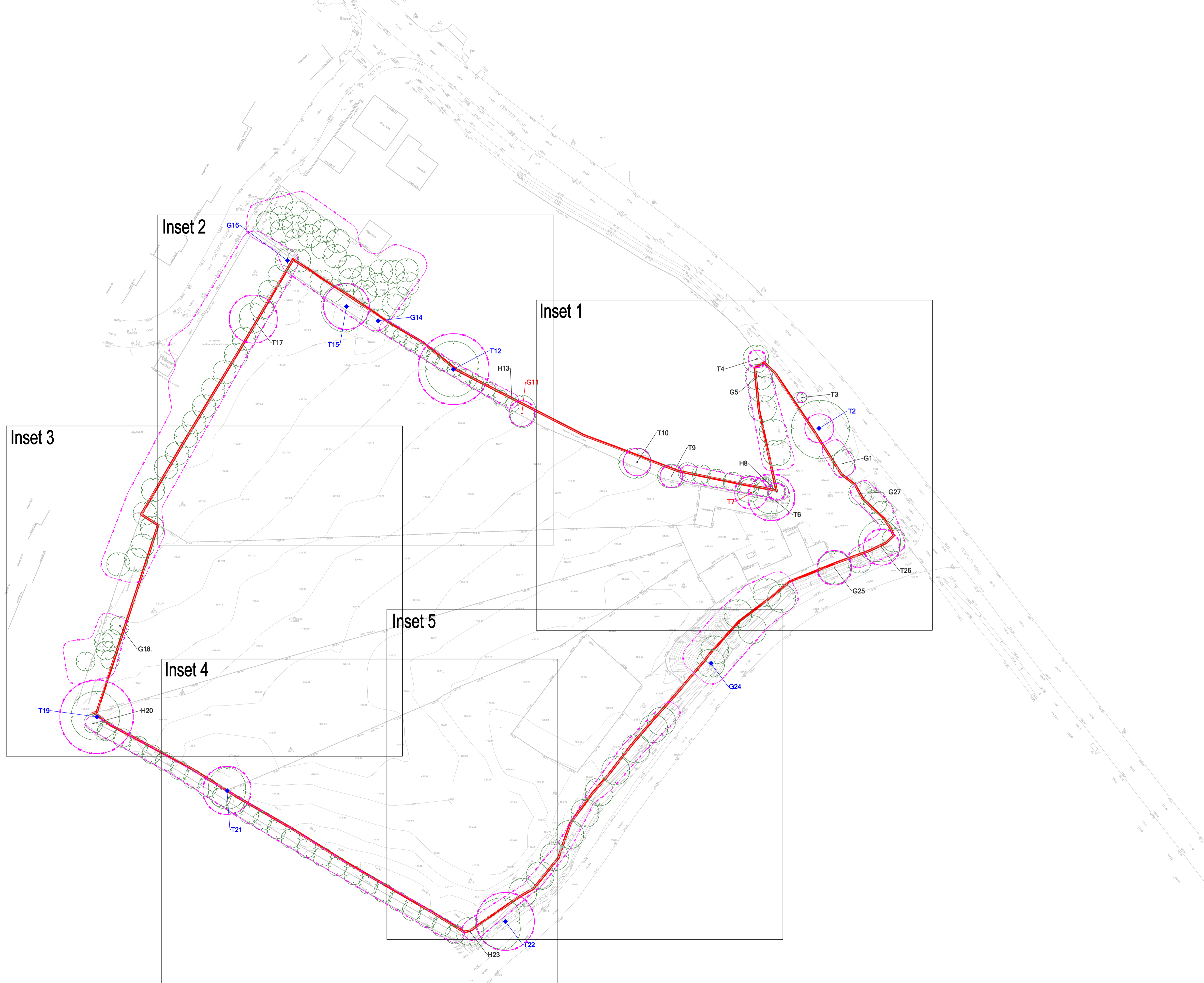

**LOCKHART GARRATT**

TITLE: Tree Constraints Plan - Overview

PROJECT: Land off Fewcott Road, Fritwell

CLIENT: Cala Homes (Chiltem) Ltd

MAP REF: 3849/06/D/15-1371

REVISION: 2

DATE: 10/06/16 SCALE: Not to scale@A1

APPROVED BY: RD PRODUCED BY: SW





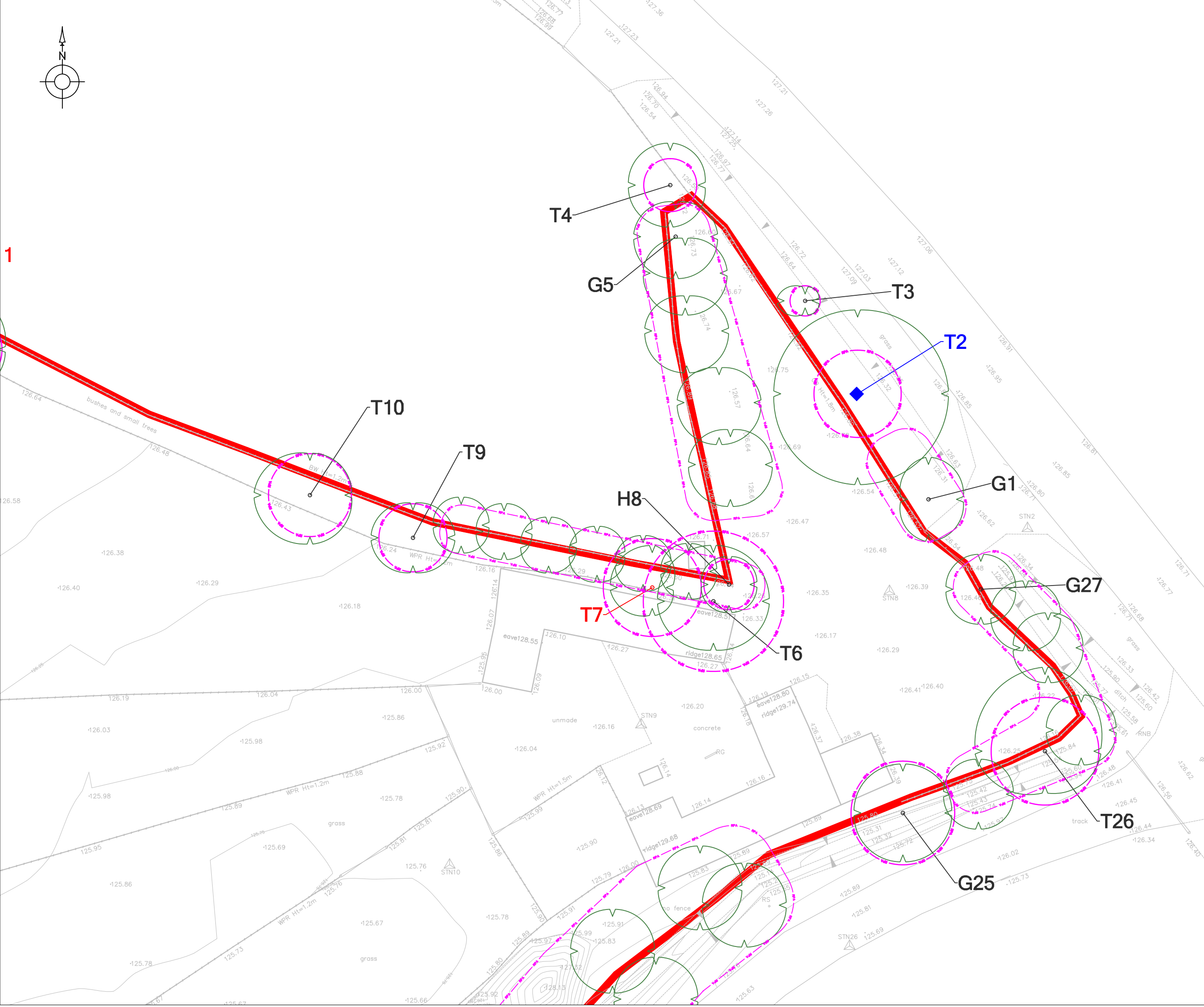
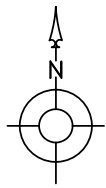

Reproduction with the permission of The Controller of the Stationery Office Crown Copyright ©. Crown Copyright ©. © 2016 Lockhart Garratt Ltd. All Rights Reserved. Copying without the permission of Lockhart Garratt Ltd. is prohibited.

7-8 Malpas Road, Chipping Norton, Oxfordshire, OX7 5EJ  
7-8 Malpas Road, Chipping Norton, Oxfordshire, OX7 5EJ





**LEGEND**

-  Category A trees
-  Category B trees
-  Category C trees
-  Category U trees or trees for removal
-  Root Protection Area
-  Tree Crown Spread
-  Indicative Site Boundary

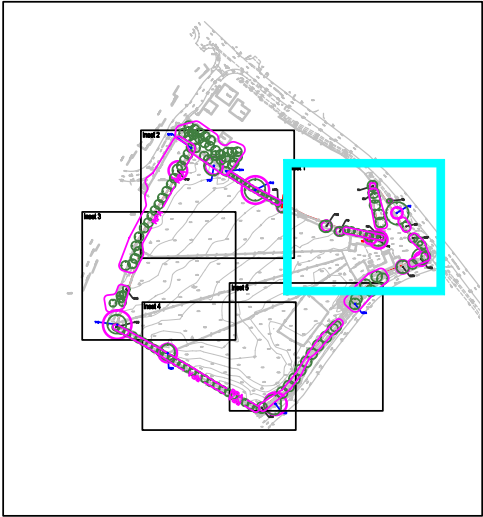

TITLE: <b>Tree Constraints Plan - Plan 1</b>	
PROJECT/SITE: <b>Land off Fewcott Road, Fritwell</b>	
CLIENT: <b>Cala Homes (Chiltern) Ltd</b>	
MAP REF: <b>3849/06/D15-1371</b>	
REVISION: <b>2</b>	
DATE: <b>10/06/16</b>	SCALE: <b>1:250@A3</b>
APPROVED BY: <b>RD</b>	PRODUCED BY: <b>SW</b>

Reproduction with the permission of The Controller of Her Majesty's Stationary Office Crown Copyright (c) Licence number: AL 52251A000 Lockhart Garratt Ltd 8 Melbourn House, Corbygate Business Park, Weldon, Corby, Northants NN17 5JG. Not to be reproduced without the permission of Lockhart Garratt Ltd

7 - 8 Melbourn House Corbygate Business Park Weldon, Corby Northamptonshire NN17 5JG 01536 408840	7 Astley House Cromwell Business Park Chipping Norton Oxfordshire OX7 5SR 01808 648857
---	--

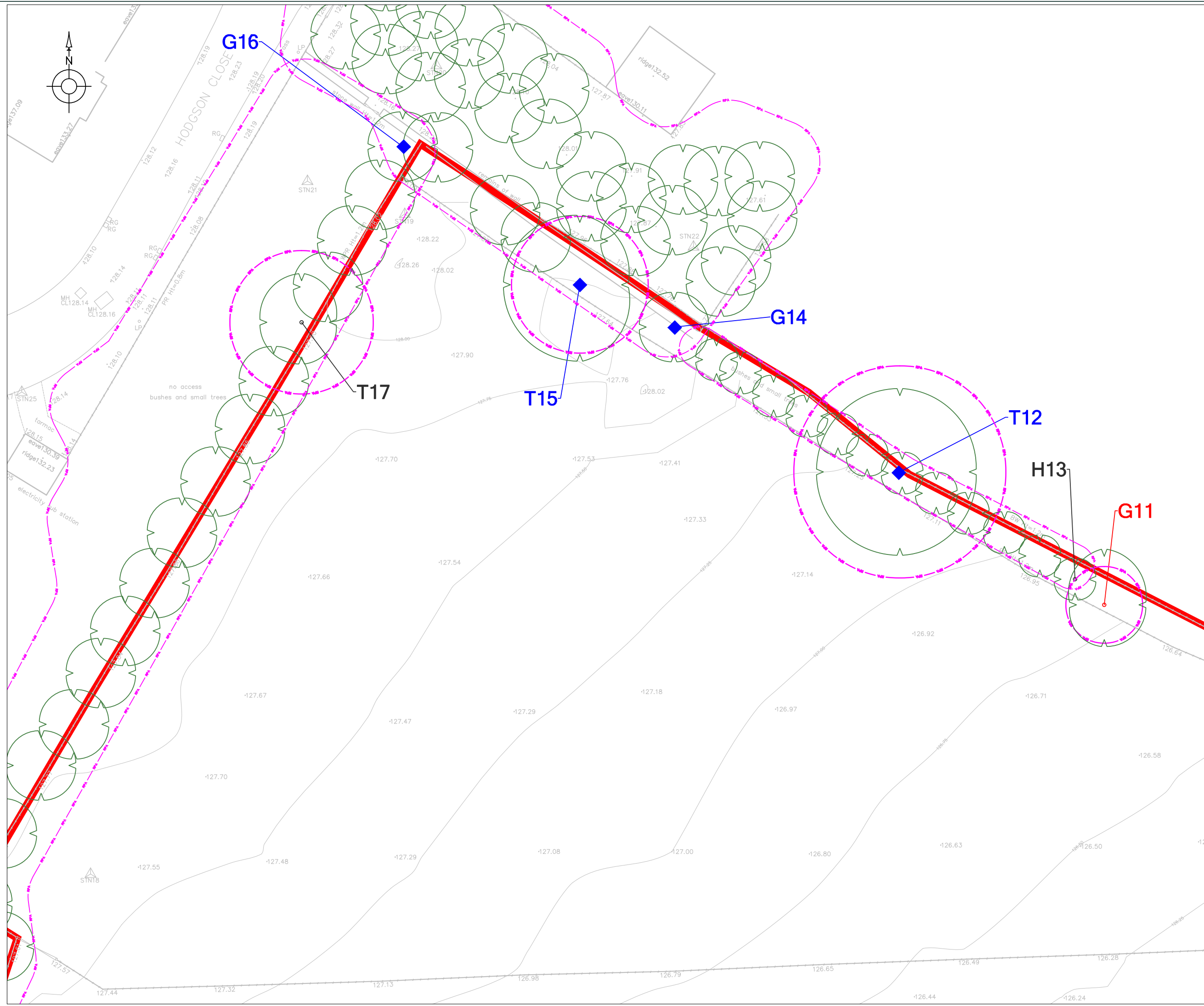

**LEGEND**

- ▲ Category A trees
- ◆ Category B trees
- Category C trees
- Category U trees or trees for removal
- Root Protection Area
- Tree Crown Spread
- Indicative Site Boundary

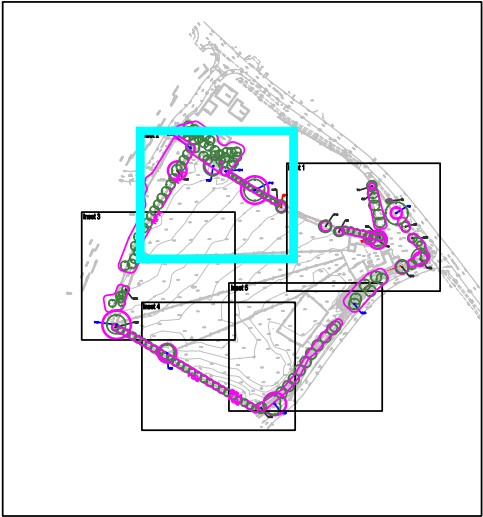

TITLE: <b>Tree Constraints Plan - Plan 2</b>	
PROJECT/SITE: <b>Land off Fewcott Road, Fritwell</b>	
CLIENT: <b>Cala Homes (Chiltern) Ltd</b>	
MAP REF: <b>3849/06/D15-1371</b>	
REVISION: <b>2</b>	
DATE: <b>10/06/16</b>	SCALE: <b>1:250@A3</b>
APPROVED BY: <b>RD</b>	PRODUCED BY: <b>SW</b>

Reproduction with the permission of The Controller of Her Majesty's Stationary Office Crown Copyright (c) Licence number: AL 52261A00 Lockhart Garratt Ltd 8 Melbourn House, Corbygate Business Park, Weldon, Corby, Northants NN17 5JG. Not to be reproduced without the permission of Lockhart Garratt Ltd

<p><small>7 - 8 Melbourn House Corbygate Business Park Weldon, Corby Northamptonshire NN17 5JG 01538 408840</small></p>	<p><small>7 Astley House Cromwell Business Park Chipping Norton Oxfordshire OX7 5SR 01808 648657</small></p>
---	--

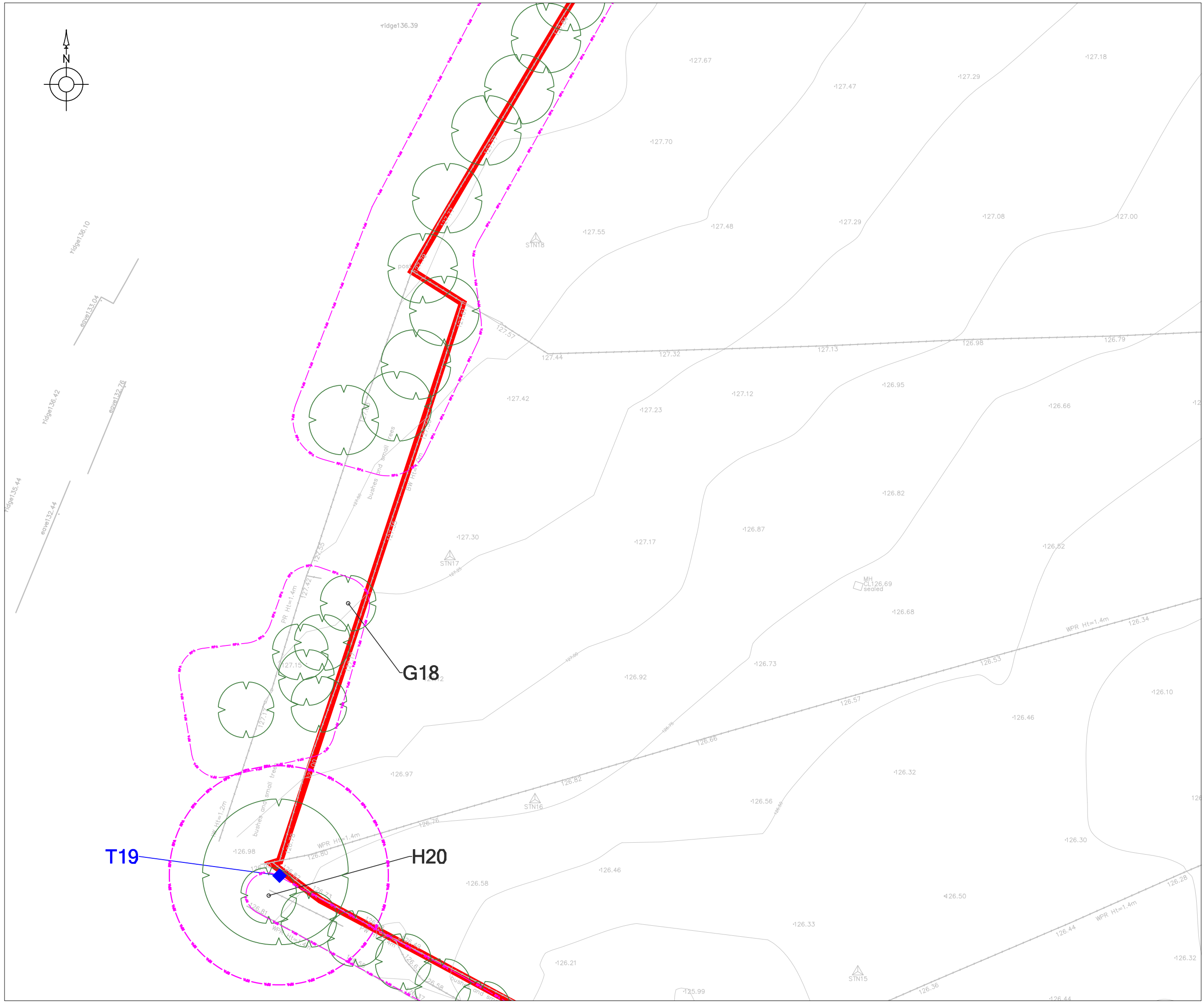
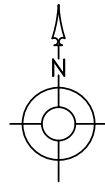

### LEGEND

- ▲ Category A trees
- ◆ Category B trees
- Category C trees
- Category U trees or trees for removal
- Root Protection Area
- Tree Crown Spread
- Indicative Site Boundary

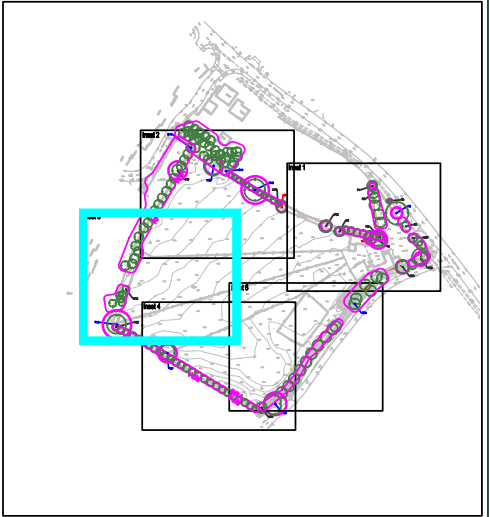

TITLE: <b>Tree Constraints Plan - Plan 3</b>	
PROJECT/SITE: <b>Land off Fewcott Road, Fritwell</b>	
CLIENT: <b>Cala Homes (Chiltern) Ltd</b>	
MAP REF: <b>3849/06/D15-1371</b>	
REVISION: <b>2</b>	
DATE: <b>10/06/16</b>	SCALE: <b>1:250@A3</b>
APPROVED BY: <b>RD</b>	PRODUCED BY: <b>SW</b>

Reproduction with the permission of The Controller of Her Majesty's Stationery Office Crown Copyright (c) Licence number: AL 52251A000 Lockhart Garratt Ltd 8 Melbourn House, Corbygate Business Park, Weldon, Corby, Northants NN17 5JG. Not to be reproduced without the permission of Lockhart Garratt Ltd

<p><small>7 - 8 Melbourn House Corbygate Business Park Weldon, Corby Northamptonshire NN17 5JG 01536 408840</small></p>	<p><small>7 Astley House Cromwell Business Park Chipping Norton Oxfordshire OX7 5SR 01808 648857</small></p>
---	--



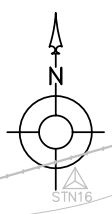
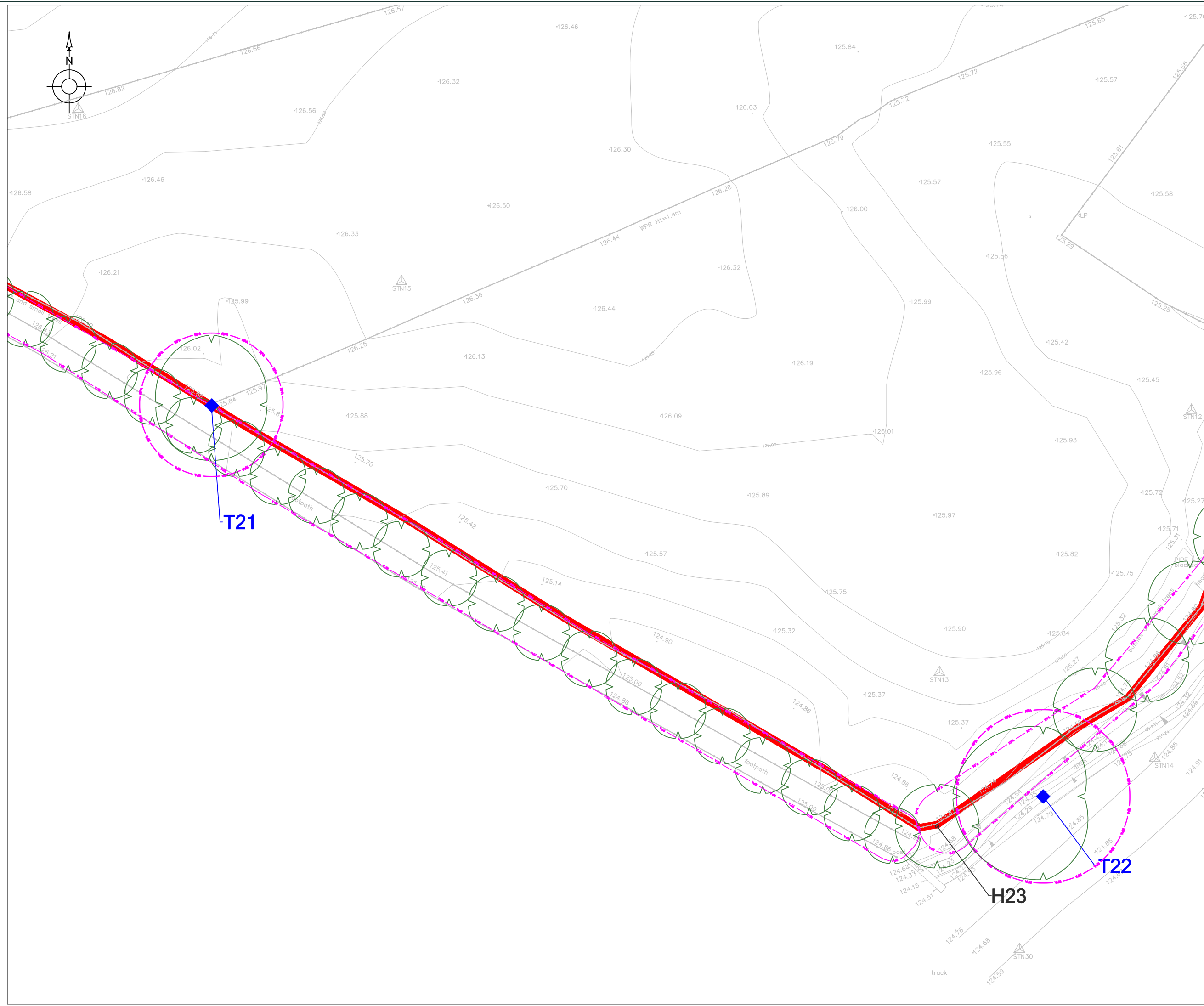

**LEGEND**

- ▲ Category A trees
- ◆ Category B trees
- Category C trees
- Category U trees or trees for removal
- Root Protection Area
- Tree Crown Spread
- Indicative Site Boundary

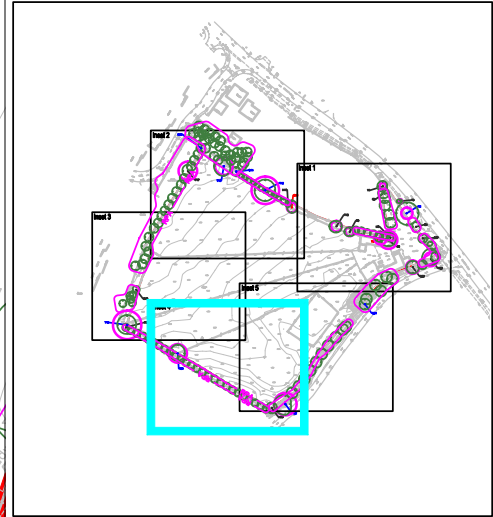

TITLE: <b>Tree Constraints Plan - Plan 4</b>	
PROJECT/SITE: <b>Land off Fewcott Road, Fritwell</b>	
CLIENT: <b>Cala Homes (Chiltern) Ltd</b>	
MAP REF: <b>3849/06/D15-1371</b>	
REVISION: <b>2</b>	
DATE: <b>10/06/16</b>	SCALE: <b>1:250@A3</b>
APPROVED BY: <b>RD</b>	PRODUCED BY: <b>SW</b>

Reproduction with the permission of The Controller of Her Majesty's Stationary Office Crown Copyright (c) Licence number: AL 52281A000 Lockhart Garratt Ltd 8 Melbourn House, Corbygate Business Park, Weldon, Corby, Northants NN17 5JG. Not to be reproduced without the permission of Lockhart Garratt Ltd

<p><small>7 - 8 Melbourn House Corbygate Business Park Weldon, Corby Northamptonshire NN17 5JG 01536 408840</small></p>	<p><small>7 Astley House Cromwell Business Park Chipping Norton Oxfordshire OX7 5SR 01608 648857</small></p>
---	--

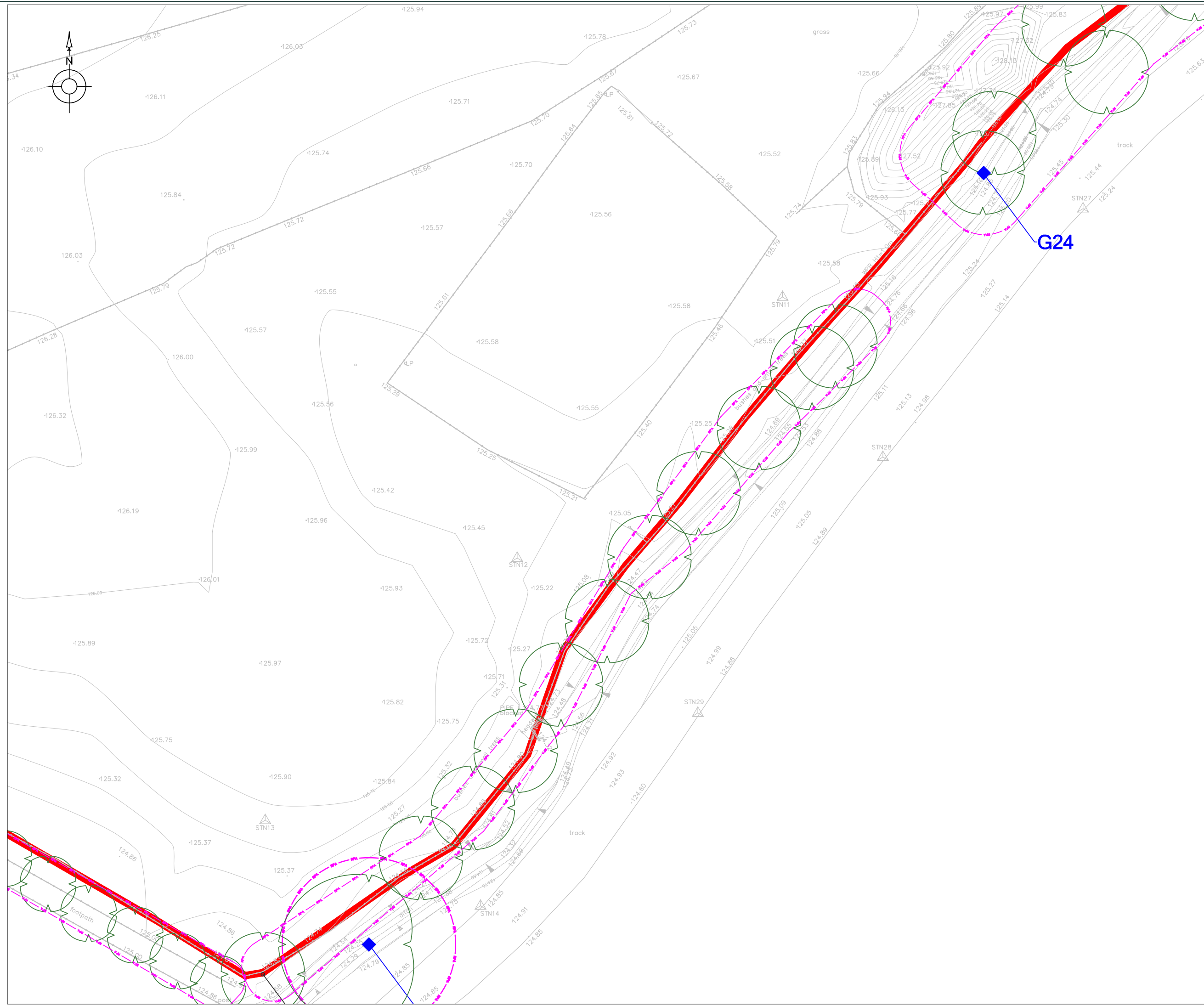

**LEGEND**

- ▲ Category A trees
- ◆ Category B trees
- Category C trees
- Category U trees or trees for removal
- Root Protection Area
- Tree Crown Spread
- Indicative Site Boundary

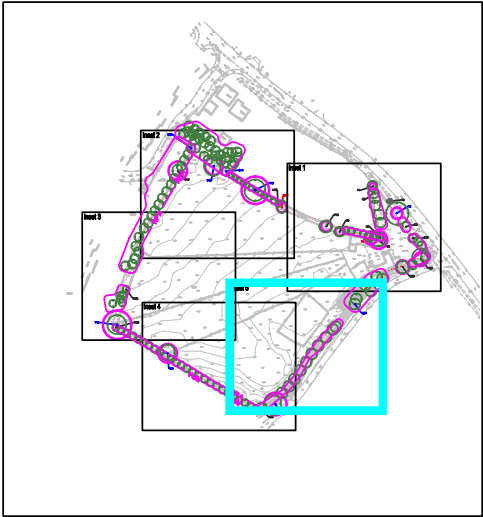

TITLE: <b>Tree Constraints Plan - Plan 5</b>	
PROJECT/SITE: <b>Land off Fewcott Road, Fritwell</b>	
CLIENT: <b>Cala Homes (Chiltern) Ltd</b>	
MAP REF: <b>3849/06/D15-1371</b>	
REVISION: <b>2</b>	
DATE: <b>10/06/16</b>	SCALE: <b>1:250@A3</b>
APPROVED BY: <b>RD</b>	PRODUCED BY: <b>SW</b>

Reproduction with the permission of The Controller of Her Majesty's Stationary Office Crown Copyright (c) Licence number: AL 52251A000 Lockhart Garratt Ltd 8 Melbourn House, Corbygate Business Park, Weldon, Corby, Northants NN17 5JG. Not to be reproduced without the permission of Lockhart Garratt Ltd