

This drawing is a reproduction of the original planning approved scheme with minor alterations and modifications to suit the new owners personal design requirements.  
 This drawing has been prepared using a different software package to the original drawing which has minor variations in its presentation detail.

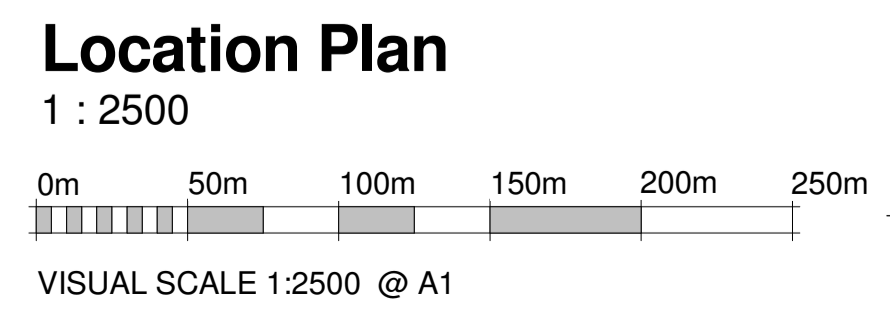

Ordnance Survey (c) Crown Copyright 2015.  
 All rights reserved. Licence number 100022432

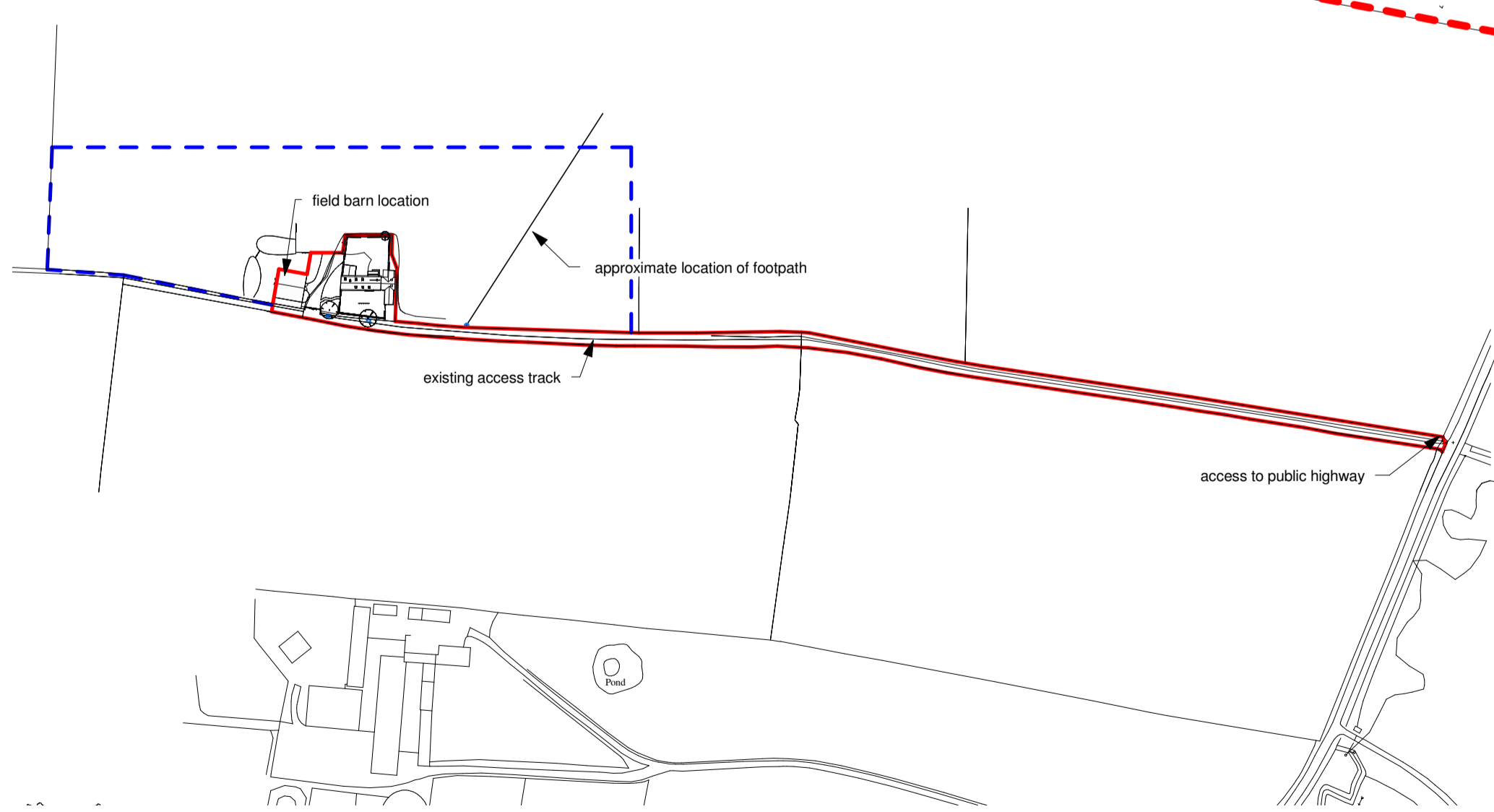
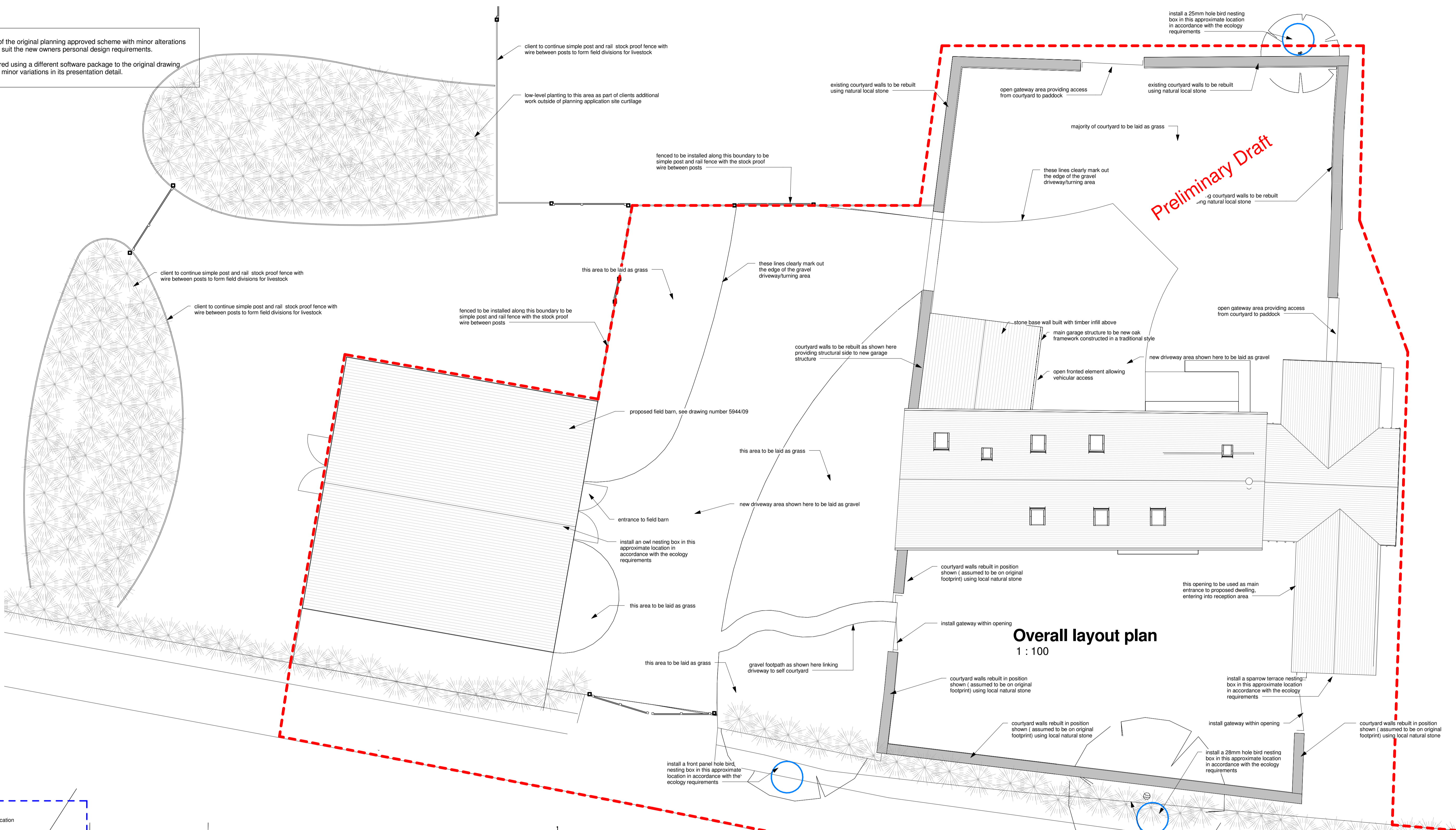
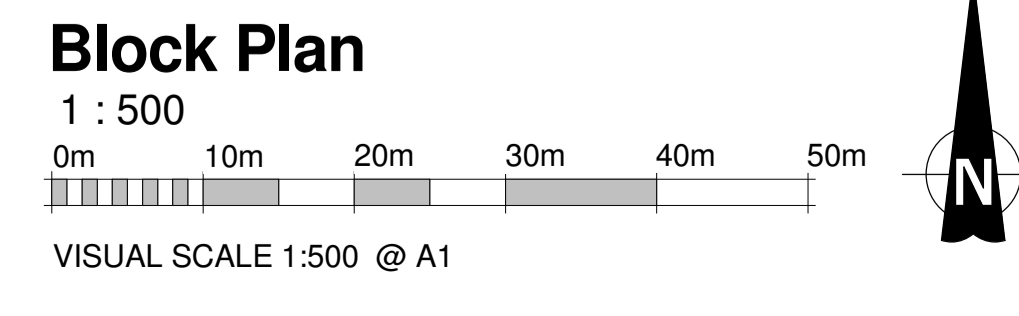
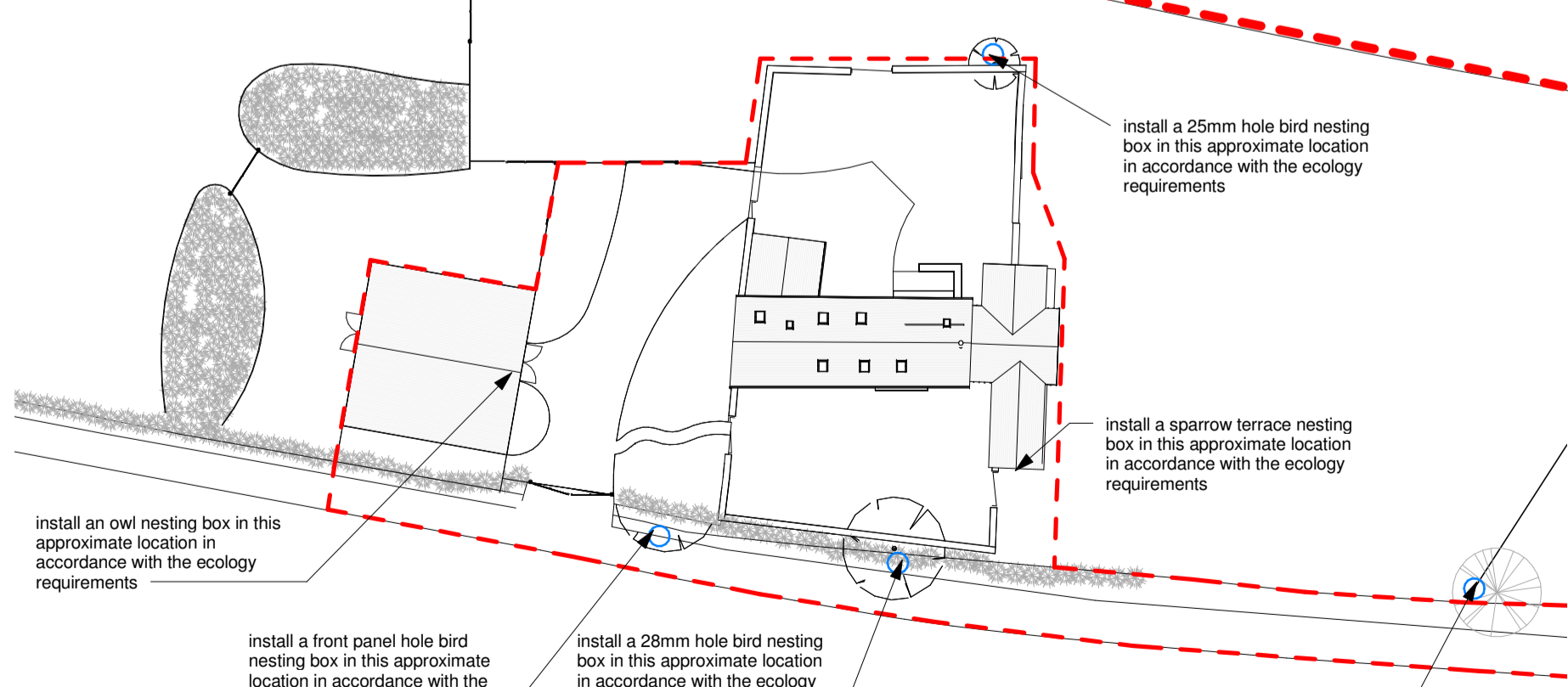

Revision "b" variations to the planning approved scheme revising minor aspects of the design to suit a new owners individual design requirements 14/11/2015

Rev.	Date	Revision Notes

**Proposed Location and Layout**

**STABLE ARCHITECTURE**  
 JEREMY DUNN  
 17 FIR TREE CLOSE  
 BANBURY OXON OX16 1JS  
 TEL: 01295 270565  
 FAX: 01295 626217  
 MOBILE: 07710 461860  
 E-mail: Jeremy.Dunn@Virgin.net

Job: Residential Barn Conversion  
 Haynes Barn  
 Sibford

Client: Mr & Mrs Finding  
 c/o Stable Architecture Ltd

Drawing No.	Date	Scale
5569-05b	14/11/15	As indicated@A1

**Ecology - birds and owls:**  
 In accordance with the ecology report, the following elements are to be installed as part of the proposed works:  
**Owl Boxes:**  
 In accordance with the ecology report, an owl box is to be installed within the tree to the east of the site (as shown and noted on the block plan) with a further owl nesting box being installed within the east gable of the field barn at high-level (also shown and noted on the block plan).  
**Bird Boxes:**  
 In accordance with the ecology report install a total of 6x bird nesting boxes in locations noted and shown on the block plan, each to be a different type as follows: 25mm hole, 28mm hole and one panel front. In addition also install a sparrow terrace on the gable end of the south elevation as shown and noted on that particular elevation.