

# ENVIRONMENTAL STATEMENT FURTHER INFORMATION

Appendix 2: Revised  
Development Framework Plan  
JJG043 / 035 / Rev P

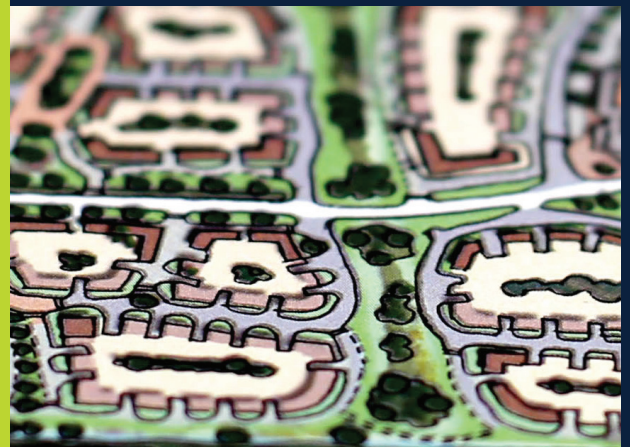

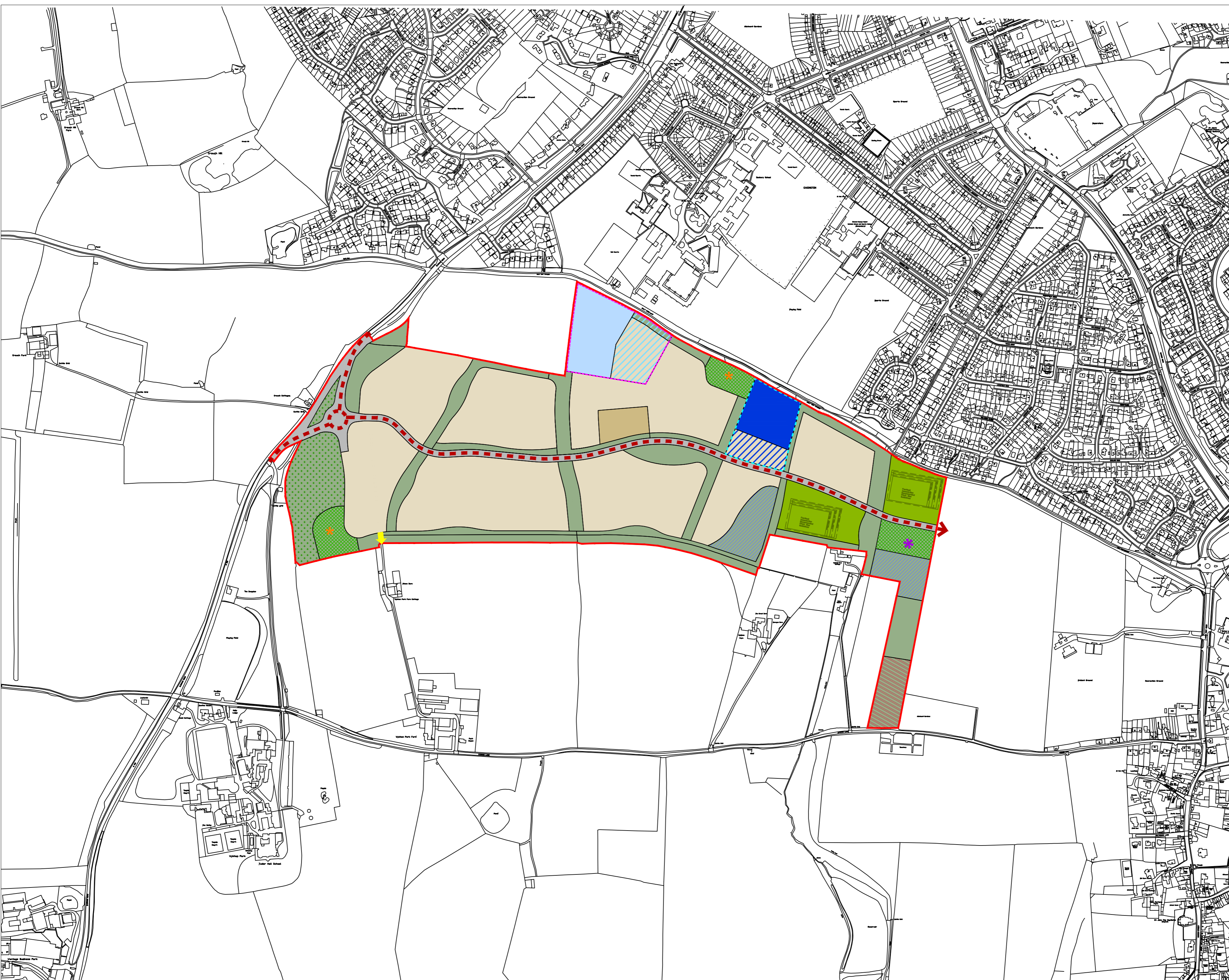

- Application Boundary - 52.46Ha
- Residential - 24.42Ha
- Local Centre - 0.64Ha
- Primary School - 3.01Ha
- 1.81Ha - WPF requirement
- 1.20Ha - additional requirement generated by Banbury South West development
- Secondary School (BGN) - 1.855Ha
- 1.22Ha - WPF requirement
- 0.635Ha - additional requirement generated by Banbury town wide needs
- Infrastructure - 2.96Ha
- SuDS - 1.89Ha
- Strategic Landscape - 2.39Ha
- Outdoor Sports - 2.84Ha
- Allotments - 0.90Ha
- Play Space - 1.94Ha
- General Green Space - 9.69Ha
- ➔ Existing Agricultural Access Retained
- ✱ LEAP
- ✱ NEAP

**NOTE:**  
Up to 12.5m Building Height to Ridge

**NOTE**  
This drawing is for information purposes only and not for use in construction. Do NOT scale from this drawing. All dimensions are to be checked on site and any discrepancies should be immediately reported to the originator of the drawing. All information is copyright protected and may not be used or reproduced without prior permission.

Reproduced by permission of Ordnance Survey on behalf of HMSO.  
© Crown copyright and database right 2013  
All rights reserved.  
Ordnance Survey Licence number: 100022533

Title  
**Wykham Park Farm  
Development Framework Plan**

Date 15-03-16 Scale 1:5,000@A2 / 1:2,500@A0

Drawn	Designed	Approved	Drawing Number
CP/DG	SH	--	JJG043 - 035



DAVID LOCK ASSOCIATES LIMITED  
50 NORTH THIRTEENTH STREET, CENTRAL MILTON KEYNES, MK9 3BP  
TEL: 01908 66276 FAX: 01908 605747 EMAIL: mail@davidlock.com  
www.davidlock.com