

notes

- The contractor is responsible for checking dimensions, tolerances and references. Any discrepancy to be verified with the Architect before proceeding with the works.
- Where an item is covered by drawings to different scales the larger scale drawing is to be worked to.
- Do not scale drawing. Figured dimensions to be worked to in all cases.

CDM Regulations 2015

ALL current drawings and specifications for the project must be read in conjunction with the Designer's Hazard and Environmental Assessment Record.

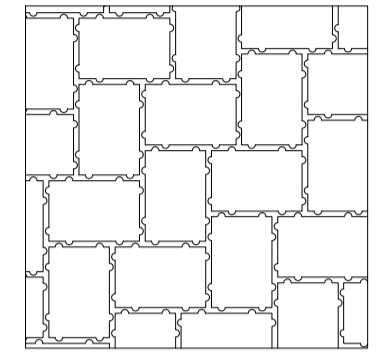

to be laid 'herringbone' pattern

P1

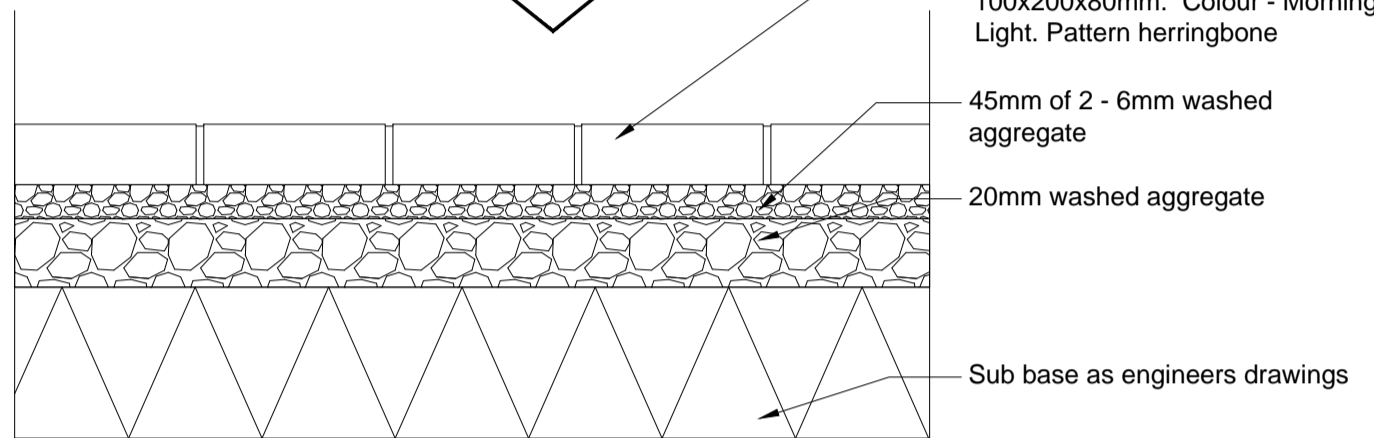

01 Paving P1
Charcon Infilta Andover textured

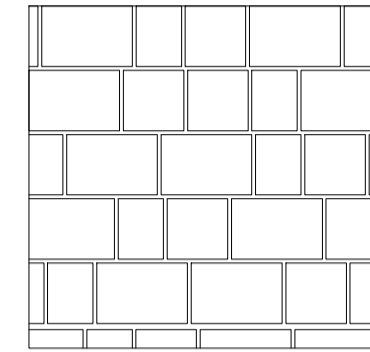

to be laid 'random course'

P2

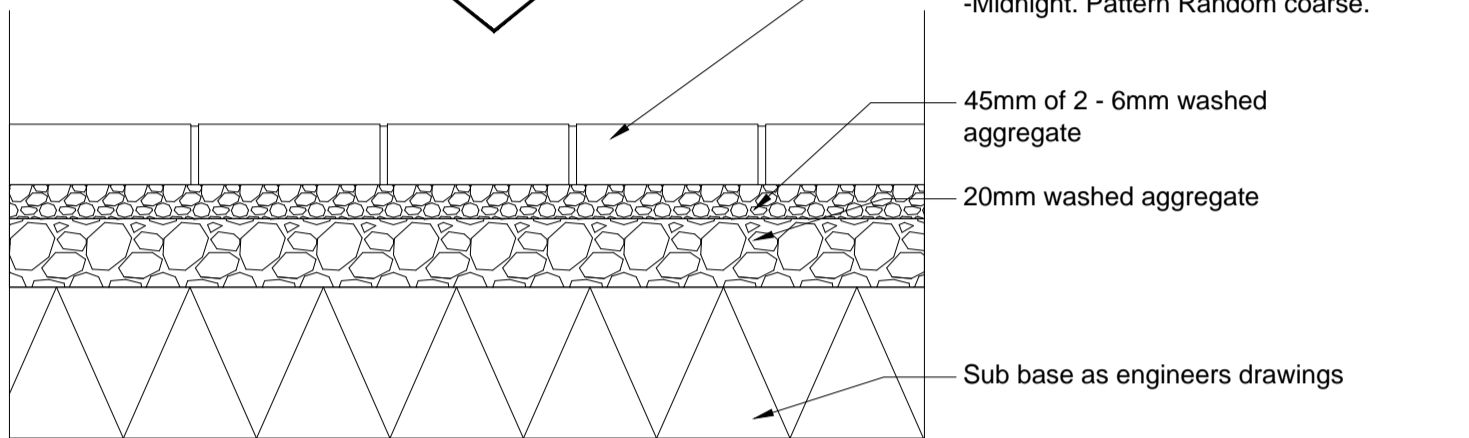

02 Paving P2
Charcon Infilta Andover textured

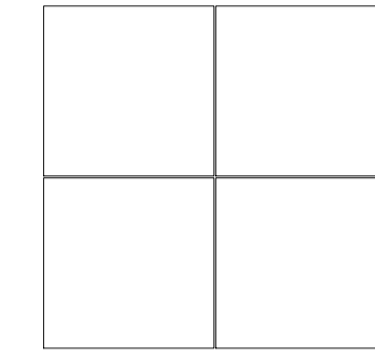

to be laid 'chequer board' pattern

P3

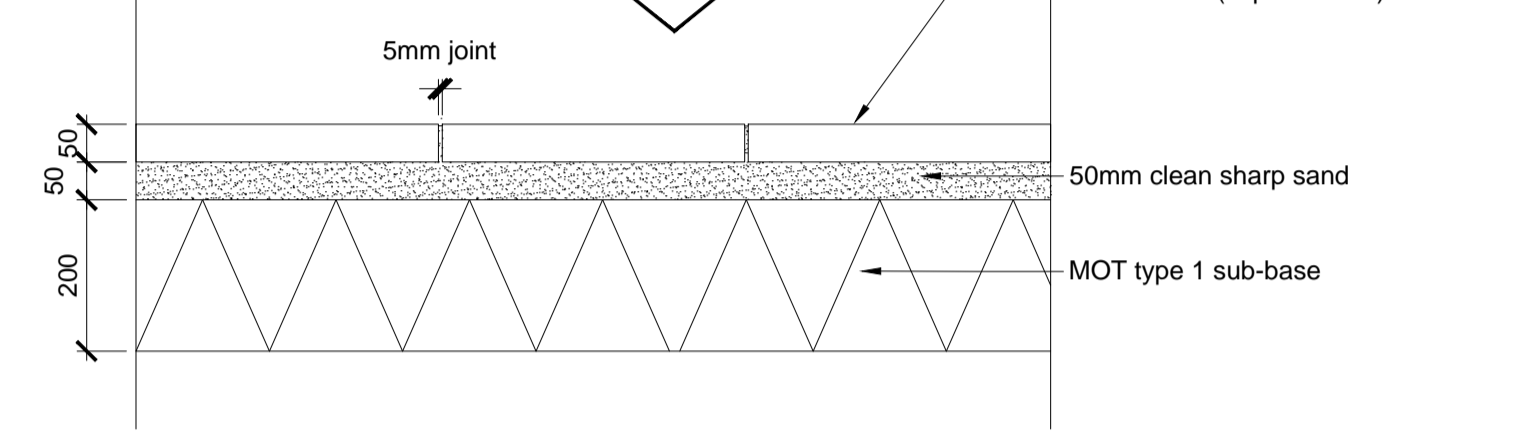

03 Paving P3
Charcon Eco pave

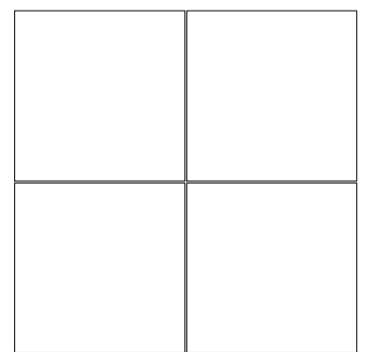

to be laid 'chequer board' pattern

P4

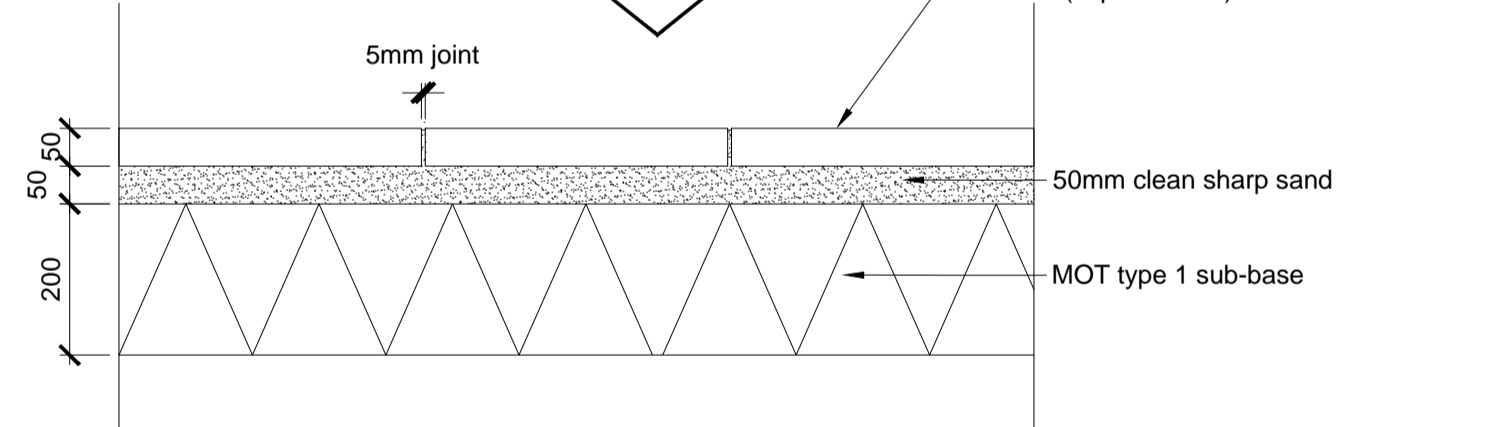

04 Paving P4
Charcon Eco pave

P5

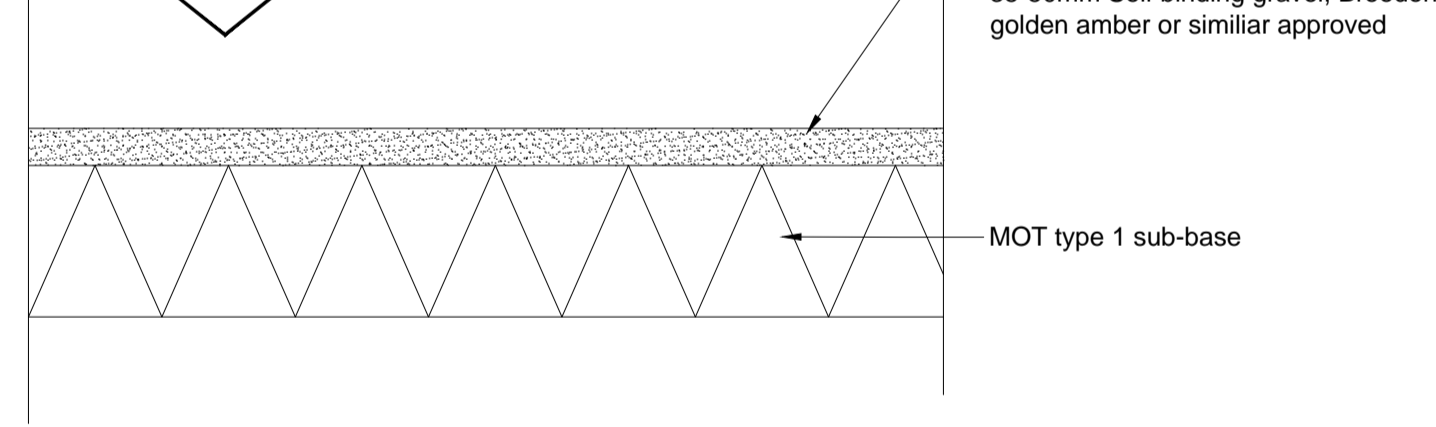

06 Paving P5
Self binding gravel

P4

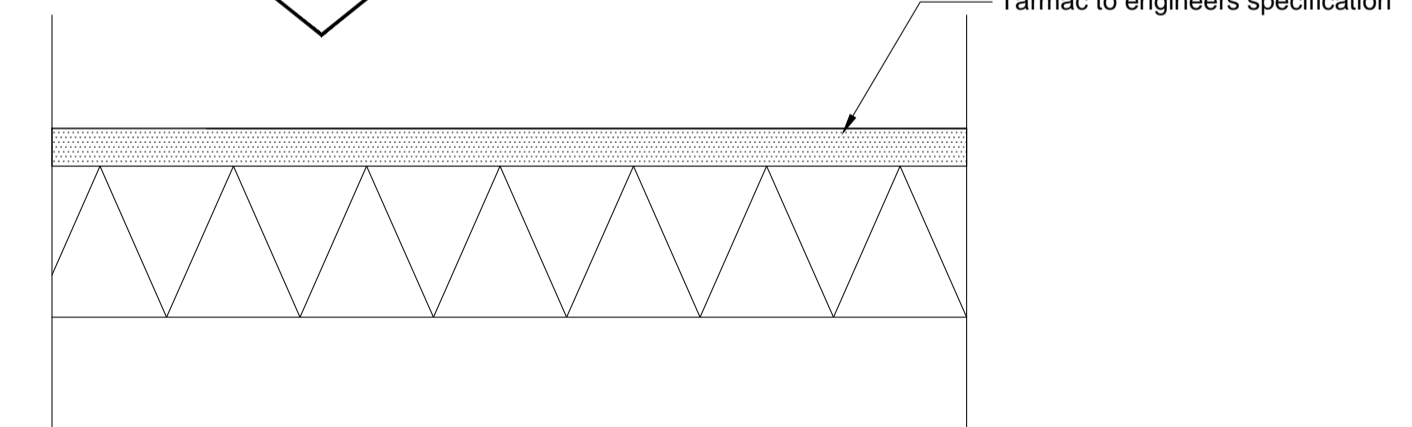

06 Paving P6
Tarmac

NOTE:
All bedding and subases to be in accordance with engineers specification.

24/06/16	B	Issued for planning	MQ/AGF
03/07/15	A	Drawing amended to reflect comments by Silver. CDM date changed	MQ/AGF

date	rev	revision/author/checker
------	-----	-------------------------

purpose of issue	PLANNING
project	Bicester Eco Town Exemplar Site, Phase 2
drawing	LANDSCAPE PAVING DETAILS

drawing no	AL4908-2100	rev	B
drawn	MQ	checked	AGF
scale @ A1	1:10	date	April '15