

Notes:

1. Do not scale from this drawing
2. This drawing is copyright and may not be copied or given to a third party without written authority from Ashley Helme Associates Ltd
3. Subject to detailed design
4. Based upon topographical survey

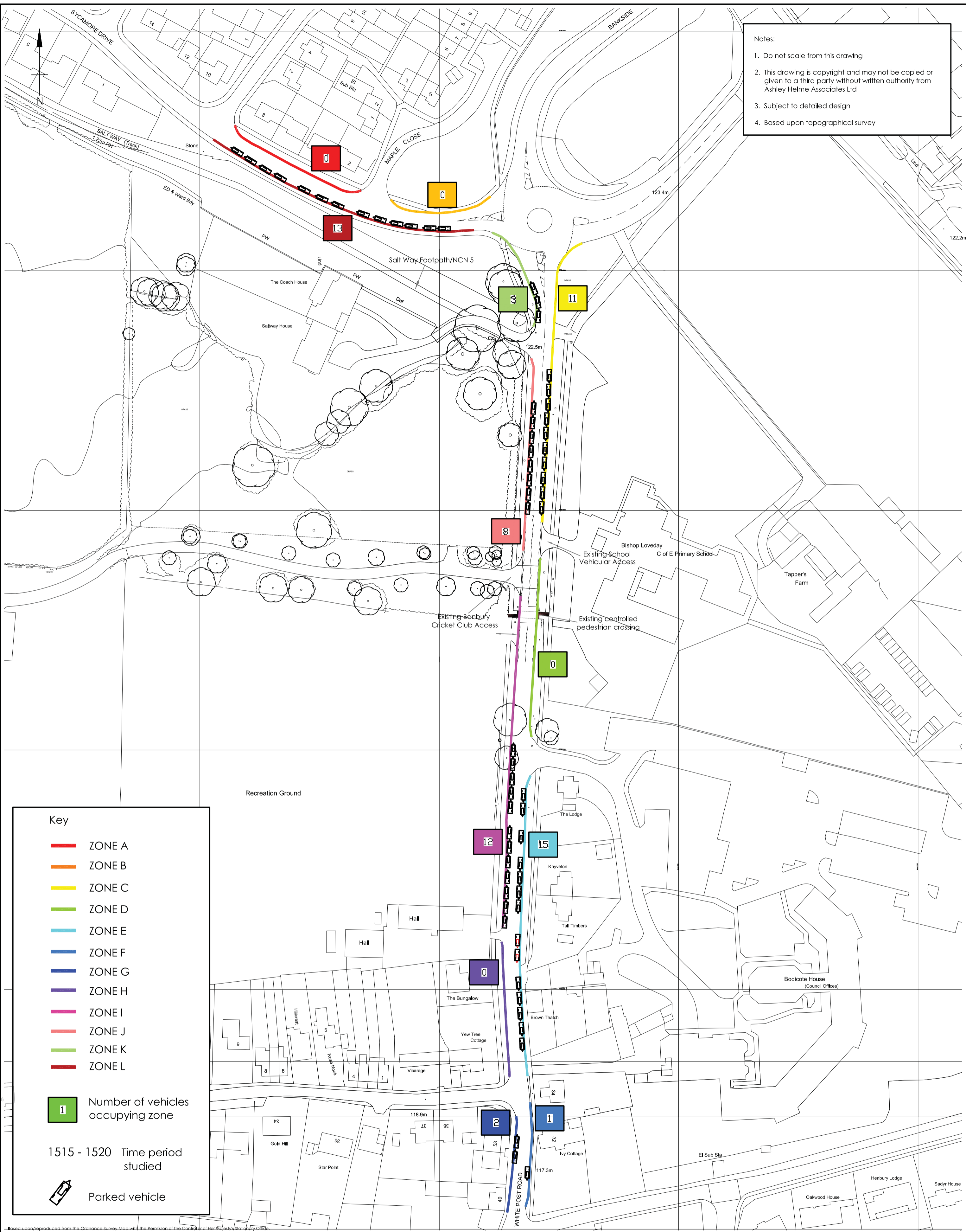

Key

- █ ZONE A
- █ ZONE B
- █ ZONE C
- █ ZONE D
- █ ZONE E
- █ ZONE F
- █ ZONE G
- █ ZONE H
- █ ZONE I
- █ ZONE J
- █ ZONE K
- █ ZONE L

1 Number of vehicles occupying zone

1515 - 1520 Time period studied

Parked vehicle

Project WHITE POST ROAD, BANBURY	Client GLADMAN DEVELOPMENTS LTD	Drawing No 1361/PS/2	Rev
Title PARKING SURVEY RESULTS: OCCUPANCY PM WORST CASE SCENARIO		Date NOV 2013	Scale 1:1000 @ A2

ashleyhelme
associates

76 washway road, sale, manchester, m33 7re
e: aha@ashleyhelme.co.uk t: 0161 972 0552 f: 0161 972 0553

This page has been
left intentionally
blank

F College Fields/Bankside Junction Improvements

This page has been
left intentionally
blank



Drawing Title BANKSIDE/CONNECTOR ROAD/SITE ACCESS - PROPOSED ROUNDABOUT	Client HALLAM LAND MANAGEMENT LTD. & JJ GALLAGHER LTD.	Newcombe House 45 Notting Hill Gate London W11 3PB	Scale: 1:500@A3 Designed by: J.H. Drawn by: A.D.					
	Job Title LAND AT COLLEGE FIELDS, BANBURY	T 020 7309 7000 F 020 7309 0906 www.cbuchanan.co.uk		Ckd/Appd: First Issued: JAN '05 Job No: 38581	Rev. Date. Amendment. Des. Drn.	Drg No: FIGURE 59		

This page has been
left intentionally
blank

Drawings

This page has been
left intentionally
blank



- Notes:
1. Do not scale from this drawing
 2. This drawing is copyright and may not be copied or given to a third party without written authority from Ashley Helme Associates Ltd
 3. Subject to detailed design
 4. Based upon digitised OS plan, accuracy can not be guaranteed until checked with topographical survey

Based upon/reproduced from the Ordnance Survey Map with the Permission of The Controller of Her Majesty's Stationary Office, © Crown Copyright Ashley Helme Associates Ltd, 76 Washway Road, Sale, Manchester, M33 7RE. Licence No AL100015126

Project	LAND TO THE WEST OF WHITE POST ROAD, BANBURY
Client	GLADMAN DEVELOPMENTS

Title	EXISTING JUNCTION ARRANGEMENTS: STUDY JUNCTION 2
-------	---

Drawing No	1361/02
Date	AUGUST 2013

Rev	
Scale	1:500 @ A3

ashleyhelme
associates
 76 washway road, sale, manchester, m33 7re
 e: aha@ashleyhelme.co.uk t: 0161 972 0552 f: 0161 972 0553

This page has been
left intentionally
blank

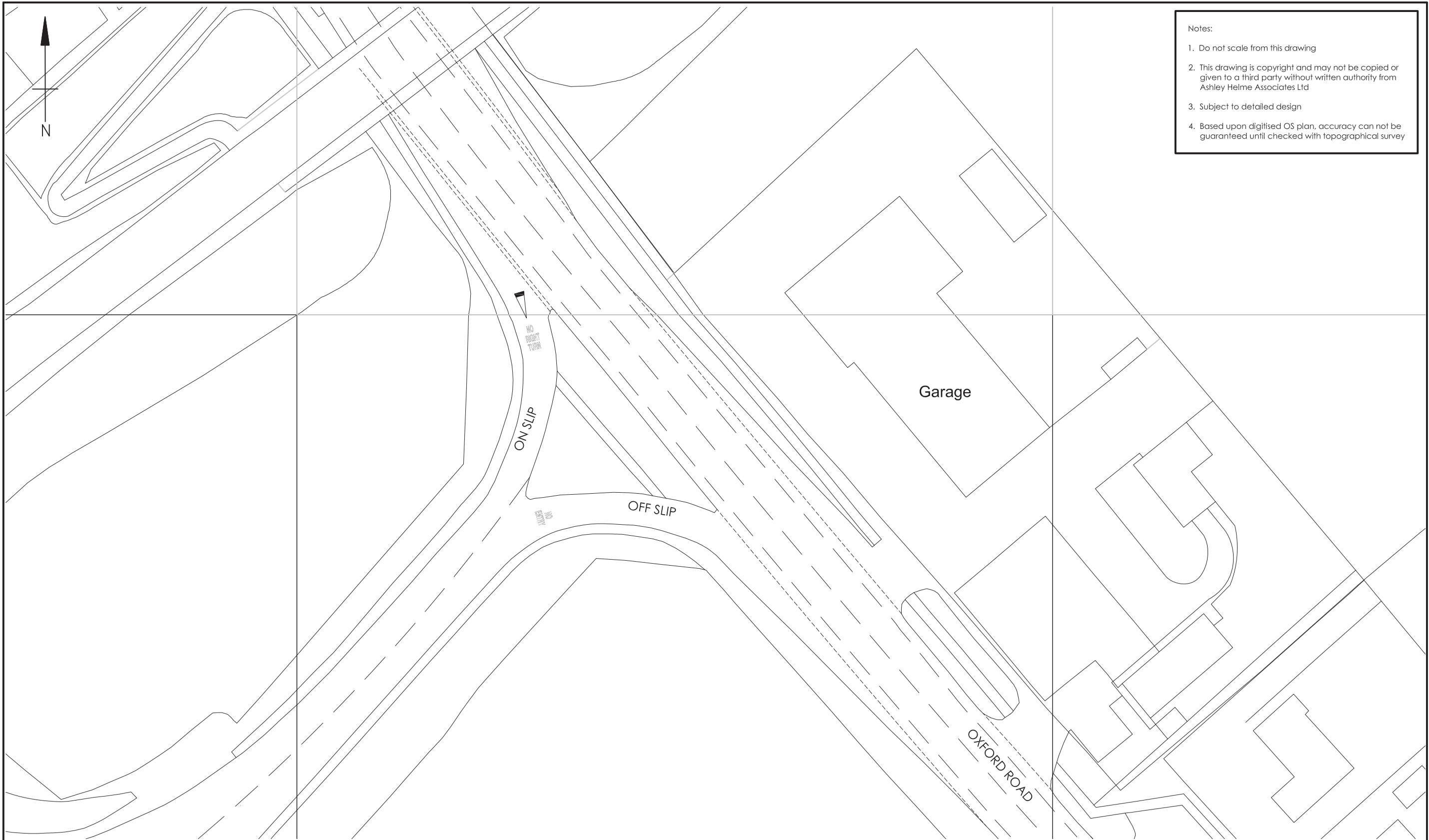

- Notes:
1. Do not scale from this drawing
 2. This drawing is copyright and may not be copied or given to a third party without written authority from Ashley Helme Associates Ltd
 3. Subject to detailed design
 4. Based upon digitised OS plan, accuracy can not be guaranteed until checked with topographical survey

Based upon/reproduced from the Ordnance Survey Map with the Permission of The Controller of Her Majesty's Stationary Office.
 © Crown Copyright Ashley Helme Associates Ltd, 76 Washway Road, Sale, Manchester, M33 7RE. Licence No AL100015126

Project	LAND TO THE WEST OF WHITE POST ROAD. BANBURY
Client	GLADMAN DEVELOPMENTS

Title	EXISTING JUNCTION ARRANGEMENTS: STUDY JUNCTION 2A
-------	--

Drawing No	1361/03
Date	AUGUST 2013

Rev	
Scale	1:500@A3

ashleyhelme
associates
 76 washway road, sale, manchester, m33 7re
 e: aha@ashleyhelme.co.uk t: 0161 972 0552 f: 0161 972 0553

This page has been
left intentionally
blank

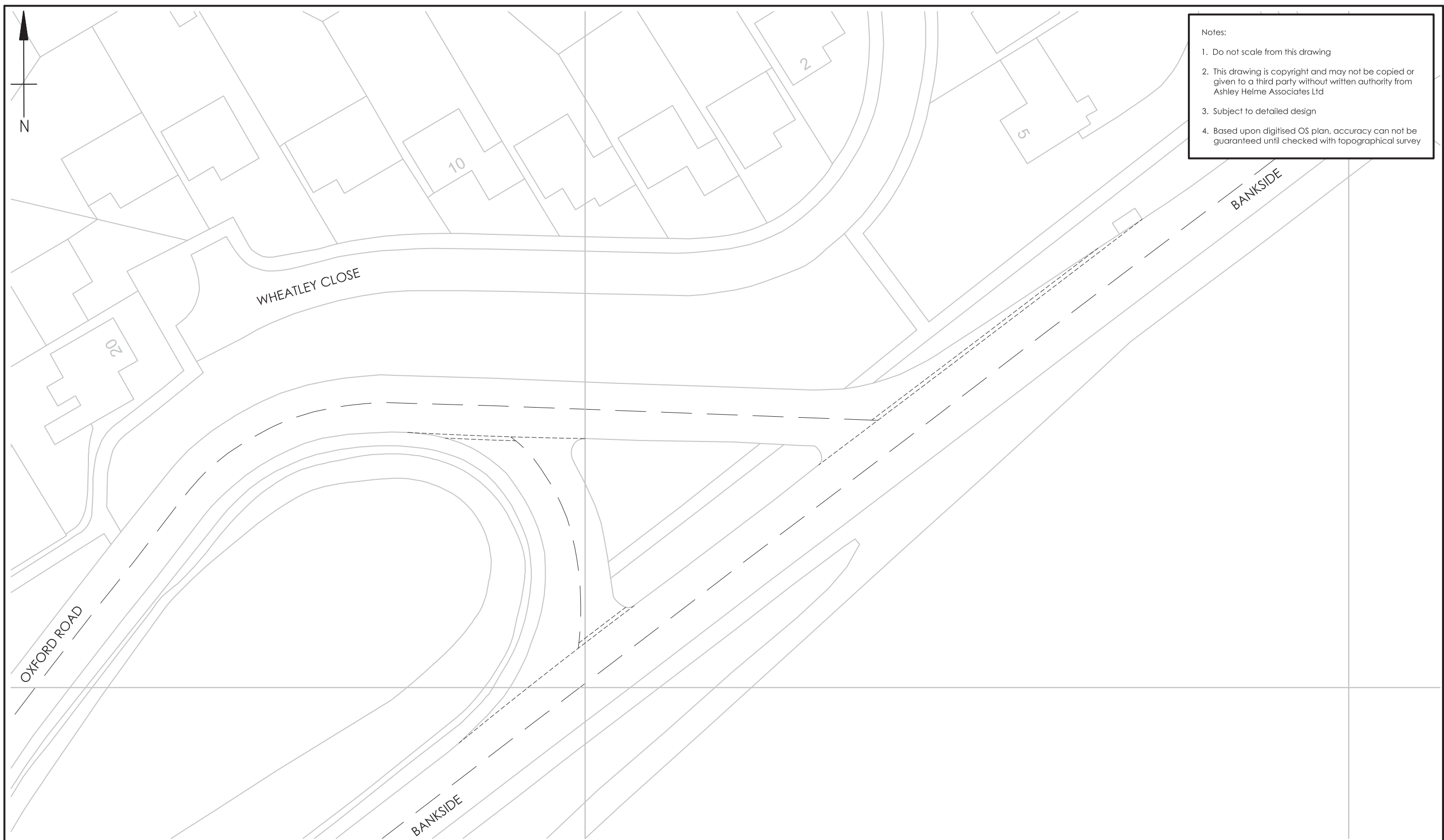

- Notes:
1. Do not scale from this drawing
 2. This drawing is copyright and may not be copied or given to a third party without written authority from Ashley Helme Associates Ltd
 3. Subject to detailed design
 4. Based upon digitised OS plan, accuracy can not be guaranteed until checked with topographical survey

Based upon/reproduced from the Ordnance Survey Map with the Permission of The Controller of Her Majesty's Stationary Office.
 © Crown Copyright Ashley Helme Associates Ltd, 76 Washway Road, Sale, Manchester, M33 7RE. Licence No AL100015126

Project	LAND TO THE WEST OF WHITE POST ROAD, BANBURY
Client	GLADMAN DEVELOPMENTS

Title	EXISTING JUNCTION ARRANGEMENTS: STUDY JUNCTION 3
-------	---

Drawing No	1361/04
Date	AUGUST 2013

Rev	
Scale	1:500@A3

ashleyhelme
associates
 76 washway road, sale, manchester, m33 7re
 e: aha@ashleyhelme.co.uk t: 0161 972 0552 f: 0161 972 0553

This page has been
left intentionally
blank

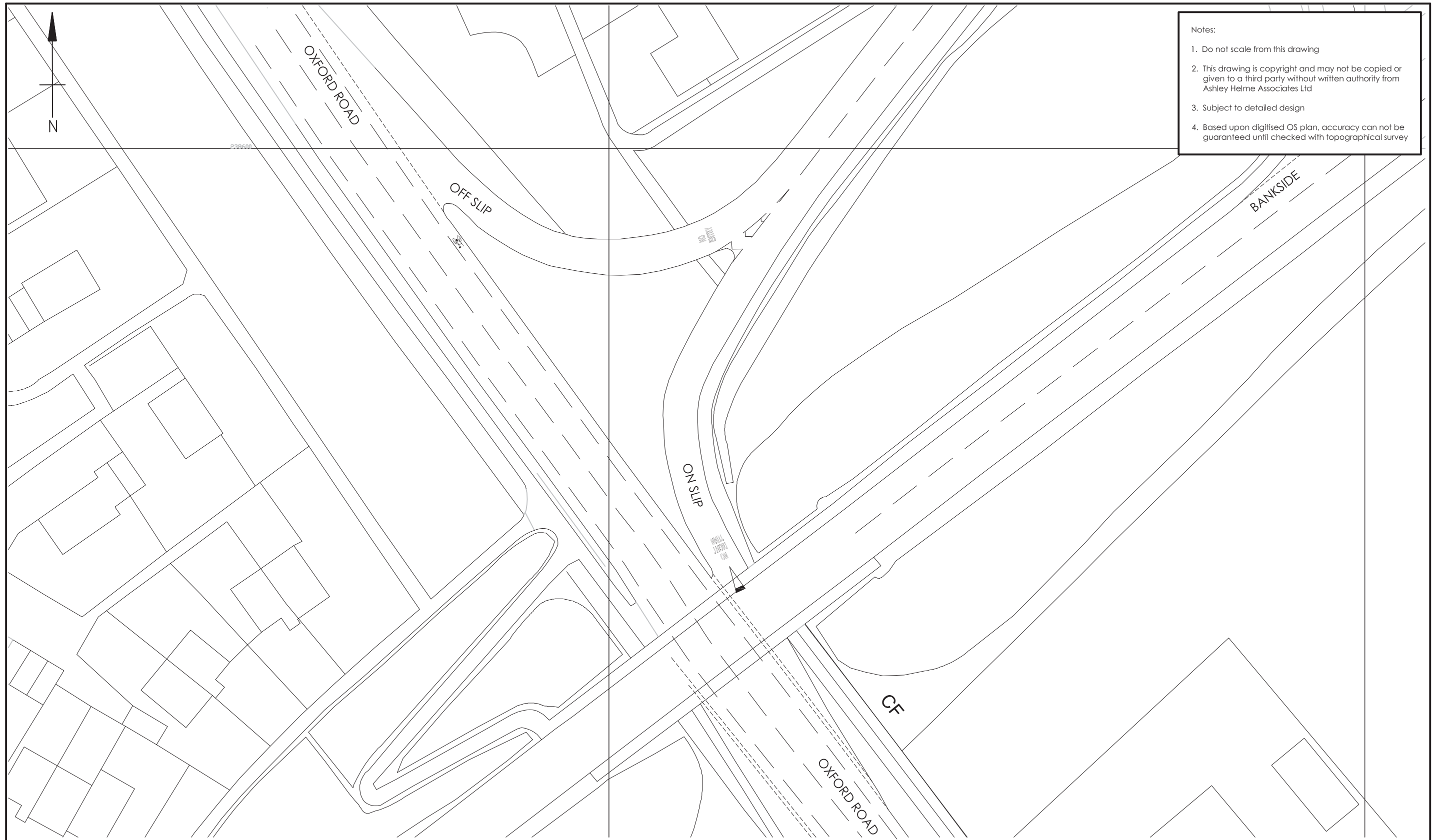

- Notes:
1. Do not scale from this drawing
 2. This drawing is copyright and may not be copied or given to a third party without written authority from Ashley Helme Associates Ltd
 3. Subject to detailed design
 4. Based upon digitised OS plan, accuracy can not be guaranteed until checked with topographical survey

Based upon/reproduced from the Ordnance Survey Map with the Permission of The Controller of Her Majesty's Stationary Office.
 © Crown Copyright Ashley Helme Associates Ltd, 76 Washway Road, Sale, Manchester, M33 7RE. Licence No AL100015126

Project LAND TO THE WEST OF WHITE POST ROAD, BANBURY	Title EXISTING JUNCTION ARRANGEMENTS: STUDY JUNCTION 3A	Drawing No 1361/05	Rev 	 76 washway road, sale, manchester, m33 7re e: aha@ashleyhelme.co.uk t: 0161 972 0552 f: 0161 972 0553
Client GLADMAN DEVELOPMENTS		Date AUGUST 2013	Scale 1:500@A3	

This page has been
left intentionally
blank

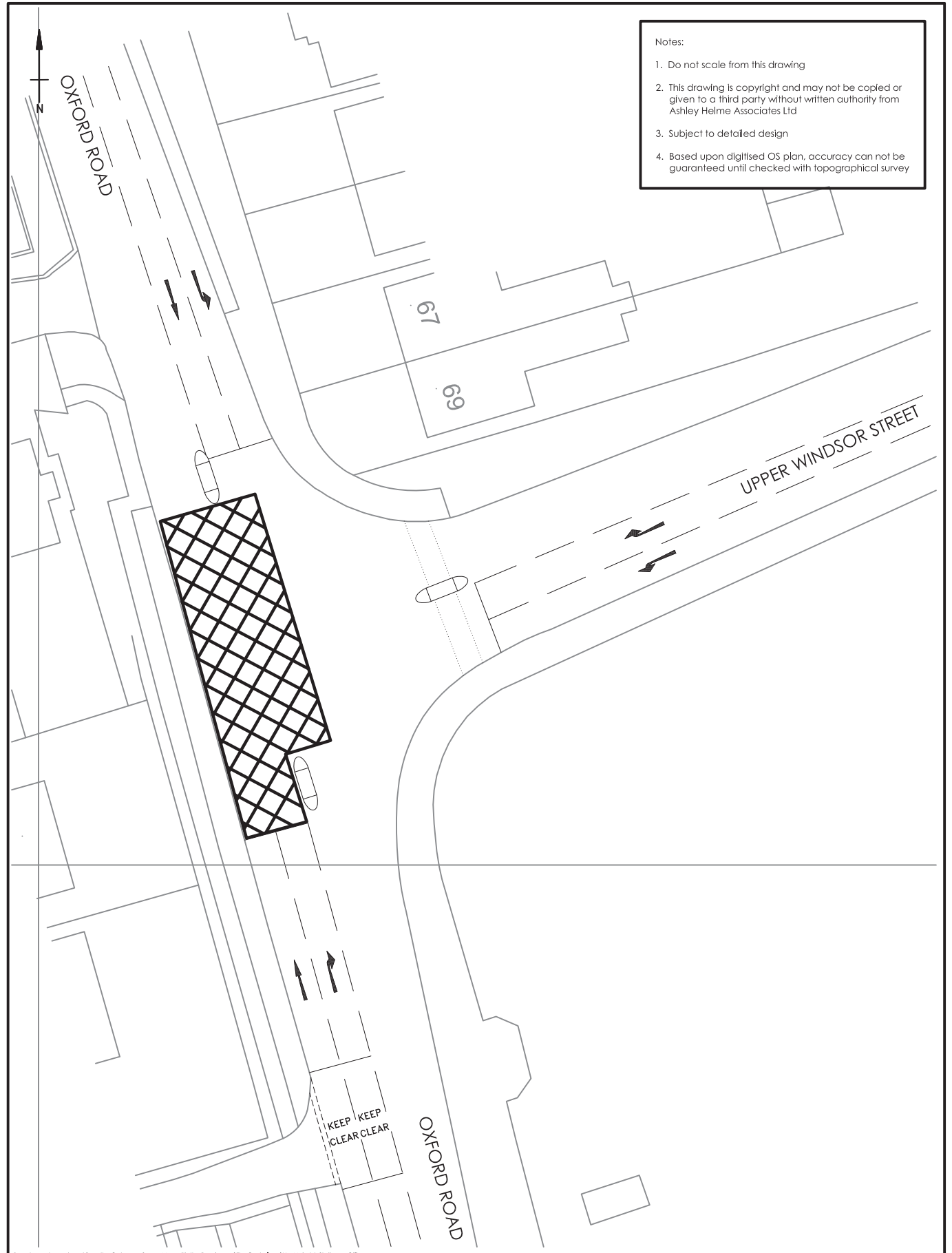

- Notes:
1. Do not scale from this drawing
 2. This drawing is copyright and may not be copied or given to a third party without written authority from Ashley Helme Associates Ltd
 3. Subject to detailed design
 4. Based upon digitised OS plan, accuracy can not be guaranteed until checked with topographical survey

Based upon/reproduced from the Ordnance Survey Map with the Permission of The Controller of Her Majesty's Stationary Office.
 © Crown Copyright Ashley Helme Associates Ltd, 76 Washway Road, Sale, Manchester, M33 7RE. Licence No AL100015126

 76 washway road, sale, manchester, m33 7re e: aha@ashleyhelme.co.uk t: 0161 972 0552 f: 0161 972 0553	Project LAND TO WEST OF WHITE POST ROAD, BANBURY	Client GLADMAN DEVELOPMENTS	Drawing No 1361/06	Rev
	Title EXISTING JUNCTION ARRANGEMENTS: STUDY JUNCTION 9		Date JULY 2013	Scale 1:500@A4

This page has been
left intentionally
blank



Notes:

1. Do not scale from this drawing
2. This drawing is copyright and may not be copied or given to a third party without written authority from Ashley Helme Associates Ltd
3. Subject to detailed design
4. Based upon digitised OS plan, accuracy can not be guaranteed until checked with topographical survey

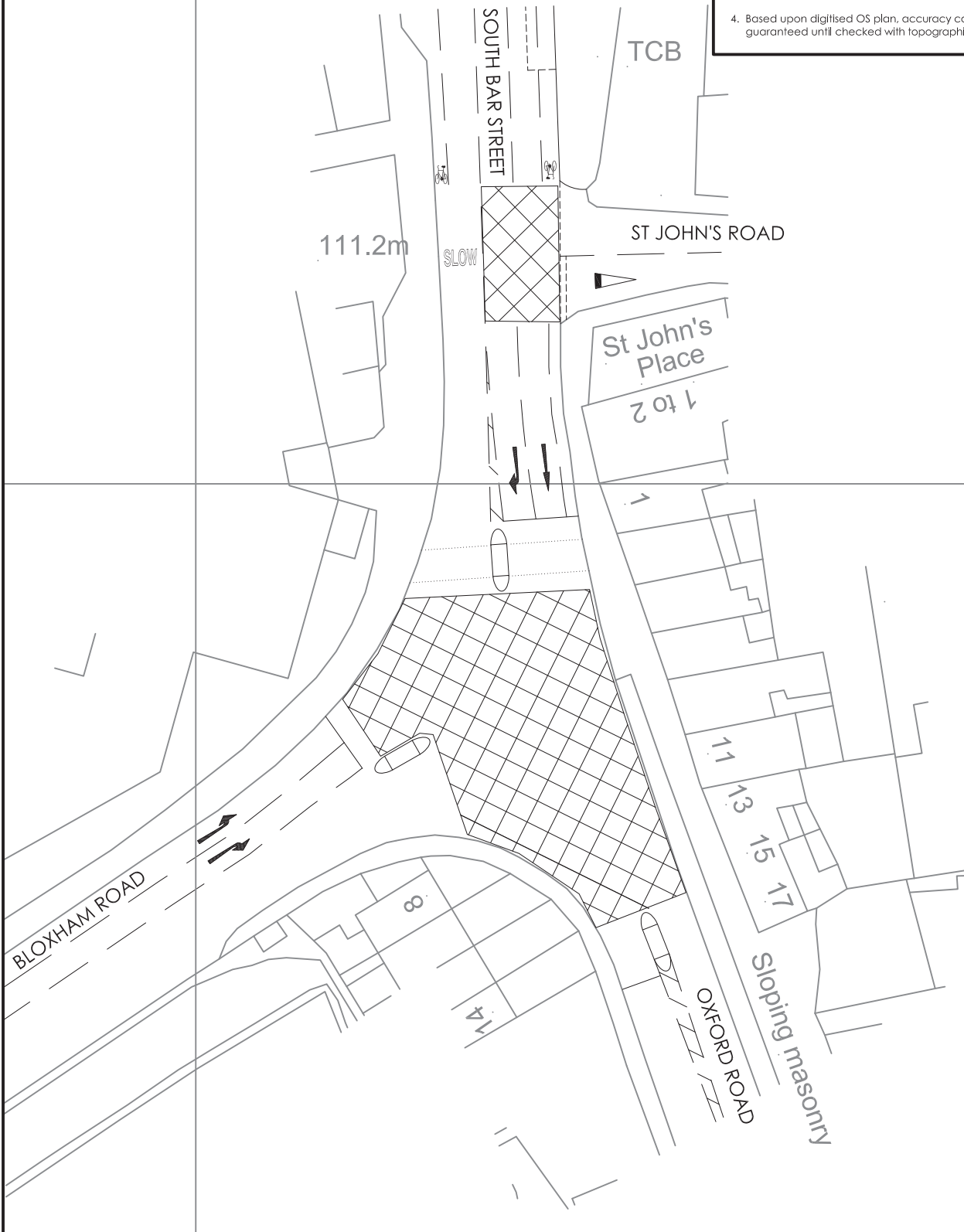

Based upon/reproduced from the Ordnance Survey Map with the Permission of the Controller of Her Majesty's Stationary Office.
© Crown Copyright Ashley Helme Associates Ltd, 76 Washway Road, Sale, Manchester, M33 7RE. Licence No AL100015126

ashleyhelme
associates
76 washway road, sale, manchester, m33 7re
e: aha@ashleyhelme.co.uk t: 0161 972 0552 f: 0161 972 0553

Project LAND TO THE WEST OF WHITE
POST ROAD, BANBURY

Client GLADMAN
DEVELOPMENTS

Drawing No
1361/07

Rev

Title EXISTING JUNCTION ARRANGEMENTS:
STUDY JUNCTION 10

Date
JULY 2013

Scale
1:500 @ A4

This page has been
left intentionally
blank

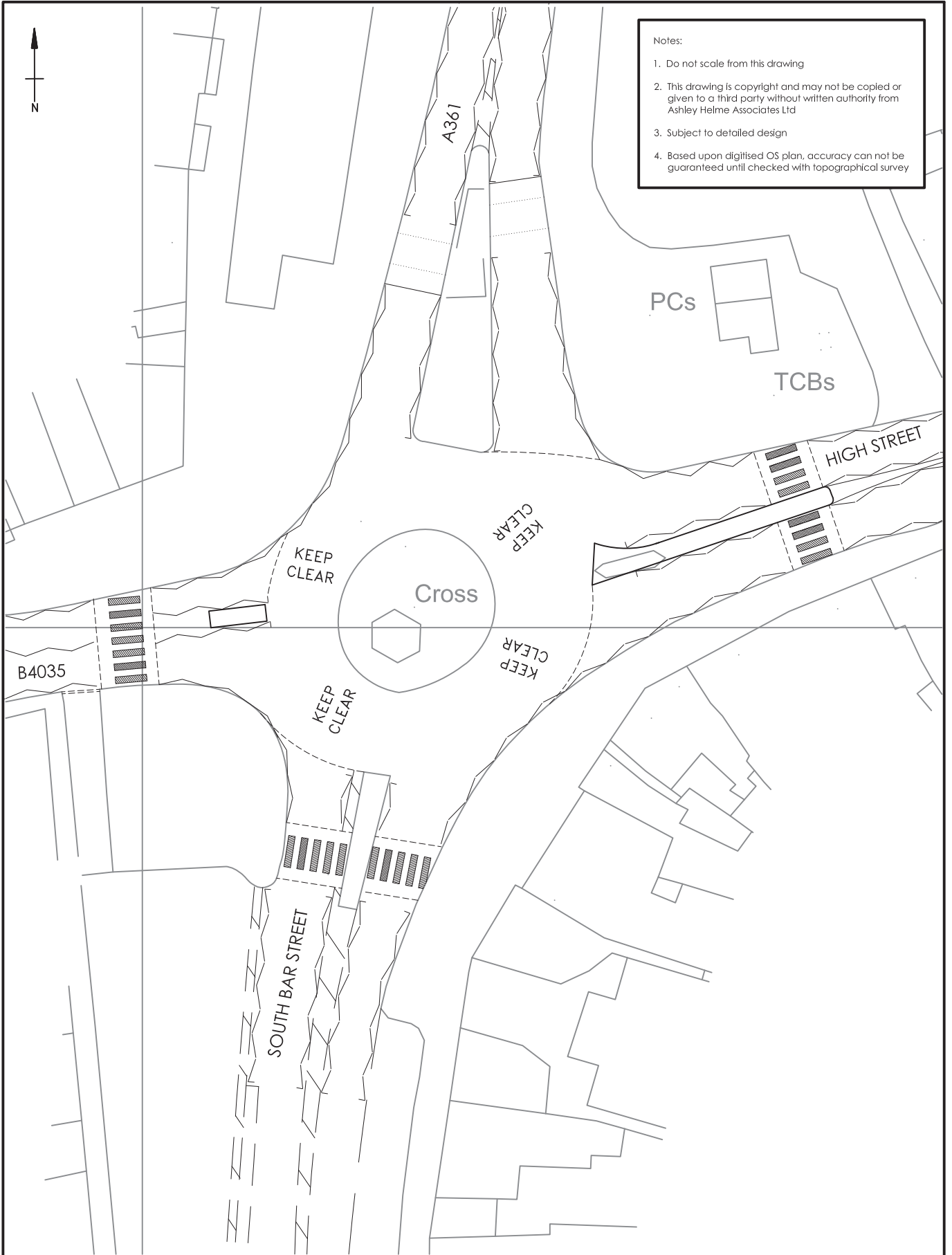

- Notes:
1. Do not scale from this drawing
 2. This drawing is copyright and may not be copied or given to a third party without written authority from Ashley Helme Associates Ltd
 3. Subject to detailed design
 4. Based upon digitised OS plan, accuracy can not be guaranteed until checked with topographical survey

Based upon/reproduced from the Ordnance Survey Map with the permission of The Controller of Her Majesty's Stationary Office.
© Crown Copyright Airkey Helme Associates Ltd, 76 Washway Road, Sale, Manchester, M33 7RE. Licence No AL100015126.

 76 washway road, sale, manchester, m33 7re e: aha@ashleyhelme.co.uk t: 0161 972 0552 f: 0161 972 0553	Project LAND TO THE WEST OF WHITE POST ROAD, BANBURY	Client GLADMAN DEVELOPMENTS	Drawing No 1361/08	Rev
	Title EXISTING JUNCTION ARRANGEMENTS: STUDY JUNCTION 11		Date JULY 2013	Scale 1:500@A4

This page has been
left intentionally
blank



Notes:

1. Do not scale from this drawing
2. This drawing is copyright and may not be copied or given to a third party without written authority from Ashley Helme Associates Ltd
3. Subject to detailed design
4. Based upon digitised OS plan, accuracy can not be guaranteed until checked with topographical survey

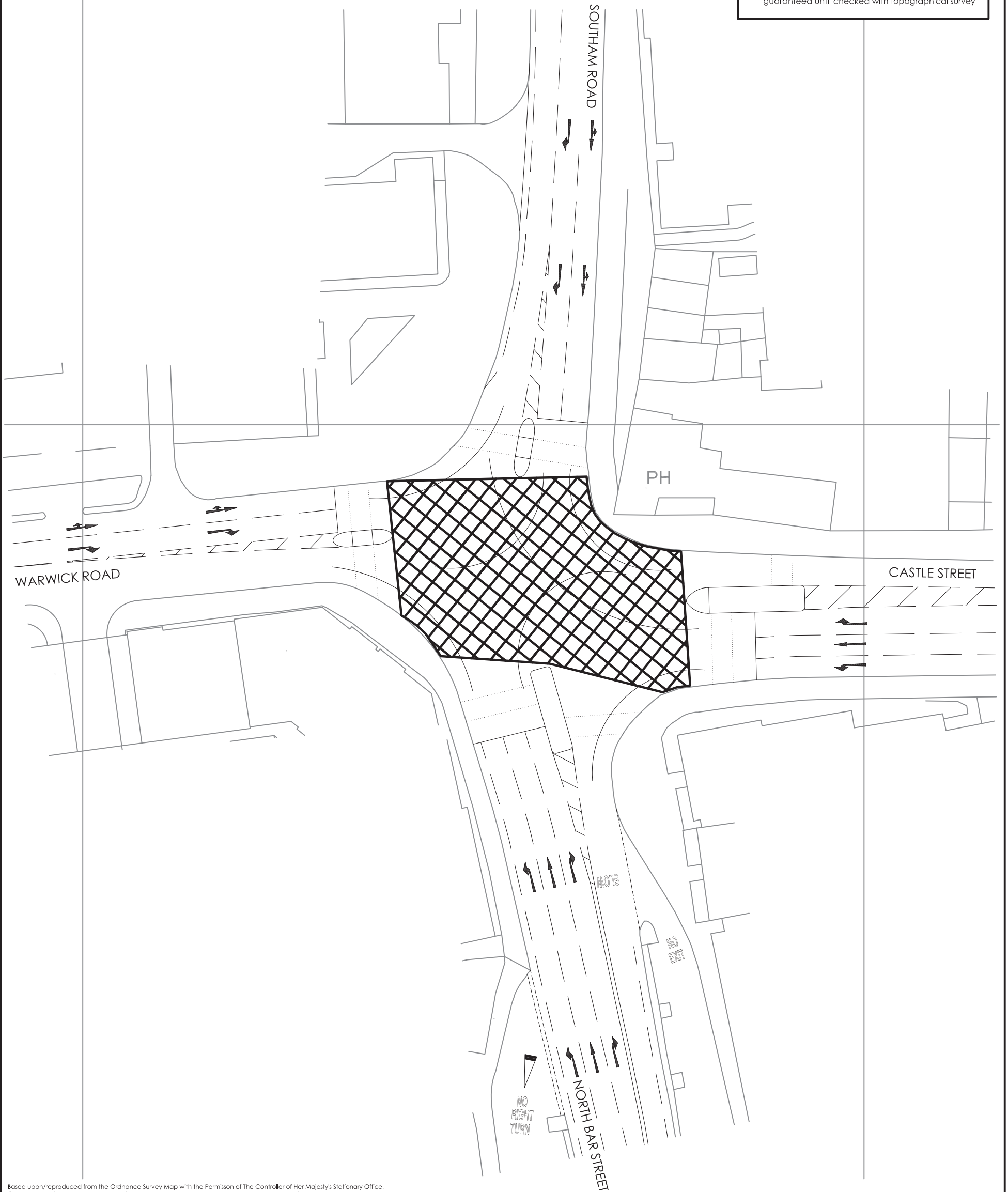

Based upon/reproduced from the Ordnance Survey Map with the Permission of The Controller of Her Majesty's Stationary Office.
© Crown Copyright Ashley Helme Associates Ltd, 76 Washway Road, Sale, Manchester, M33 7RE, Licence No AL100015126

ashleyhelme
associates
76 washway road, sale, manchester, m33 7re
e: aha@ashleyhelme.co.uk t: 0161 972 0552 f: 0161 972 0553

Project
LAND TO THE WEST OF WHITE
POST ROAD, BANBURY

Client
GLADMAN
DEVELOPMENTS

Drawing No
1361/09

Rev

Title
EXISTING JUNCTION ARRANGEMENTS:
STUDY JUNCTION 12

Date
JULY 2013

Scale
1:500@A3

This page has been
left intentionally
blank

Notes:

1. Do not scale from this drawing
2. This drawing is copyright and may not be copied or given to a third party without written authority from Ashley Helme Associates Ltd
3. Subject to detailed design
4. Based upon topographical survey

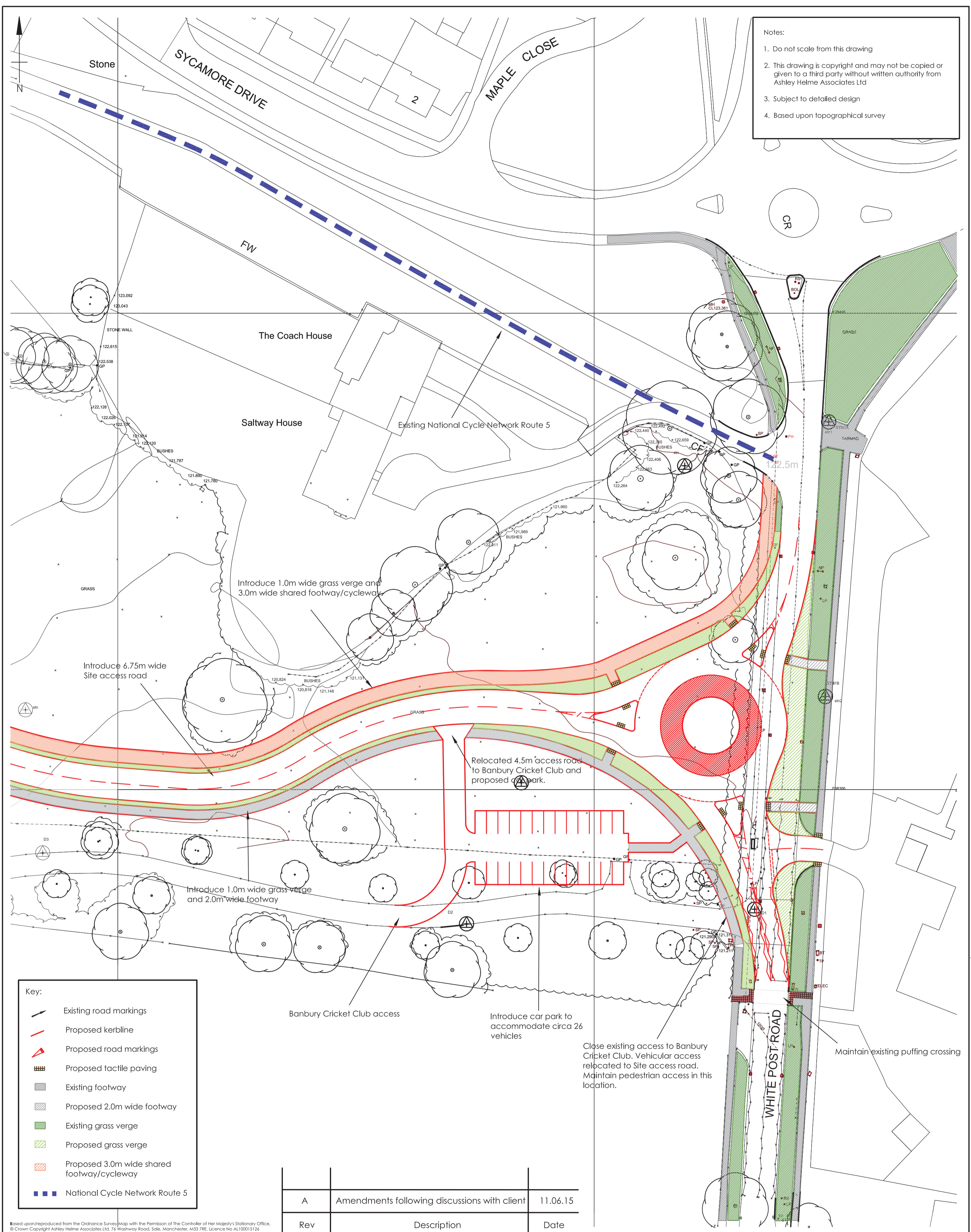

Key:

- Existing road markings
- Proposed kerblines
- Proposed road markings
- Proposed tactile paving
- Existing footway
- Proposed 2.0m wide footway
- Existing grass verge
- Proposed grass verge
- Proposed 3.0m wide shared footway/cycleway
- National Cycle Network Route 5

Rev	Description	Date
A	Amendments following discussions with client	11.06.15

Based upon/reproduced from the Ordnance Survey Map with the Permission of The Controller of Her Majesty's Stationary Office. © Crown Copyright Ashley Helme Associates Ltd, 74 Washway Road, Sale, Manchester, M33 7RE. Licence No AL100013126

Project	LAND TO THE WEST OF WHITE POST ROAD, BANBURY	Client	GLADMAN DEVELOPMENTS LTD	Drawing No	1361/12	Rev	A
Title	PROPOSED ACCESS ARRANGEMENTS: ROUNDABOUT OPTION	Date	MAY 2015	Scale	1:500@A2	 76 washway road, sale, manchester, m33 7re e: aha@ashleyhelme.co.uk t: 0161 972 0552 f: 0161 972 0553	

This page has been
left intentionally
blank

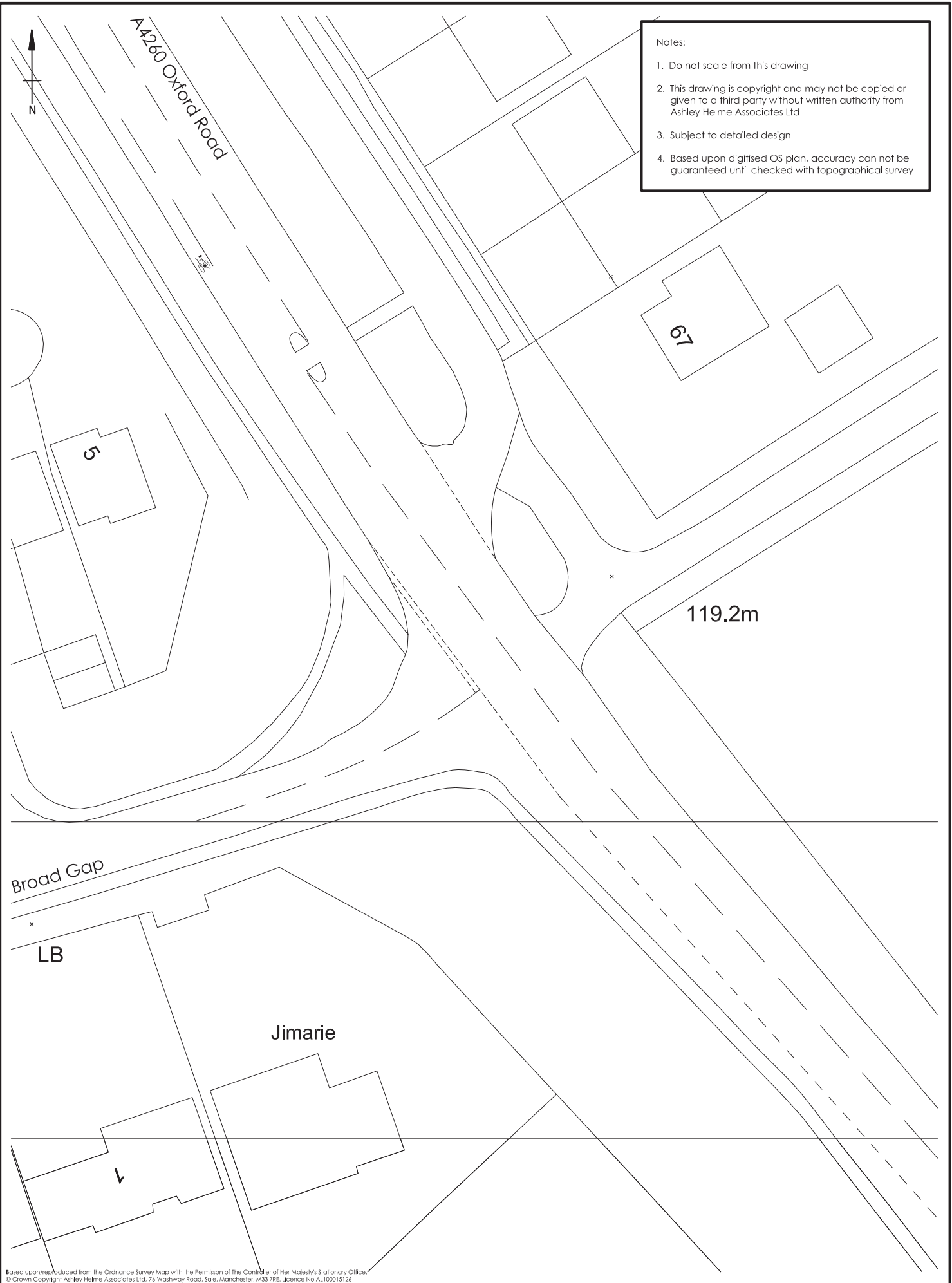

Notes:

1. Do not scale from this drawing
2. This drawing is copyright and may not be copied or given to a third party without written authority from Ashley Helme Associates Ltd
3. Subject to detailed design
4. Based upon digitised OS plan, accuracy can not be guaranteed until checked with topographical survey

Based upon/reproduced from the Ordnance Survey Map with the Permission of The Controller of Her Majesty's Stationary Office.
 © Crown Copyright/ Ashley Helme Associates Ltd, 76 Washway Road, Sale, Manchester, M33 7RE. Licence No AL100015126

ashleyhelme
associates
 76 washway road, sale, manchester, m33 7re
 e: aha@ashleyhelme.co.uk t: 0161 972 0552 f: 0161 972 0553

Project
**LAND TO THE WEST OF WHITE
 POST ROAD, BANBURY**

Client
**GLADMAN
 DEVELOPMENTS**

Drawing No
1361/14

Rev

Title
**EXISTING JUNCTION ARRANGEMENTS:
 STUDY JUNCTION 4**

Date
MAY 2015

Scale
1:500 @ A4

This page has been
left intentionally
blank

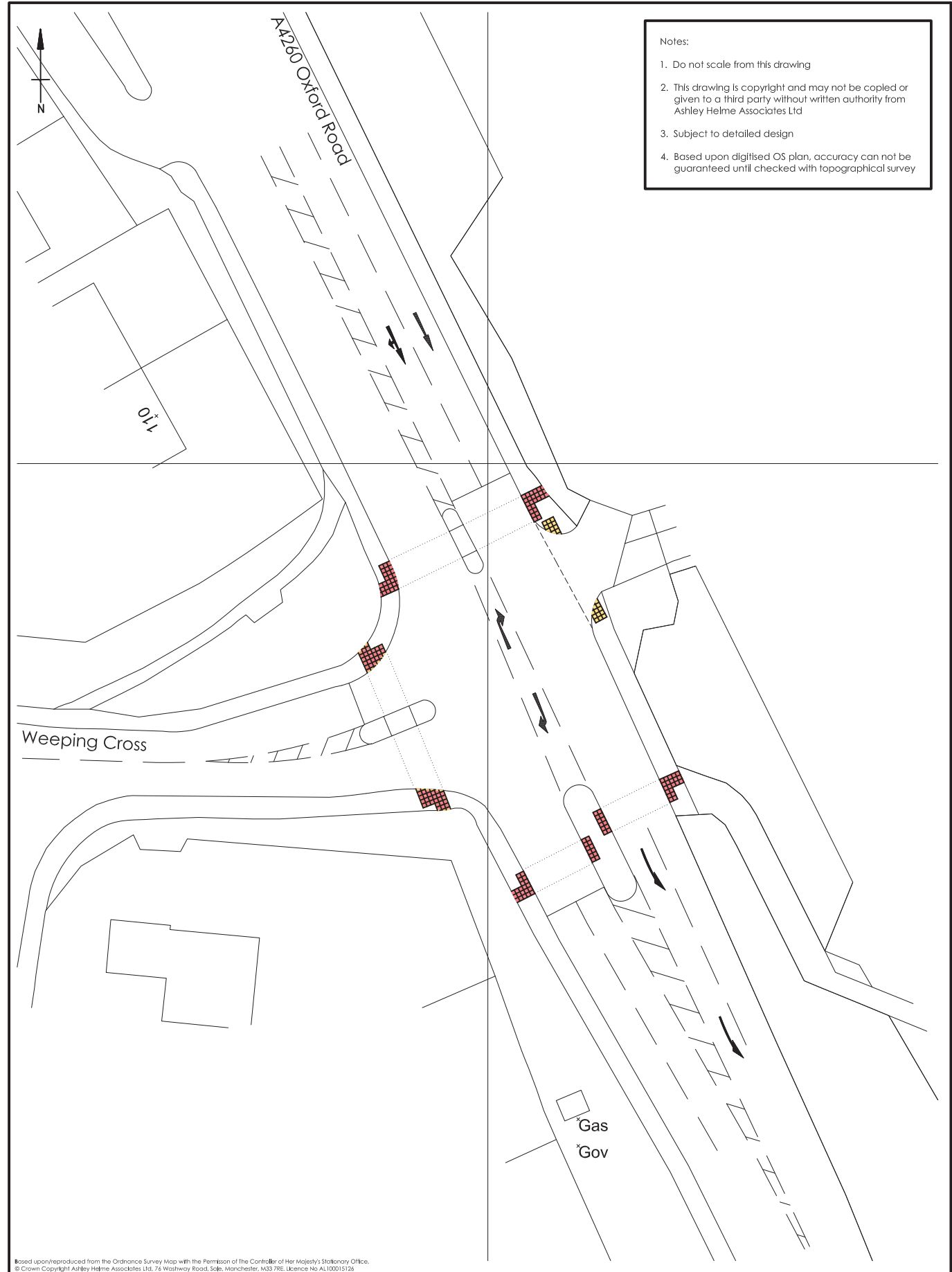

Notes:

1. Do not scale from this drawing
2. This drawing is copyright and may not be copied or given to a third party without written authority from Ashley Helme Associates Ltd
3. Subject to detailed design
4. Based upon digitised OS plan, accuracy can not be guaranteed until checked with topographical survey

Based upon/reproduced from the Ordnance Survey Map with the Permission of the Controller of Her Majesty's Stationary Office.
 © Crown Copyright Ashley Helme Associates Ltd, 76 Washway Road, Sale, Manchester, M33 7RE. Licence No AL100015126

ashleyhelme
associates
 76 washway road, sale, manchester, m33 7re
 e: aha@ashleyhelme.co.uk t: 0161 972 0552 f: 0161 972 0553

Project
**LAND TO THE WEST OF WHITE
 POST ROAD, BANBURY**

Client
**GLADMAN
 DEVELOPMENTS**

Drawing No
1361/15

Rev

Title
**EXISTING JUNCTION ARRANGEMENTS:
 STUDY JUNCTION 5**

Date
MAY 2015

Scale
1:500 @ A4

This page has been
left intentionally
blank

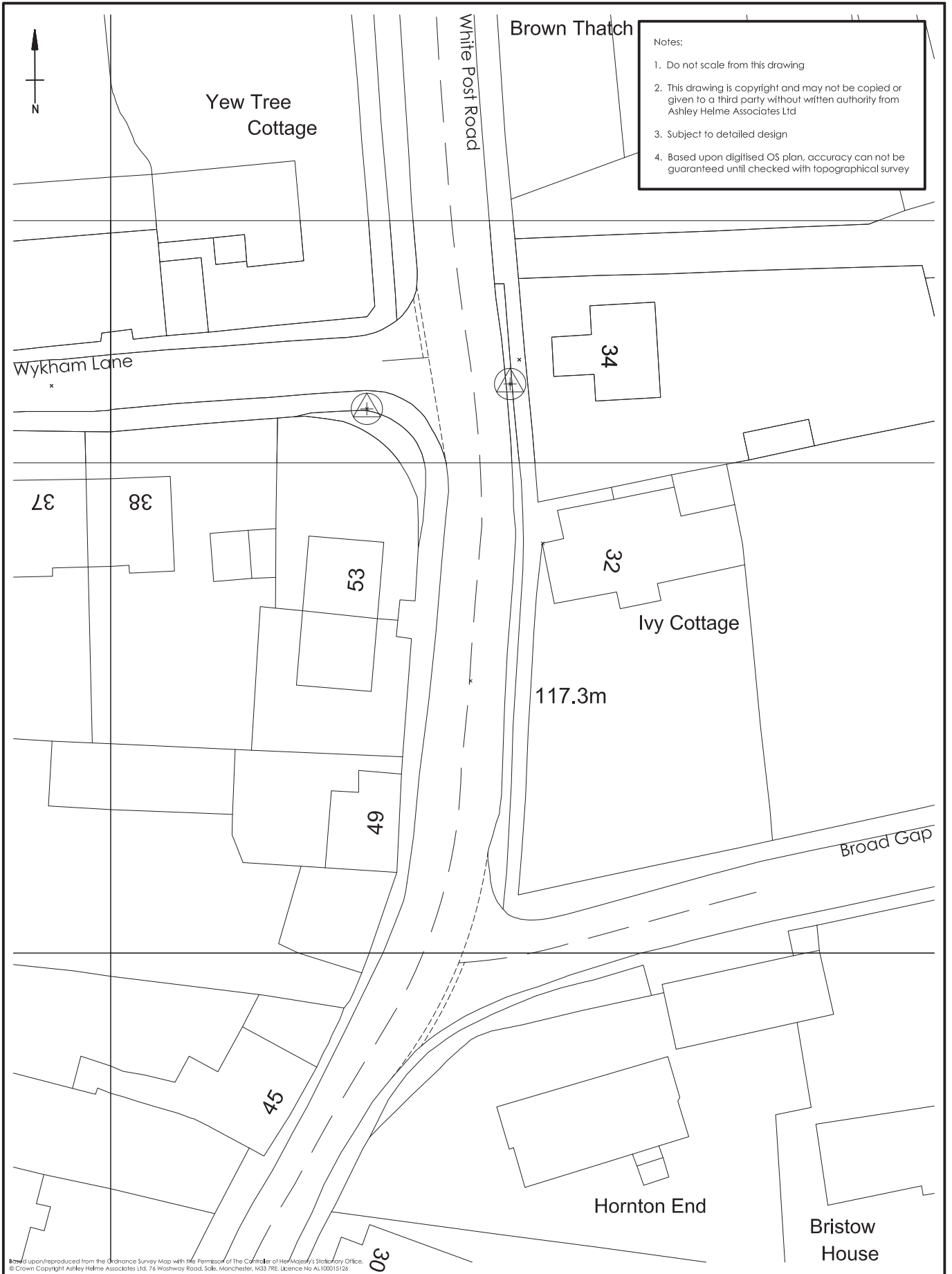

Notes:

1. Do not scale from this drawing
2. This drawing is copyright and may not be copied or given to a third party without written authority from Ashley Helme Associates Ltd
3. Subject to detailed design
4. Based upon digitised OS plan, accuracy can not be guaranteed until checked with topographical survey

Based upon/reproduced from the Ordnance Survey Map with the Permission of the Controller of Her Majesty's Stationary Office
 © Crown Copyright Ashley Helme Associates Ltd, 76 Washway Road, Sale, Manchester, M33 7RE. Licence No AL100015126

ashleyhelme
associates
 76 washway road, sale, manchester, m33 7re
 e: aha@ashleyhelme.co.uk t: 0161 972 0552 f: 0161 972 0553

Project
**LAND TO THE WEST OF WHITE
 POST ROAD, BANBURY**

Client
**GLADMAN
 DEVELOPMENTS**

Drawing No
1361/16

Rev

Title
**EXISTING JUNCTION ARRANGEMENTS:
 STUDY JUNCTIONS 6 & 7**

Date
MAY 2015

Scale
1:500 @ A4

This page has been
left intentionally
blank

- Notes:
1. Do not scale from this drawing
 2. This drawing is copyright and may not be copied or given to a third party without written authority from Ashley Helme Associates Ltd
 3. Subject to detailed design
 4. Based upon digitised OS plan, accuracy can not be guaranteed until checked with topographical survey



Based upon/reproduced from the Ordnance Survey Map with the Permission of The Controller of Her Majesty's Stationary Office.
 © Crown Copyright Ashley Helme Associates Ltd, 76 Washway Road, Sale, Manchester, M33 7RE. Licence No AL100015126

 <p>76 washway road, sale, manchester, m33 7re e: aha@ashleyhelme.co.uk t: 0161 972 0552 f: 0161 972 0553</p>	Project LAND TO THE WEST OF WHITE POST ROAD, BANBURY	Client GLADMAN DEVELOPMENTS	Drawing No 1361/17	Rev
	Title EXISTING JUNCTION ARRANGEMENTS: STUDY JUNCTION 8	Date MAY 2015	Scale 1:500 @ A3	

This page has been
left intentionally
blank

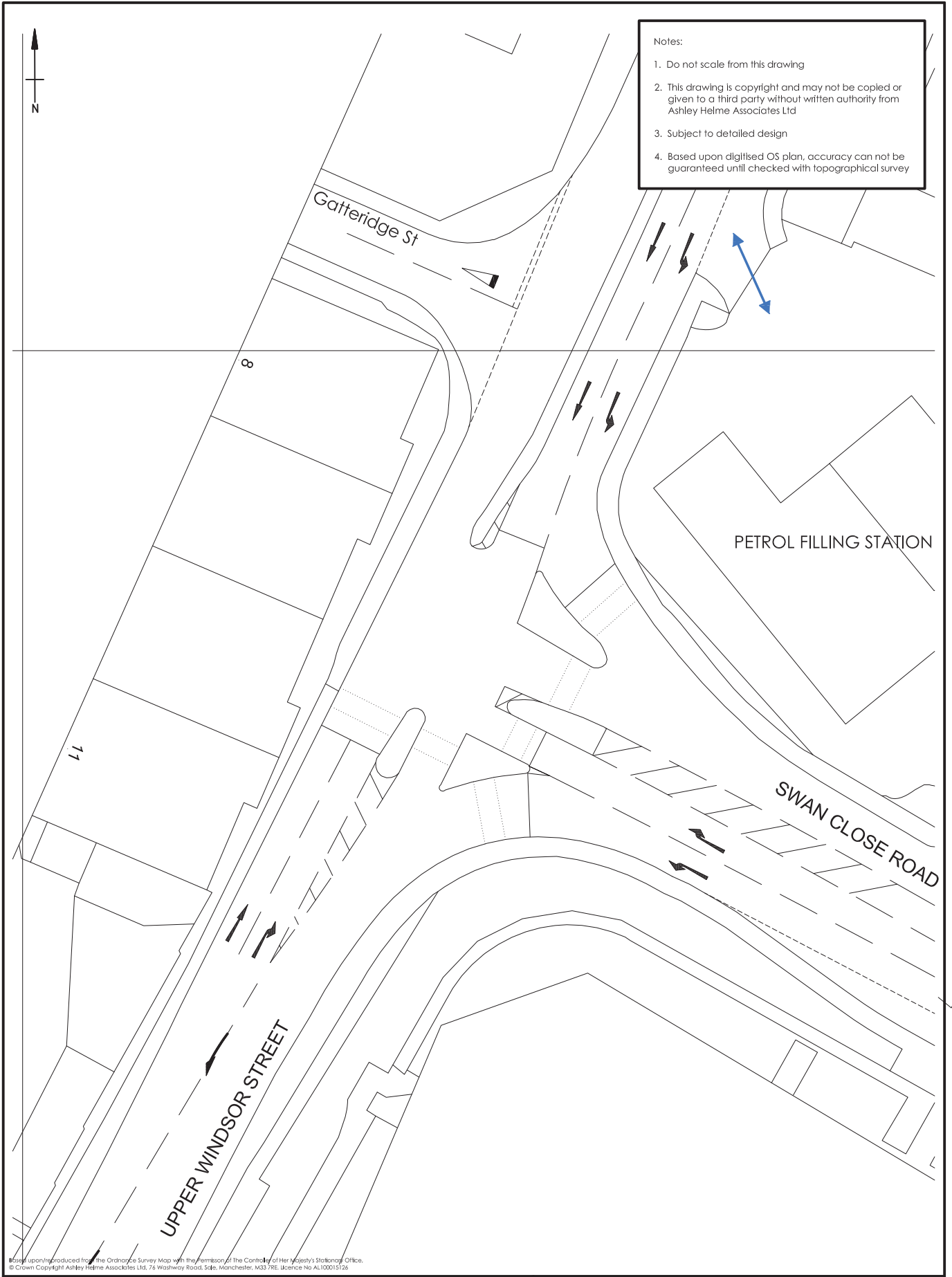

Based upon digitised OS plan, accuracy can not be guaranteed until checked with topographical survey.
 © Crown Copyright Ashley Helme Associates Ltd, 76 Washway Road, Sale, Manchester, M33 7RE. Licence No AL100015126

 76 washway road, sale, manchester, m33 7re e: aha@ashleyhelme.co.uk t: 0161 972 0552 f: 0161 972 0553	Project LAND TO THE WEST OF WHITE POST ROAD, BANBURY	Client GLADMAN DEVELOPMENTS	Drawing No 1361/18	Rev
	Title EXISTING JUNCTION ARRANGEMENTS: STUDY JUNCTION 13		Date MAY 2015	Scale 1:500 @ A4

This page has been
left intentionally
blank

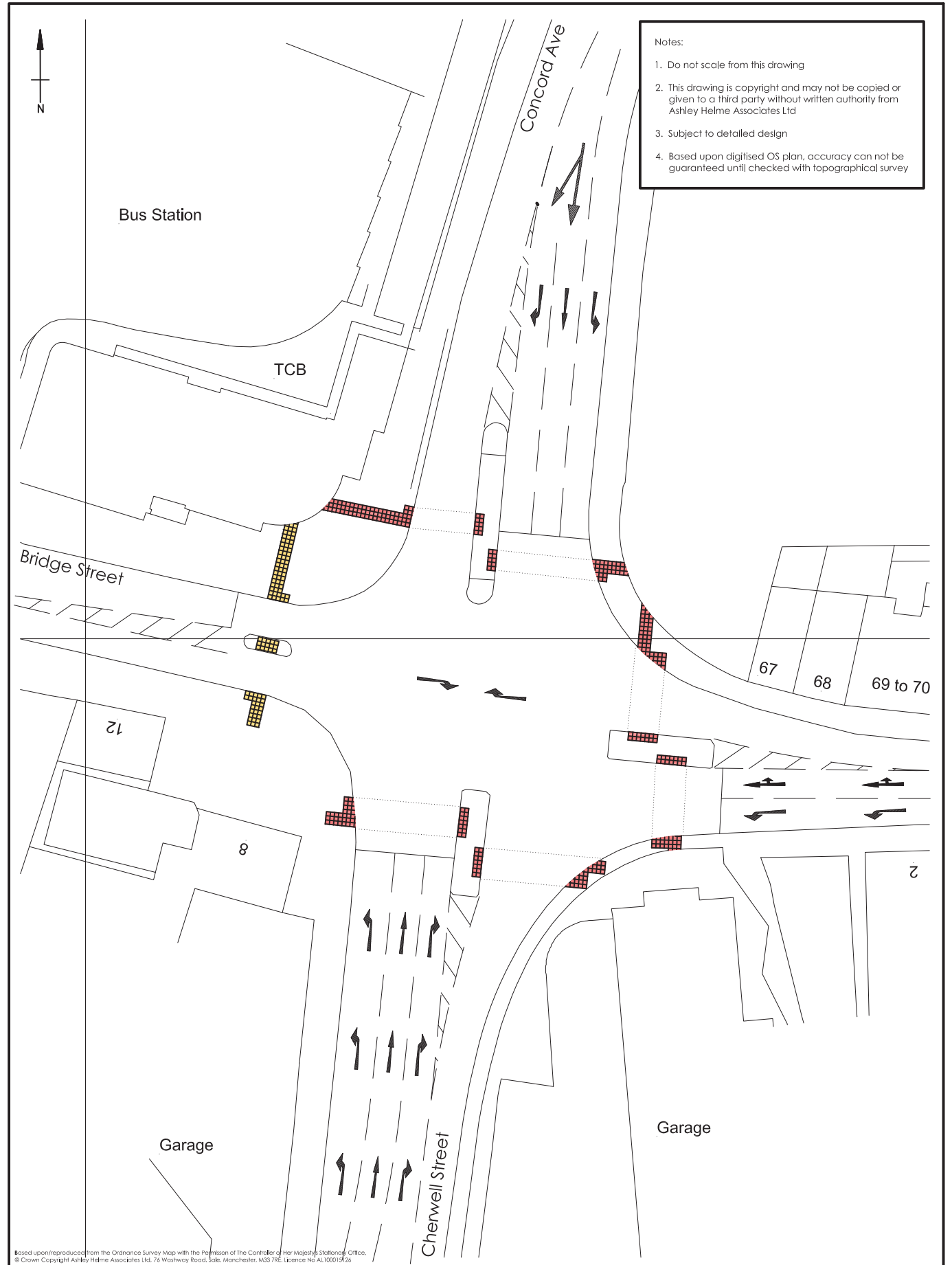

Based upon/reproduced from the Ordnance Survey Map with the Permission of the Controller of Her Majesty's Stationery Office.
 © Crown Copyright Ashley Helme Associates Ltd, 76 Washway Road, Sale, Manchester, M33 7RE. Licence No A1100015726

ashleyhelme
associates
 76 washway road, sale, manchester, m33 7re
 e: aha@ashleyhelme.co.uk t: 0161 972 0552 f: 0161 972 0553

Project	LAND TO THE WEST OF WHITE POST ROAD, BANBURY
Title	EXISTING JUNCTION ARRANGEMENTS: STUDY JUNCTION 14

Client	GLADMAN DEVELOPMENTS
--------	----------------------

Drawing No	1361/19	Rev	
Date	MAY 2015	Scale	1:500 @ A4

This page has been
left intentionally
blank

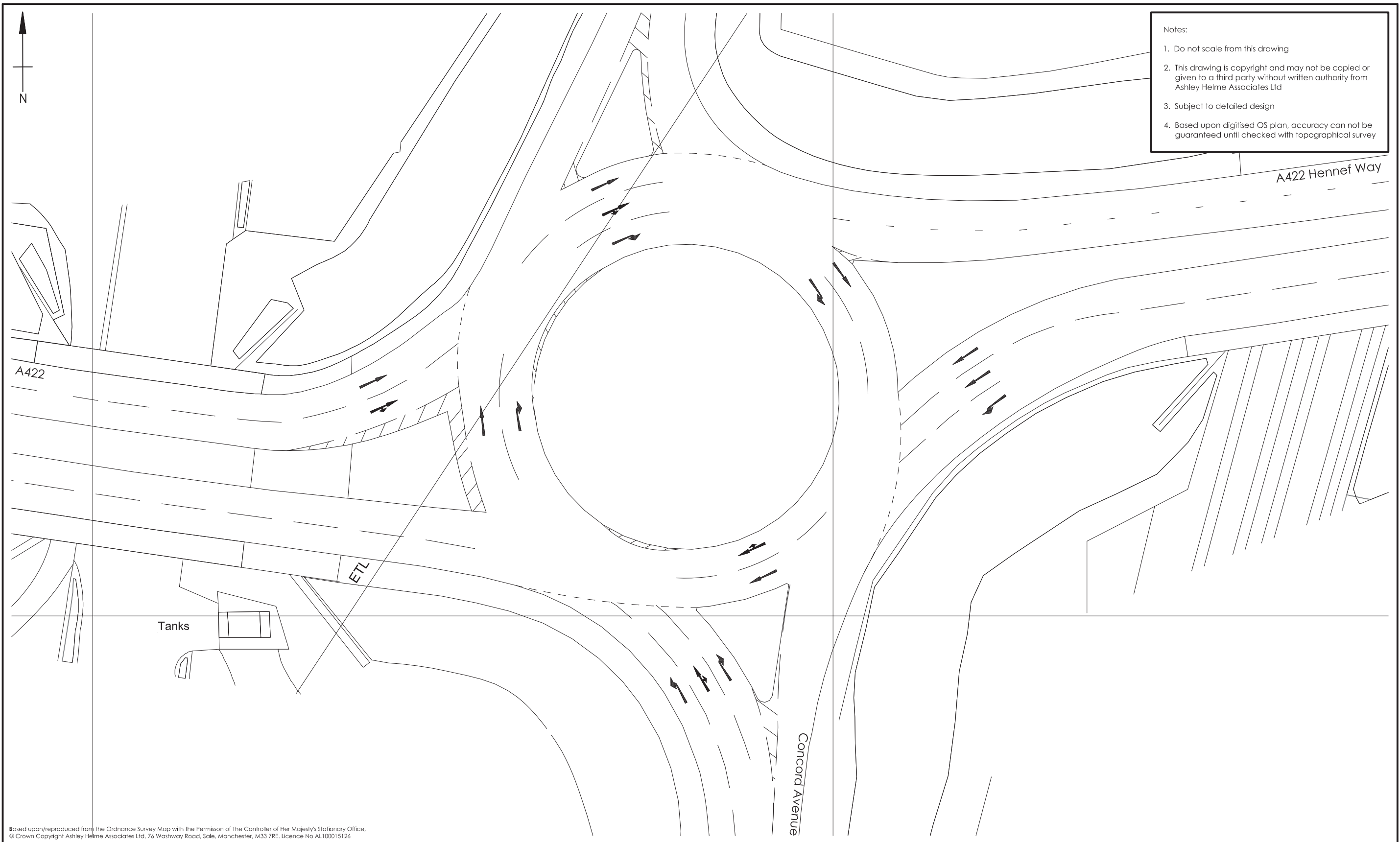

- Notes:
1. Do not scale from this drawing
 2. This drawing is copyright and may not be copied or given to a third party without written authority from Ashley Helme Associates Ltd
 3. Subject to detailed design
 4. Based upon digitised OS plan, accuracy can not be guaranteed until checked with topographical survey

Based upon/reproduced from the Ordnance Survey Map with the Permission of The Controller of Her Majesty's Stationary Office.
 © Crown Copyright Ashley Helme Associates Ltd, 76 Washway Road, Sale, Manchester, M33 7RE. Licence No AL100015126

Project	LAND TO THE WEST OF WHITE POST ROAD, BANBURY	Title	EXISTING JUNCTION ARRANGEMENTS: STUDY JUNCTION 15	Drawing No	1361/20	Rev	
Client	GLADMAN DEVELOPMENTS			Date	MAY 2015	Scale	1:500 @ A3

ashleyhelme
associates
 76 washway road, sale, manchester, m33 7re
 e: aha@ashleyhelme.co.uk t: 0161 972 0552 f: 0161 972 0553

This page has been
left intentionally
blank

Notes:

1. Do not scale from this drawing
2. This drawing is copyright and may not be copied or given to a third party without written authority from Ashley Helme Associates Ltd
3. Subject to detailed design
4. Based upon topographical survey

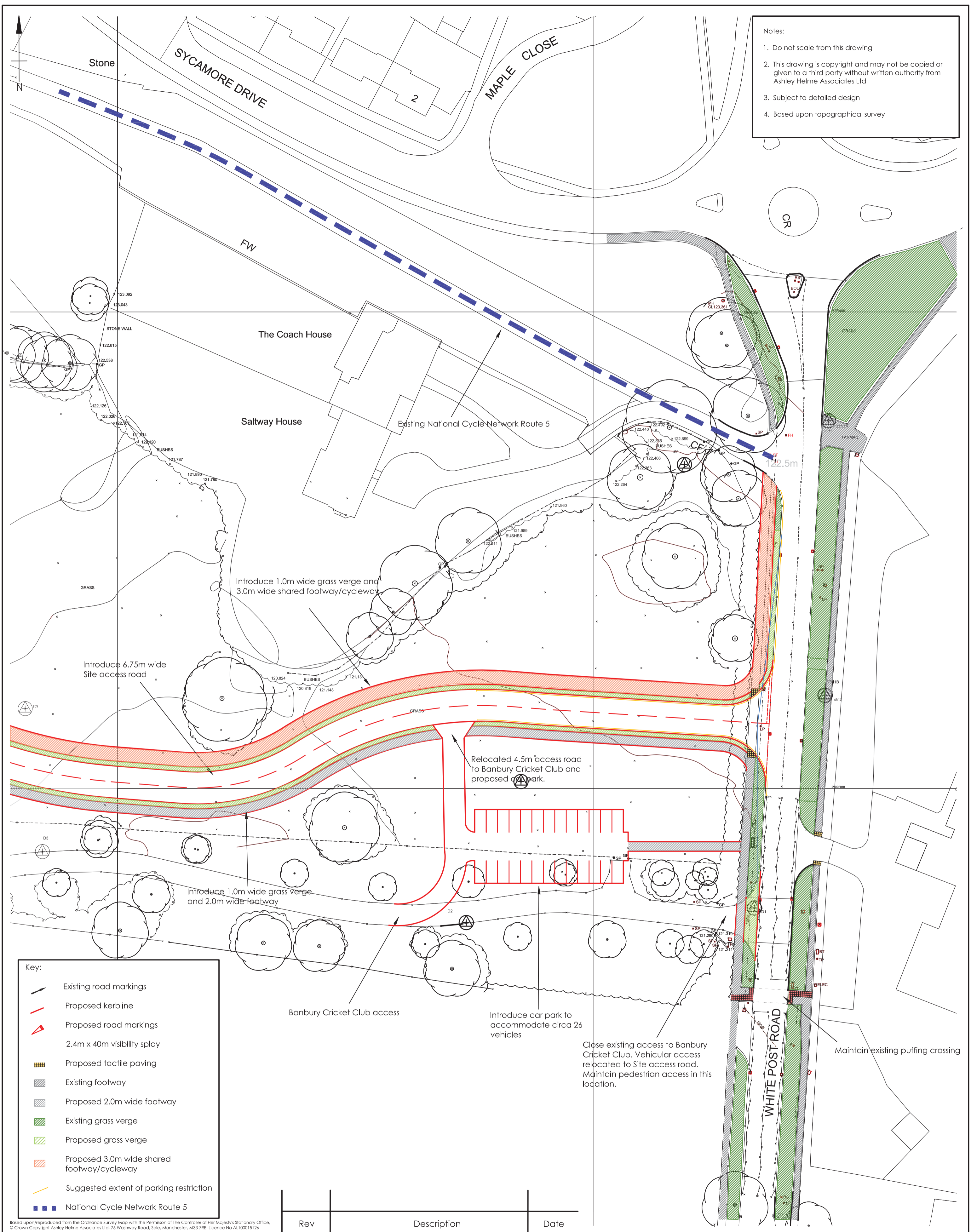

Key:

- Existing road markings
- Proposed kerbline
- Proposed road markings
- 2.4m x 40m visibility splay
- Proposed tactile paving
- Existing footway
- Proposed 2.0m wide footway
- Existing grass verge
- Proposed grass verge
- Proposed 3.0m wide shared footway/cycleway
- Suggested extent of parking restriction
- National Cycle Network Route 5

Rev	Description	Date

Project: LAND TO THE WEST OF WHITE POST ROAD, BANBURY		Client: GLADMAN DEVELOPMENTS LTD		Drawing No: 1361/21		Rev:	
Title: PROPOSED ACCESS ARRANGEMENTS: PRIORITY CONTROLLED T-JUNCTION				Date: MAY 2015		Scale: 1:500@A2	

ashleyhelme
associates
 76 washway road, sale, manchester, m33 7re
 e: aha@ashleyhelme.co.uk t: 0161 972 0552 f: 0161 972 0553

Based upon/reproduced from the Ordnance Survey Map with the Permission of the Controller of Her Majesty's Stationary Office. © Crown Copyright Ashley Helme Associates Ltd, 76 Washway Road, Sale, Manchester, M33 7RE. Licence No AL100015126

This page has been
left intentionally
blank