

- Notes:
1. Do not scale from this drawing
 2. This drawing is copyright and may not be copied or given to a third party without written authority from Ashley Helme Associates Ltd
 3. Subject to detailed design
 4. Based upon topographical survey

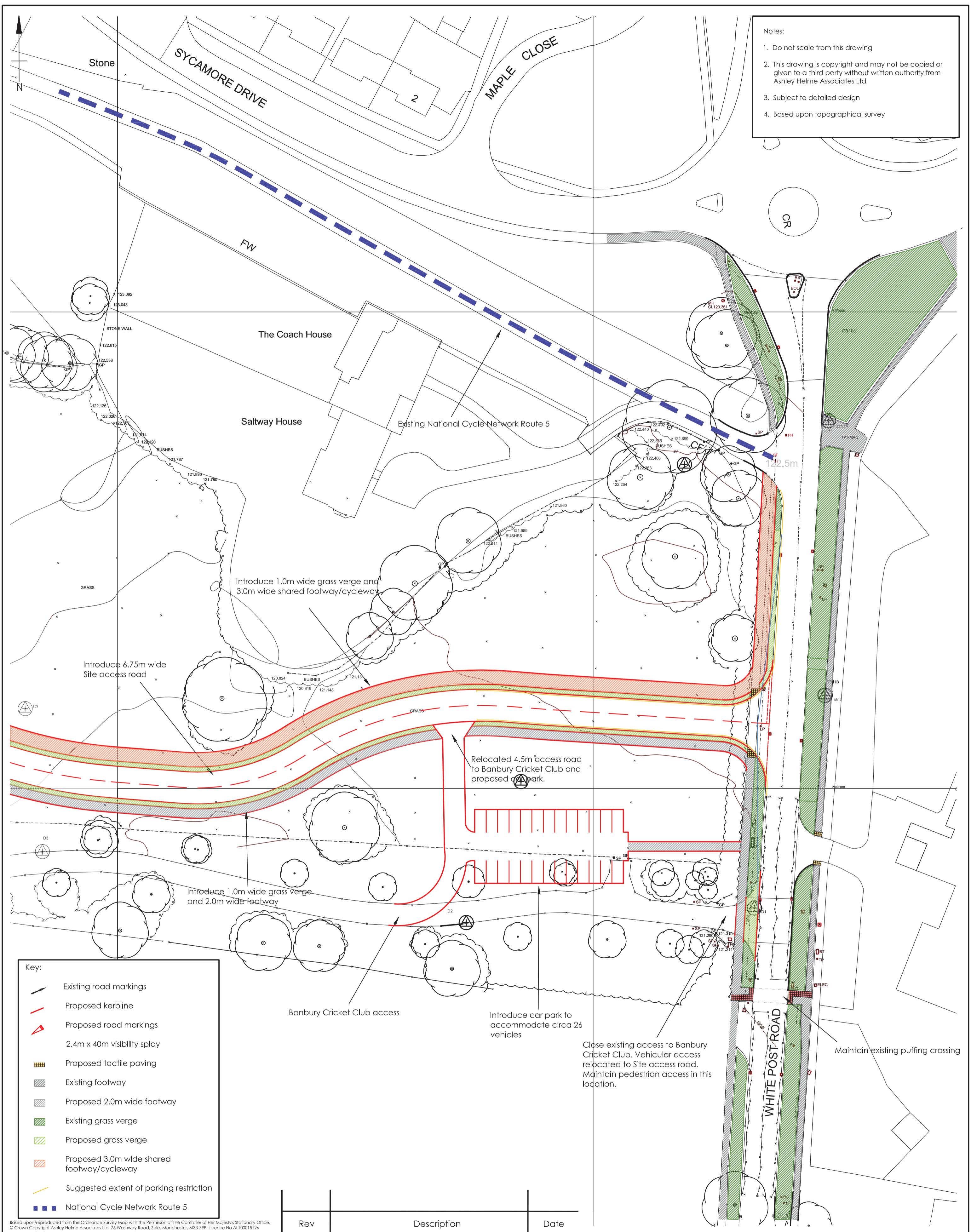

Key:

- Existing road markings
- Proposed kerbline
- Proposed road markings
- 2.4m x 40m visibility splay
- Proposed tactile paving
- Existing footway
- Proposed 2.0m wide footway
- Existing grass verge
- Proposed grass verge
- Proposed 3.0m wide shared footway/cycleway
- Suggested extent of parking restriction
- National Cycle Network Route 5

Rev	Description	Date

Project LAND TO THE WEST OF WHITE POST ROAD, BANBURY	Client GLADMAN DEVELOPMENTS LTD	Drawing No 1361/21	Rev 	 76 washway road, sale, manchester, m33 7re e: aha@ashleyhelme.co.uk t: 0161 972 0552 f: 0161 972 0553
Title PROPOSED ACCESS ARRANGEMENTS: PRIORITY CONTROLLED T-JUNCTION		Date MAY 2015	Scale 1:500@A2	

Based upon/reproduced from the Ordnance Survey Map with the Permission of the Controller of Her Majesty's Stationary Office. © Crown Copyright Ashley Helme Associates Ltd, 76 Washway Road, Sale, Manchester, M33 7RE. Licence No AL100015126