

Legend

- PERMANENT LAND EASEMENT BOUNDARY
- NETWORK RAIL BOUNDARY (INDICATIVE)
- PROPOSED GRASS SEEDING (NATIVE SPECIES GRASSLAND MIX)
- PROPOSED WET WOODLAND PLANTING
- PROPOSED HEDGE PLANTING
- EXISTING HEDGEROW TO BE RETAINED
- PROPOSED SPECIMEN TREES
- PROPOSED POST AND 4 RAIL DONE BY OTHERS
- PROPOSED SURFACE WATER DITCH DONE BY OTHERS
- PROPOSED PALISADE FENCING DONE BY OTHERS

NOTES

All trees to be planted Double Staked. Refer to construction details within Specification for Soft Landscape Works.

The Contractor is to familiarise themselves with the locations of any services prior to commencement of work on site.

The setting out and extent of planting is to be confirmed on site prior to implementation of the works.

Drawing produced on the Snakegrid coordinate system

This drawing is based on:

- LANDSCAPE GENERAL ARRANGEMENT PLAN (5114534-ATK-DRG-AR-907353)
- EWR P1 CO-ORDINATION DRAWING SHEET 27 OF 38 (5114534-ATK-DRG-MD-700227)
- PROPOSED BOUNDARY FENCING AND ACCESS STRATEGY SHEET 27 OF 38 (5114534-ATK-MOD-MD-705227)

All works have been designed in accordance with network rail recommended planting species matrix V2.1. all planting is located in XS of 5m distance from running rails.

Access for maintenance via OS Grid Reference 457553, 220324. Road Rail Access.

Hedge and Tree alignment is indicative and for illustrative purposes and will follow Limit of Deviation that will be confirmed on site.

Field gate location is indicative only.

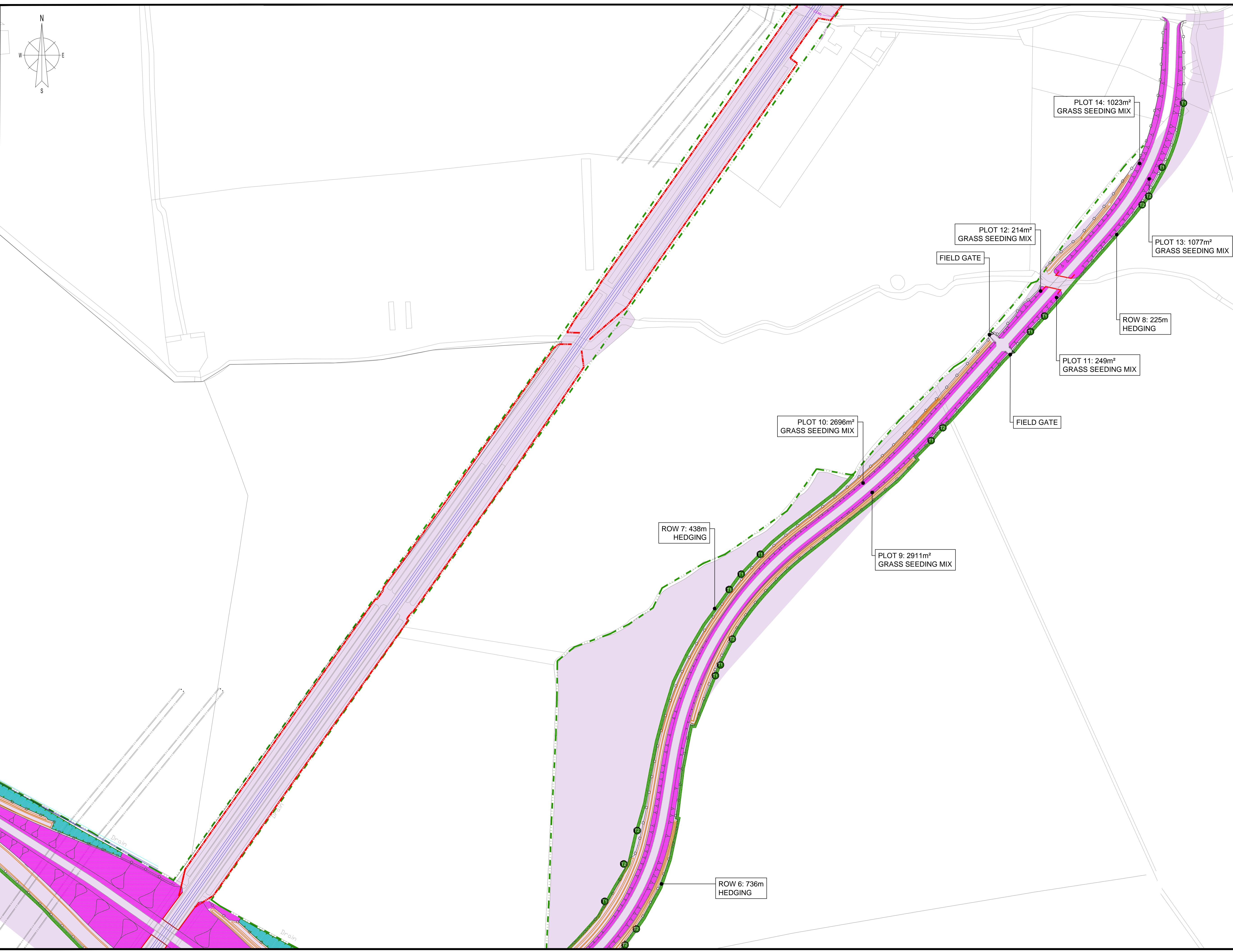

Rev.	Date	Amendment	Drawn	Chkd.	Appd.
01	28/09/15	Updated road layout and revised planting plan	RP	SF	SF

RSK

18 Frogmore Road, Hemel Hempstead, Herts, HP3 9RT. Tel: +44 (0) 1442 437590 Fax: +44 (0) 1442 437550 Email: info@rsk.co.uk Web: www.rsk.co.uk

Client
CARILLION BUCKINGHAM JOINT VENTURE

Project Title
EAST WEST RAIL PHASE 1

Drawing Title
LANGFORD LANE OVERBRIDGE LANDSCAPE GENERAL ARRANGEMENT PLAN SHEET 2/3

Drawn	Date	Checked	Date	Approved	Date
CN	27/07/15	SF	27/07/15	SF	27/07/15

Scale 1:1250 Drawing File: RSK/M/1121097/04/02/06/C01 Rev. P1

Scale 1:1250 0 25 50 m

The drawing includes map data licenced from Ordnance survey. © Crown copyright and database right 2013 Ordnance Survey 0100040692