

Tree Pit Adjacent Road Carriage

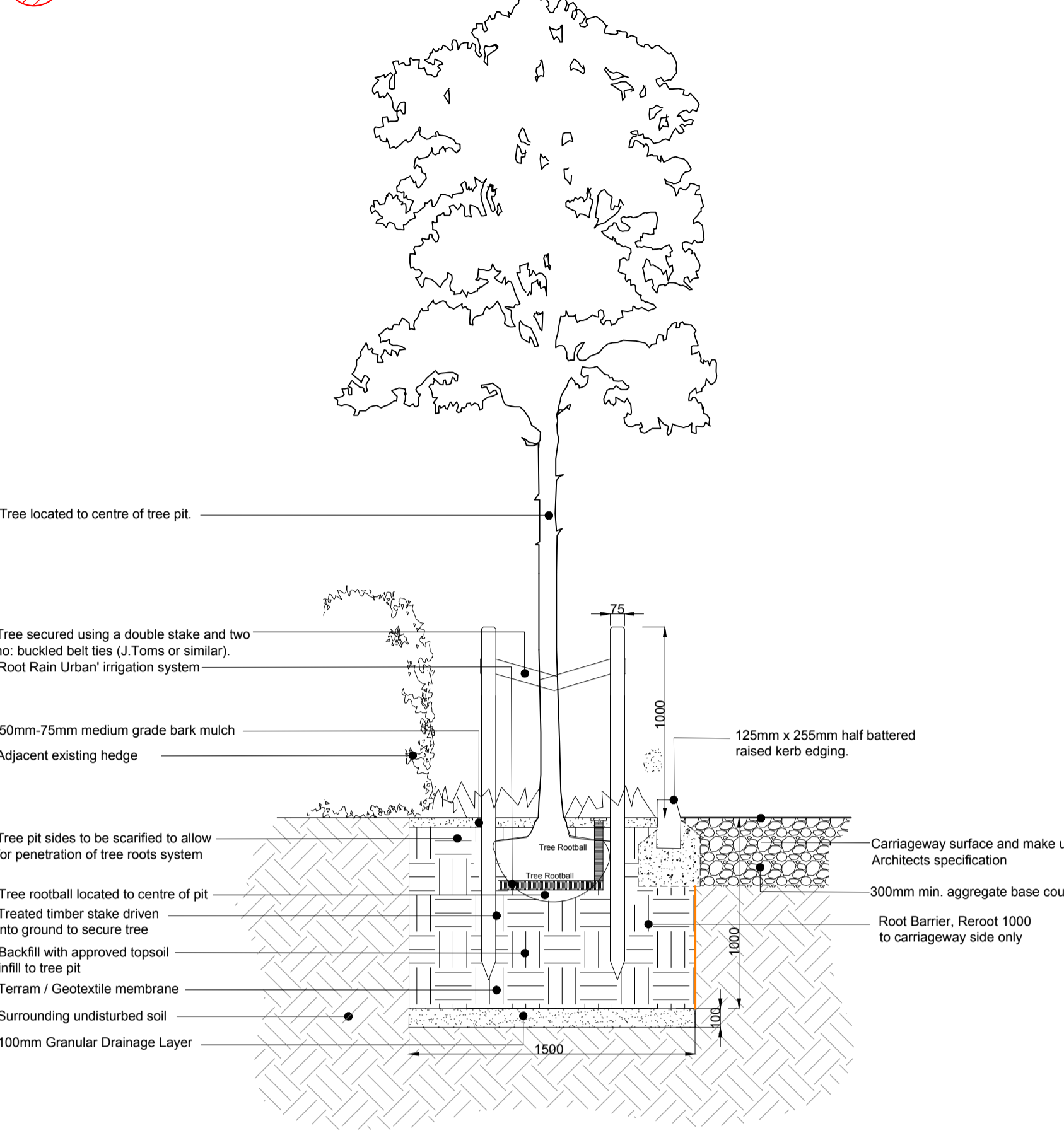

Tree Pit Detail 1
Elevation View
Scale 1:25 @ A1

Tree Pit Adjacent Footway

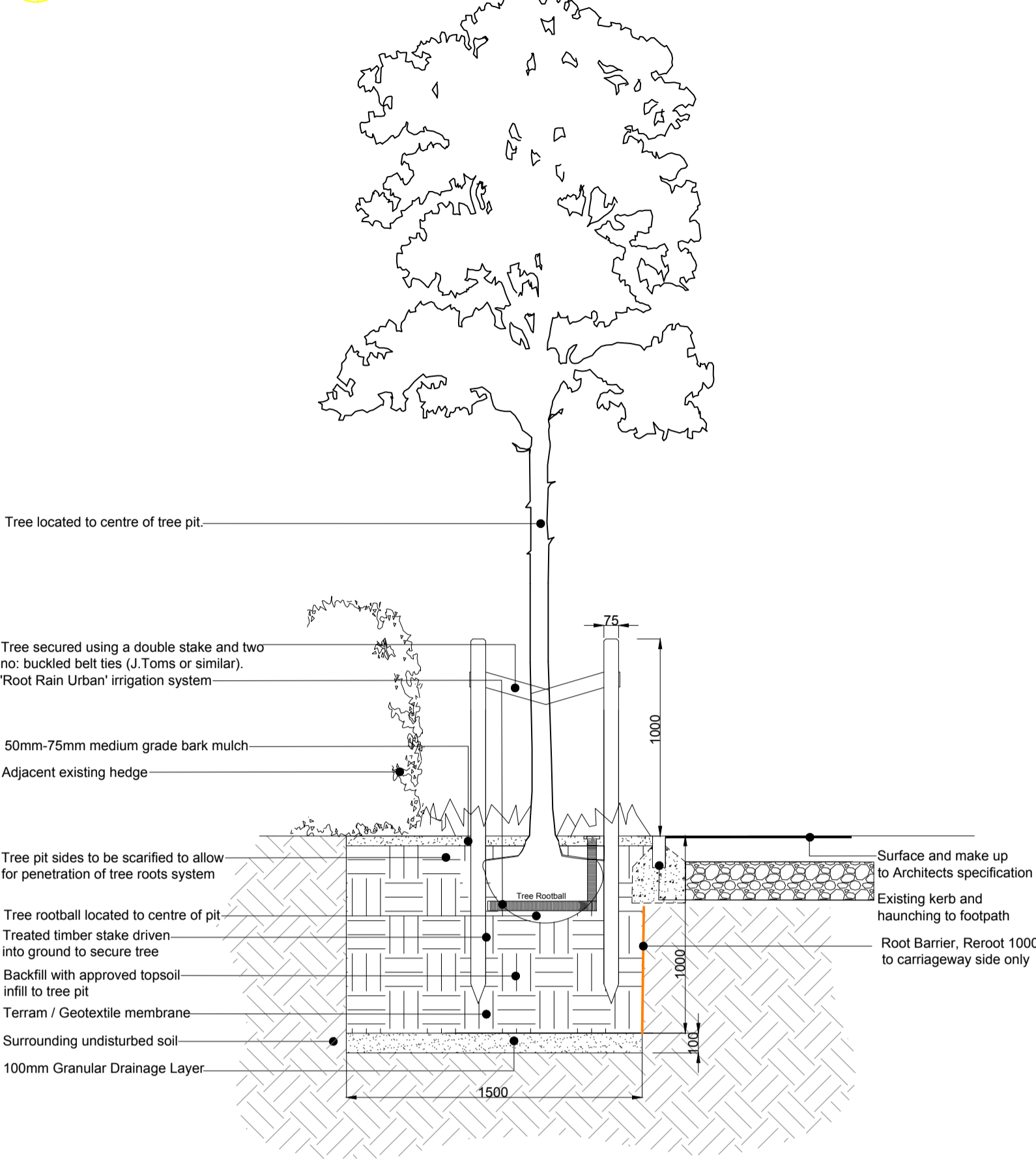

Tree Pit Detail 2
Elevation View
Scale 1:25 @ A1

Hard Landscape Tree Pit

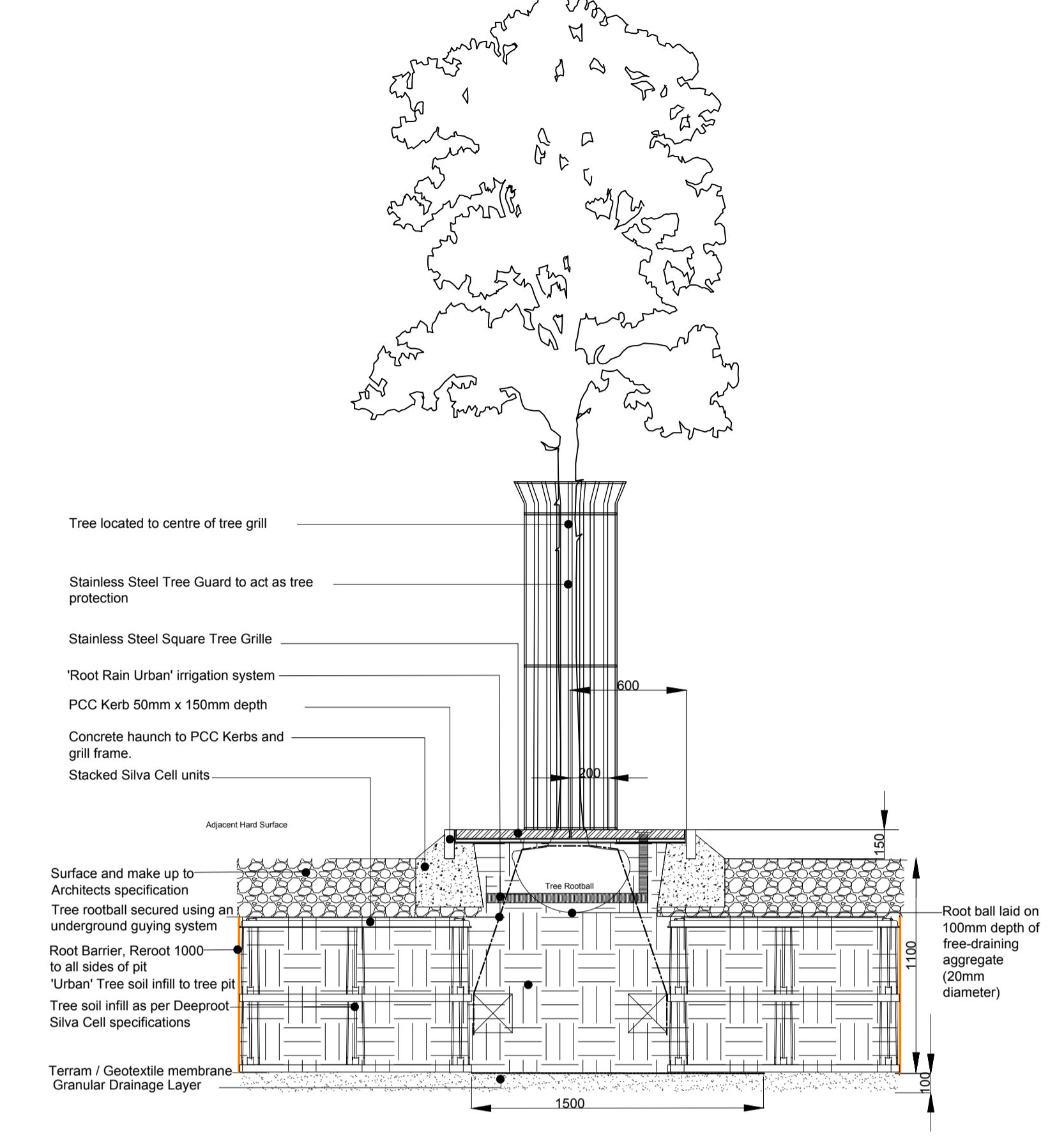

Tree Pit Detail 3
Elevation View
Scale 1:25 @ A1

NOTES:
Based upon the Ordnance Survey map with permission of The Controller of Her Majesty's Stationery Office. © Crown Copyright.
Aspect Landscape Planning Ltd, West Court, Harbeck Business Park, Noral Way, Banbury OX18 2AF.
Licence 100045345
Copyright reserved
No Dimensions to be scaled from this drawing.

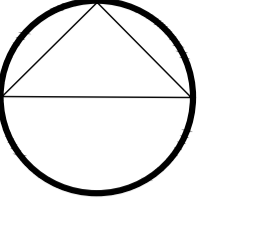

Root Barrier:
Trees within or adjacent to hard surfaces, built form and where underground services are located will require root barriers to be installed.
Reroot 1000 or similar should be used where necessary within 3m of proposed tree stem.

Tree Pit Adjacent to Road Carriage and footway

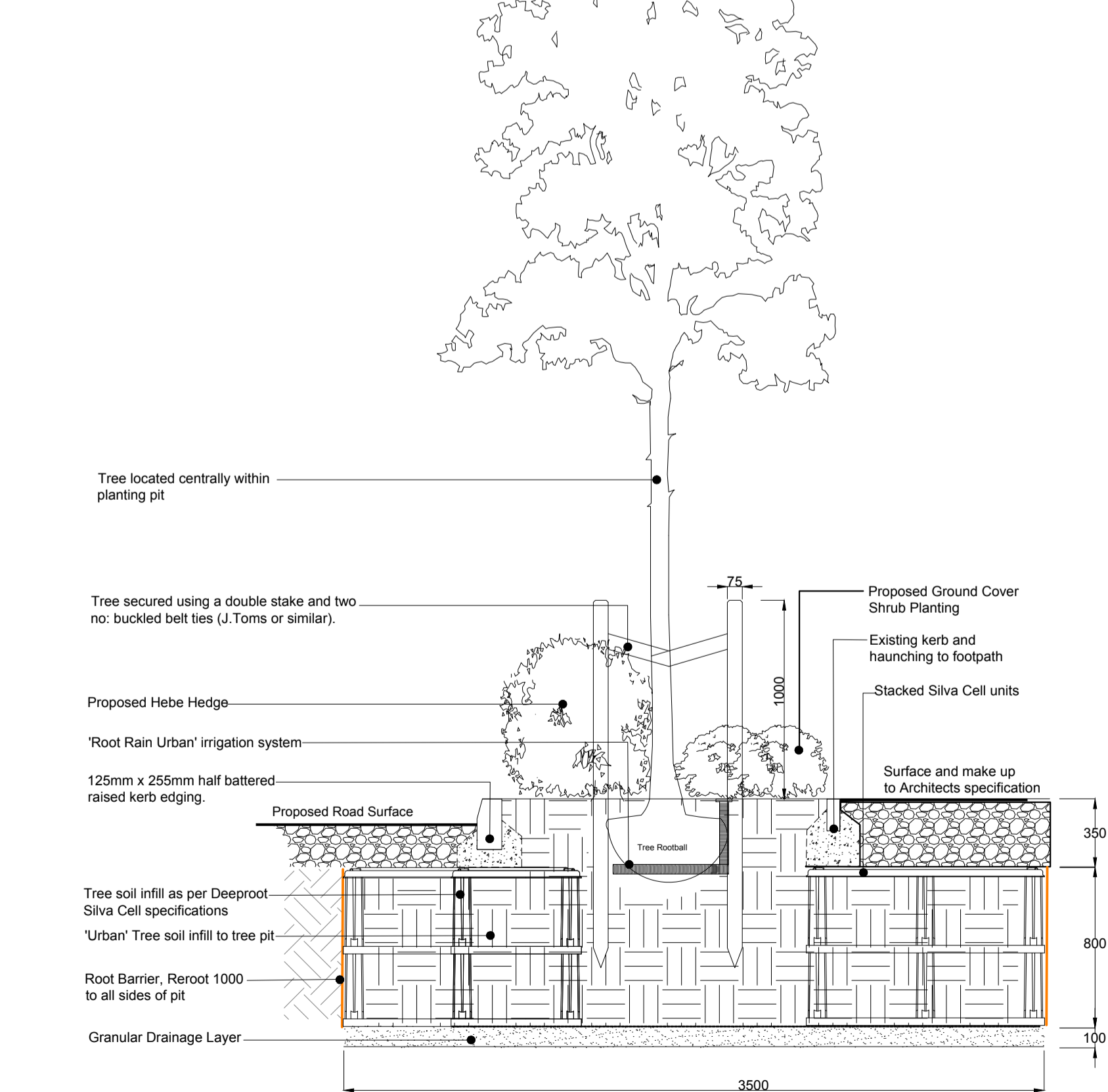

Tree Pit Detail 4
Elevation View
Scale 1:25 @ A1

Tree Pit Within Soft Landscape Area

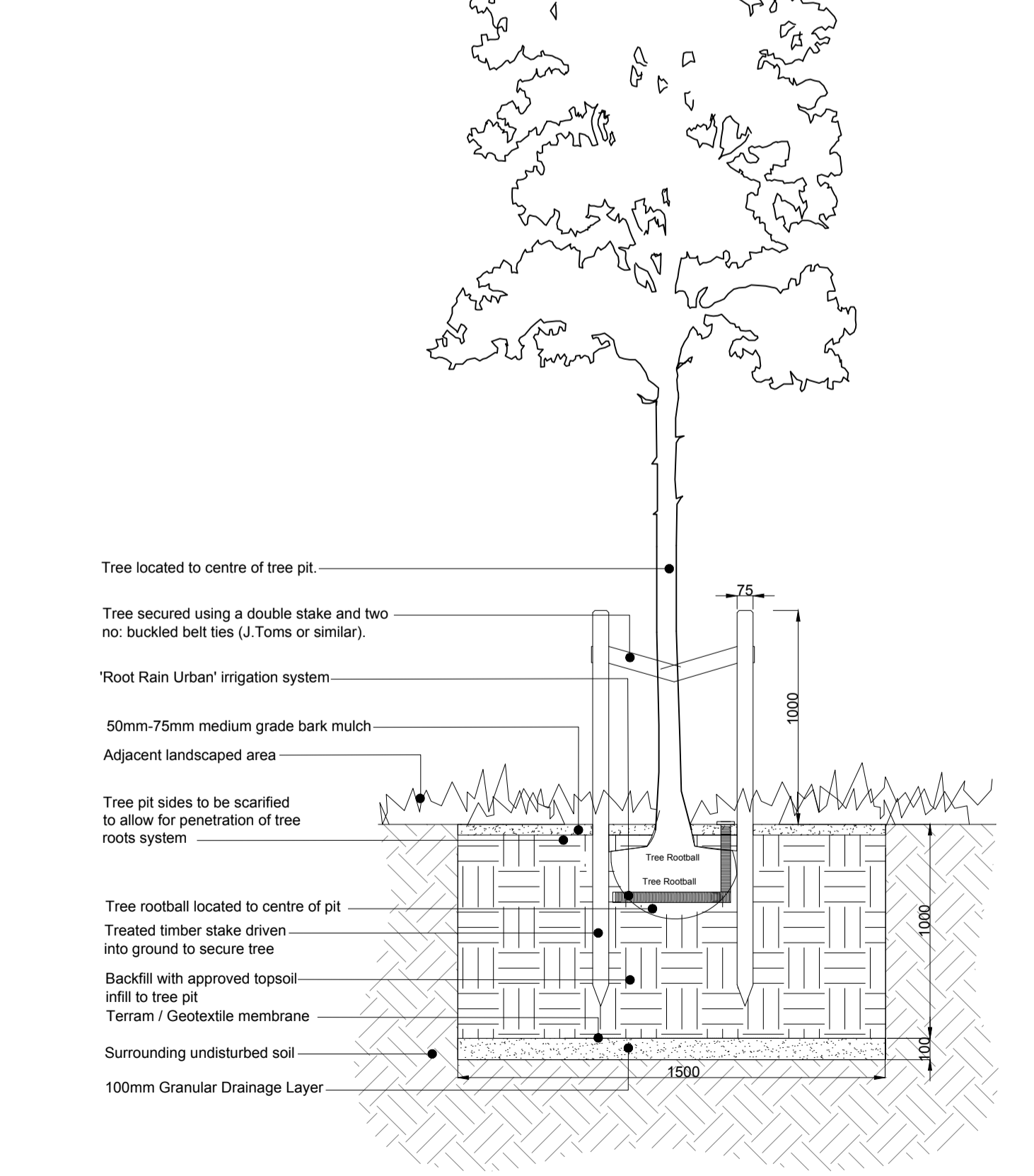

Tree Pit Detail 5
Elevation View
Scale 1:25 @ A1

REV	DATE	NOTE	DRAWN	CHKD
G	16.06.16	Tree locations updated to include landscape officer comments	BS	
F	23.05.16	Parcel C planting and 1 street tree removed	BS	
E	03.05.16	Tree locations updated to include landscape officer comments	BS	
D	07.04.16	Updated to include landscape officer comments	CW	BS
C	11.03.16	Community Hall layout updated, cycle rack location amended	BS	AM
B	16.12.15	Hard and soft landscape amended to suit new layout and to include CDC latest comments	BS	AM
A	05.10.15	Service bay hard and soft proposals amended	BS	AM

REVISIONS

aspect landscape planning

TITLE
Longford Park, Banbury Village Centre- Tree Pit Details

CLIENT
Barratt Homes, Bovis & Taylor Wimpey Homes

SCALE: DATE: DRAWN:
Refer to drawing SEPT 2015 BS

DRAWING NUMBER: REVISION:
5205/ ASP.VC.TPD.1.3 G