

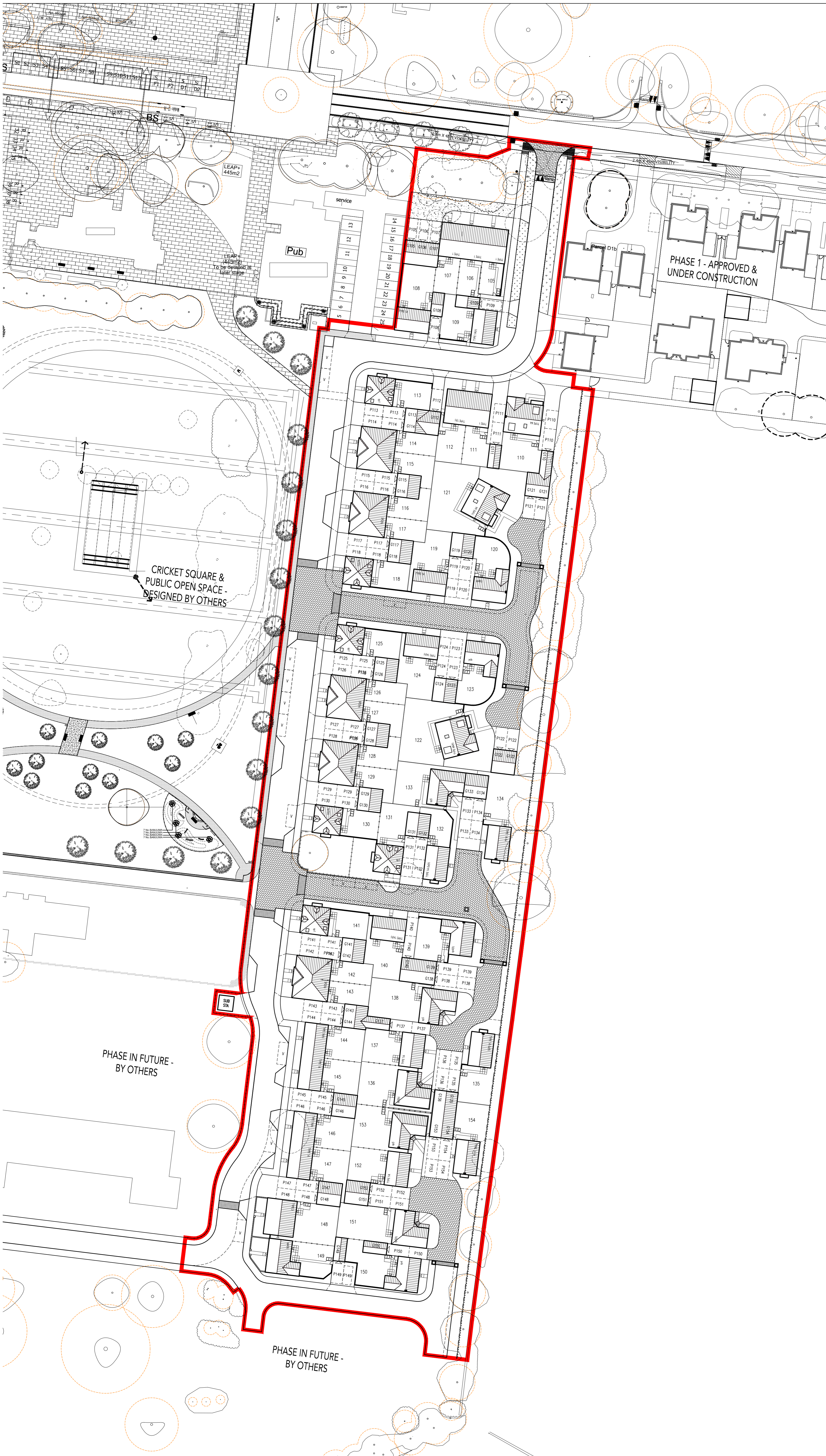

REVISIONS:

- A. 2014-10-20. Plots 9-14, 21-26 & 37-39 re-positioned and road layout in-front of those plots redesigned, sub-station relocated, gravel surface added on the private drive in front of plots 1-3 (now 105-107), shingle/stone rolled tarmac added on the private drives village green design updated, plots 6, 17, 18 swapped with type 4A and side access to plot 29 amended, Plot 20 & 36 handed, redline amended and plots 1-50 renumbered as 105-154 to suit with other parcels following Local Authority's comments. SRS
- 2014-10-24. Visitors' spaces at the southern boundary removed & redline boundary amended and footprints for SP1 & SP2 amended following the house type booklet Issue 2. SRS
- B. 2014-10-29. The frontal projections on plots 114-117, 126-129, 142 & 149 made 300mm wider, garages for plots 115-118, 125-130, 141 & 42 made eaves fronted, roof form on plots 112-114 changed, plot 139 re-aligned and plot 109 handed following Local Authority's comments. SRS



LEGEND

	APPLICATION BOUNDARY	
<b>EXISTING VEGETATION</b>		
	EXISTING TREE TO BE RETAINED	
	EXISTING HEDGEROW	
<b>EXTERNAL BOUNDARY TREATMENTS</b>		
	1800mm HIGH SCREEN WALL WITH 100mm LAYOUT DETAIL FOR MATERIALS	
	1800mm HIGH CLOSE BOARD TIMBER FENCE	
	1000mm HIGH PER POST TO MATERIAL LAYOUT DETAIL FOR MATERIALS	
	1800mm HIGH PER POST TO MATERIAL LAYOUT DETAIL FOR MATERIALS	
	1800mm HIGH DIVISION PANEL FENCE	
	1500mm HIGH POST & RAIL FENCE	
	300mm HIGH TIMBER KNEE RAIL	
<b>NUMBERING</b>		
12	PLOT NUMBERS	G12
P12	PARKING NUMBERS	V
(N)	PLOT HANDING	C
<b>MISCELLANEOUS</b>		
	CHIMNEY	
	HANDED UNIT	
<b>GROUND SURFACING</b>		
	BLOCK PAVING-1	
	TARMAC	
	GRAVEL	
	BRICK SUB	
<b>LANDSCAPING</b>		
	PROPOSED NEW TREE WITH 1000mm LANDSCAPING DIMENSIONS FOR DETAIL	
	PROPOSED SHRUB OR HERBACEOUS PLANTING WITH 1000mm LANDSCAPING DIMENSIONS FOR DETAIL	

ACCOMMODATION SCHEDULE

OPEN MARKET				
Name	Stories	Bedrooms	sqft	
Type 1	2 Storey	3 Bed house	1023ft <sup>2</sup>	5
Type 1A	2 Storey	3 Bed house	1041ft <sup>2</sup>	11
Type 1A-sa (side access)	2 Storey	3 Bed house	1041ft <sup>2</sup>	4
SP4	2 Storey	3 Bed house	1205ft <sup>2</sup>	5
Type 3	2 Storey	3 Bed house	1442ft <sup>2</sup>	1
SP5	2 Storey	4 Bed house	1347ft <sup>2</sup>	5
SP1	2.5 Storey	4 Bed house	1534ft <sup>2</sup>	6
SP2	3 Storey	4 Bed house	1536ft <sup>2</sup>	10
Type 4A	2.5 Storey	5 Bed house	2159ft <sup>2</sup>	3
<b>GRAND TOTAL</b>				<b>50</b>

