

GENERAL NOTES.

1. DO NOT SCALE THIS DRAWING.
2. THIS DRAWING IS TO BE READ IN CONJUNCTION WITH ALL OTHER RELEVANT ENGINEERS, ARCHITECTS AND SPECIALIST DESIGN DRAWINGS AND DETAILS.
3. ALL DIMENSIONS ARE IN METRES UNLESS NOTED OTHERWISE. ALL LEVELS ARE IN METRES UNLESS NOTED OTHERWISE.
4. ANY DISCREPANCIES NOTED ON SITE ARE TO BE REPORTED TO THE ENGINEER IMMEDIATELY.
5. THE CONTRACTOR SHALL CHECK ALL TIE-INS FOR LINE AND LEVEL WITH EXISTING BEFORE COMMENCING ANY WORKS. THE ENGINEER SHALL BE NOTIFIED IMMEDIATELY IN WRITING, SHOULD ANY ERRORS BE FOUND.
6. IT IS THE RESPONSIBILITY OF THE CONTRACTOR TO LOCATE ANY SERVICE APPARATUS IN THE VICINITY OF THE WORKS. THE CLIENT WILL ACCEPT NO CLAIMS WHATSOEVER IN RESPECT OF ANY LOSSES OR DAMAGE CAUSED IN RESPECT OF SUCH APPARATUS, HOWEVER CAUSED.
7. IT IS THE RESPONSIBILITY OF THE CONTRACTOR TO EXECUTE THE WORKS AT ALL TIMES IN STRICT ACCORDANCE WITH THE REQUIREMENTS OF THE HEALTH AND SAFETY AT WORK ACT 1974, AND THE C.D.M. REGULATIONS 2007. THE CONTRACTOR WILL BE DEEMED TO HAVE ALLOWED FOR FULL COMPLIANCE, INCLUDING FULL LIAISON WITH THE CDM CO-ORDINATOR, WITHIN HIS RATES.
8. THE CONTRACTOR IS RESPONSIBLE FOR ENSURING THAT ALL WORKS ARE TO THE SATISFACTION OF THE ENGINEER, AND SHALL BE DEEMED TO HAVE INCLUDED WITHIN HIS RATES FOR ANY NECESSARY TESTING.
9. THE CONTRACTOR WILL BE RESPONSIBLE FOR PROVIDING ALL NECESSARY DE-WATERING AND TRENCH SUPPORT TO EXECUTE THE WORKS IN A SATISFACTORY MANNER, AND SHALL BE DEEMED TO HAVE ALLOWED FOR THE SAME WITHIN HIS RATES.
10. ALL TACTILE PAVING TILE ARRANGEMENTS SHALL BE LAID WITH THE MODULES IN LINE WITH THE CROSSING AND MUST BE AGREED WITH THE HIGHWAY AUTHORITY PRIOR TO LAYING.
11. ALL BURIED CONCRETE PRODUCTS AND MORTAR SHALL BE MADE USING SULPHATE RESISTING CEMENT.
12. FOR CONSTRUCTION DETAILS REFER TO DRAWING NO. 20488-02_080_03

H	SPINE ROAD UPDATED TO SUIT COMMENTS.	VP	KA	13.08.15
G	SURFACES PLAN UPDATED TO SUIT	VP	KA	13.08.15
F	LAYBY LEADING TO VILLAGE CENTRE AMENDED	ARD	KA	03.06.15
E	SPINE ROAD LAYOUT AMENDED	KA	CP	13.08.15
D	PARCEL B LAYOUT UPDATED	KA	CP	31.02.15
C	PARCEL B AND SPINE ROAD LAYOUT UPDATED.	KA	CP	31.02.15
B	SURFACE FINISHES AMENDED TO SUIT	TPW	KA	27.01.15
A	SURFACE FINISHES AMENDED	CG	KA	14.01.15
	ROAD LAYOUT UPDATED INLINE WITH NEW REVISED LAYOUT	KA	KM	10.10.14
	ROAD LAYOUT AND DRAINAGE UPDATED INLINE WITH NEW REVISED LAYOUT.	DRN	CHK:	DATE:

**LONGFORD PARK
BODCOTE
BANBURY**

**DRAWING TITLE:
PHASE 2 - SPINE ROAD & PARCEL B
ADOPTABLE SURFACING AND KERBING
SHEET 1 OF 2**

**CLIENT:
BARRATT HOMES, BOVIS HOMES
TAYLOR WIMPEY**

**DRAWING NUMBER:
20488_02_060_011**

REVISION:	SHEET SIZE:	SCALE:
H	A1	1:500

DRAWN BY:	CHECKED BY:	DATE:
KA	KM	29.08.14

**STATUS:
FOR INFORMATION / APPROVAL**



ORDNANCE SURVEY © CROWN COPYRIGHT 2014. ALL RIGHTS RESERVED.
LICENCE NUMBER 10002432.

KEY -- KERBING

- TACTILE PAVING WITH THE MODULES LAID IN LINE WITH THE CROSSING (SEE DRG NO.S 20488_02_080_03)
- TYPE EF FOOTWAY/VERGE EDGING (SEE DRG NO. 20488_02_080_03)
- TYPE BN BULLNOSE DROPPED KERB (SEE DRG NO. 20488_02_080_03)
- 125X150MM CHANNEL BLOCK (SEE DRG NO. 20488_02_080_03)
- 915MM WIDE TRANSITION KERB (WHERE POSSIBLE) (SEE DRG NO. 20488_02_080_03)
- VEHICLE DROPPED CROSSING (25mm UPSTAND) (SEE DRG NO. 20488_02_080_03)
- TYPE HB1 HALF BATTERED KERB (SEE DRG NO. 20488_02_080_03)
- PEDESTRIAN DROPPED CROSSING (0mm UPSTAND) (SEE DRG NO. 20488_02_166)

KEY -- SURFACING

- ADOPTABLE SPINE ROAD / PRIMARY STREET CONSTRUCTION. (SEE DRG NO.S 20488_02_080_03).
- ADOPTABLE SECONDARY STREET / SIDE STREET CARRIAGEWAY CONSTRUCTION. (SEE DRG NO.S 20488_02_080_03).
- ADOPTABLE LANE / MINOR STREET CARRIAGEWAY / FOOTWAY CONSTRUCTION (IMPERMEABLE BLOCK PAVING). (SEE DRG NO.S 20488_02_080_03).
- ADOPTABLE IMPERMEABLE FLEXIBLE FOOTWAY OR VEHICLE CROSSING (SEE DRG NO.S 20488_02_080_03).
- ADOPTABLE VERGE CONSTRUCTION
- RUMBLE STRIP. (SEE DRG NO. 20488_02_080_03)

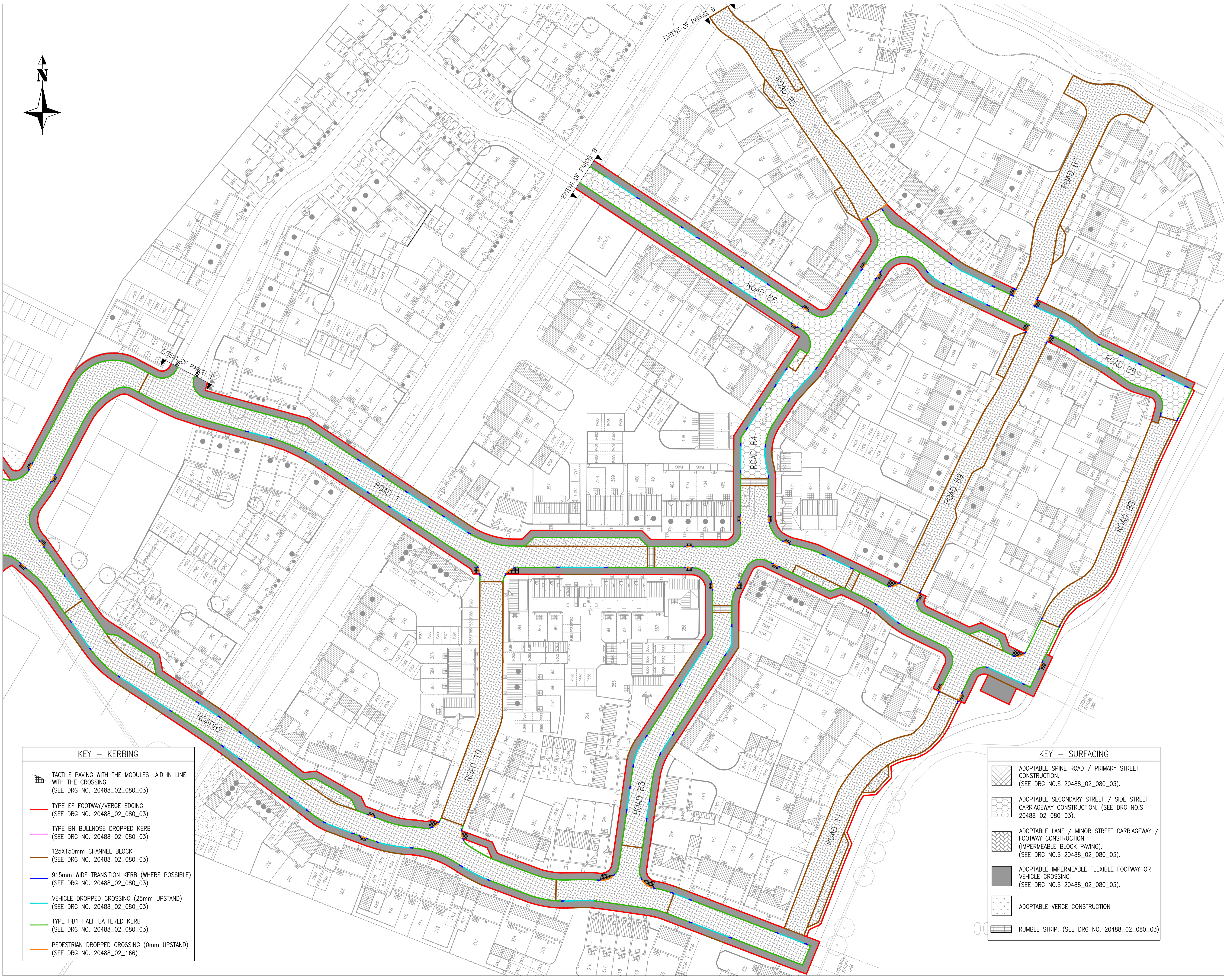

File Location: T:\M-EC\Job Book\20488\Drawings\m-ec\parcel B & spine of 02 series\infrastructure\020\series\02060_011.dwg