

Client
Value Retail

C:\Revitlocal\2016\09068 Bicester Village, Phase 4 (central M adj)_1092.rvt

Index	Revision	Date	Int	Chk'd
-	Issued for Planning	27/04/2016	RT	SA

Indicative location of existing substation

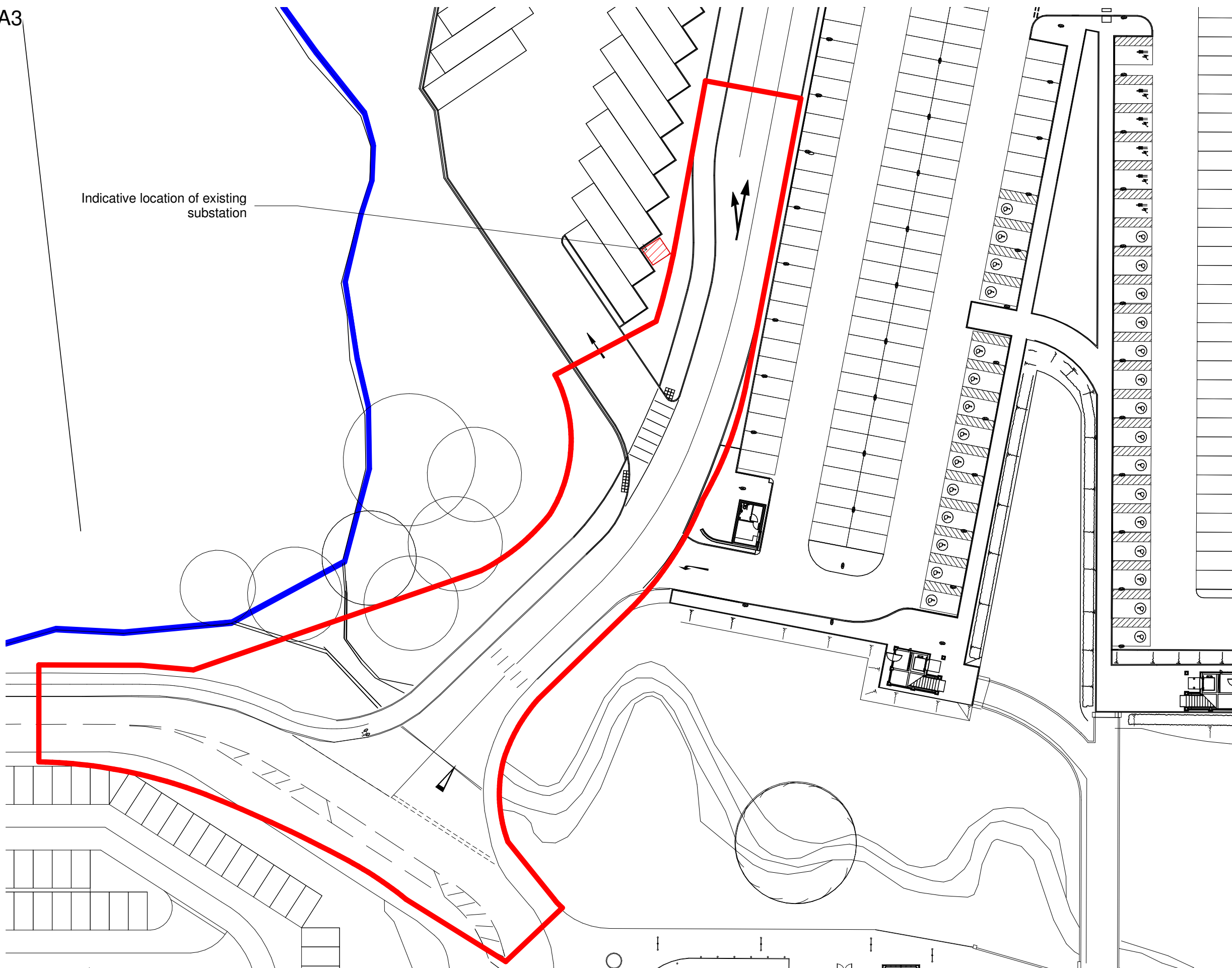

1 | P-302 - Existing Plan
1 : 500

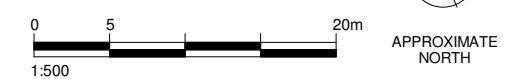

Job N	Drg N	Rev	Scale	Status
09/068	/ P-302	-	1 : 500	PLANNING
Date	Director	Author	Check	
27/04/16	SA	RT	SA	

Job
Bicester Village Retail Outlet Centre - Phase 4

Drawing
Existing Plan

© LYONS+SLEEMAN+HOARE Ltd

NOTE: All figures are approximate and have been measured and expressed in a manner as defined by the current edition of the RICS/ISVA Code of Measuring Practice. Figures relate to the current stage of the project and any development decisions to be made on the basis of this information should include due allowance for the increases and decreases inherent in the design and building processes.

This drawing may be scaled or cross referenced to the scale bar for Planning Application purposes only. Do not scale for any other purpose, use figured dimensions only. Subject to site survey and all necessary consents. All dimensions to be checked by user and any discrepancies, errors or omissions to be reported to the Architect before work commences. This drawing is to be read in conjunction with all other relevant materials.