

movement joint
3.8N/mm² blockwork
7.3N/mm² blockwork
10.0N/mm² blockwork
75mm C.A. metal stud partition (50mm studs) with 25mm glass mineral wool between studs
75mm/100mm C.A. timber stud partition (50mm/75mm studs)
125mm stud cladding wall (75mm studs)
SDW

b balanced flue boiler, wall mounted
f refrigerator position
oven position
hob position
washing machine position
dishwasher position
30min fire resistant door
ceiling mounted smoke detector
ceiling mounted heat detector
boiler/heating programmer fitted under boiler unless otherwise shown. bottom of unit 250mm above ceiling
wall mounted room thermostat. bottom of unit 1500mm above FFL
non-dedicated pendant light fitting with energy efficient bulb
non-dedicated bathroom light fitting with energy efficient bulb
LED downlighter

light to underside of wall unit
porch light wiring only, fall centre 1850mm above FFL
light switch
two way light switch
top of plate 1200mm above FFL
shaver point
3A fused double-pole isolating switch (for cylinder)
3A fused double-pole isolator (for boiler)
fused switch
unfused, unswitched spur
oven spur
30A cooker panel
grid switch
13A switched single socket
13A switched double socket (TV, BT, SAT)
media connector point
tv aerial point
incoming telephone connection
consumer unit, 1350-1450 to centre of switches above FFL
hot, cold water drive off points
gas point
semi-enclosed gas meter
wall mounted gas meter box
wall mounted electrical meter box
100mm soil vent pipe, insulated
see in roofspace where civil engineer requires slab to be externally vented. termination is to be at file vent or near abutment
standing waste
radiator
background ventilator with equivalent area of 1700mm²
background ventilator with equivalent area of 4400mm²
background ventilator with equivalent area of 5000mm²

MECHANICAL VENT CODES
mv A recessed ceiling-mounted mechanical vents
mv B refer to standard detail for definition of manufacturer's product codes
mv D
mv D1
scf terminal
terminal
terminal

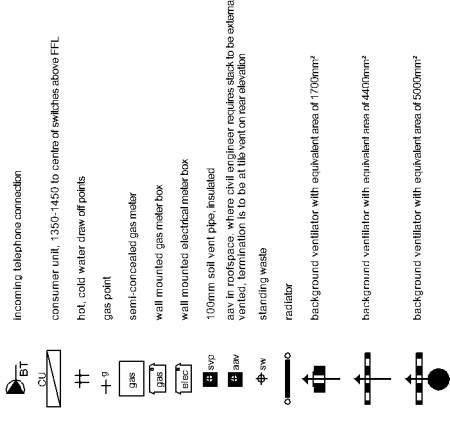

MECHANICAL VENT CODES
mv A recessed ceiling-mounted mechanical vents
mv B refer to standard detail for definition of manufacturer's product codes
mv D
mv D1
scf terminal
terminal
terminal



SITE/DRAWING REF: Upper Heyford Phase B6
DRAWING TITLE: P409VT Setting Out Ground Floor
REV: B

B6 PLOTS:
AS - 291
HANDED - None

B 06.12.16 AH - Landmark planning version for plot 291 renamed as P409VT1 and extracted from previous working drawing for type P409VT. Changes include change of window W1 size including bay omission from kitchen. Hall width amended with return internal wall and front door moved over. Heating layout altered to suit new arrangement. Feature GRP entrance canopy. Rear wall alignment with adjacent plot 290 now flush.
A 24.11.16 AH - Drawing taken from Portfolio Rev A.
Re-fitted for Upper Heyford B6, internal door setting out added.

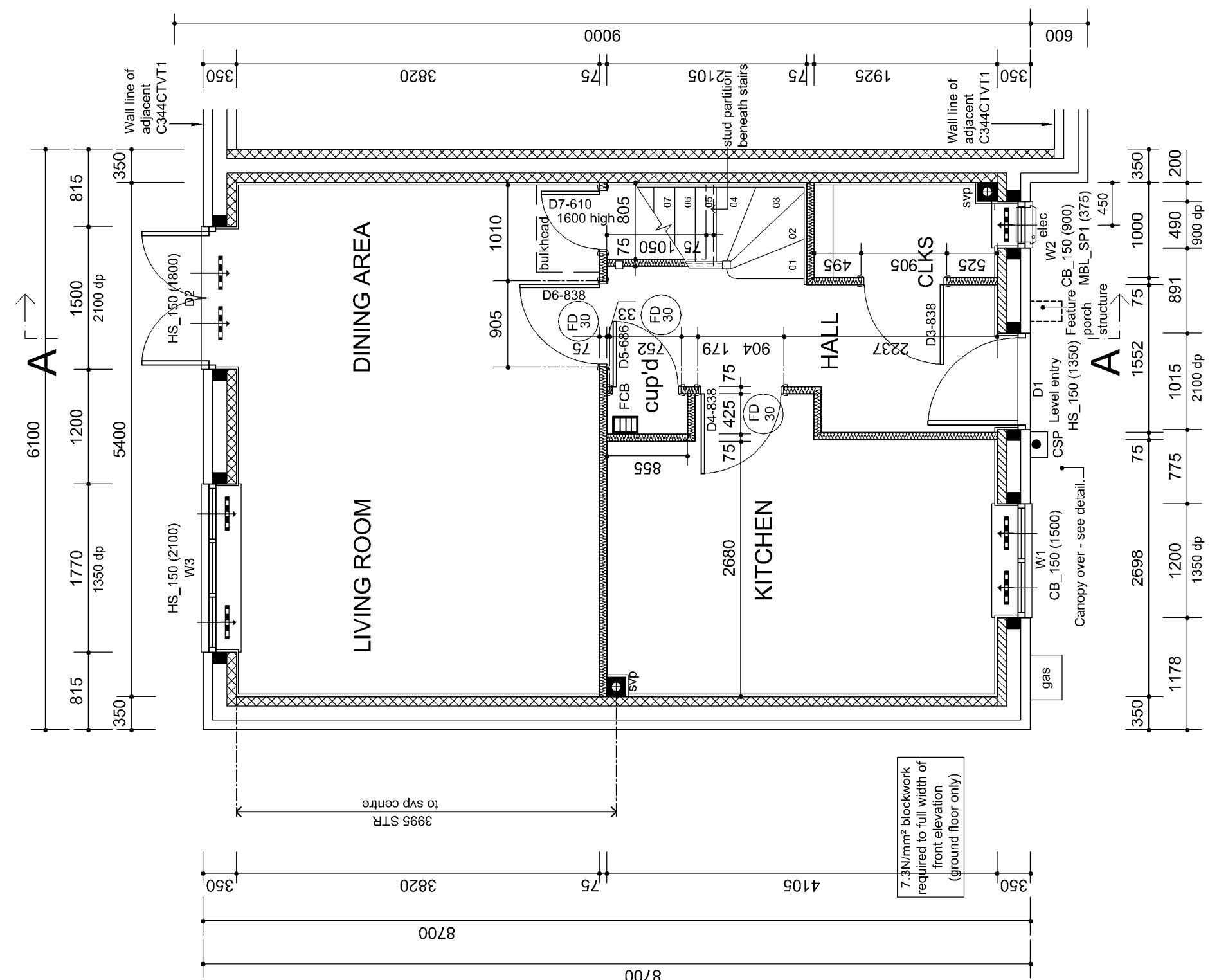

GROUND FLOOR

Do not scale from this drawing. Use written dimensions only. Any discrepancy or suggested modification is to be reported to Bovis Homes Ltd. This drawing is the copyright of Bovis Homes Ltd.