

Number	Species	Specification	Height	Girth	Pot Size
13 No.	Betula pendula	Multi-Stemmed C	4.0-5.0m	18-20cm	75-80L
13 No.	Betula utilis jacquemontii	Advanced Nursery Stock	BR 4.0-4.5m	16-18cm	
8 No.	Carpinus betulus 'Frans Fontaine'	Advanced Nursery Stock	BR 4.0-4.5m	15-18cm	
4 No.	Koeleria paniculata	Extra Heavy Standard BR	4.0-4.5m	16-18cm	
8 No.	Prunus 'Prinosol'	Extra Heavy Standard BR	4.0-4.5m	14-16cm	
12 No.	Tilia cordata 'Green Spire'	Extra Heavy Standard BR	4.0-4.5m	14-16cm	
2 No.	Tilia cordata 'Green Spire'	Advanced Nursery Stock BR	4.0-4.5m	16-18cm	
6 No.	Tilia mongolica	Extra Heavy Standard BR	4.0-4.5m	14-16cm	

Number	Species	Specification	Height	Density
611 No.	Carpinus betulus BR	Double staggered row	60-80cm	5/m
Total: 611 No.				

NOTES:  
 Based upon the Ordnance Survey map with permission of The Controller of Her Majesty's Stationery Office, © Crown Copyright.  
 Aspect Landscape Planning Ltd, West Court, Hardwick Business Park, Noral Way, Banbury OX16 2AF.  
 Licence 100045345

Copyright reserved  
 0m 5m 10m 20m

Hard Landscape Details



Primary Paving- Metrolinia Textured block set paving- 300x100x80 Charcoal and Silver Grey (or similar)

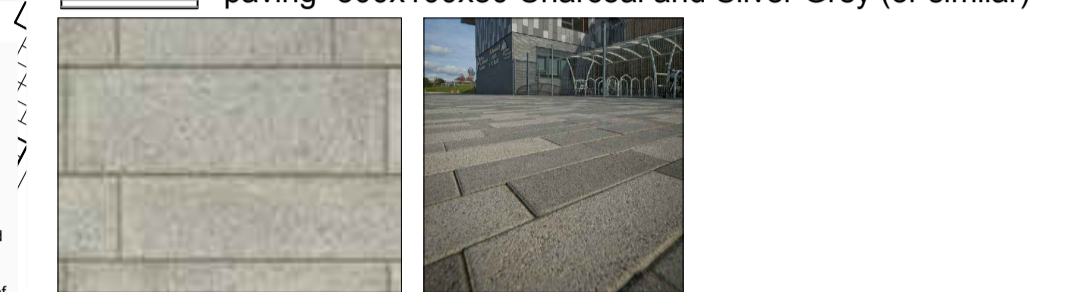

POS/Secondary Paving- Conservation Textured 450x450x50mm-Silver Grey (or similar)



Tertiary Paving- Conservation Textured 450x450x50mm- Charcoal (or similar)



Parking Bays- Keyblok Concrete Block Paving- 200x100x80mm Charcoal- Stretcher course (or similar)



Shared Road/ Car park Surface- Keyblok Concrete Block Paving 200x100x80mm- Natural (or similar)



REV	DATE	NOTE	Drawn	CHK'D
O	20.09.16	Planting amended for Retail Site substation, hard and soft landscape updated to suit new CC layout	SFB	CW
N	20.07.16	Community Centre boundary line amended	BS	
M	21.06.16	Proposals updated to include LPA comments dated 6/6/16. Seating, lighting, plant species updated	BS	
L	16.06.16	Proposals updated to include LPA comments dated 6/6/16. Seating, lighting, plant species updated	BS	
K	23.05.16	Parcel C planting and 1 street tree removed	BS	
J	03.05.16	Updated to include landscape officer comments	BS	
I	07.04.16	Updated to include landscape officer comments	CW	BS
H	11.03.16	Community Hall layout updated, cycle rack location amended	BS	AM
G	16.12.15	Hard and soft landscape amended to suit new layout and to include CDC latest comments	BS	AM
F	05.10.15	Service bay hard and soft proposals amended	BS	AM
E	22.09.15	Amended to new layout and spine road	CW	AM
D	17.07.15	Amended after team comments	CW	AM
C	2.07.15	Amended after team comments	CW	AM
A	9.10.14	Amended after team comments	BS	KC
REV	DATE	NOTE	Drawn	CHK'D



TITLE  
 Longford Park, Village Centre  
 Landscape Hard and Soft Plan 1 of 2

CLIENT  
 Taylor Wimpey, Bovis Homes,  
 Barratt Homes.

SCALE	DATE	DRAWN	CHK'D
1:200 @ A1	OCT 2014	BS	KC

DRAWING NUMBER: 5205/ ASP.VC1.1  
 REVISION: O

Based on Abacus Architects drawing no. Longford 103k Comm Hall + Ecumenical Centre Site Plan

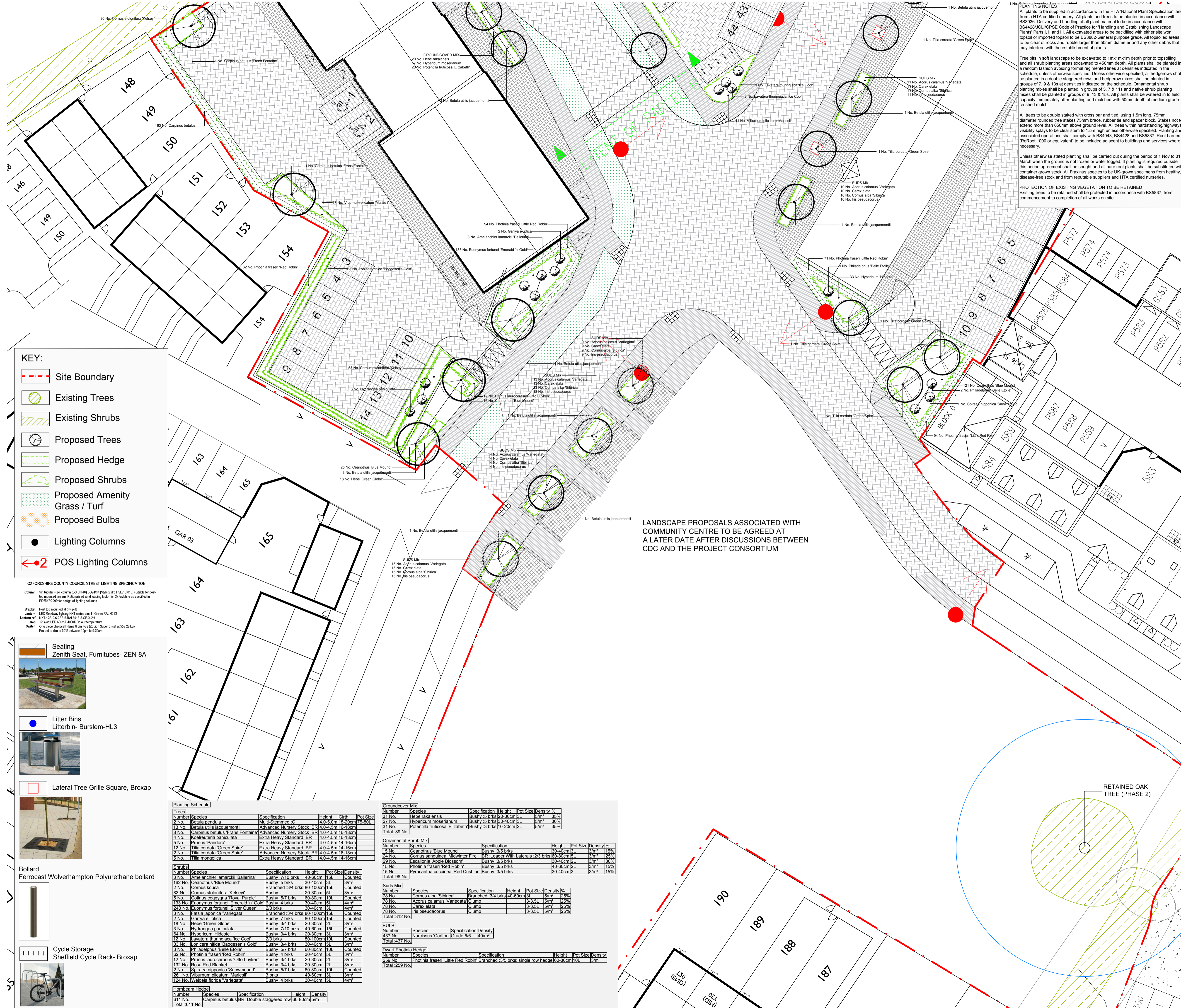

- KEY:**
- Site Boundary
  - Existing Trees
  - Existing Shrubs
  - Proposed Trees
  - Proposed Hedge
  - Proposed Shrubs
  - Proposed Amenity Grass / Turf
  - Proposed Bulbs
  - Lighting Columns
  - POS Lighting Columns

**OXFORDSHIRE COUNTY COUNCIL STREET LIGHTING SPECIFICATION**

**Column:** See tubular steel column (BS EN 40) 80/407 (Style 2 @ HSD/3010) suitable for post top mounted luminaire. Full certified wind loading factor for Oxfordshire as specified in P2060/2006 for design of lighting columns.

**Bracket:** Post top mounted 0.1m light

**Luminaire:** LED Roadway lighting NCT series small - Green FAL 8013

**Lighting ref:** 10 Watt LED 8000k 4000K Colour temperature

**Switch:** One piece photocell remote 5 pin type (Colour Super 6) set at 55/128 Lux. Pre-wired cable to 20% minimum 10pin to 3.0mm

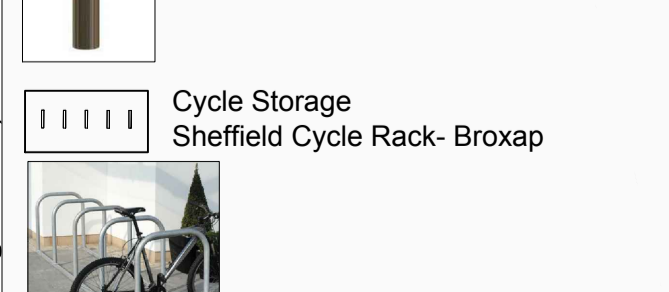
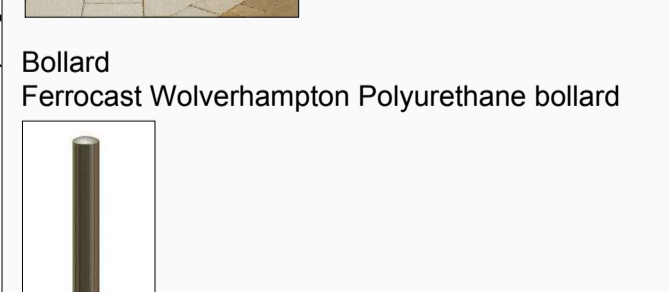
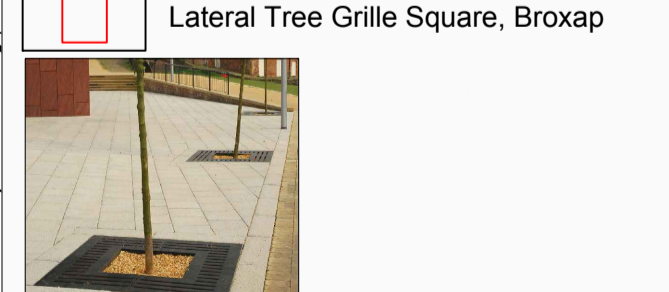
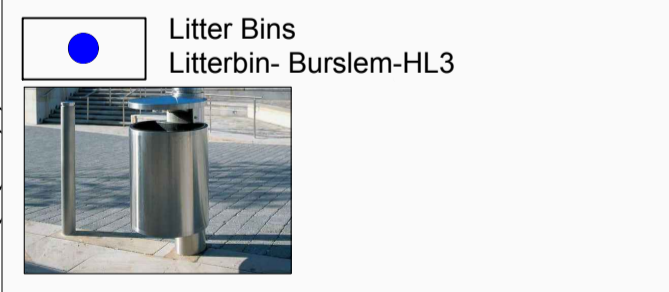

**Planting Schedule**

Number	Species	Specification	Height	Pot Size	Density
2 No.	Hebe rakaiensis	Advanced Nursery Stock BR	4.0-5.0m	18-20cm	15%
13 No.	Betula utilis jacquemonti	Advanced Nursery Stock BR	4.0-4.5m	16-18cm	35%
8 No.	Carpinus betulus Frans Fontaine	Advanced Nursery Stock BR	4.0-4.5m	16-18cm	35%
4 No.	Koeleruteria paniculata	Extra Heavy Standard BR	4.0-4.5m	16-18cm	35%
5 No.	Prunus Pandora	Extra Heavy Standard BR	4.0-4.5m	14-16cm	35%
12 No.	Tilia cordata Green Spire	Extra Heavy Standard BR	4.0-4.5m	14-16cm	35%
2 No.	Tilia cordata Green Spire	Advanced Nursery Stock BR	4.0-4.5m	16-18cm	35%
5 No.	Tilia mongolica	Extra Heavy Standard BR	4.0-4.5m	14-16cm	35%

**Groundcover Mix**

Number	Species	Specification	Height	Pot Size	Density
51 No.	Hebe rakaiensis	Bushy	5 brks	20-30cm	3L
27 No.	Hypericum moserianum	Bushy	5 brks	30-40cm	3L
31 No.	Potentilla fruticosa Elizabeth	Bushy	3 brks	10-20cm	2L

**Ornamental Shrub Mix**

Number	Species	Specification	Height	Pot Size	Density
16 No.	Ceanothus Blue Mound	Bushy	3/5 brks	30-40cm	3L
24 No.	Cornus sanguinea Midwinter Fire	BR Leader With laterals	2/3 brks	60-80cm	3L
28 No.	Escallonia Apple Blossom	Bushy	3/5 brks	30-40cm	3L
16 No.	Photinia fraseri Little Red Robin	Bushy	3/5 brks	40-60cm	2L
15 No.	Pyracantha coccinea Red Cushion	Bushy	3/5 brks	30-40cm	3L

**Studs Mix**

Number	Species	Specification	Height	Pot Size	Density
78 No.	Cornus alba Sibirica	Branched	3/4 brks	40-60cm	3L
78 No.	Acorus calamus Variegata	Clump	3-3.5L	5m <sup>2</sup>	25%
78 No.	Carex elata	Clump	3-3.5L	5m <sup>2</sup>	25%
78 No.	Iris pseudacorus	Clump	3-3.5L	5m <sup>2</sup>	25%

**BLUB**

Number	Species	Specification	Density
437 No.	Narcissus Carlton	Grade 5/6	40m <sup>2</sup>

**Dwarf Photinia Hedge**

Number	Species	Specification	Height	Pot Size	Density
259 No.	Photinia fraseri Little Red Robin	Branched	3/5 brks: single row hedge	60-80cm	10L

**Hornbeam Hedge**

Number	Species	Specification	Height	Density
611 No.	Carpinus betulus BR	Double staggered row	60-80cm	5m

**NOTES:**  
Based upon the Ordnance Survey map with permission of The Controller of Her Majesty's Stationery Office, © Crown Copyright.  
Aspect Landscape Planning Ltd, West Court, Hardwick Business Park, Noral Way, Banbury OX16 2AF.  
Licence 100045465

Copyright reserved

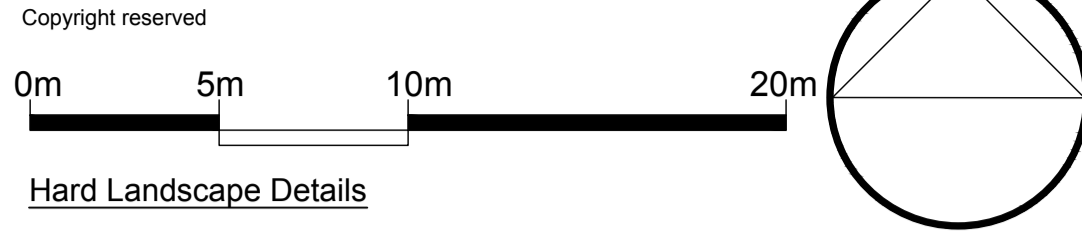

- Hard Landscape Details**
- POS/Paving bands- Saxon Textured Concrete Paving 450x300x50mm- Charcoal (or similar)
  - Primary Paving- Metrolinia Textured block sett paving- 300x100x80 Charcoal and Silver Grey (or similar)
  - POS/Secondary Paving- Conservation Textured 450x450x50mm-Silver Grey (or similar)
  - Tertiary Paving- Conservation Textured 450x450x50mm- Charcoal (or similar)
  - Parking Bays- Keyblok Concrete Block Paving- 200x100x80mm Charcoal- Stretcher course (or similar)
  - Shared Road/ Car park Surface- Keyblok Concrete Block Paving 200x100x80mm- Natural (or similar)

**REVISIONS**

REV	DATE	NOTE	Drawn	CHK'd
O	20.09.16	Planting amended for Retail Site substation, hard and soft landscape updated to suit new CC layout	SFB	CW
N	20.07.16	Community Centre boundary line amended	BS	BS
M	21.06.16	Proposals updated to include LPA comments dated 6/6/16. Seating, lighting, plant species updated, Parcel C planting and 1 street tree removed	BS	BS
L	16.06.16	Proposals updated to include LPA comments dated 6/6/16. Seating, lighting, plant species updated, Updated to include landscape officer comments	BS	BS
K	23.05.16	Parcel C planting and 1 street tree removed	BS	BS
J	03.05.16	Updated to include landscape officer comments	CW	BS
I	07.04.16	Updated to include landscape officer comments	CW	BS
H	11.03.16	Community Hall layout updated, cycle rack location amended	BS	AM
G	16.12.15	Hard and soft landscape amended to suit new layout and to include CDC latest comments	BS	AM
F	05.10.15	Service bay hard and soft proposals amended	BS	AM
E	22.08.15	Amended to new layout and spine road	CW	AM
D	17.07.15	Amended after team comments	CW	AM
C	2.07.15	Amended after team comments	CW	AM
A	9.10.14	Amended after team comments	BS	KC

**aspect landscape planning**

**TITLE**  
Longford Park, Village Centre Landscape Hard and Soft Plan 2 of 2

**CLIENT**  
Taylor Wimpey, Bovis Homes, Barratt Homes.

**SCALE**  
1:200 @ A1

**DATE**  
OCT 2014

**DRAWN**  
BS

**CHK'D**  
KC

**DRAWING NUMBER**  
5205/ ASP.VC1.2

**REVISION**  
O

Based on Abacus Architects drawing no. Longford 103k Comm Hall + Ecumenical Centre Site Plan

**Tree Pit Adjacent Road Carriage**

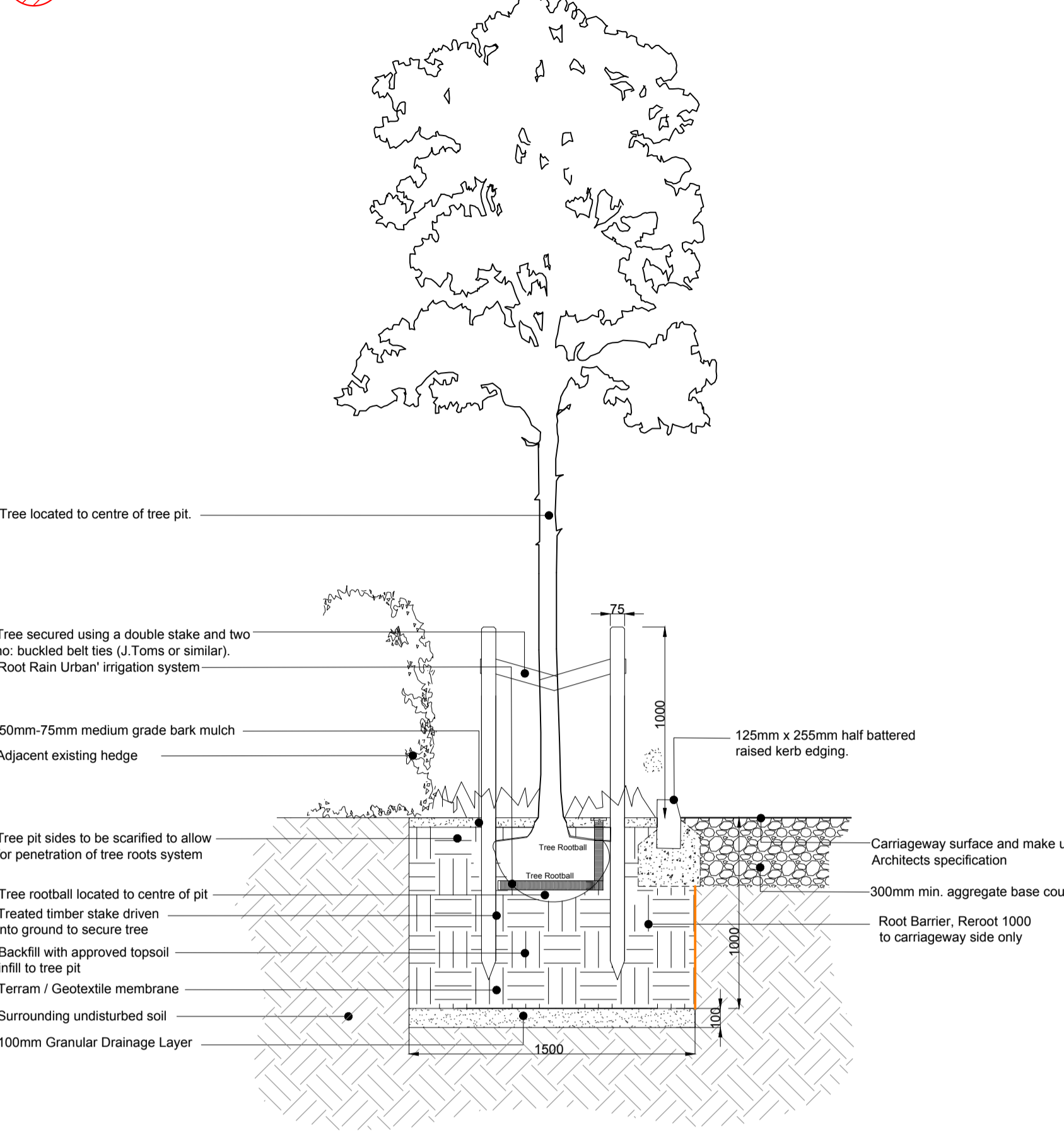

**Tree Pit Detail 1**  
Elevation View  
Scale 1:25 @ A1

**Tree Pit Adjacent Footway**

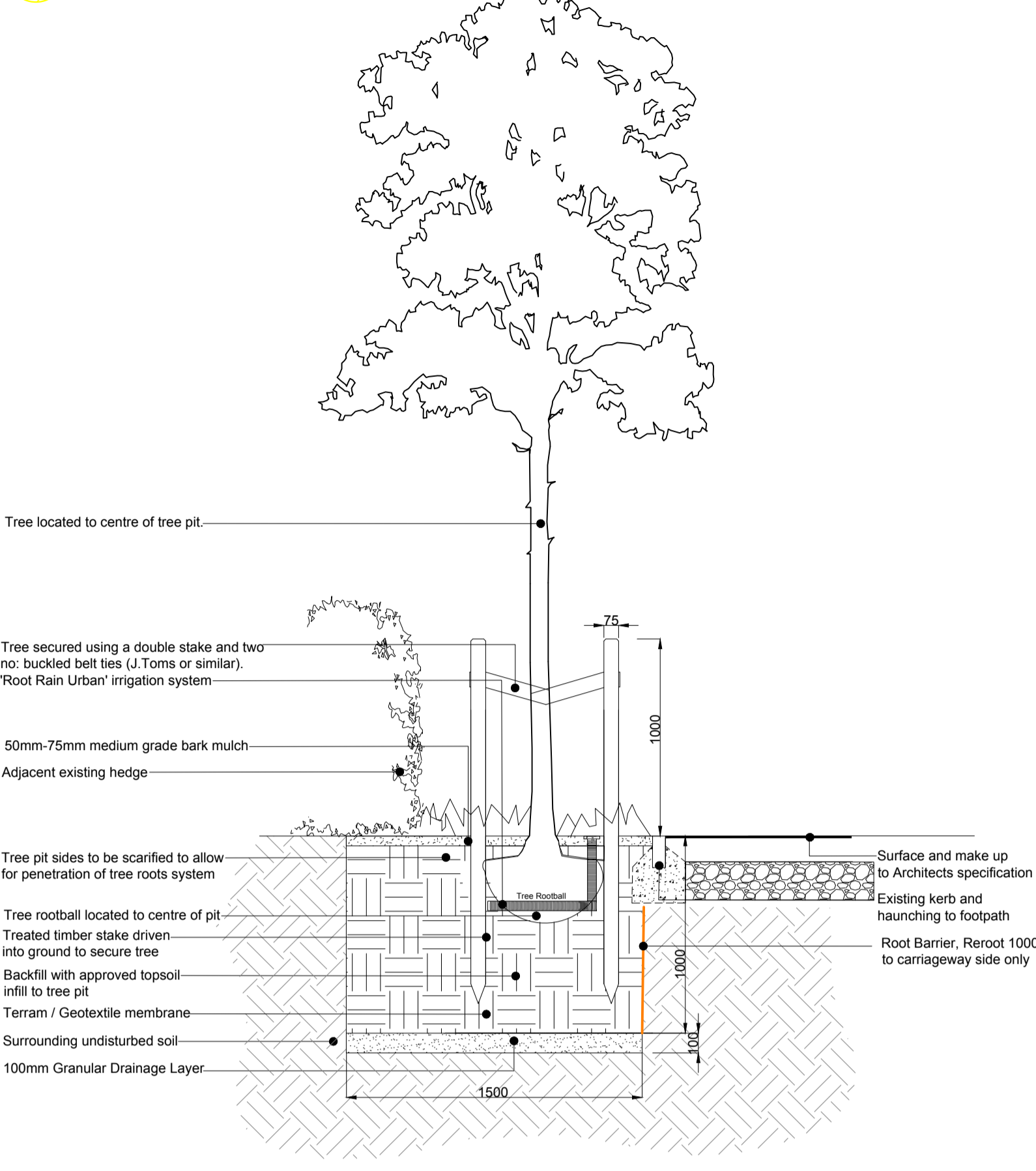

**Tree Pit Detail 2**  
Elevation View  
Scale 1:25 @ A1

**Hard Landscape Tree Pit**

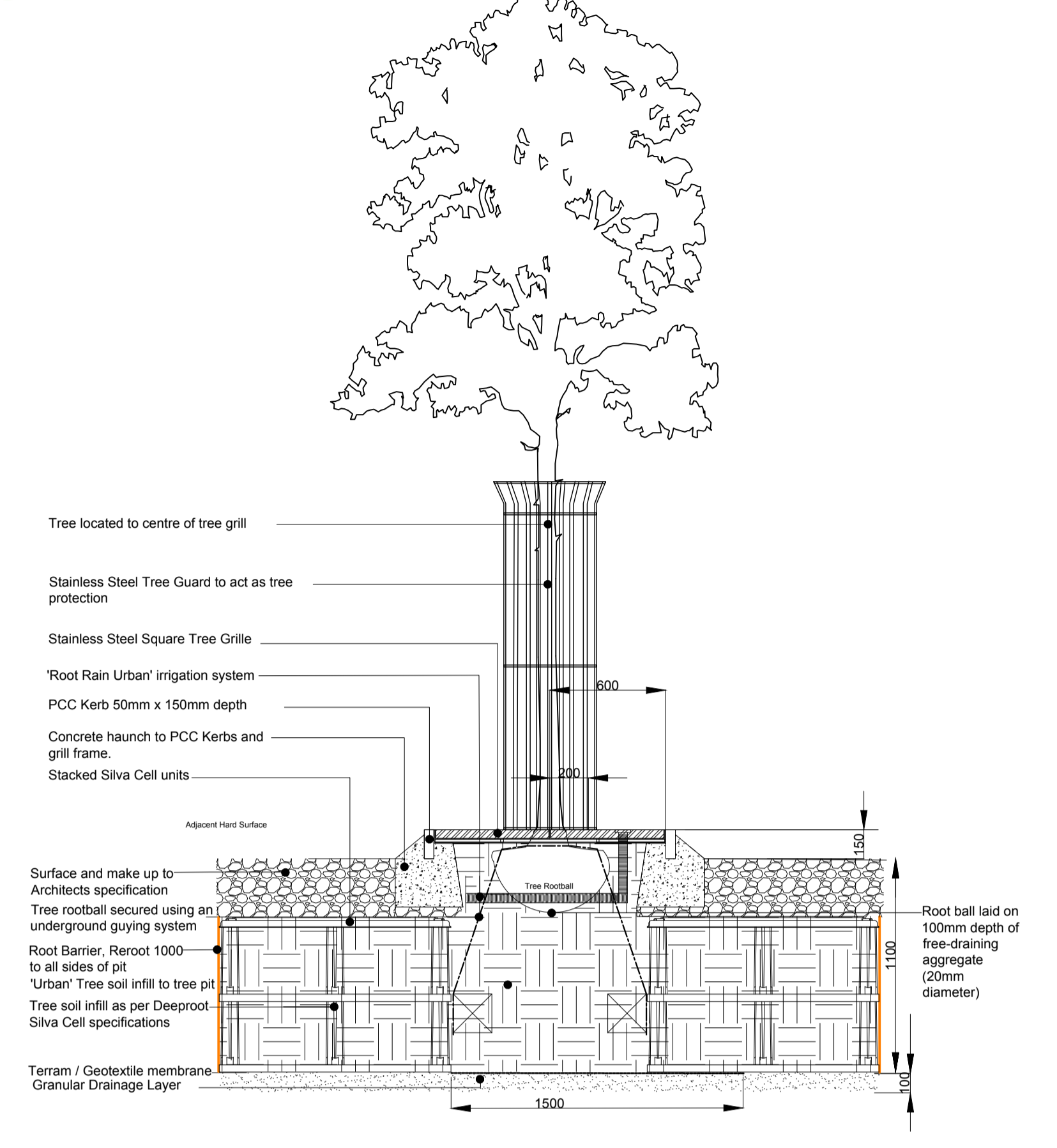

**Tree Pit Detail 3**  
Elevation View  
Scale 1:25 @ A1

NOTES:  
Based upon the Ordnance Survey map with permission of The Controller of Her Majesty's Stationery Office. © Crown Copyright.  
Aspect Landscape Planning Ltd, West Court, Harbeck Business Park, Noral Way, Banbury OX18 2AF.  
Licence 100045345  
Copyright reserved  
No Dimensions to be scaled from this drawing.

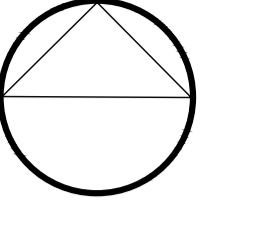

**Root Barrier:**  
Trees within or adjacent to hard surfaces, built form and where underground services are located will require root barriers to be installed.  
Reroot 1000 or similar should be used where necessary within 3m of proposed tree stem.

**Tree Pit Adjacent to Road Carriage and footway**

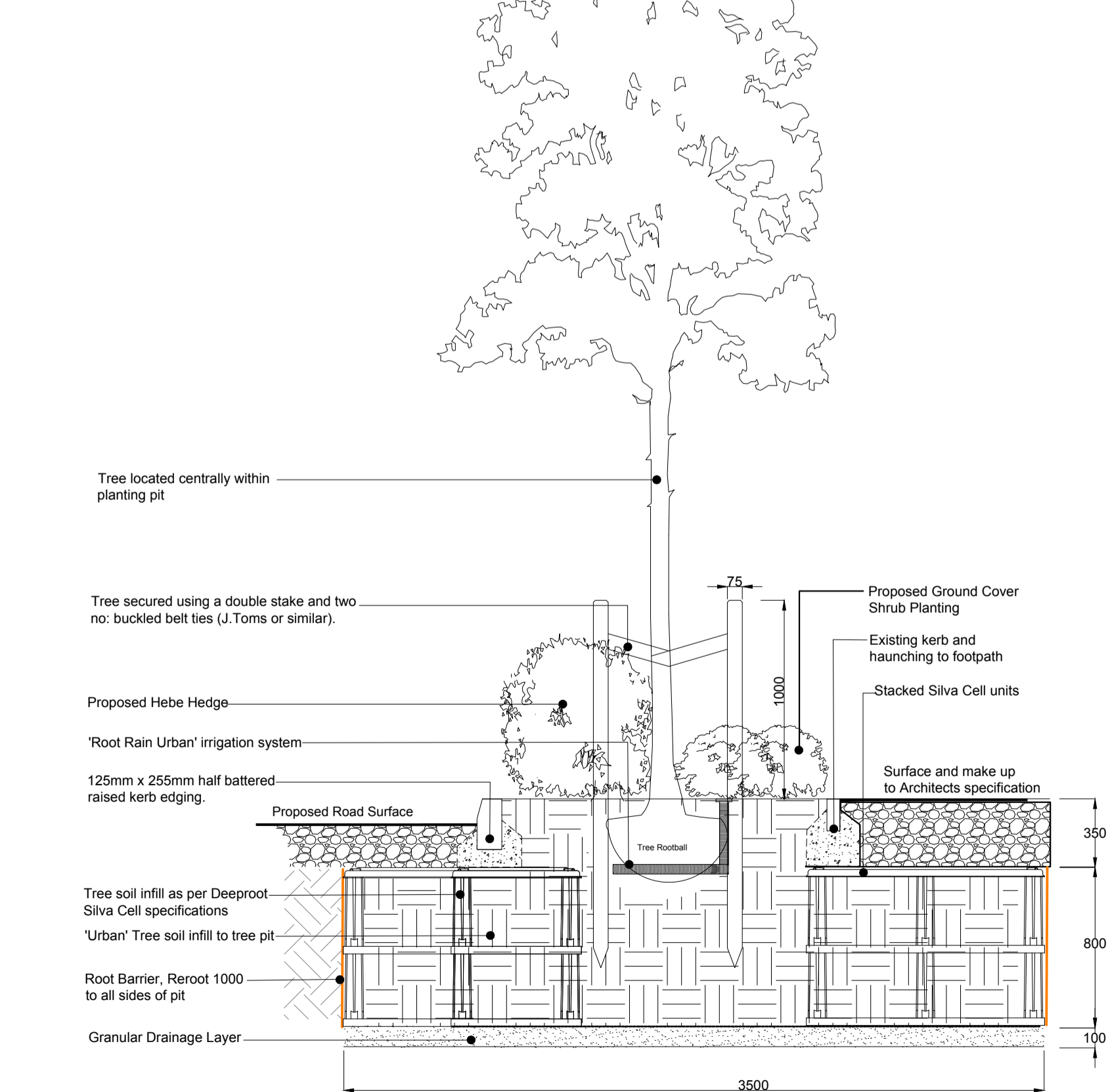

**Tree Pit Detail 4**  
Elevation View  
Scale 1:25 @ A1

**Tree Pit Within Soft Landscape Area**

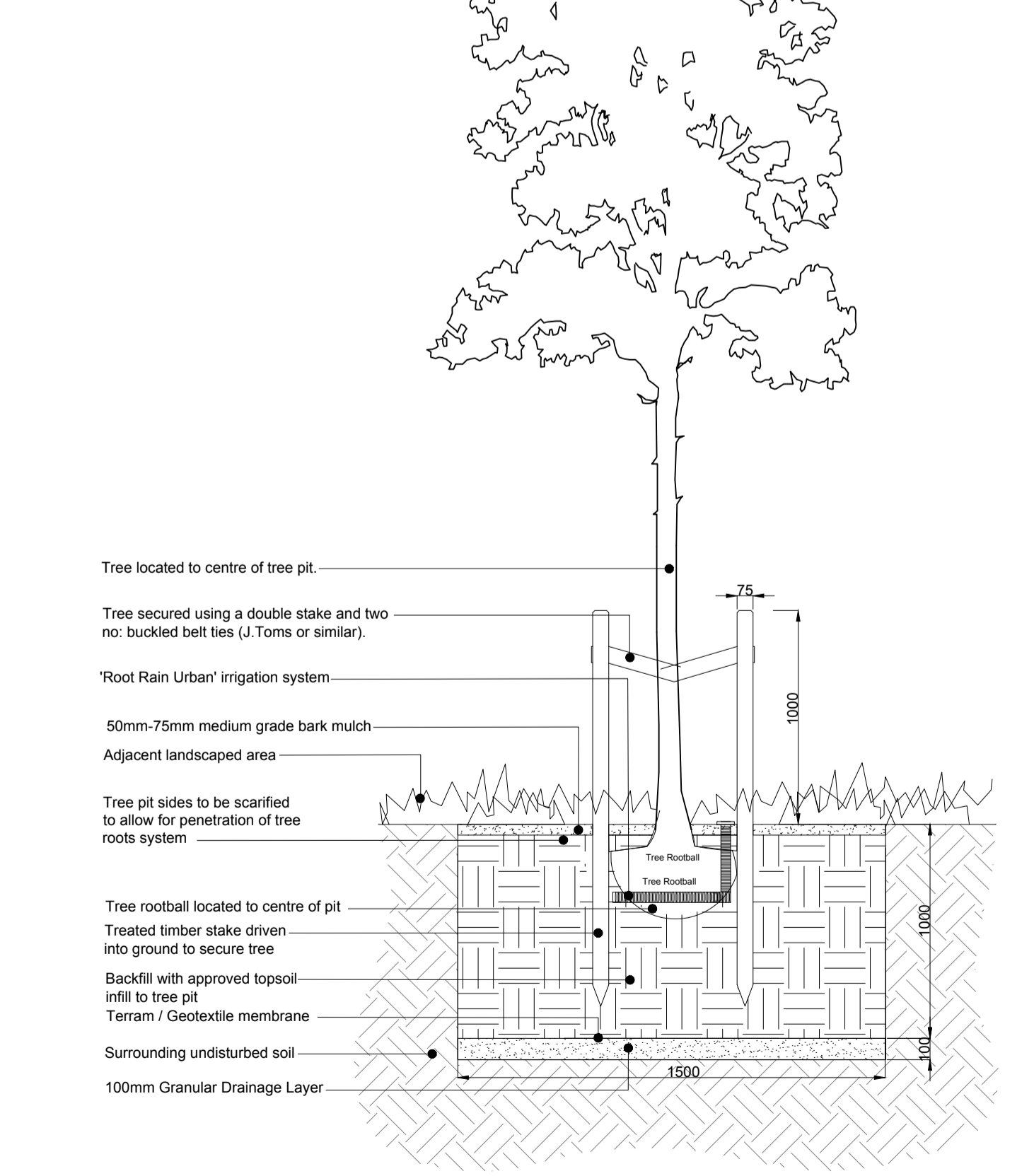

**Tree Pit Detail 5**  
Elevation View  
Scale 1:25 @ A1

REV	DATE	NOTE	BS	CHKD
H	20.09.16	Tree locations updated to integrate Retail Site	SFB	BS
G	16.06.16	substation and to suit new CC layout	BS	
		Tree locations updated to include landscape officer comments	BS	
F	23.05.16	Parcel C planting and 1 street tree removed	BS	
E	03.05.16	Tree locations updated to include landscape officer comments	BS	
D	07.04.16	Updated to include landscape officer comments	CW	BS
C	11.03.16	Community Hall layout updated, cycle rack location amended	BS	AM
B	16.12.15	Hard and soft landscape amended to suit new layout and to include CDC latest comments	BS	AM
A	05.10.15	Service bay hard and soft proposals amended	BS	AM

REVISIONS

**aspect landscape planning**

TITLE  
**Longford Park, Banbury Village Centre- Tree Pit Details**

CLIENT  
**Barratt Homes, Bovis & Taylor Wimpey Homes**

SCALE: DATE: DRAWN:  
Refer to drawing SEPT 2015 BS

DRAWING NUMBER: REVISION:  
5205/ ASP.VC.TPD.1.3 H



NOTES:  
 Based upon the Ordnance Survey map with permission of The Controller of Her Majesty's Stationery Office © Crown Copyright.  
 Aspect Landscape Planning Ltd, West Court, Harwood Business Park, Noral Way, Banbury OX16 2AF.  
 License 100045345  
 Copyright reserved  
 No Dimensions to be scaled from this drawing.

- Tree Pit Adjacent Road Carriage
- Tree Pit Adjacent Footway
- Hard Landscape Tree Pit
- Tree Pit Adjacent to Road Carriage and footway
- Tree Pit Within Soft Landscape Area
- Proposed Root Barrier (Reroot 1000 or similar)  
 Indicative locations shown, subject to detailed services drawings being finalised.

**Root Barrier:**  
 Trees within or adjacent to hard surfaces, built form and where underground services are located will require root barriers to be installed. Reroot 1000 or similar should be used where necessary within 3m of proposed tree stem. Refer to plan 5205/ ASP.TPD. 2.1 for tree pit details.

REV	DATE	DESCRIPTION	BY	CHKD
H	20.09.16	Tree locations updated to integrate Retail Site	SFB	BS
G	16.06.16	Substation and to suit new CC layout	BS	BS
F	23.05.16	Tree locations updated to include landscape officer comments	BS	BS
E	03.05.16	Parcel C planting and 1 street tree removed	BS	BS
D	07.04.16	Tree locations updated to include landscape officer comments	CW	BS
C	11.03.16	Updated to include landscape officer comments	BS	AM
B	16.12.15	Community Hall layout updated, cycle rack location amended	BS	AM
A	05.10.15	Hard and soft landscape amended to suit new layout and to include CDC latest comments	BS	AM
REV	DATE	Service bay hard and soft proposals amended	BS	AM
NOTE			Drawn	Chkd

**aspect landscape planning**

TITLE  
**Longford Park, Banbury Village Centre- Tree Pit Detail Overview**

CLIENT  
**Barratt Homes, Bovis & Taylor Wimpey Homes**

SCALE	DATE	DRAWN
Not to scale	SEPT 2015	BS
DRAWING NUMBER	REVISION	
5205/ ASP.VC.TPD.1.4	H	

Based on Abacus Architects drawing no. Longford 103k Comm Hall + Ecumenical Centre Site Plan