

KEY

- Existing: Existing tree and hedge
- Proposed: Proposed tree, Proposed hedge
- Amenity grass - Emorsgate EG22 Lawn Mixture - refer to schedule UA001881-701-1103
- Planting area
- EM6 Meadow mix for chalk and limestone soils (Perimeter planting) refer to schedule UA001881-701-1103.
- EH1 Hedgerow mix (shade tolerant) refer to schedule UA001881-701-1103.
- Proposed tree grille - refer to drg no. UA001881-701-800
- Proposed tree pit. Root barrier = blue line. Refer to drg no. UA001881-701-800/801
- Green Roofs - refer to drg no. UA001881-701-933
- SUDS - refer to drg no. UA001881-701-811
- Exemplar boundary line
- Adoption boundary line
- Perimeter planting extents
- Light column

Planting Plan 5 - Species List

| Plant type | Common name | Reference |
|-------------------------|--------------------|---------------|
| Non-edible shrub | | |
| Carpinus betulus | Hornbeam | CAR BET hedge |
| Herbs | | |
| Lavendula augustifolia | Lavender | LAV AUG |
| Ground Cover | | |
| Berginea cordifolia | Berginea | BER COR |
| Liorope muscari | Big Blue Lily turf | LIO MUS |

| Tree Species* | Common name | Reference |
|----------------|------------------|-----------|
| Betula pendula | Silver Birch | BET PEN |
| Prunus avium | Native Cherry | PRU AVI |
| Sorbus aria | Common Whitebeam | SOR ARI s |

*Where a tree species is specified in both standard and extra heavy standard size, an affix of 'S' denotes standard size

For detailed Plant Schedule, refer to:
 UA001881-701-1102 Infrastructure Planting Schedule
 UA001881-701-1103 Phase 1 Planting Schedule
 For Topsoiling plans, refer to: UA001881-701-114 to 116

Tree locations and planting areas layout by ICS.
 Root barrier & tree pits - locations to be checked on site in line with drawings UA001881-701-800/801

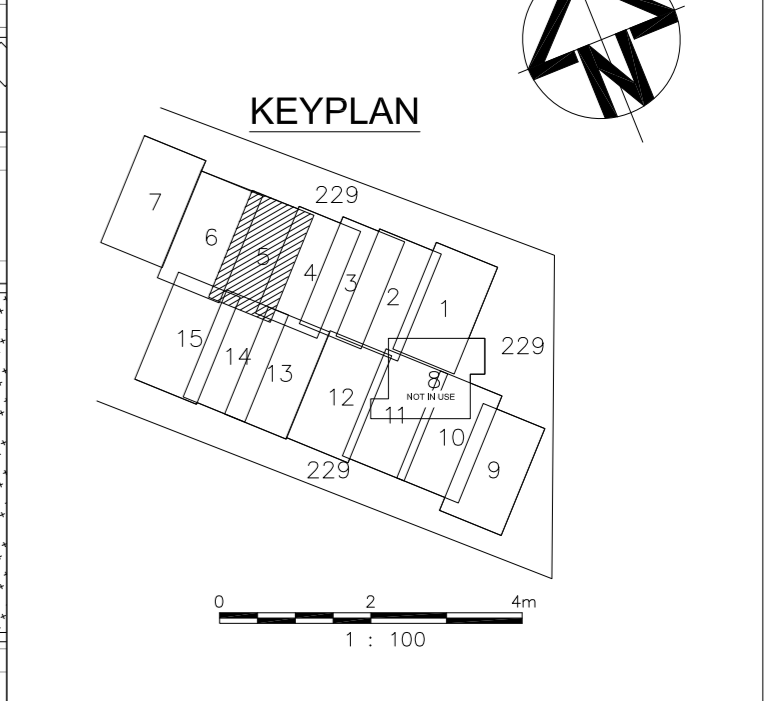

| | | |
|--------------------------|---|--------------------------|
| 05 | Planting revised to align with scheme revisions & revised root barriers | 21-10-15 |
| 04 | 'DRAFT' removed, tree pits and note added, key revised shade tolerant hatch revised | 29-08-14 |
| 03 | Drawing updated to CIS layout and WHI comments | 14-05-14 |
| 02 | General Amendments. Issue for planning condition discharge | 21-12-12 |
| V | Initial Draft | 31-08-12 |
| Issue Description | | Date |
| Status: PLANNING | | |
| Scales: 1:100 @ A1 | | Current Issue Signatures |
| Original Size: A1 | | Author: A.VICTORY |
| Height Datum: O.S. | | Checker: A.VICTORY |
| Grid: O.S. | | Approver: A.ZORLUTUN |
| © Copyright reserved | | |



Hyder HYDER CONSULTING (UK) Limited
 5th Floor, The Pithay
 All Saints Street
 Bristol, England
 BS1 2NL
 Tel: +44 (0)870 000 3003
 Fax: +44 (0)870 000 3903

Project: **Bicester Eco Development**

Title: **Planting Plan 5 - Phase 1**

Drawing No. 701-909 Project No. UA001881-05 Issue

SEE DRAWING: Green Roof Plan UA001881-701-933 for details

SEE DRAWING: Green Roof Plan UA001881-701-933 for details

SEE DRAWING: Green Roof Plan UA001881-701-933 for details

MATCH LINE FOR CONTINUATION SEE DWG01-914

MATCH LINE FOR CONTINUATION SEE DWG01-908

MATCH LINE FOR CONTINUATION SEE DWG01-908

MATCH LINE FOR CONTINUATION SEE DWG01-914