

- Contractors must check all dimensions on site. Only figured dimensions are to be worked from. Discrepancies must be reported to the Architect or Engineer before proceeding. © This drawing is copyright
- Reproduced from OS Sitemap © by permission of Ordnance Survey® on behalf of The Controller of Her Majesty's Stationary Office. © Crown copyright 2008. All rights reserved. Licence number 100007126.
- Subject to detailed design. Adoptable highway materials subject Section 38 / 278 approval by Oxfordshire County Council as required.
- 450x450 paving slabs to all primary access points where drives are gravel.
- Planning drawing to be superseded by external finishes drawings 827 and 828 during detailed design.

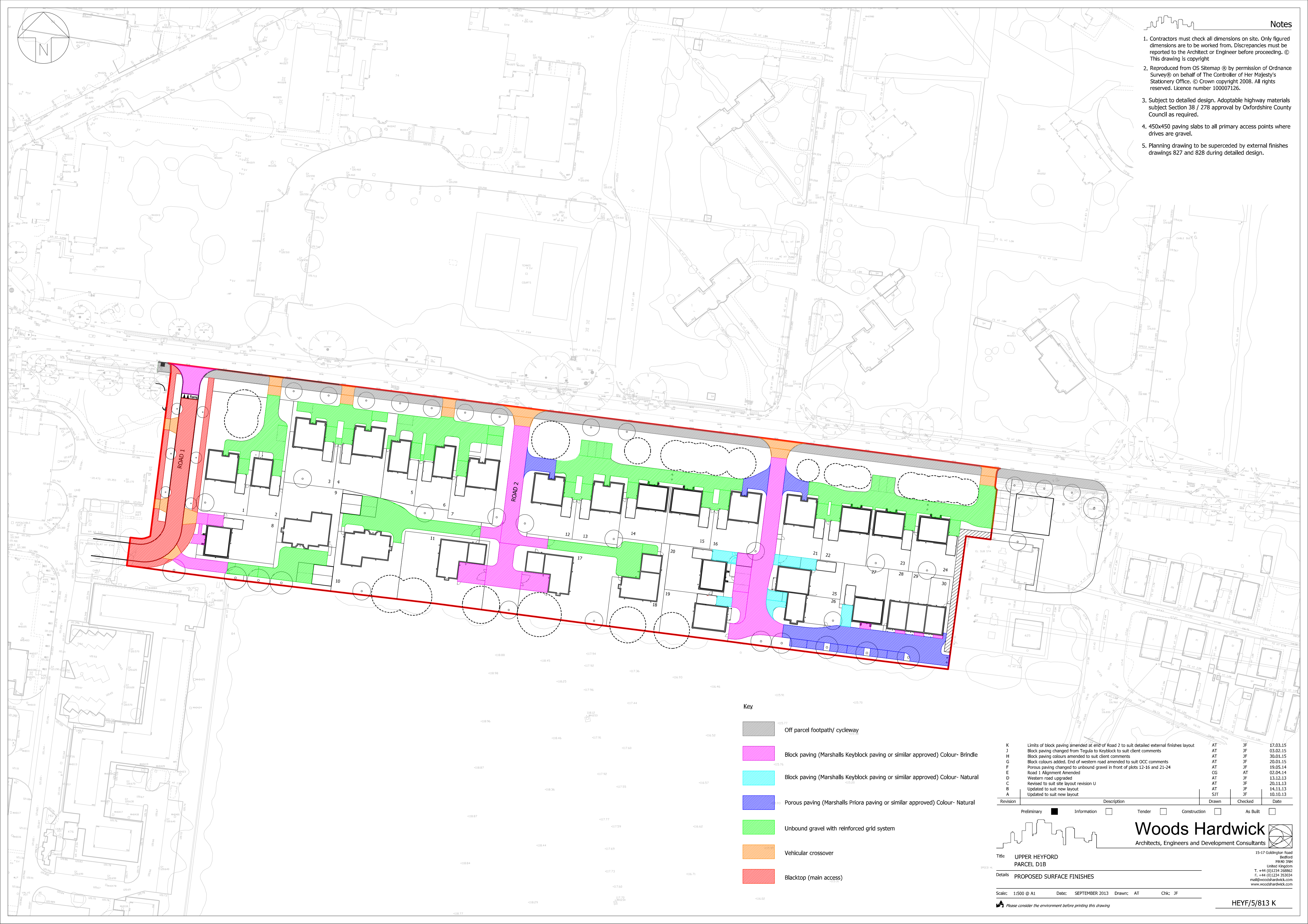

Key

	Off parcel footpath/ cycleway
	Block paving (Marshalls Keyblock paving or similar approved) Colour- Brindle
	Block paving (Marshalls Keyblock paving or similar approved) Colour- Natural
	Porous paving (Marshalls Piora paving or similar approved) Colour- Natural
	Unbound gravel with reinforced grid system
	Vehicular crossover
	Blacktop (main access)

Revision	Description	Drawn	Checked	Date
K	Limits of block paving amended at end of Road 2 to suit detailed external finishes layout	AT	JF	17.03.15
J	Block paving changed from Tegula to KeyBlock to suit client comments	AT	JF	03.02.15
H	Block paving colours amended to suit client comments	AT	JF	30.01.15
G	Block colours added. End of western road amended to suit OCC comments	AT	JF	20.01.15
F	Porous paving changed to unbound gravel in front of plots 12-16 and 21-24	AT	JF	19.05.14
E	Road 1 Alignment Amended	CG	AT	02.04.14
D	Western road upgraded	AT	JF	13.12.13
C	Revised to suit site layout revision U	AT	JF	20.11.13
B	Updated to suit new layout	SJT	JF	14.11.13
A	Updated to suit new layout	SJT	JF	10.10.13

Revision	Description	Drawn	Checked	Date
	Preliminary	<input checked="" type="checkbox"/>		
	Information	<input type="checkbox"/>		
	Tender	<input type="checkbox"/>		
	Construction	<input type="checkbox"/>		
	As Built	<input type="checkbox"/>		

Woods Hardwick
 Architects, Engineers and Development Consultants

15-17 Goldington Road
 Bedford
 MK40 3NH
 United Kingdom
 T. +44 (0)1234 268862
 F. +44 (0)1234 353034
 mail@woodsardwick.com
 www.woodsardwick.com

Title **UPPER HEYFORD
 PARCEL D1B**

Details **PROPOSED SURFACE FINISHES**

Scale: 1:500 @ A1 Date: SEPTEMBER 2013 Drawn: AT Chk: JF

Please consider the environment before printing this drawing