

1. Contractors must check all dimensions on site. Only final dimensions are to be worked from. Discrepancies must be reported to the Architect or Engineer before proceeding. This drawing is copyright © 2013 Woods Hardwick. 2. Reproduced from OS Shemap by permission of Ordnance Survey on behalf of The Controller of Her Majesty's Stationery Office. © Crown copyright 2008. All rights reserved. License number 10000126.

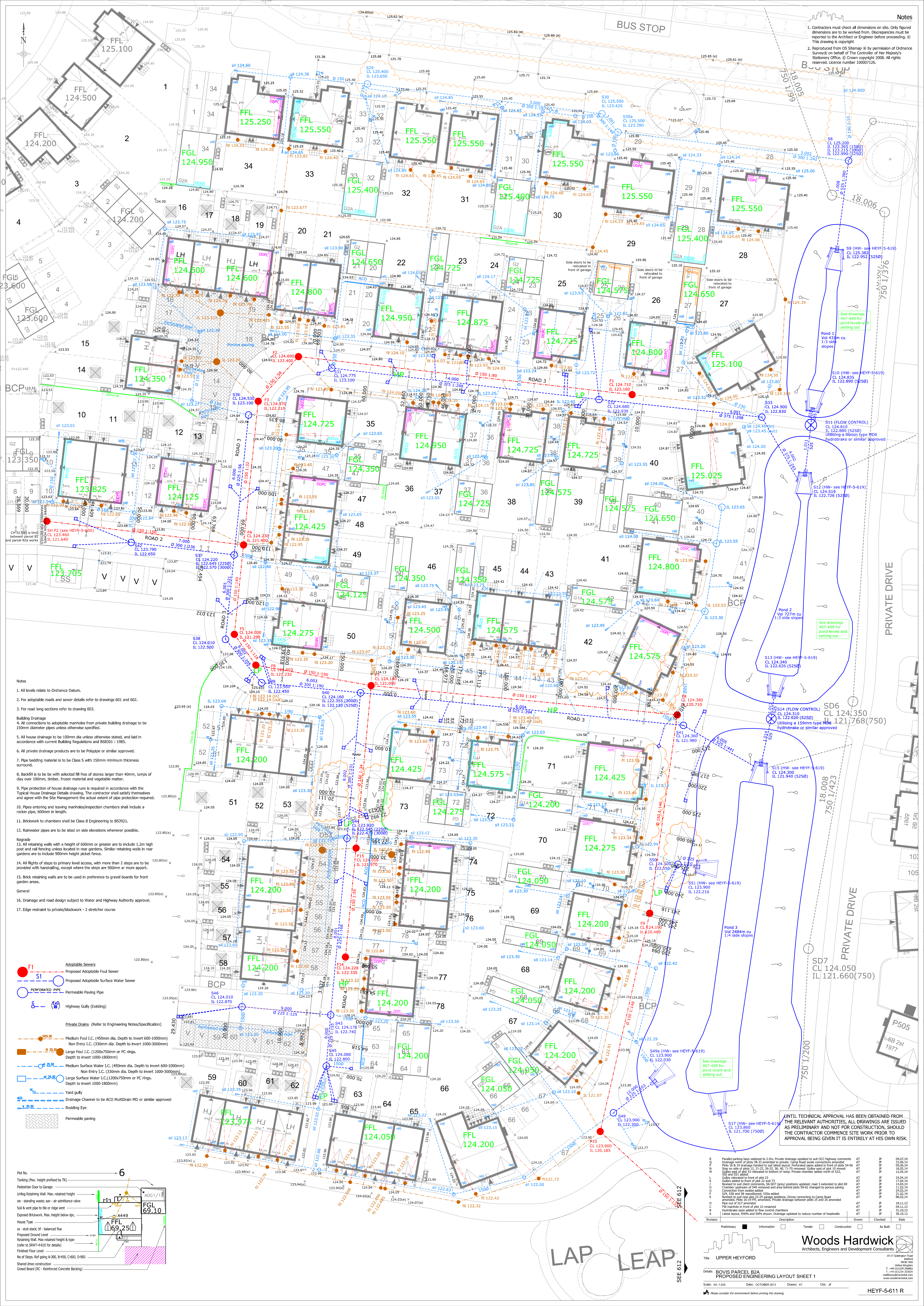

- Notes
- All levels relate to Ordnance Datum.
  - For adoptable roads and sewer details refer to drawings 601 and 602.
  - For road long sections refer to drawing 603.
- Building Drainage
- All connections to adoptable manholes from private building drainage to be 150mm diameter pipes unless otherwise specified.
  - All house drainage to be 100mm dia unless otherwise stated, and laid in accordance with current Building Regulations and BS8301:1985.
  - All private drainage products are to be Polypropylene or similar approved.
  - Pipe bedding material is to be Class S with 150mm minimum thickness surround.
  - Backfill is to be with selected fill free of stones larger than 40mm, lumps of clay over 100mm, timber, frozen material and vegetable matter.
  - Protection of house drainage runs is required in accordance with the Typical House Drainage Details drawing. The contractor shall satisfy themselves and agree with the Site Management the actual extent of pipe protection required.
  - Pipes entering and leaving manholes/inspection chambers shall include a rocker pipe, 600mm in length.
  - Brickwork to chambers shall be Class B Engineering to BS3921.
  - Rainwater pipes are to be sited on side elevations whenever possible.
- Regrade
- All retaining walls with a height of 600mm or greater are to include 1.2m high post and rail fencing unless located in rear gardens. Similar retaining walls in rear gardens are to include 900mm height picket fence.
  - All flights of steps to primary level access, with more than 2 steps are to be provided with handrails, except where the steps are 900mm or more apart.
  - Brick retaining walls are to be used in preference to gravel boards for front garden areas.
- General
- Drainage and road design subject to Water and Highway Authority approval.
  - Edge restraint to private/blockwork - 2 stretcher course

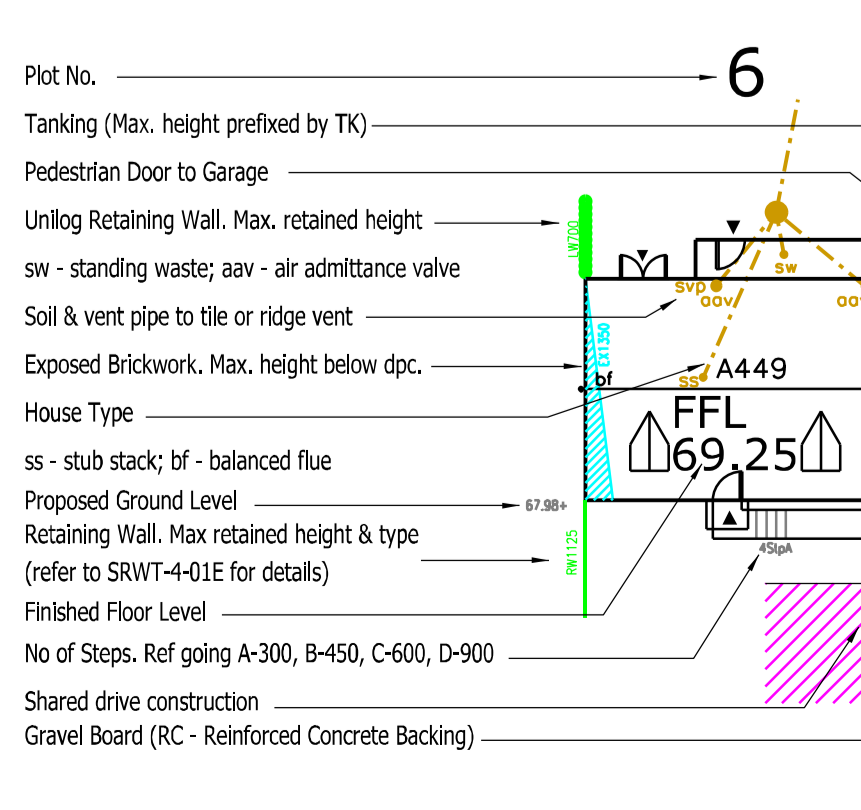
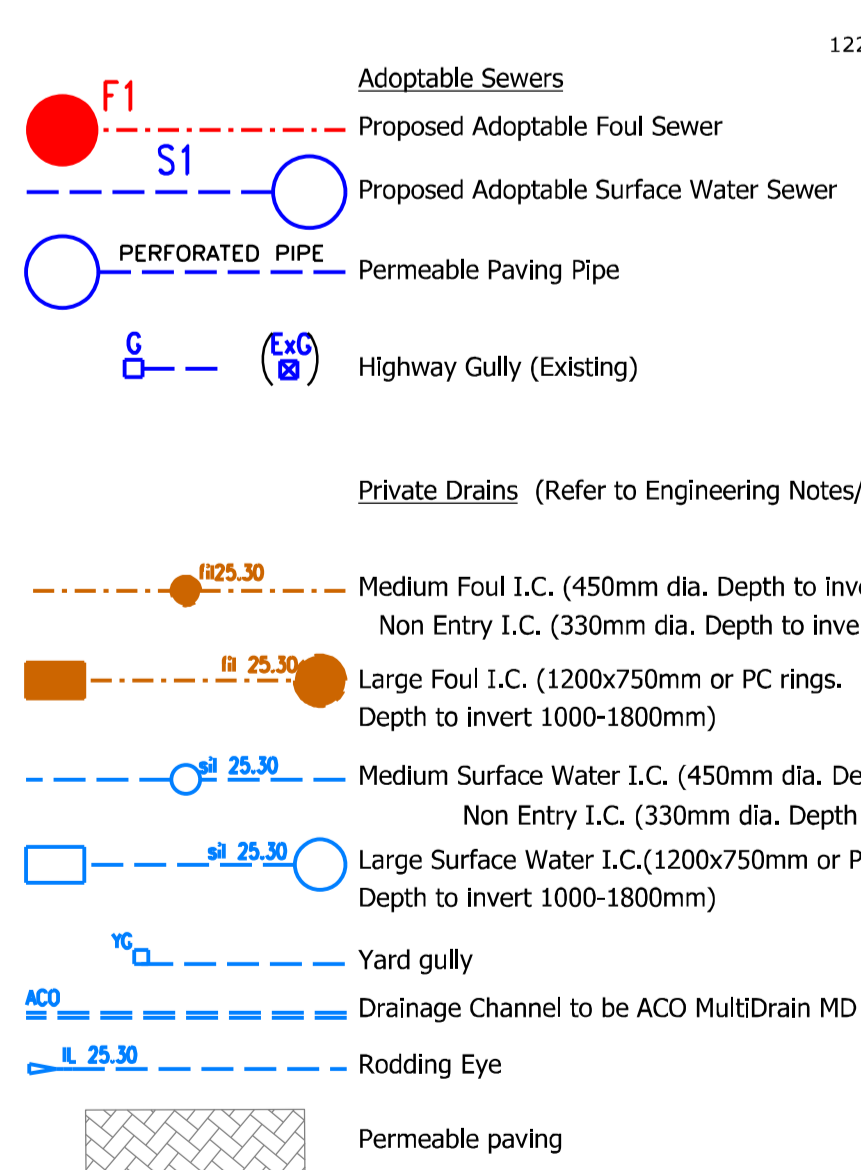

UNTIL TECHNICAL APPROVAL HAS BEEN OBTAINED FROM THE RELEVANT AUTHORITIES, ALL DRAWINGS ARE ISSUED AS PRELIMINARY AND NOT FOR CONSTRUCTION, SHOULD THE CONTRACTOR COMMENCE SITE WORK PRIOR TO APPROVAL BEING GIVEN IT IS ENTIRELY AT HIS OWN RISK.

Revision	Description	Drawn	Checked	Date
Q	Parallel parking bays widened to 2.5m. Private drainage updated to suit OCC highway comments	AT	AT	04/07/14
P	Drainage north of plots 28-33 amended to private. Camp Road inside connections amended	AT	AT	23/06/14
O	Plot 18 1/19 drainage needed to suit land works. Private drainage updated to suit	AT	AT	16/06/14
N	Step on side of plots 12, 21-25, 26-30, 40, 71-75 removed. Gully east of plot 10 moved	AT	AT	16/06/14
M	Gully east of plot 53 relocated to eastern of section. Private drainage north of plot 53	AT	AT	16/06/14
L	S50 and S51 added	AT	AT	24/04/14
K	Gully relocated to front of plot 23	AT	AT	14/04/14
J	Boundaries to suit client comments. S62 (grey) positions updated, road 3 extended to plot 69	AT	AT	14/04/14
I	Connection from sewers added	AT	AT	24/02/14
H	S29 and S31 repositioned. S29 added	AT	AT	11/02/14
G	Revised to suit new plot 23-24 garage positions. Drives connecting to Camp Road amended. Plot 10-11 amended. Private drainage between plots 25 and 26 amended	AT	AT	06/02/14
F	Pipe out of S12 amended	AT	AT	18/11/13
E	FW manhole in front of plot 10 removed	AT	AT	04/11/13
D	Hydrant riser added to flow control chambers	AT	AT	31/10/13
C	Latest layout, HWs and SWs shown. Garage updated to reduce number of headwalls	AT	AT	30/10/13

**Woods Hardwick**  
Architects, Engineers and Development Consultants

15-17 Oakwood Road  
Bovingdon  
Uxbridge  
Middlesex  
UB8 3PH  
T: +44 (0)1895 830000  
E: info@woods-hardwick.com  
www.woods-hardwick.com

Title: UPPER HEYFORD  
Details: BOVIS PARCEL B2A  
PROPOSED ENGINEERING LAYOUT SHEET 1

Scale: A3-1:200 Date: OCTOBER 2013 Drawn: AT Ck: JF

Phase:  Preliminary  Information  Tender  Construction  As Built

HEYF-5-611 R