

PLAN  
1:500

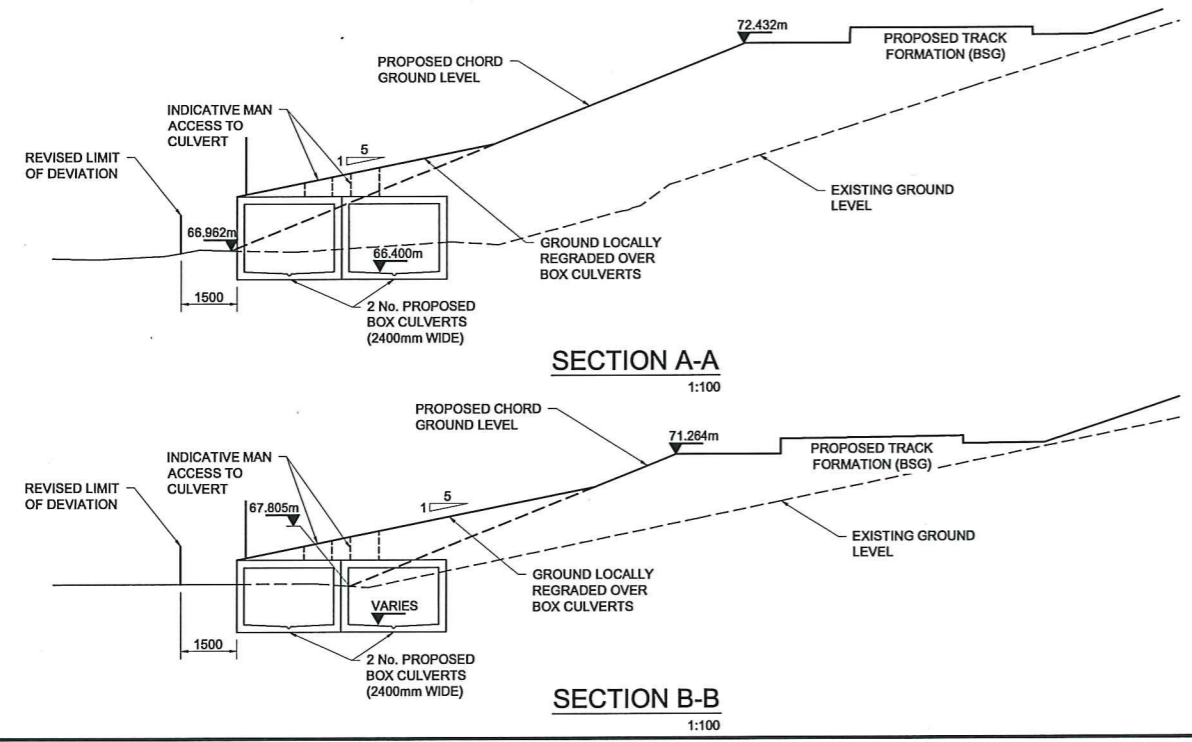

SECTION A-A  
1:100

SECTION B-B  
1:100

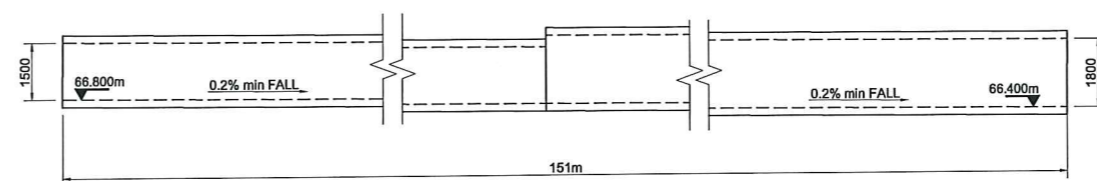

LONG SECTION THROUGH CULVERT  
1:100  
(GROUND LEVELS OMITTED FOR CLARITY)

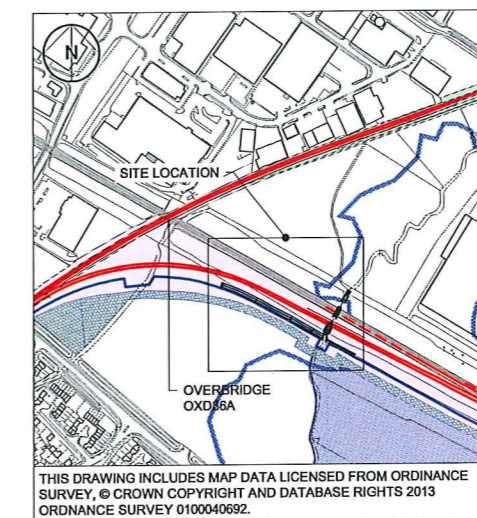

LOCATION PLAN  
1:5000

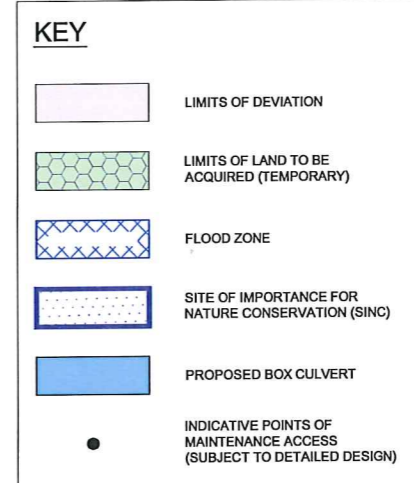

- Legend/Notes
1. THIS DRAWING SHOULD NOT BE SCALED AND IS TO BE USED FOR INFORMATION ONLY.
  2. ALL DIMENSIONS IN MILLIMETRES UNLESS NOTED OTHERWISE
  3. TWA DRAWING INFORMATION IS AS SUPPLIED BY ARDENT AND IS FOR INFORMATION ONLY. ANY SPECIFIC QUERIES REGARDING TWA/LAND BOUNDARIES CONTACT ARDENT.
  4. TOTAL STORAGE VOLUME IN DEPTH BAND 66.4-66.6m APPROXIMATELY 36m<sup>3</sup>.
  5. TOTAL STORAGE VOLUME IN DEPTH BAND 66.6-66.8m APPROXIMATELY 108m<sup>3</sup>.
  6. TOTAL STORAGE VOLUME IN DEPTH BAND 66.8-67.0m APPROXIMATELY 144m<sup>3</sup>.
  7. MINIMUM AVAILABLE FLOOD COMPENSATION VOLUME IN DEPTH BAND 67.0-67.15m APPROXIMATELY 108m<sup>3</sup>.
  8. ACCESS ARRANGEMENTS TO THE BOX CULVERT ARE SUBJECT TO FURTHER ENGINEERING.
  9. TOE DRAINAGE TO BE PROVIDED AND WILL BE ADDRESSED DURING DETAILED DESIGN STAGE.

Rev	Date	Description of Revisions	Drawn	Chkd	Appr
P02	01.07.13	NR COMMENTS INCORPORATED		PL	AR JG
P01	19.06.13	PRELIMINARY		ST	AR JG

PRELIMINARY



Contractor(s)

**ATKINS**

The Axis  
10 Holiday Street  
Birmingham  
West Midlands  
B1 1TF

Tel: +44 (0)121 483 5000  
Fax: +44 (0)121 483 6333

Project  
**EAST WEST RAIL PHASE 1**

Drawing Title  
**BICESTER CHORD  
FLOOD COMPENSATION  
OPTION B - BOX CULVERT**

Designed	P.LAWRENCE	Signed	<i>[Signature]</i>	Date	
Drawn	S.TOLLEY	Signed	<i>[Signature]</i>	Date	13/06/2013
Checked	A.ROSE	Signed	<i>[Signature]</i>	Date	
Approved	J.GREEN	Signed	<i>[Signature]</i>	Date	24/07/13
Scale(s)	AS SHOWN	ELR & Mileage			