

FOR CONTINUATION  
SEE DWG 7248

**MATCH LINE**  
CO-ORDINATES

- P92 REMOVED
- P93 REMOVED
- P94 457792.28E 224998.60N
- P95 457792.85E 224996.24N
- P96 457794.98E 224993.21N
- P97 457798.14E 224992.70N
- P98 457798.07E 224989.69N
- P99 457793.88E 224989.25N
- P100 457790.96E 224986.59N
- P101 457790.56E 224985.22N
- P102 457787.33E 224977.60N
- P103 457781.44E 224981.45N
- P104 457780.80E 224978.32N
- P105 457784.23E 224976.06N
- P106 457782.54E 224973.89N
- P107 457778.97E 224975.51N
- P108 457776.28E 224973.69N
- P109 457781.47E 224970.43N
- P110 457770.72E 224956.50N
- P111 457765.38E 224959.80N
- P112 457764.82E 224956.86N
- P113 457768.22E 224954.52N
- P114 457766.78E 224951.66N
- P115 457763.24E 224953.80N
- P116 457761.30E 224951.68N
- P117 457766.53E 224948.26N
- P118 457763.22E 224931.37N
- P119 457763.07E 224928.85N
- P120 457764.90E 224925.32N
- P121 457761.91E 224923.79N
- P122 457756.61E 224927.14N
- P123 457755.80E 224920.13N
- P124 457767.36E 224920.84N
- P125 457764.28E 224921.02N
- P126 457764.82E 224919.13N
- P127 457759.39E 224916.54N
- P128 457757.79E 224907.45N
- P129 457753.76E 224908.20N
- P130 457753.00E 224904.31N
- P131 457751.06E 224903.53N
- P132 457752.18E 224899.50N
- P132A 457751.17E 224894.47N
- P133 457749.17E 224885.69N
- P134 457746.00E 224886.19N
- P135 457744.34E 224884.76N
- P136 457742.25E 224862.11N
- P137 457732.26E 224851.96N
- P137A 457742.80E 224854.85N
- P138 457752.32E 224875.52N
- P139 457751.06E 224865.21N
- P140 457730.71E 224856.84N
- P141 457731.82E 224845.302N
- P142 457716.71E 224833.92N
- P141B 457720.52E 224839.45N
- P142 457718.88E 224828.24N
- P143 457753.04E 224845.26N
- P144 457752.04E 224846.34N
- P145 457756.42E 224863.16N
- P145A 457759.97E 224843.08N
- P146 457762.45E 224863.39N
- P147 457762.83E 224839.22N
- P148 457759.69E 224836.69N
- P149 457758.84E 224832.84N
- P150 457760.83E 224828.04N
- P151 457716.46E 224821.62N
- P151A 457716.62E 224815.46N
- P152 457714.87E 224811.84N
- P152A 457707.87E 224802.84N
- P153 457704.20E 224839.77N
- P153 457722.30E 224820.30N
- P154 457726.04E 224819.96N
- P155 457727.20E 224820.36N
- P156 457740.96E 224826.77N
- P157 457744.17E 224829.375N
- P158 457743.81E 224820.61N
- P159 457747.50E 224822.15N
- P160 457731.51E 224814.92N
- P161 457734.92E 224814.29N
- P162 457739.32E 224816.32N
- P163 457740.17E 224819.20N
- P164 457758.55E 224820.33N
- P165 457784.25E 224809.65N
- P166 457786.64E 224815.28N
- P167 457787.50E 224809.47N
- P168 457789.04E 224813.27N
- P169 457793.10E 224811.61N
- P170 457791.69E 224807.76N
- P171 457793.95E 224805.75N
- P172 457796.26E 224811.41N
- P173 457834.05E 224789.37N
- P174 457836.37E 224795.04N
- P175 457838.76E 224792.98N
- P176 457837.07E 224789.25N
- P177 457842.83E 224791.41N
- P178 457841.28E 224787.51N
- P179 457845.96E 224792.06N
- P180 457845.70E 224785.50N
- P181 457843.40E 224784.76N
- P182 457859.35E 224778.81N
- P183 457859.81E 224778.82N
- P184 457879.37E 224777.41N
- P185 457886.87E 224774.35N
- P186 457867.23E 224775.89N
- P187 457866.87E 224775.03N
- P188 457878.32E 224771.35N
- P189 457877.98E 224770.50N
- P190 457880.30E 224770.54N
- P191 457889.25E 224766.89N
- P192 457891.24E 224765.94N
- P193 457890.96E 224765.24N
- P194 457910.92E 224757.04N
- P195 457911.21E 224757.73N
- P196 457912.03E 224757.58N

**WILLMOTT DIXON HOUSING**  
**REVIEWED**

PRELIMINARY	STATUS
FOR COMMENT	A
FOR CONSTRUCTION	B
SIGNED	ND
DATE	23.06.15
	C

MATCH LINE  
FOR CONTINUATION  
SEE DWG 7250

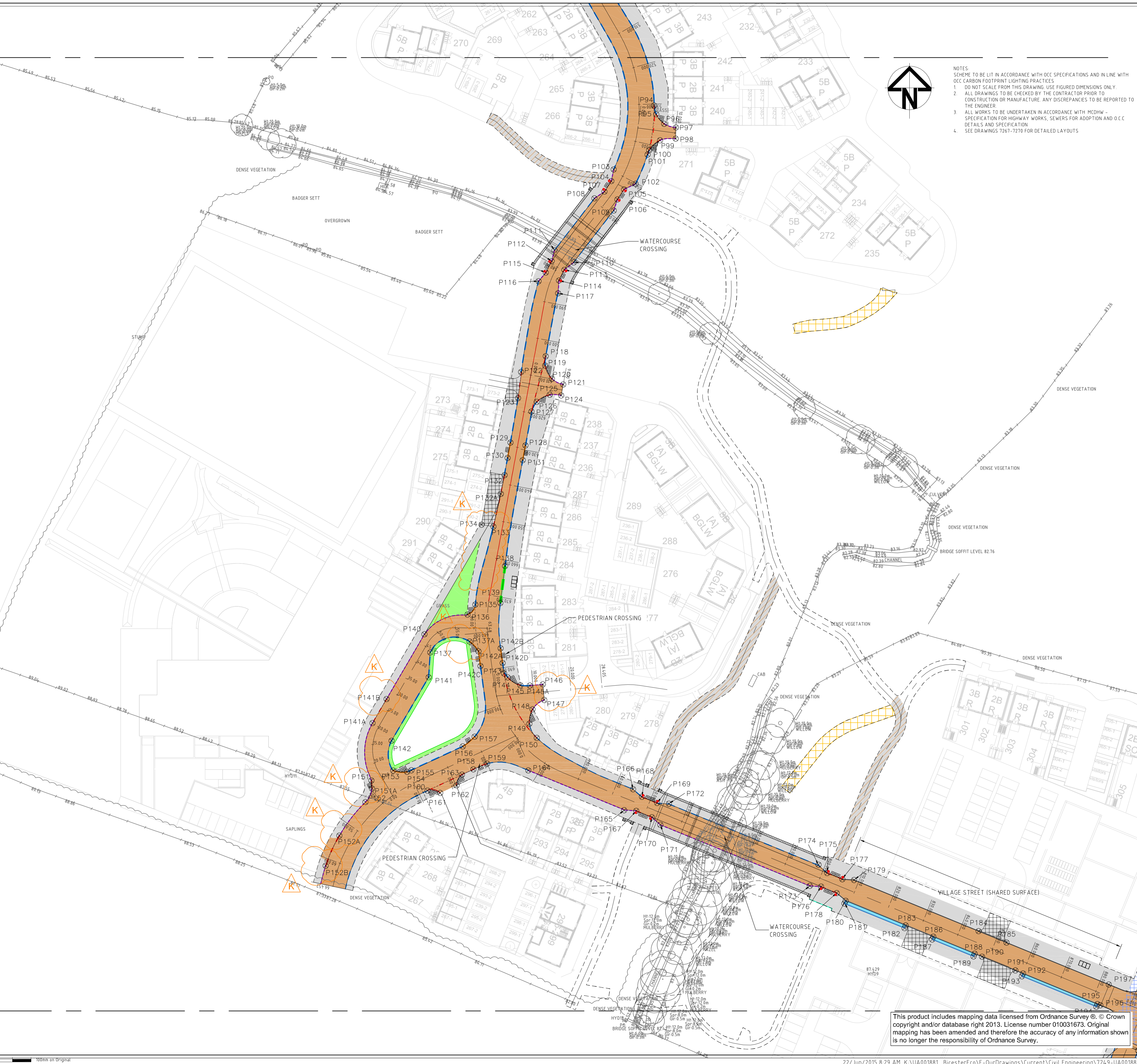

- NOTES:
- SCHEME TO BE LIT IN ACCORDANCE WITH OCC SPECIFICATIONS AND IN LINE WITH OCC CARBON FOOTPRINT LIGHTING PRACTICES
  - DO NOT SCALE FROM THIS DRAWING. USE FIGURED DIMENSIONS ONLY.
  - ALL DRAWINGS TO BE CHECKED BY THE CONTRACTOR PRIOR TO CONSTRUCTION OR MANUFACTURE. ANY DISCREPANCIES TO BE REPORTED TO THE ENGINEER.
  - ALL WORKS TO BE UNDERTAKEN IN ACCORDANCE WITH MCDHW - SPECIFICATION FOR HIGHWAY WORKS, SEWERS FOR ADOPTION AND O.C.C. DETAILS AND SPECIFICATION
  - SEE DRAWINGS 7267-7270 FOR DETAILED LAYOUTS

- KEY
- FULL CARRIAGEWAY CONSTRUCTION (SEE DRG 7271 FOR DETAIL)
  - FULL FOOTWAY CONSTRUCTION (SEE DRG 7271 FOR DETAIL)
  - LANDSCAPED VERGE (SEE DRG 7271 FOR DETAIL)
  - ROADSIDE SUDS FEATURE (SEE DRGS 7277 AND 7278 FOR DETAILS)
  - FOOTWAY CROSSING (SEE DRG 7271 FOR DETAIL)
  - COMMUNITY FOOTPATH (SEE DRG 7271 FOR DETAIL)
  - GRASSCRETE CONSTRUCTION POND ACCESS (SEE DRG 7271 FOR DETAIL)
  - GATEWAY FEATURE CONSTRUCTION
  - UNCONTROLLED CROSSING POINT - (SEE OCC DETAIL HSD/1100/102)
  - PROPOSED BOLLARD (REFER TO O.C.C. DRAWING No. HSD/1200/220 FOR DETAILS)
  - FOOTWAY EDGING (SEE DRG 7271 FOR DETAIL)
  - DROP KERB TYPE (SEE DRG 7271 FOR DETAIL)
  - STANDARD KERB 125mm UPSTAND GENERAL (SEE DETAIL DRGS 7271, 7277 & 7284 FOR DETAILS AT COMMUNITY STREET CONNECTIONS AND ROADSIDE SUDS FEATURES)
  - KASSEL KERB (SEE DRG 7272 FOR DETAIL)
  - FLUSH KERB TYPE (SEE DRG 7271 FOR DETAIL)
  - KERB DRAINAGE BLOCK (HYDROKERB OR SIMILAR APPROVED, SEE DRG 7271 FOR DETAIL)
  - DROPPED KERB DRAINAGE BLOCK (HYDROKERB OR SIMILAR APPROVED, SEE DRG 7271 FOR DETAIL)

Issue	Description	Date
K	COORDS ADDED, KERB TYPE AMENDED AND SIDE ROAD FINISHING POSITION AMENDED	22/06/15
J	ROAD LAYOUT AND COORDINATES REVISED	08/06/15
H	COORDINATE P145A ADDED	14/04/15
G	KERBING AMENDED	01/04/15
F	KERBING AMENDED	20/03/15
E	KERBING & KEY AMENDED	13/03/15
D	EXTENTS OF KERBS REVISED	20/08/14
C	GENERAL REVISIONS	04/04/14
B	KERB NOTE IN KEY REVISED	28/02/14
A	CONSTRUCTION ISSUE	09/08/13
10	CROSSING ADDED AT CH 631 AND DROPPED REMOVED FROM SCHOOL JUNCTION	17/05/13
09	HIGHWAY BOUNDARY REVISED	06/11/12
08	GENERAL REVISIONS	19/10/12
07	MASTERPLAN REVISED	05/10/12

**FOR CONSTRUCTION**

Scales	1:500	Author	M LLEWELLYN
Original Size	A1	Checker <td>S DAVIES</td>	S DAVIES
Height Datum	O.S.	Approver <td>S DAVIES</td>	S DAVIES
Grid	O.S.	Copyright reserved	

Filename: 7249-UA001881-UP210-S38-K-SURFACING & KERBING.DWG  
Client:



Hyder Consulting (UK) Limited  
HCL House  
St. Mellons Business Park  
Fortran Road, St Mellons  
Cardiff  
CF3 0EY  
Tel: +44 029 20926700  
Fax: +44 029 20925222

Project: BICESTER ECO DEVELOPMENT EXEMPLAR SITE  
Title: EXEMPLAR SITE (S38) SURFACING AND KERBING SHEET 3 OF 4

Drawing No.	Project No.	Issue
7249	UA001881	K

CAD FILE: K:\UA001881\_BicesterEcoE-OurDrawings\Curren\Civil Engineering\7249-UA001881-UP210-S38-K-SURFACING & KERBING.dwg  
PRINTED BY: DHA16298 - JUNE 23 2015 - 8:29AM  
UPDATED BY: DHA16298 - JUNE 23 2015 - 8:29AM

This product includes mapping data licensed from Ordnance Survey ©. Crown copyright and/or database right 2013. License number 010031673. Original mapping has been amended and therefore the accuracy of any information shown is no longer the responsibility of Ordnance Survey.