

CO-ORDINATES

P1 457766.79E 225468.02N  
 P2 457777.12E 225459.61N  
 P3 457764.55E 225464.53N  
 P4 457768.51E 225461.33N  
 P5 457761.90E 225459.53N  
 P6 457769.68E 225460.47N  
 P7 457773.64E 225457.20N  
 P8 457748.61E 225439.92N  
 P9 457754.23E 225436.30N  
 P10 457751.67E 225433.23N  
 P11 457746.46E 225436.55N  
 P12 457750.61E 225431.80N  
 P13 457752.28E 225430.78N  
 P14 457749.77E 225430.60N  
 P15 457733.52E 225433.67N  
 P16 457729.45E 225429.15N  
 P17 457732.87E 225397.59N  
 P18 457731.72E 225399.76N  
 P19 457731.06E 225398.44N  
 P20 457730.27E 225394.21N  
 P21 457731.69E 225390.32N  
 P22 457734.71E 225387.73N  
 P23 457732.06E 225382.34N  
 P24 457728.26E 225383.03N  
 P25 457724.23E 225381.62N  
 P26 457721.57E 225378.50N  
 P27 457723.36E 225377.61N  
 P28 457720.97E 225377.02N  
 P29 457718.76E 225365.50N  
 P30 457716.89E 225366.21N  
 P31 457717.46E 225367.71N  
 P32 457712.12E 225353.58N  
 P33 457712.69E 225355.09N  
 P34 457714.57E 225354.37N  
 P35 457703.77E 225310.61N  
 P36 457701.88E 225312.33N  
 P37 457701.76E 225310.72N  
 P38 457701.75E 225308.23N  
 P39 457695.77E 225307.58N  
 P40 457697.18E 225305.21N  
 P41 457700.65E 225305.60N  
 P42 457701.29E 225301.34N  
 P43 457697.92E 225300.42N  
 P44 457699.15E 225295.88N  
 P45 457702.52E 225296.80N  
 P46 457700.67E 225292.00N  
 P47 457703.72E 225293.76N  
 P48 457706.56E 225290.87N  
 P49 457707.36E 225291.36N  
 P50 457701.15E 225288.25N  
 P51 457707.48E 225289.38N  
 P52 457720.42E 225275.43N  
 P53 457718.60E 225276.10N  
 P54 457719.67E 225274.89N  
 P55 457712.81E 225271.41N  
 P56 457726.73E 225266.90N

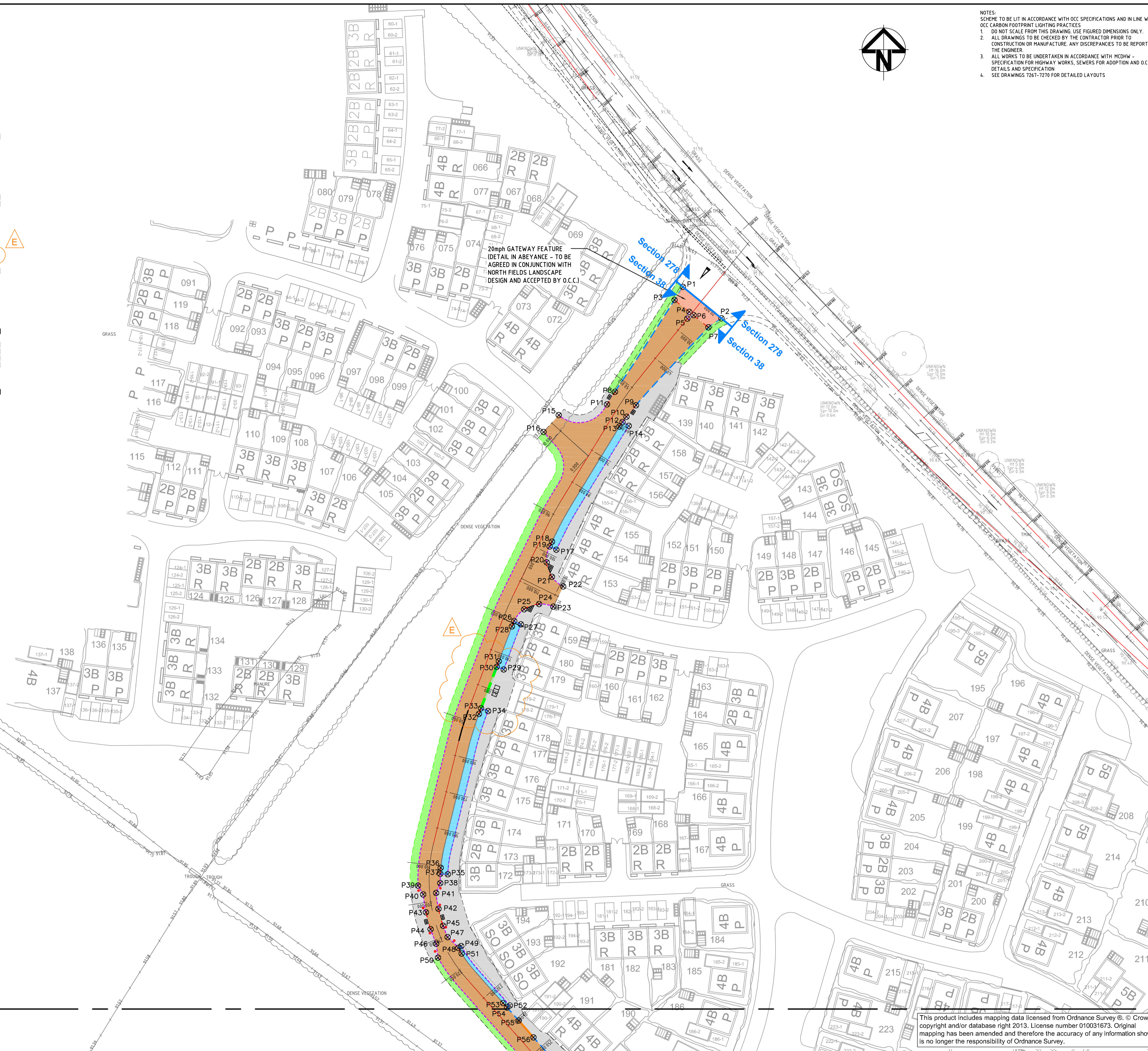

- NOTES
- SCHEME TO BE LIT IN ACCORDANCE WITH OCC SPECIFICATIONS AND IN LINE WITH OCC CARBON FOOTPRINT LIGHTING PRACTICES
  - DO NOT SCALE FROM THIS DRAWING. USE FIGURED DIMENSIONS ONLY.
  - ALL DRAWINGS TO BE CHECKED BY THE CONTRACTOR PRIOR TO CONSTRUCTION OR MANUFACTURE. ANY DISCREPANCIES TO BE REPORTED TO THE ENGINEER.
  - ALL WORKS TO BE UNDERTAKEN IN ACCORDANCE WITH MCDHW - SPECIFICATION FOR HIGHWAY WORKS, SEWERS FOR ADOPTION AND O.C.C. DETAILS AND SPECIFICATION
  - SEE DRAWINGS 7247-7249 FOR DETAILED LAYOUTS

- KEY
- FULL CARRIAGEWAY CONSTRUCTION (SEE DRG 7271 FOR DETAIL)
  - FULL FOOTWAY CONSTRUCTION (SEE DRG 7271 FOR DETAIL)
  - LANDSCAPED VERGE (SEE DRG 7271 FOR DETAIL)
  - ROADSIDE SUDS FEATURE (SEE DRGS 7277 AND 7278 FOR DETAILS)
  - FOOTWAY CROSSING (SEE DRG 7271 FOR DETAIL)
  - COMMUNITY FOOTPATH (SEE DRG 7271 FOR DETAIL)
  - GRASSCRETE CONSTRUCTION POND ACCESS (SEE DRG 7271 FOR DETAIL)
  - GATEWAY FEATURE CONSTRUCTION
  - UNCONTROLLED CROSSING POINT - (SEE OCC DETAIL HSD/1100/102)
  - PROPOSED BOLLARD (REFER TO O.C.C. DRAWING No. HSD/1200/220 FOR DETAILS)
  - FOOTWAY EDGING (SEE DRG 7271 FOR DETAIL)
  - DROP KERB TYPE (SEE DRG 7271 FOR DETAIL)
  - STANDARD KERB 125mm UPSTAND GENERAL (SEE DETAIL DRGS 7271, 7277 & 7284 FOR DETAILS AT COMMUNITY STREET CONNECTIONS AND ROADSIDE SUDS FEATURES)
  - KASSEL KERB (SEE DRG 7272 FOR DETAIL)
  - FLUSH KERB TYPE (SEE DRG 7271 FOR DETAIL)
  - KERB DRAINAGE BLOCK (HYDROKERB OR SIMILAR APPROVED, SEE DRG 7271 FOR DETAIL)
  - DROPPED KERB DRAINAGE BLOCK (HYDROKERB OR SIMILAR APPROVED, SEE DRG 7271 FOR DETAIL)

Issue	Description	Date
E	KERBING AND COORDS P31, P32 AMENDED	23/04/15
D	KERBING & KEY AMENDED	13/03/15
C	GENERAL REVISIONS	04/04/14
B	KERB NOTE IN KEY REVISED	28/02/14
A	CONSTRUCTION ISSUE	09/08/13
09	DROPPED KERBS REMOVED FROM TWO JUNCTS	17/05/13
08	SCALE REVISION & HIGHWAY BOUNDARY REVISED	05/11/12
07	GENERAL REVISIONS	19/10/12
06	DETAIL REFERENCES IN KEY AMENDED	07/09/12
05	MINOR REVISIONS	27/07/12
04	DESIGN REVISED	22/06/12
03	DESIGN REVISED	MAR 12
02	DESIGN REVISED	JULY 11

Status: **FOR CONSTRUCTION**

Scales	1:500	Author	M.LLEWELIN
Original Size	A1	Checker	S.A.DAVIES
Height Datum	O.S.	Approver	S.A.DAVIES
Grid	O.S.	Copyright	reserved

Filename: 7247-7249-UA001881-UP21D-S38-H-SURFACING & KERBING.DWG



Hyder Consulting (UK) Limited  
 HCL House  
 St. Mellons Business Park  
 Fortran Road, St Mellons  
 Cardiff  
 CF3 0EY  
 Tel: +44 029 20926700  
 Fax: +44 029 20925222

Project: **BICESTER ECO DEVELOPMENT EXEMPLAR SITE**

Title: **EXEMPLAR SITE (S38) SURFACING AND KERBING SHEET 1 OF 4**

Drawing No. 7247 — Project No. UA001881 — Issue E

<b>WILLMOTT DIXON HOUSING REVIEWED</b>	
PRELIMINARY	STATUS
FOR COMMENT	A
FOR CONSTRUCTION	B
SIGNED ND	C
DATE 23.04.15	

MATCH LINE FOR CONTINUATION SEE DWG 7248

This product includes mapping data licensed from Ordnance Survey © Crown copyright and/or database right 2013. License number 010031673. Original mapping has been amended and therefore the accuracy of any information shown is no longer the responsibility of Ordnance Survey.

CAD FILE: K:\UA001881\BicesterEco\Current\Civil Engineering\7247-7249-UA001881-UP21D-S38-H-SURFACING & KERBING.dwg  
 PRINTED BY: DHA16298 - APRIL 23/2015 - 3:26PM