

**CARRIAGEWAY REGULATING DETAIL**  
SCALE 1:20

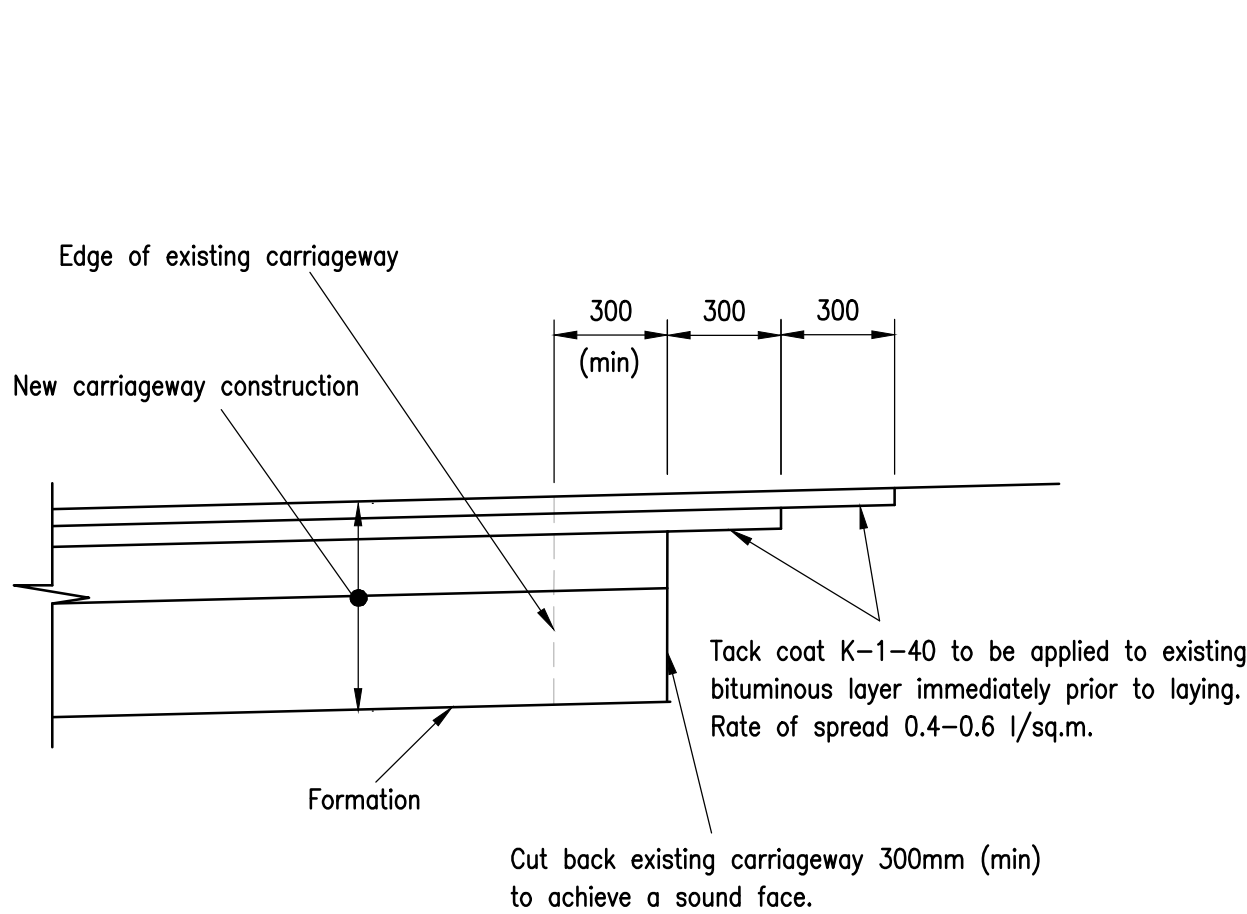

**CARRIAGEWAY TIE-IN DETAIL**  
SCALE 1:20

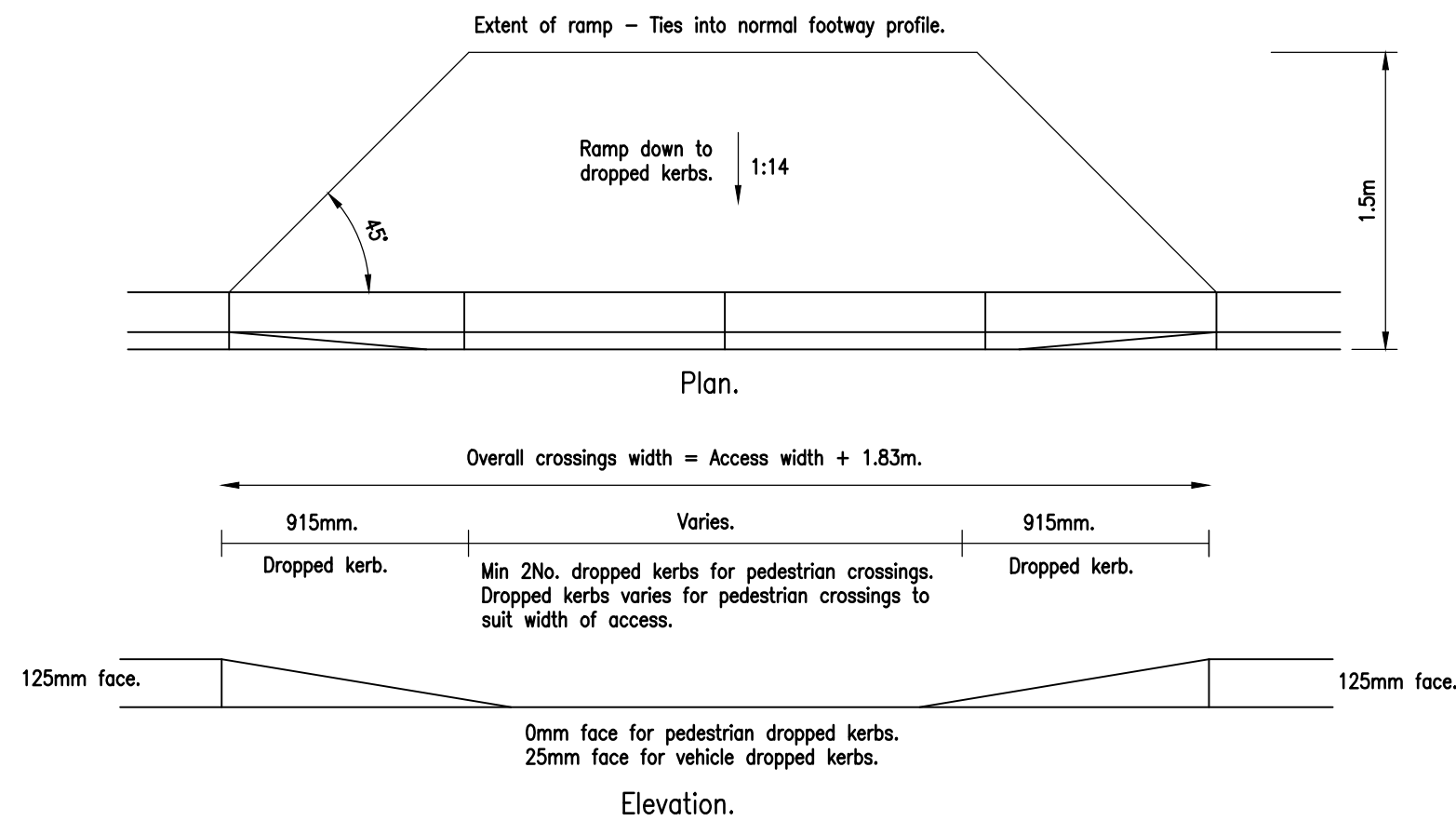

**PEDESTRIAN / VEHICLE DROPPED CROSSING DETAILS**  
NTS

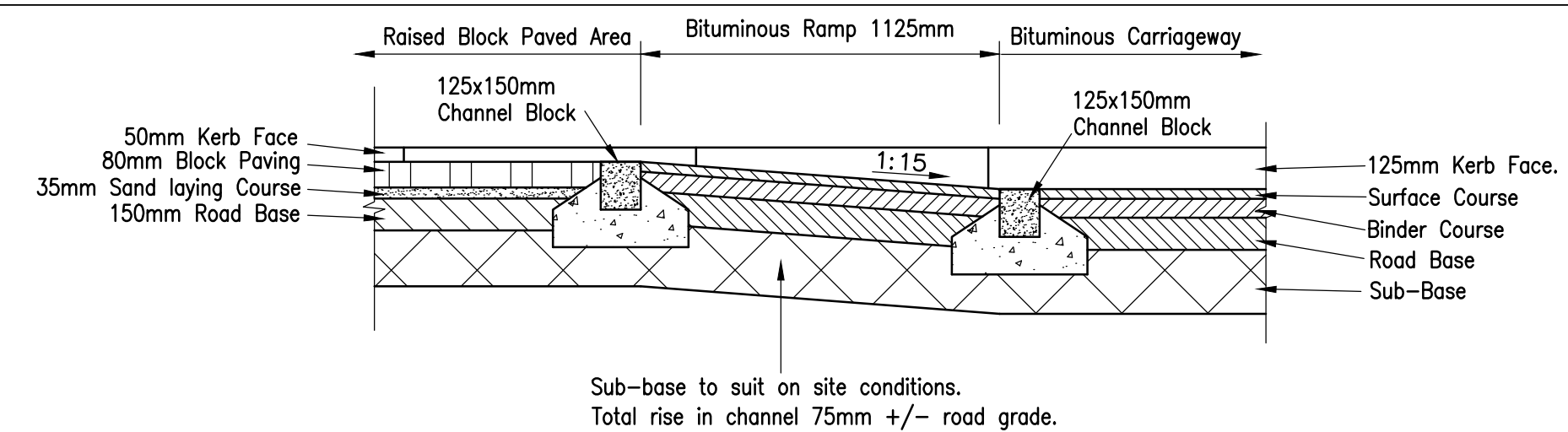

**BITUMINOUS RAMPS ON BUS ROUTES INTO RAISED BLOCK PAVED TRAFFIC CALMING FEATURE**  
Scale 1:20

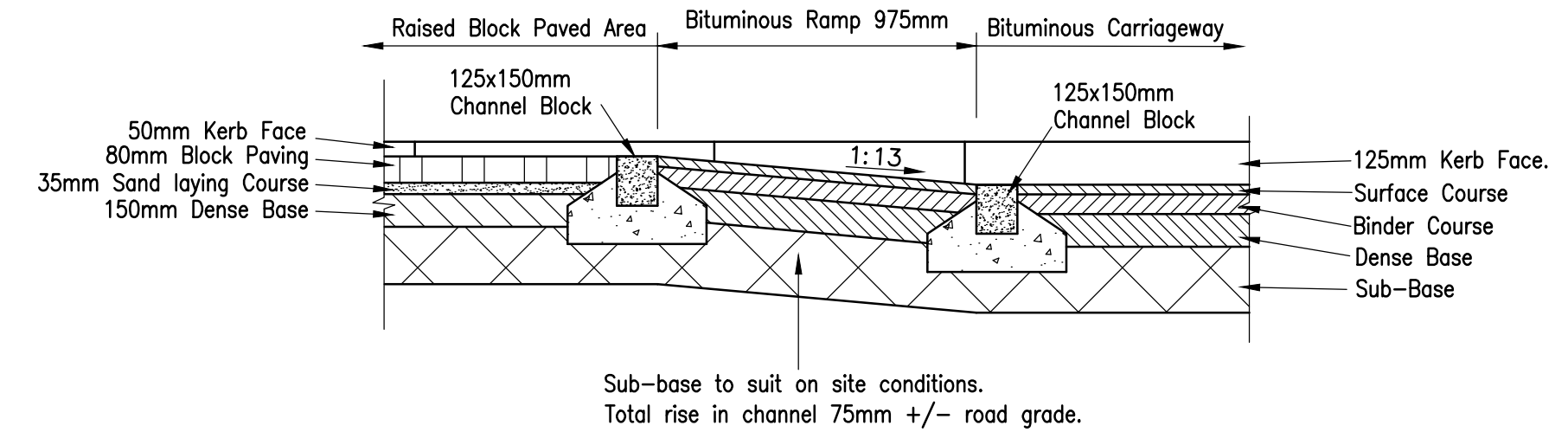

**BITUMINOUS RAMPS ON ACCESS ROADS INTO RAISED BLOCK PAVED TRAFFIC CALMING FEATURE**  
Scale 1:20

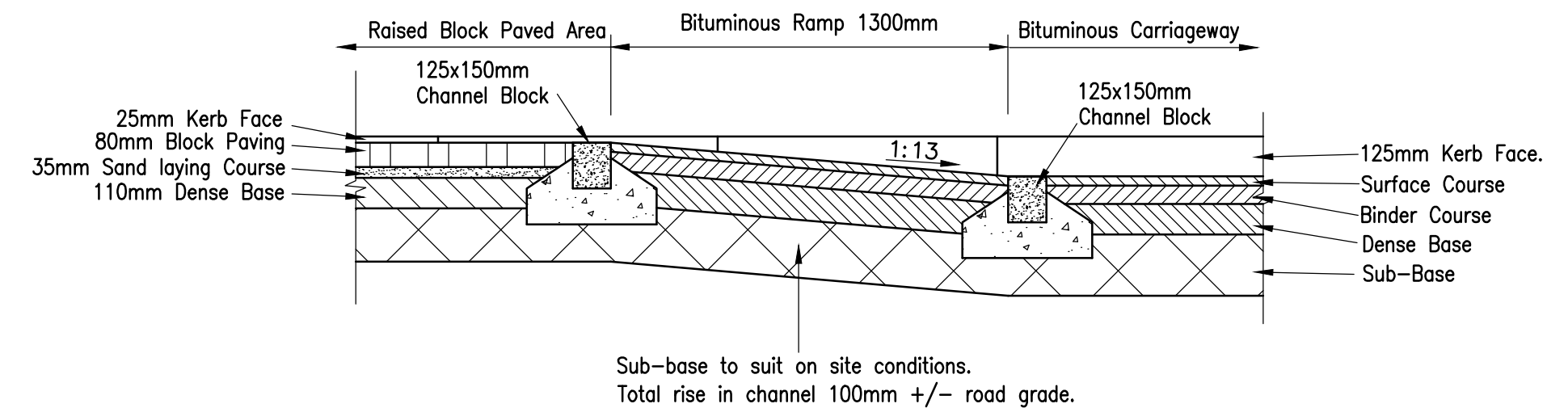

**BITUMINOUS RAMPS INTO RAISED BLOCK PAVED ACCESS WAY**  
Scale 1:20

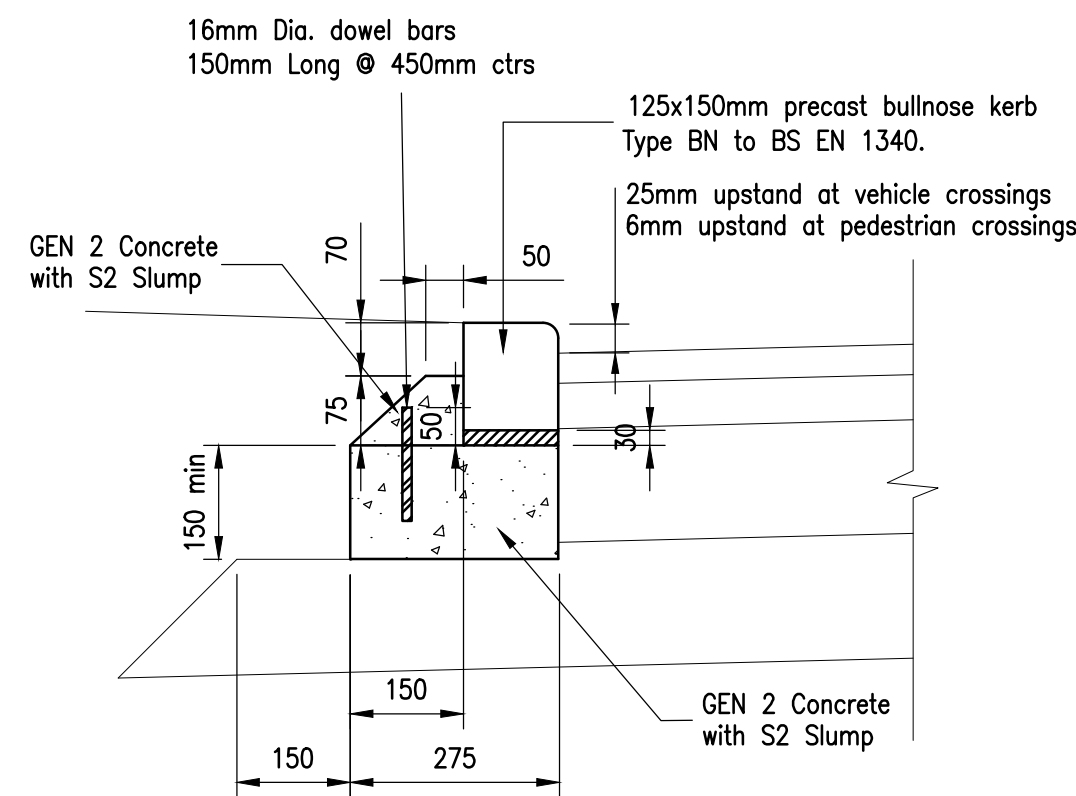

**BULLNOSE DROPPED KERB**  
SCALE 1:10

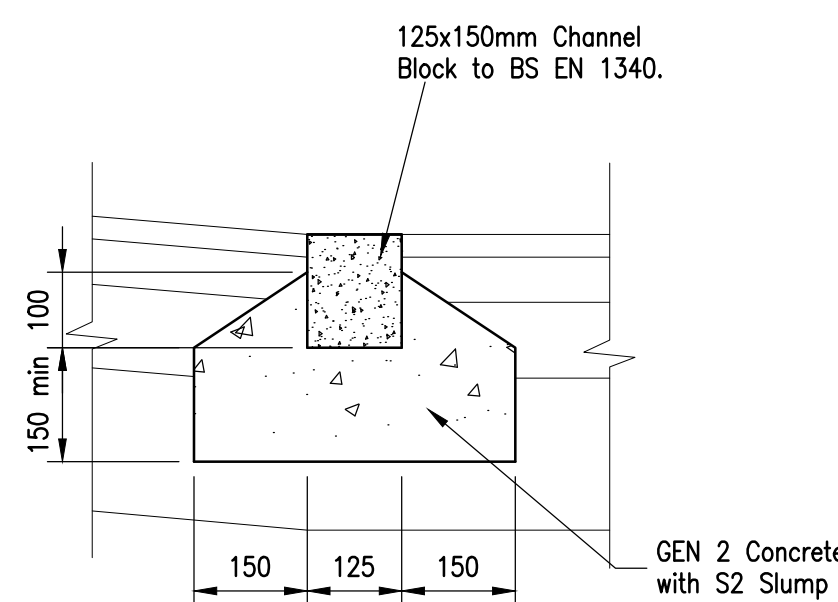

**CHANNEL BLOCKS AT RAMPS**  
SCALE 1:10

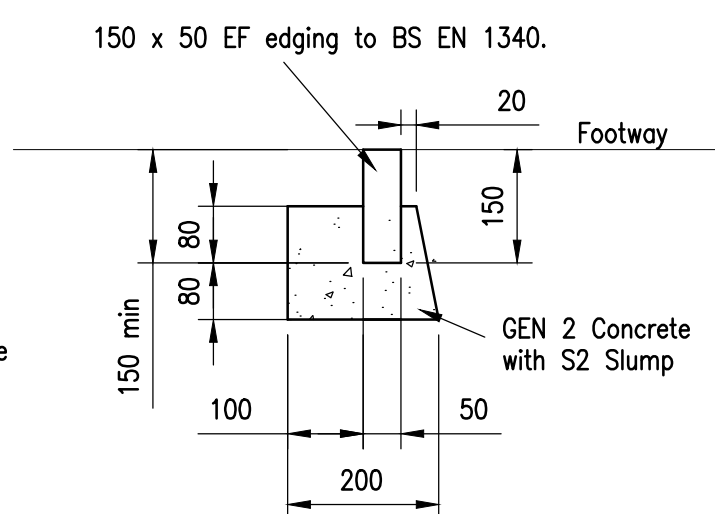

**FOOTWAY/VERGE EDGING DETAIL**  
SCALE 1:10

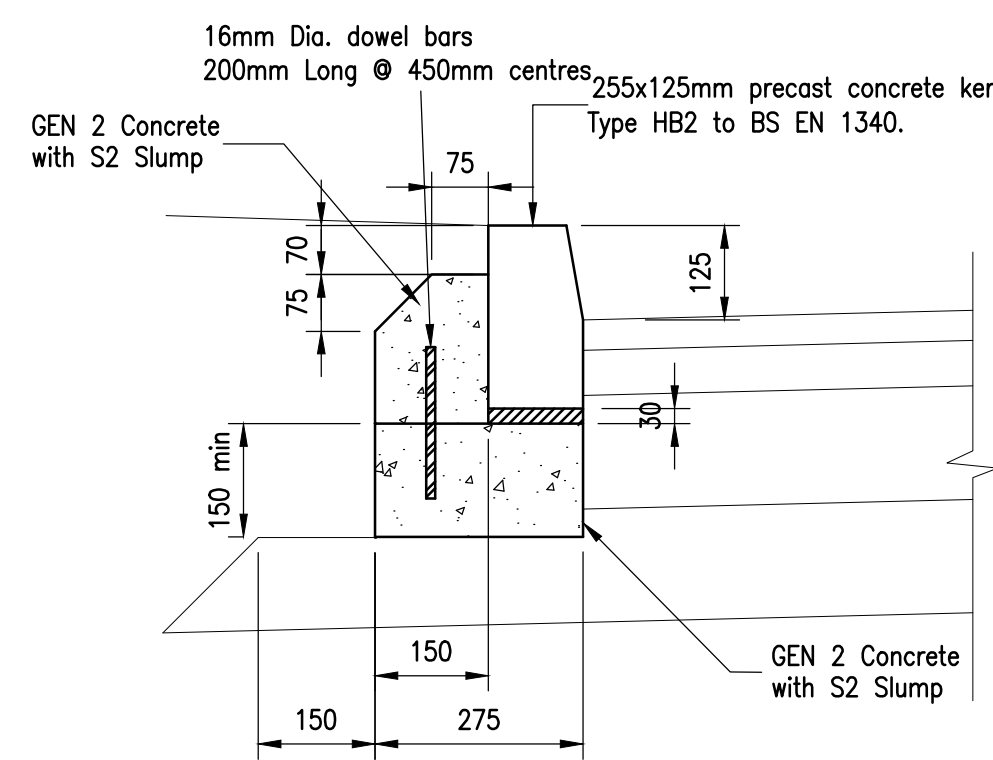

**HALF BATTERED KERB**  
SCALE 1:10

**TACTILE PAVING NOTES:**

1. Tactile paving shall be used at pedestrian and cycle crossing points to identify an appropriate place to cross.
2. The use of tactile paving shall be in accordance with clause 5.16 and the recommendations given in "Guidance on the use of Tactile Paving Surfaces" 1998 published by the Department of the Environment, Transport & the Regions.
3. Crossing points should be laid out directly opposite each other with domes aligned to the direction of the crossing.
4. The paving slabs to be bedded on 35mm sand with foundation of 200mm Type 1 Sub-base.
5. Tactile paving shall be buff coloured for all uncontrolled crossings and red at any signal controlled crossings.

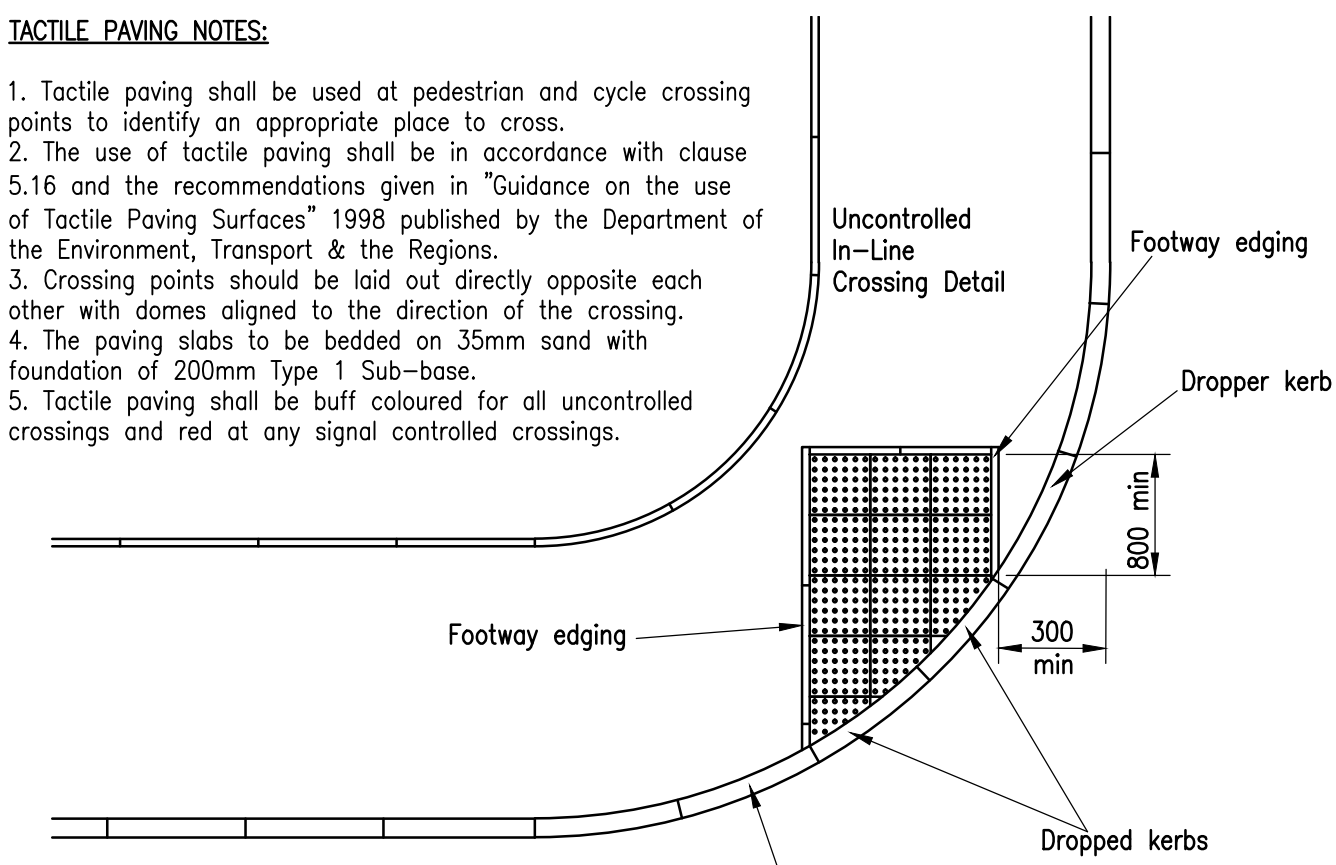

**TYPICAL TACTILE CROSSING LAYOUT**  
Scale 1:50

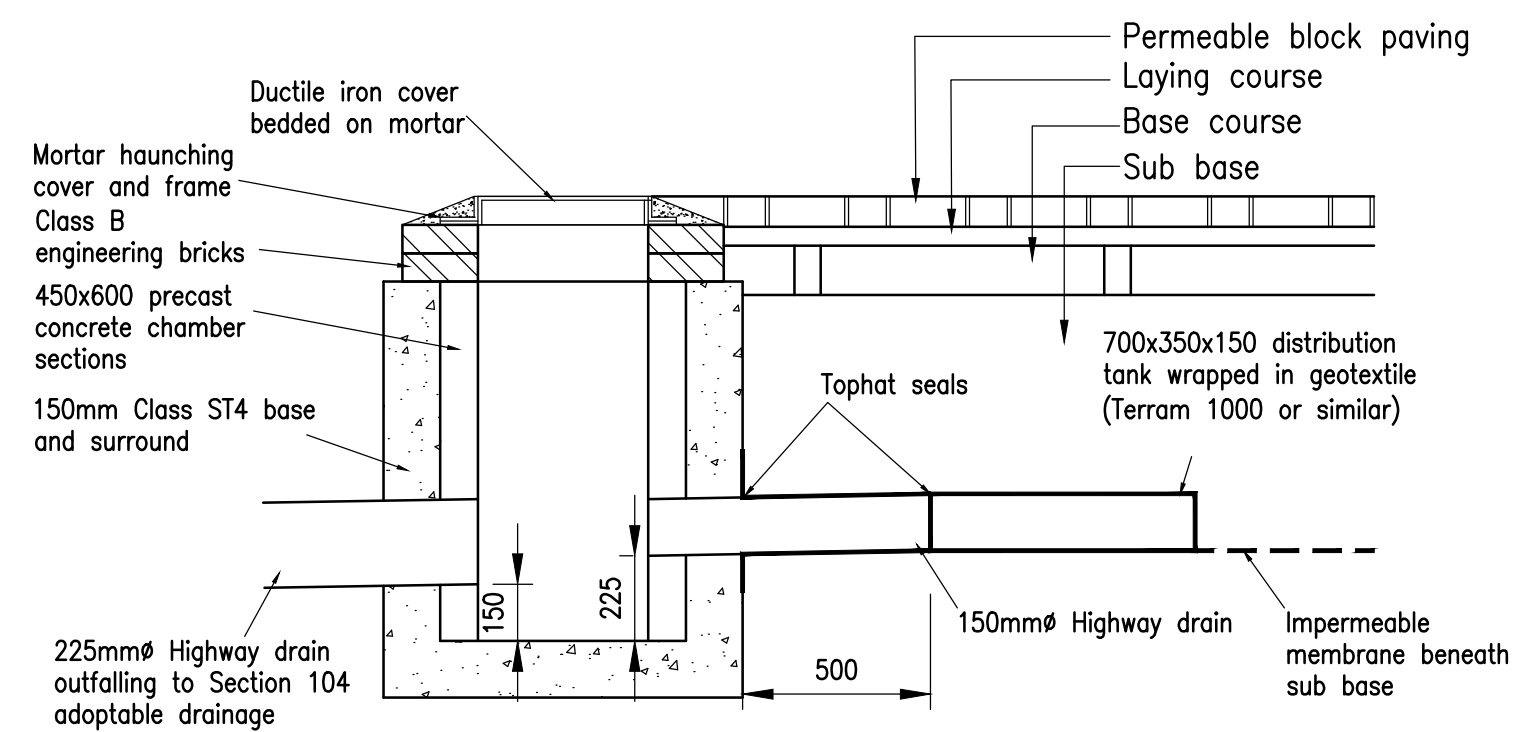

**TYPICAL SECTION DETAIL FOR CATCHPIT MANHOLES S5, S12 and S18**  
SCALE 1:20

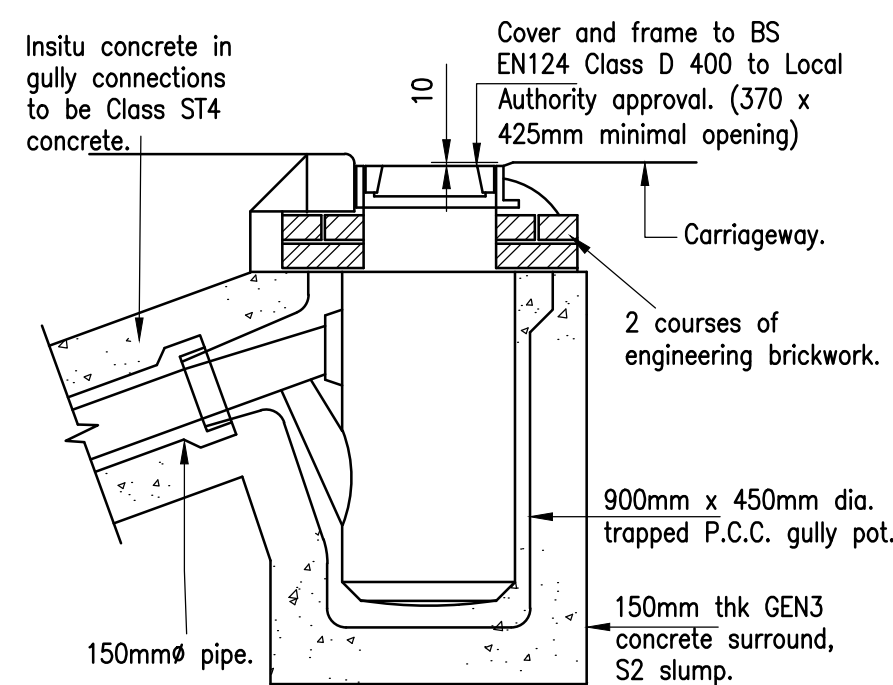

**TYPICAL GULLY DETAIL**  
SCALE 1:20

**General Notes.**

1. Do not scale this drawing.
2. This drawing is to be read in conjunction with all relevant Architect's, Engineer's and Specialist drawings and specifications.
3. All dimensions are in millimetres unless noted otherwise. All levels are in metres unless noted otherwise.
4. Any discrepancies noted on site are to be reported to the Engineer immediately.
5. The Contractor is responsible for ensuring that all works are to the satisfaction of the Engineer, and shall be deemed to have included in his rates for any necessary testing.
6. Bituminous spray to be applied to all existing surfaces where directly overlaid by bituminous material. Rate of spread to be 0.4-0.6 litres per square metre.
7. All works shall be carried out in accordance with the Oxfordshire County Council Design Guide.
8. Clauses refer to the Specification for Highway Works, unless otherwise stated.

REV.	AMENDMENTS	DRN.	CHK.	DATE.
PROJECT: LONGFORD PARK BODICOTE BANBURY				
DRAWING TITLE: PHASE 1 HIGHWAY CONSTRUCTION DETAILS SHEET 2 OF 2				
CLIENT: BARRATT HOMES, BOVIS HOMES TAYLOR WIMPEY				
DRAWING NUMBER: 20488_02_166				
REVISION: -	SHEET SIZE: A1	DATE: 04.10.13		
DRAWN BY: MJK	CHECKED BY: EM	SCALE: AS SHOWN		