



- NOTES
1. All dimensions in millimetres and all levels in metres unless shown otherwise.
  2. Any proposed changes to the water networks to be checked for clashes with sewerage.
  3. Ground contamination present throughout site – All Mains and Service pipes to be GPS Protecta-Line PE80 (up to and including 63mm BP) and PE100 (90mm BP and above) manufactured in accordance with WIS 4-32-19.
  4. All pipes to be laid in accordance with WRc Self-Laying of Water Mains and Services A Code of Practice for England and Wales 2nd Edition and Water Network Design issued 1st October 2013 from Albion including marker tape.
  5. Minimum trench width to be 550mm. Type A granular bed and surround well compacted – Type 'A' granular bed and surround to pipes shall be uncrushed gravel, or crushed stone or crushed gravel, the grading of which complies with table 4 of B.S. 882 for nominal size of single sized aggregates. When tested in accordance with B.S.812, the 10% fines value shall not be less than 50kn and for that portion of a sample retained on a 6mm sieve the index of flakiness shall not exceed 45%. Material grading to be 10mm nominal size of single sized aggregates.
  6. Pipes to be tested in accordance with IGN4-01-03 TO 4.5BAR.
  7. Trees to be confirmed – Types and proximity to water mains.
  8. Water mains & supply pipes to be laid at depth as recommended in NJUG Publication Number 7.

LEGEND WATER SUPPLY

EXISTING WATER MAIN - BLUE MDPE

NEW POTABLE WATER MAIN - BLUE MDPE

NEW POTABLE WATER SERVICE SINGLE METER

NEW POTABLE WATER SERVICE WITHIN DUCT

DIAMETER CHANGE

NEW POTABLE WATER SLUICE VALVE

NEW POTABLE WATER WASHOUT

NEW POTABLE WATER AIRVALVE

NEW POTABLE WATER FIRE HYDRANT

PROPOSED TREES

EXISTING TREES

REV	DATE	DESCRIPTION
B2	23/07/14	REVISED 32mm SERVICE CONNECTION LOCATIONS
B1	25/04/14	REVISED MAINS PIPE SIZES & ADDED FIRE HYDRANT REFERENCES
A	07/02/14	FIRST ISSUE

CLIENT



Unit 9 Cirencester Office Park, Tetbury Road,  
Cirencester, Gloucestershire, GL7 6JJ



Waterco Ltd.  
Eden Court, Ruthin LL15 1NJ

01824 702220 fax 705244  
www.waterco.co.uk

SCHEME

UPPER HEYFORD, OXFORD

TITLE

WATER SUPPLY  
SHEET 6 OF 6

STATUS

APPROVAL

DRAWN	CHECKED	APPROVED	SCALE
DRD	RMW	TM	1:500 @ A1

DRAWING NO.	REV
w4028-d06	B2

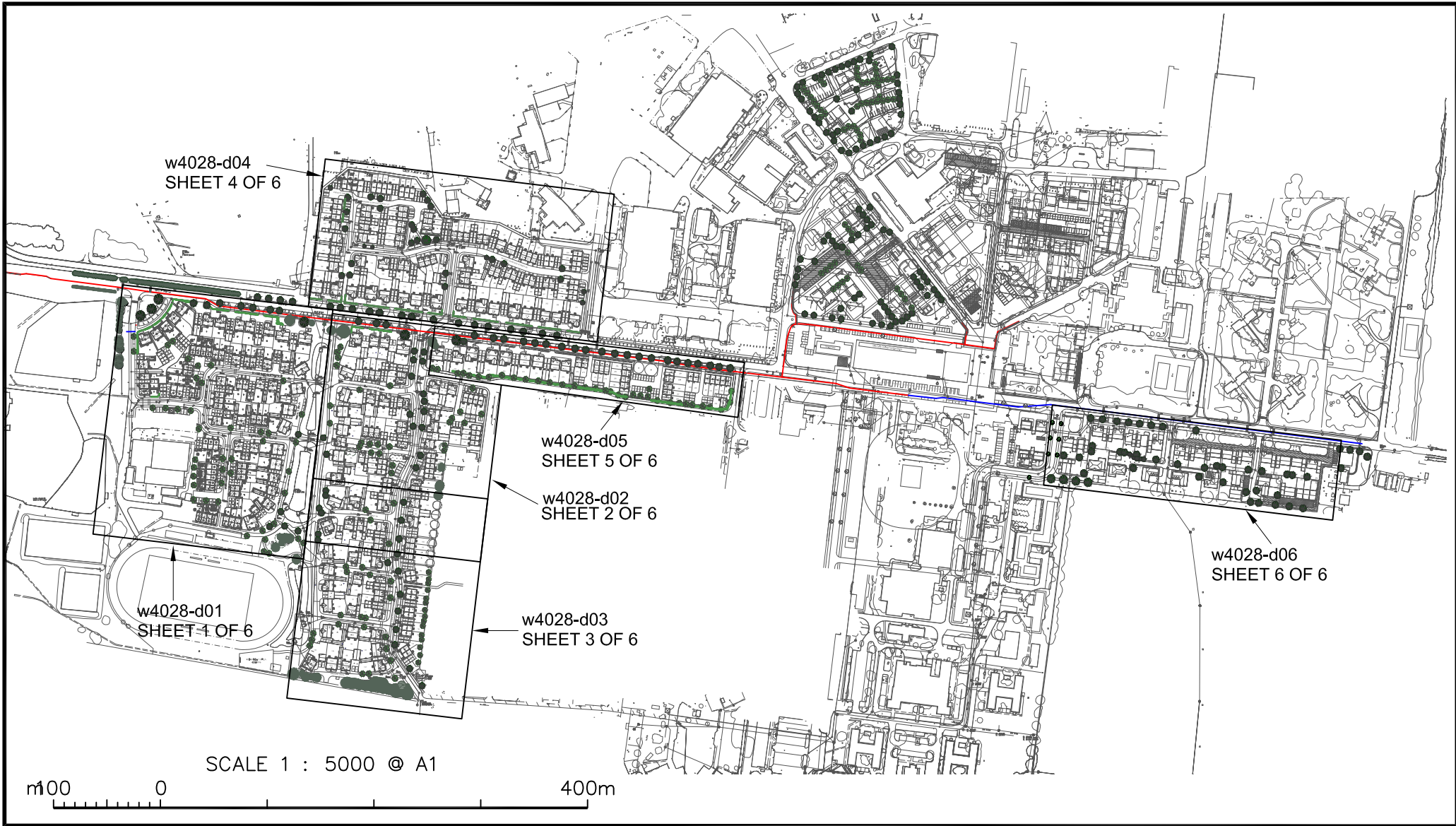

Reproduced from OS Master Map 1:2500 scale by permission of Ordnance Survey on behalf of The Controller of Her Majesty's Stationary Office. © Crown copyright. All rights reserved. Licence number 100043718.