

OXFORDSHIRE COUNTY COUNCIL STREET LIGHTING SPECIFICATIONS

Column 5m tubular steel column (BS EN 40) B09407 (Style 4 drg HSD/13015) suitable for entry mounted lantern. Rationalised wind loading factor for Oxfordshire as specified in PD0547/2009 for design of lighting columns

Lantern Holograph Factor LED Lantern Ref: FTFL034NRAL6013TSZ - Green RAL 6013
Lamp LED c 3000m with 4000K colour temperature
Control One piece mini photocell (Zodion) set at 55 Lux on 28 lux off

Column finish EPA Compliant Epoxy / Polysiloxane Amended Oxfordshire County Council Specification

1st Coat: Internal root to 250mm above ground level & External overall
 Item 121, Decrylate 2 Pack Extended Cure Epoxy MIO, ref 90-270, Airless Spray, Minimum Dry Film Thickness 100 microns.
 2nd Coat: External root to 250mm above ground level
 Decrylate Epoxide 2 Glass Reinforced 2 Pack Epoxy, ref 79-489, Brush/Airless Spray, Minimum Dry Film Thickness 200 microns.
 3rd Coat: External overall
 Decrylate Dacsil 200 2-Pack Polysiloxane Finish RAL 6013 (or other specified colour), 200-line, Conventional Spray, Minimum Dry Film Thickness 75 microns.

- Additional notes:**
- Columns to be sited at the rear of footpath and within adoptable area.
 - Positions are approximate. The Local Authority Engineer reserves the right to alter positions depending on site conditions.
 - All equipment shall comply with the Oxfordshire County Council General Technical Specification.
 - The Contractor shall obtain samples of the paint and technical Data Sheets from the Manufacturers prior to commencement of work.
 - In order to assist the developer, the design Engineer will mark out all of the column positions.
 - All Street Lighting works must be carried out by Highway Electrical Association Registered Contractor.
 - All columns to be numbered two metres from ground level.
 - Electrical Supply to Street Lighting Columns and Illuminated Signs are to be serviced/owned by the local Distribution Network Operator (i.e. Regional Electricity Company).
 - The 'A' file reference number which is on the drawing, is to be quoted in all correspondence.
 - No trees are to be planted within five metres of a column.

NB Touch up on site using 2 Pack paints applied by brush will never offer the same appearance as that of a spray applied finish. For this reason every effort should be made to minimize handling / transportation damage.

Street Lighting to be adopted by OXFORDSHIRE COUNTY COUNCIL

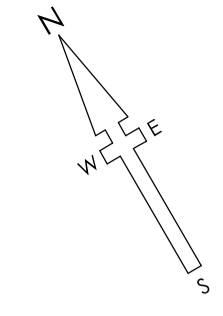

KERBING KEY

HB2	- 125x255 HB2 kerb (125mm face)
BN	- 125x150 BN15 dropped (15mm face)
DK 0	- 125x150 BN15 dropped (0mm face)
EF	- 50x150 EF edging laid flush
T	- Dropper/Transition kerb as required
CS	- square edged channel block
BJ	- Blocks Butt Jointed together
mb	- Highway marker block
TB	- Timber Bollard (OCC Approved)
GS	- Circle of Granite Sets

[Pattern]	Permeable Charcon Andover Stratford Infiltra Colour - Silver Grey (refer to drg 11-1196-20 - Detail B)
[Pattern]	Permeable Charcon Woburn Rumble Infiltra Colour - Rustic (refer to drg 11-1196-20 - Detail B)
[Pattern]	Permeable Charcon Andover Stratford Infiltra Colour - Charcoal (refer to drg 11-1196-20 - Detail B)
[Pattern]	Permeable Charcon Infiltra Colour - Grey (refer to drg 11-1196-21 - Detail A)
[Pattern]	Permeable Charcon Infiltra Colour - Burnt Oker (refer to drg 11-1196-21 - Detail A)
[Pattern]	Impermeable Charcon Woburn Rumble Colour - Graphite (refer to drg 11-1196-21 - Detail B)
[Pattern]	Impermeable Mastertint surfacing (with contrasting inset colour where noted on plans) (refer to drg 11-1196-20 - Detail A)
[Pattern]	Soft landscaping (refer to Hyder drawings)
[Pattern]	Ecodeck (refer to detail on drg 11-1196-20)
[Pattern]	Granite Sets (refer to detail on drg 11-1196-20)
[Pattern]	Impermeable Blocks to be used within designated areas
[Pattern]	Proposed Service Margin
[Symbol]	Brass stud or equivalent to denote the edge of the service margin
[Line]	Proposed Limit of O.C.C. Section 38 adoption To be agreed
[Line]	Limit of Phase 1 works - Refer to Hyder drawings for details of Spine Road
[Symbol]	Sureset Recycled Glass 6mm Aggregate set within granite sets sunk into ground Colour A=Wild Lavender, Colour B=Pacific (refer to detail on drg 11-1196-20)
[Symbol]	Timber Bollard with reflective strip (OCC approved)
[Line]	Extent of concrete wall to service trench
[Line]	Drainage channel

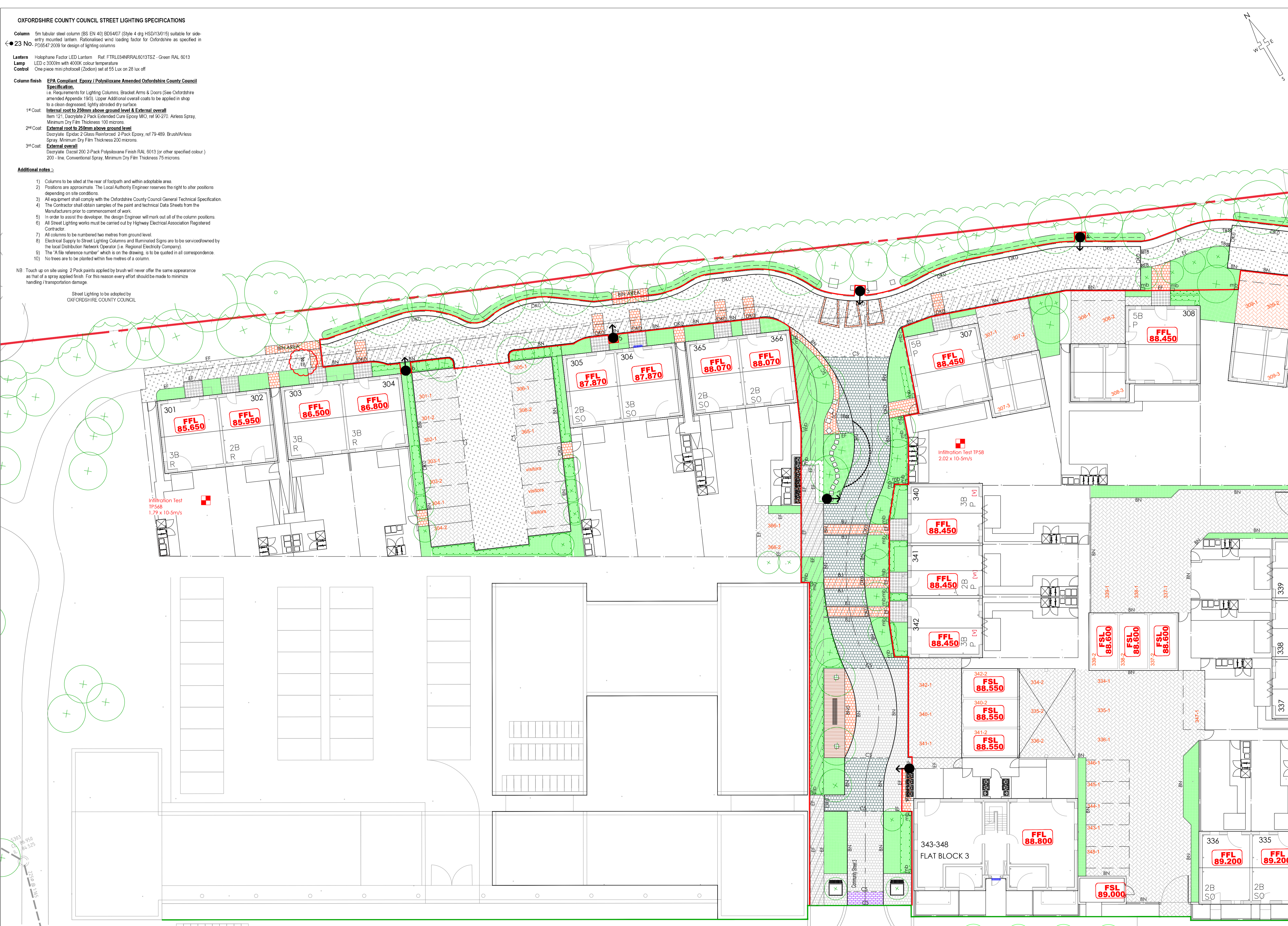

OCC Lighting Ref: A 4 2 3 6
 To be read in conjunction with drg 12-1196-07 Com 3

WILLMOTT DIXON HOUSING

REVIEWED

PRELIMINARY	STATUS
FOR COMMENT	A
FOR CONSTRUCTION	B
SIGNED	ND
DATE	10.11.14

Surface Finishes and Kerb Types
 Sheet 1 of 4
 Bicester Southfields Eco Village
 Bicester
 Oxon

DRAWING NUMBER
 12-1196-04 Sheet 1 of 4 Rev C02



Rev	Drawn by	Chkd by	Comments	Date
P7	NJ	TST	Amended in accordance with Willmott Dixon Housing amendments (June 2014)	20/06/14
P8	NJ	TST	Amended in accordance with Willmott Dixon Housing amendments (July 2014)	21/07/14
CO1	NJ	TST	Issued for construction	23/09/14
CO2	NJ	TST	Bollard added as shown to prevent vehicles accessing footway	03/11/14

- NOTES**
- All dimensions and levels are in metres unless otherwise noted
 - This drawing is to be read in conjunction with the relevant Architects/Engineers drawings, specifications and CDM documentation
 - This drawings has been produced electronically and may have been photo reduced or enlarged when copied. Work to figured dimensions only (DO NOT SCALE). All dimensions to be checked on site. Any errors or omissions to be reported to the engineer immediately.
 - This drawing contains coloured lines / information that may not be clear if reproduced in black and white.

Note
 Lighting Column Installation
 All columns must be installed within 1 metre of the design position on the lighting layout drawing, otherwise the lighting performance will be impaired.

Landscaping and Planting
 Landscaping or planting around the column must be kept at a low level to avoid obstructing the luminaire and must be suitably maintained to avoid any future obstruction that may occur from the long term growth of plants. No account is taken for the blocking effect caused by buildings, trees etc.

DATE
 10/01/2013

DESIGNED BY
 TST

SCALE
 1:200 @ A1

STATUS
CONSTRUCTION

0m 5m 10m
 scale bar @ 1:200

INFRASTRUCT CS LTD
 Consulting Civil and Structural Engineers

26A High Street, Eynsham, Oxford, OX29 4HB
 Tel: 01865 880909
 Email: info@infrastructurecs.co.uk
 Web: www.infrastructurecs.co.uk