

DETAIL A
 PERMEABLE BLOCK PAVING MAX FALL 1:150
 (DEPTH OF SUB BASE DETERMINED BY TRAFFIC LOADING)
 SCALE 1:20

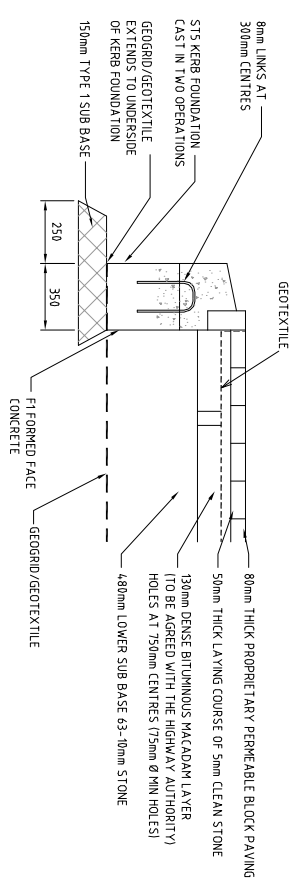

DETAIL B
 PERMEABLE BLOCK PAVING MAX FALL 1:20
 (DEPTH OF SUB BASE DETERMINED BY ATTENUATION VOLUME)
 SCALE 1:20

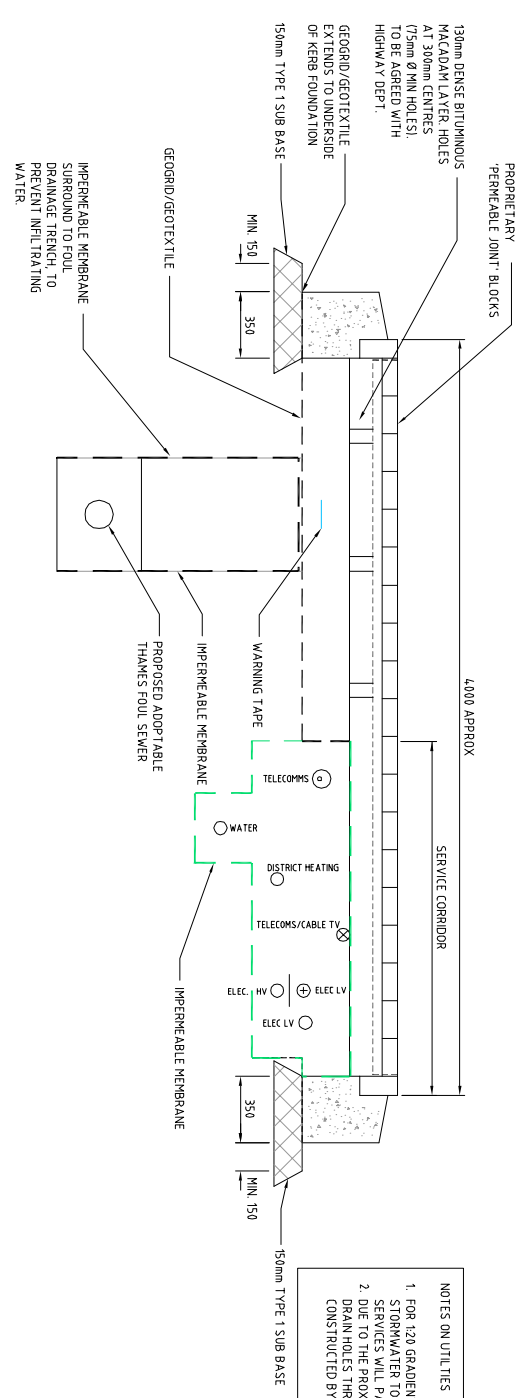

PERMEABLE BLOCK PAVEMENT
 SCALE 1:20

- NOTES ON UTILITIES
- FOR 1:20 GRADE/INT ROAD SERVICE CORRIDORS, SERVICE CORRIDORS SHALL BE CONSTRUCTED TO ALLOW FOR INFILTRATION TO OCCUR. ALL SERVICES SHALL PASS THROUGH THESE WALLS.
 - DUE TO THE PROXIMITY OF SERVICES WITHIN THE SERVICE CORRIDOR, DRAIN HOLES THROUGH THE BITUMEN LAYER WILL NEED TO BE CONSTRUCTED BY CORING AND NOT BY PUNCTURING.

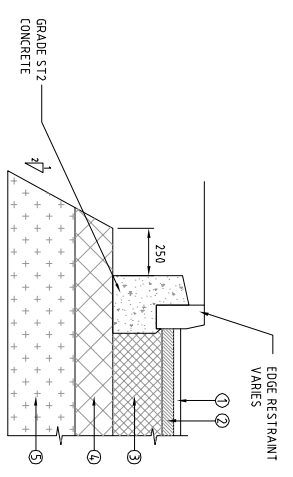

MASTERTINT ROAD
 CONSTRUCTION
 SCALE 1:20

	(PAVEMENT SPECIFICATION)	SPEIN ROAD SPECIFICATION
1	SUBPAVE COURSE	30
2	BINDER COURSE	60
3	BASE COURSE	150 (min)
4	SUB BASE	SUBJECT TO GR
5	CAPPING	SUBJECT TO GR

NOTE: TYPICAL FOAMMASTER RECYCLED ASPHALT OR SIMILAR APPROVED PRODUCT MAY BE USED.

NOTE: THE SUB-GRADE FORMATION AT MAXIMUM INTERVALS OF 100m ALONG THE CENTRELINE OF THE PROPOSED CARRIAGEWAY.

NOTE: THE SUB-GRADE FORMATION AT MAXIMUM INTERVALS OF 100m ALONG THE CENTRELINE OF THE PROPOSED CARRIAGEWAY.

NOTE: THE SUB-GRADE FORMATION AT MAXIMUM INTERVALS OF 100m ALONG THE CENTRELINE OF THE PROPOSED CARRIAGEWAY.

	BELOW 5%	5% & ABOVE
300mm SUB BASE PLUS GEO TEXTILE PROBRANE AND 400mm CAPPING LAYER		300mm

NOTE: FOR DETAILS OF SPEED TABLES, COMMUNITY STREET AND GATEWAY FEATURE REFER TO DRAWINGS UA001881 / 701-209 TO 701-228

<p>Hyder Consulting (UK) Limited 29, Bressenden Place London SW1E 5DUZ Tel: +44 (0)870 000 3006 Fax: +44 (0)870 000 3906</p>	
Project: BICESTER ECO DEVELOPMENT EXEMPLAR SITE Title: COMMUNITY STREETS CONSTRUCTION DETAILS SHEET 1 OF 2	Drawing No: 7279 Project No: UA001881 Issue: 02
Status: DRAFT Issue Description: 02 SERVICE ZONE REVISED Date: 27-07-12	Author: P. SWINNEY Checker: HYRELASSON Approver: S. ADAMS Scale: 1:20 Original Size: A1 Height: 0.5 Grid: 0.5