

- NOTES**
1. COLUMNS TO BE SITED AT THE REAR OF FOOTPATH OR LOCATION AS INDICATED ON PLAN
  2. POSITIONS ARE APPROXIMATE. THE LOCAL AUTHORITY ENGINEER RESERVES THE RIGHT TO ALTER POSITIONS DEPENDING ON SITE CONDITIONS
  3. ALL EQUIPMENT SHALL COMPLY WITH THE TECHNICAL SPECIFICATION
  4. THE CONTRACTOR SHALL OBTAIN SAMPLES OF THE PAINT AND TECHNICAL DATA SHEETS / SUPPORT FROM THE MANUFACTURERS PRIOR TO COMMENCEMENT OF WORK
  5. IN ORDER TO ASSIST THE DEVELOPER, SL DESIGNER OR DEVELOPER TO MARK ALL COLUMNS
  6. ALL STREET LIGHTING WORKS MUST BE CARRIED OUT BY A HIGHWAY ELECTRICAL ASSOCIATION CONTRACTORS TO BE NUMBERED 2m FROM
  7. ALL COLUMNS TO BE NUMBERED 2m FROM
  8. ELECTRICAL SUPPLY TO STREET LIGHTING COLUMNS AND ILLUMINATED SIGNS ARE TO BE SERVICED/OWNED BY THE LOCAL DISTRIBUTION NETWORK OPERATOR (IE REGIONAL ELECTRICITY COMPANY)
  9. NO TREES ARE TO BE PLANTED WITHIN 5m FROM A COLUMN POSITION

**MATCHLINE**  
 FOR CONTINUATION  
 SEE DWG 7263

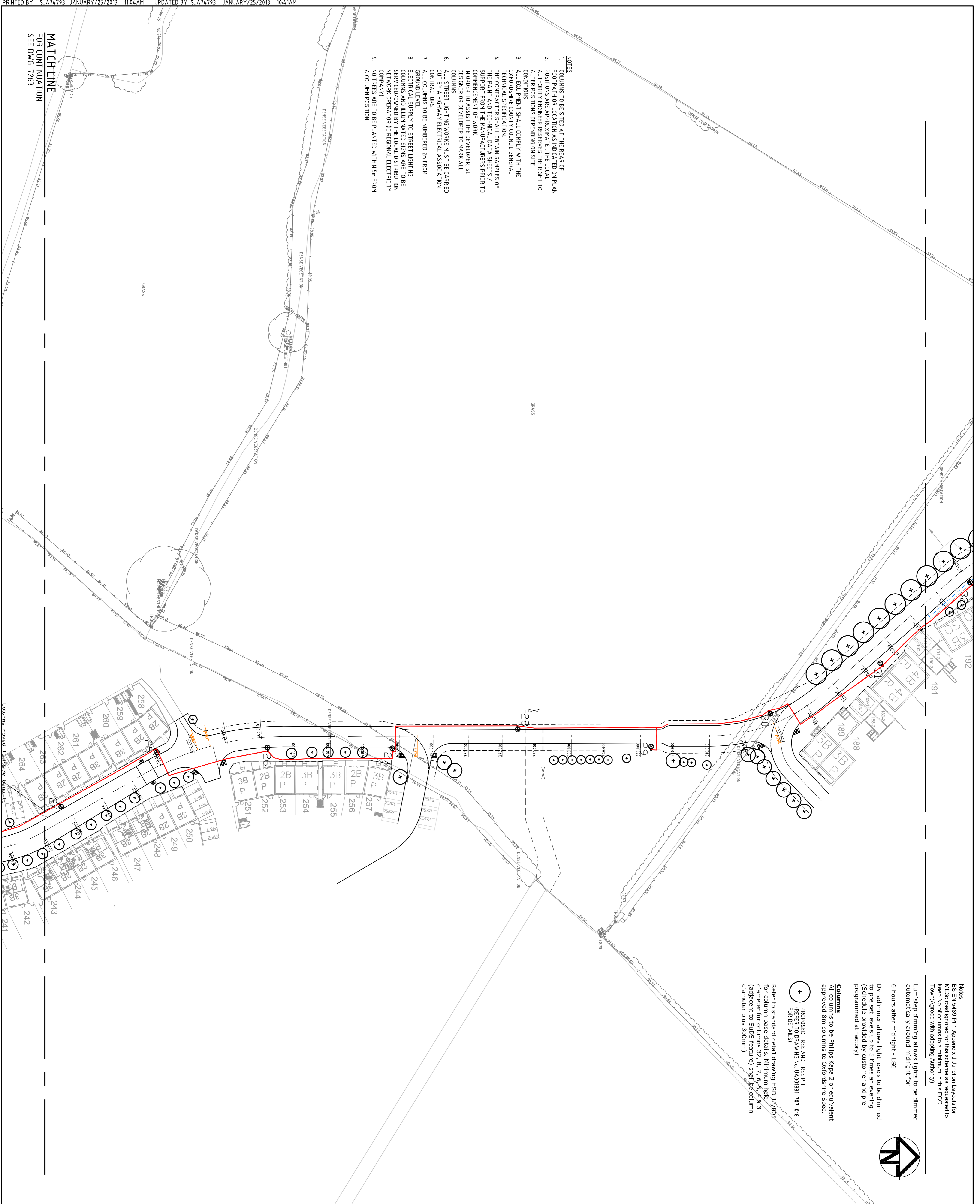

**Notes:**  
 BS EN 5489 Pt 1 Appendix J Junction Layouts for MSc: road ignored for this scheme as requested to keep No of columns to a minimum in this ECO Town/Agreed with adopting Authority)  
 Luminaire dimming allows lights to be dimmed automatically around midnight for 6 hours after midnight - L36  
 Dynamidmer allows light levels to be dimmed to pre set levels up to 3 times an evening (Schedule provided by customer and pre programmed at factory)  
**Columns**  
 All columns to be Phillips Kapa 2 or equivalent approved 8m columns to Oxfordshire Spec.  
 + PROPOSED TREE AND TREE PIT REFER TO DRAWING No. UA001881-707-018 FOR DETAILS  
 Refer to standard detail drawing HSD 13/005 for column base details. Minimum hole diameter for columns 32, 8, 7, 6, 5, 4 & 3 (adjacent to SUDS features) shall be column diameter plus 300mm)

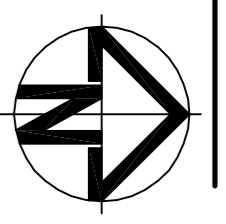

**KEY**

- ⊕ Iridium 2 BGP353 - 114w (Total System) Wattage/LED luminaire with DM optic, Dail dimmable electronic driver 12,688 lm, 4000K Neutral white with one piece electronic mini photocell (Zodion SS12X11) set at 55 lux on 28 lux off.
- ⊕ Luminaire installed 8m (Oxfordshire spec) column, Post top mounted at 5 deg tilt
- Ref: Iridium 2 BGP353 1XGRN127-25/740 D9 DW P3 (SS12A)-RAL 6013 (Dimmable driver allows for future dimming either stand alone Lumisstep or Dynamidmer or remote Stansense 2. Remove D9 ref if no dimming required)
- ⊕ Iridium 2 BGP353 - 114w (Total System) Wattage/LED luminaire with DM optic, Dail dimmable electronic driver 12,688 lm, 4000K Neutral white with one piece electronic mini photocell (Zodion SS12X11) set at 55 lux on 28 lux off.
- ⊕ Luminaire installed 8m (Oxfordshire spec) column, Luminaire side entry mounted on 1.5m 5 tile deg bracket.
- Ref: Iridium 2 BGP353 1XGRN127-25/740 D9 DW P3 (SS12A)-RAL 6013 (Dimmable driver allows for future dimming either stand alone Lumisstep or Dynamidmer or remote Stansense 2. Remove D9 ref if no dimming required)
- ⊕ Iridium 2 BGP353 1XECO127-25/740 D9 DW P3 (SS12A)-RAL 6013 (Dimmable driver allows for future dimming either stand alone Lumisstep or Dynamidmer or remote Stansense 2. Remove D9 ref if no dimming required)
- ⊕ Iridium 2 BGP353 - 114w (Total System) Wattage/LED luminaire with DM optic, Dail dimmable electronic driver 12,688 lm, 4000K Neutral white with one piece electronic mini photocell (Zodion SS12X11) set at 55 lux on 28 lux off.
- ⊕ Luminaire installed on Phillips Flange Plate type Kapa 2 8m column to Oxfordshire spec; Post top mounted at 5 deg tilt
- Ref: Iridium 2 BGP353 1XECO127-25/740 D9 DW P3 (SS12A)-RAL 6013 (Dimmable driver allows for future dimming either stand alone Lumisstep or Dynamidmer or remote Stansense 2. Remove D9 ref if no dimming required)

Issue	Description	Date
05	STREET LIGHTING LAYOUT & NOTES REVISED	25/01/13
04	TREES ADDED	04/12/12
03	HIGHWAY BOUNDARY REVISED	06/11/12
02	STREET LIGHTING LAYOUT REVISED	26/10/12
01	FIRST ISSUE	APR 11

**Status**  
**DRAFT**

Original Size	Author
A1	SLONES
Height Datum	GREYNER S.ADVANCES
Grid	APPROVER S.ADVANCES
	© Copyright reserved

Client  
 Filenaming: 7261-7264-UA001881-UP21D-538-05-STREET LIGHTING.DWG



Hyder Consulting (UK) Limited  
 29, Bessenden Place  
 London  
 SW1E 6DZ  
 Tel: +44 (0)870 000 3006  
 Fax: +44 (0)870 000 3006

Project  
**BICSTER ECO DEVELOPMENT EXEMPLAR SITE**

Title  
**EXEMPLAR SITE (S38) STREET LIGHTING**

Drawing No. **7262** Project No. **UA001881** Issue **05**  
 SHEET 2 OF 4