

- NOTES**
1. COLUMNS TO BE SITED AT THE REAR OF FOOTPATH OR LOCATION AS INDICATED ON PLAN
 2. POSITIONS ARE APPROXIMATE. THE LOCAL AUTHORITY ENGINEER RESERVES THE RIGHT TO ALTER POSITIONS DEPENDING ON SITE CONDITIONS
 3. ALL EQUIPMENT SHALL COMPLY WITH THE OXFORDSHIRE COUNTY COUNCIL GENERAL TECHNICAL SPECIFICATION
 4. THE CONTRACTOR SHALL OBTAIN SAMPLES OF SOIL FROM TECHNICAL DATA SHEETS OF SITE FROM THE MAIN CONTRACTORS PRIOR TO COMMENCEMENT OF WORK
 5. IN ORDER TO ASSIST THE DEVELOPER, SL DESIGNER OR DEVELOPER TO MARK ALL COLUMNS
 6. ALL STREET LIGHTING WORKS MUST BE CARRIED OUT BY A HIGHWAY ELECTRICAL ASSOCIATION CONTRACTORS
 7. ALL COLUMNS TO BE NUMBERED 2m FROM GROUND LEVEL
 8. ELECTRICAL SUPPLY TO STREET LIGHTING BE SERVICES AND CABLED TO THE MAINS NETWORK OPERATOR (IE REGIONAL ELECTRICITY COMPANY) NO TREES ARE TO BE PLANTED WITHIN 5m FROM A COLUMN POSITION

MATCH LINE
 FOR CONTINUATION
 SEE DWG 7264

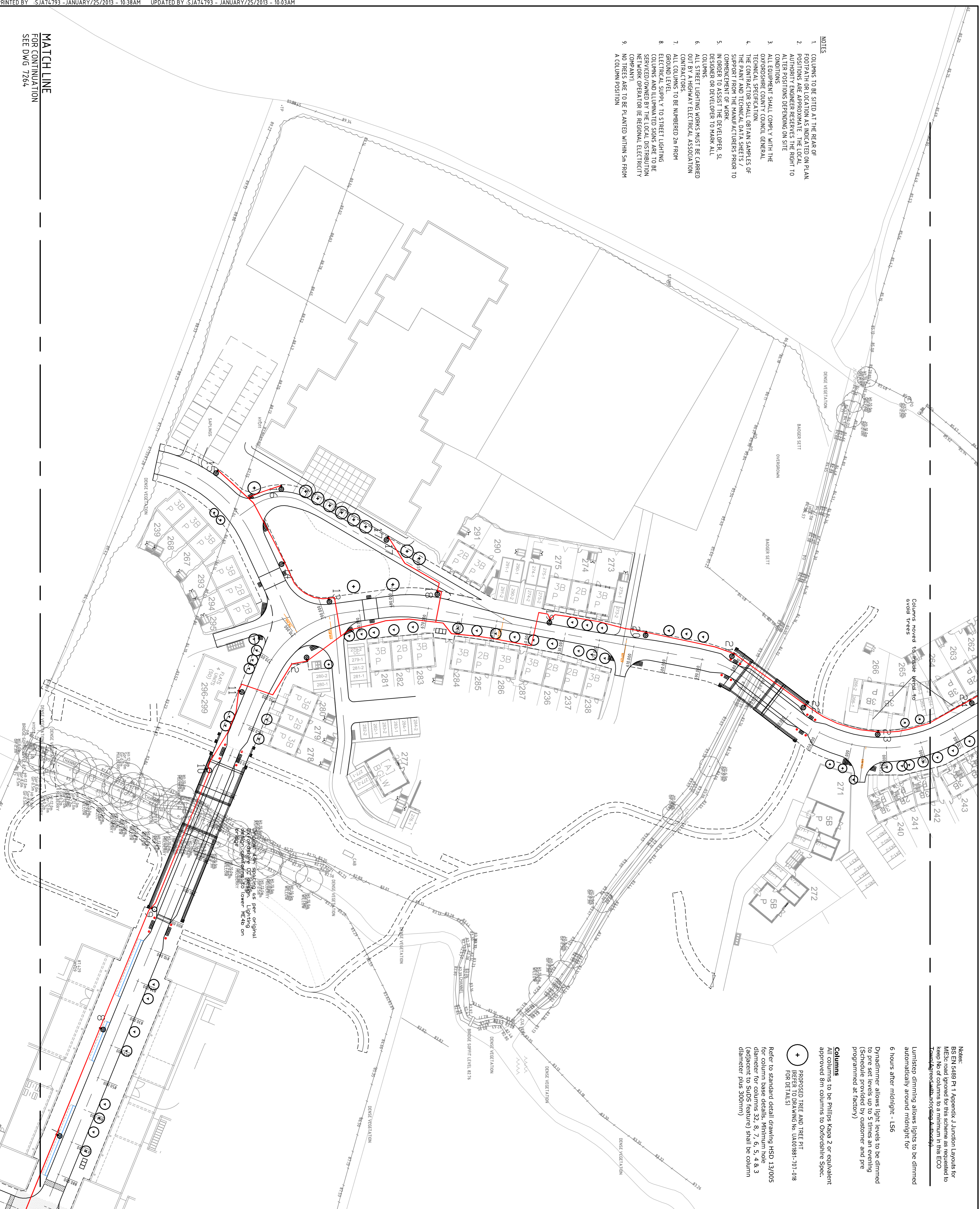

Columns moved to inside verge to avoid trees

Notes:
 BS EN 5489 Pt 1 Appendix J Junction Layouts for MESC road ignored for this scheme as requested to keep No of columns to a minimum in this ECO
<http://www.bsigroup.com/products/bsi-standards>
 Lumistep dimming allows lights to be dimmed automatically around midlight for 6 hours after midlight - L56
 Dynadimmer allows light levels to be dimmed to pre set levels up to 5 times an evening (Schedule provided by customer and pre programmed at factory)
Columns
 All columns to be Phillips Kana 2 or equivalent approved 8m columns to Oxfordshire Spec.
 PROPOSED TREE AND TREE PIT (REFER TO DRAWING No UA001881-701-018 FOR DETAILS)
 Refer to standard detail drawing HSD 13/005 for column base details. Minimum hole diameter for columns 32, 8, 7, 6, 5, 4 & 3 (adjacent to SUDS feature) shall be column diameter plus 300mm)

KEY
 Iridium 2 BGP353 - 114w (Total System)
 Wattage/LED luminaire with DM optic. Dail dimmable electronic driver 12,688 lm, 4000K Neutral white with one piece electronic mini photocell (Zodion SS12X11) set at 55 lux on 28 lux off.
 Luminaire installed 8m (Oxfordshire spec) column, Post top mounted at 5 deg tilt
 Ref: Iridium 2 BGP353 1XGRN127-25/740 D9 D9 P3 (SS12A)-RAL 6013
 Other: Stand alone Lumistep or Dynadimmer or remote Stansense 2. Remove D9 ref if no dimming required)
 Iridium 2 BGP353 - 114w (Total System)
 Wattage/LED luminaire with DM optic. Dail dimmable electronic driver 12,688 lm, 4000K Neutral white with one piece electronic mini photocell (Zodion SS12X11) set at 55 lux on 28 lux off.
 Luminaire installed 8m (Oxfordshire spec) column, Luminaire side entry mounted on 1.5m 5 tile deg bracket.
 Ref: Iridium 2 BGP353 1XGRN127-25/740 D9 DM P3 (SS12A)-RAL 6013
 Dimmable driver allows for future dimming either stand alone Lumistep or Dynadimmer or remote Stansense 2. Remove D9 ref if no dimming required)
 Wattage/LED luminaire with DM optic. Dail dimmable electronic driver 12,688 lm, 4000K Neutral white with one piece electronic mini photocell (Zodion SS12X11) set at 55 lux on 28 lux off.
 Luminaire installed on Phillips Flange Haze type Kana 2 8m column to Oxfordshire spec; Post top mounted at 5 deg tilt
 Ref: Iridium 2 BGP353 1XECO127-25/740 D9 DW P3 (SS12A)-RAL 6013
 Dimmable driver allows for future dimming either stand alone Lumistep or Dynadimmer or remote Stansense 2. Remove D9 ref if no dimming required)
 Iridium 2 BGP353 - 114w (Total System)
 Wattage/LED luminaire with DM optic. Dail dimmable electronic driver 12,688 lm, 4000K Neutral white with one piece electronic mini photocell (Zodion SS12X11) set at 55 lux on 28 lux off.
 Luminaire installed 8m (Oxfordshire spec) column, Post top mounted at 5 deg tilt
 Ref: Iridium 2 BGP353 1XGRN127-25/740 D9 DW P3 (SS12A)-RAL 6013
 Dimmable driver allows for future dimming either stand alone Lumistep or Dynadimmer or remote Stansense 2. Remove D9 ref if no dimming required)

Issue	Description	Date
05	STREET LIGHTING LAYOUT & NOTES REVISED	25/01/13
04	TREES ADDED	04/12/12
03	HIGHWAY BOUNDARY REVISED	06/11/12
02	STREET LIGHTING LAYOUT REVISED	26/10/12
01	FIRST ISSUE	APR 11

Status
DRAFT

Scale	Author
1:500	S.JONES
Original Size	GREEKER S.ADVAINES
Height	APPROVER S.ADVAINES
Datum	© Copyright reserved
Grid	O.S.

Client
 Flenshaw/261-7264-UA001881-UP21D-S38-05-STREET LIGHTING.DWG

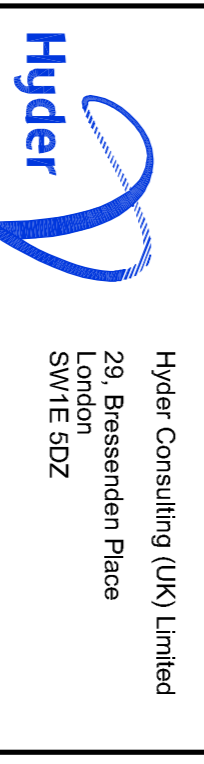

Hyder
 29 Bressenden Place
 London SW1E 8DZ
 Tel: +44 (0)870 000 3906
 Fax: +44 (0)870 000 3906

Project
BICESTER ECO DEVELOPMENT EXEMPLAR SITE

Title
EXEMPLAR SITE (S38) STREET LIGHTING
 SHEET 3 OF 4

Drawing No: 7263
 Project No: UA001881
 Issue: 05