

KEY

- Existing tree and hedge
- Proposed tree
- Proposed hedge
- Amenity grass - Emorsgate EG22 Lawn Mixture - refer to schedule UA001881-701-1103
- Planting area
- EM6 Meadow mix for chalk and limestone soils (Perimeter planting) refer to schedule UA001881-701-1103.
- EH1 Hedgerow mix (shade tolerant) refer to schedule UA001881-701-1103.
- Proposed tree grille - refer to drg no. UA001881-701-800
- Proposed tree pit. Root barrier = blue line. Refer to drg no. UA001881-701-800/801
- Green Roofs - refer to drg no. UA001881-701-933
- SUDS - refer to drg no. UA001881-701-911
- Exemplar boundary line
- Adoption boundary line
- Perimeter planting extents
- Light column

Planting Plan 7 - Species List

Plant type	Common name	Reference
Edible shrubs		
Crataegus monogyna	Hawthorn	CRA MON
Non-edible shrubs		
Cornus sanguinea	Dogwood	COR SAN
Potentilla fruticosa	Potentilla	POT FRU
Herbs		
Lavendula augustifolia	Lavender	LAV AUG
Ground Cover		
Bergenia cordifolia	Bergenia	BER COR
Ajuga reptans	Blue bugle	AJU REP

Tree Species*	Common name	Reference
Acer campestre 'Streetwise'	Field Maple 'Streetwise'	ACE CAM
Sorbus aria	Common Whitebeam	SOR ARI

*Where a tree species is specified in both standard and extra heavy standard size, an affix of 'S' denotes standard size

For detailed Plant Schedule, refer to:
 UA001881-701-1102 Infrastructure Planting Schedule
 UA001881-701-1103 Phase 1 Planting Schedule
 For Topsoiling plans, refer to: UA001881-701-114 to 116
 Tree locations and planting areas layout by ICS.
 Root barrier & tree pits - locations to be checked on site in line with drawings UA001881-701-800/801

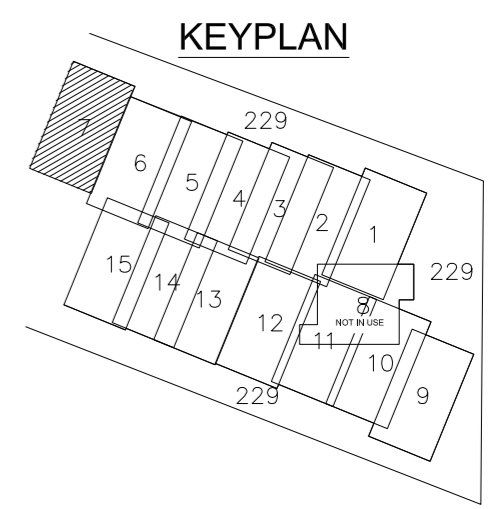

05	Planting revised to align with scheme revisions & revisions to root barriers	21-10-15
04	'DRAFT' removed, tree pits added, note added, key revised	29-08-14
03	Drawing updated to GIS layout and WDH comments	14-05-14
02	General Amendments. Issue for planning condition discharge	21-12-12
V	Initial Draft	31-08-12
Issue Description		Date
Status: PLANNING		
Scales: 1:100 @ A1		Current Issue Signatures
Original Size: A1		Author: A.VICTORY
Height Datum: O.S.		Checker: A.VICTORY
Grid: O.S.		Approver: A.ZORLUTUN
© Copyright reserved		



Hyder HYDER CONSULTING (UK) Limited
 5th Floor, The Pithay
 All Saints Street
 Bristol, England
 BS1 2NL
 Tel: +44 (0)870 000 3003
 Fax: +44 (0)870 000 3903

Project: **Bicester Eco Development**

Title: **Planting Plan 7 - Phase 1**

Drawing No. | Project No. | Issue
 701-911 | UA001881 | 05

MATCH LINE FOR CONTINUATION SEE DWG01-921 River Corridor Planting Plan

MATCH LINE FOR CONTINUATION SEE DWG01-910

