

**KEY**

- Existing: Existing tree and hedge
- Proposed: Proposed tree, Proposed hedge
- Materials: Amently grass - Emorsgate EG22 Lawn Mixture - refer to schedule UA001881-701-1103
- Planting area: EM6 Meadow mix for chalk and limestone soils (Perimeter planting) refer to schedule UA001881-701-1103, E.H1 Hedgerow mix (shade tolerant) refer to schedule UA001881-701-1103.
- Proposed tree grille - refer to drg no. UA001881-701-800
- Proposed tree pit, Root barrier = blue line. Refer to drg no. UA001881-701-800/801
- Green Roofs - refer to drg no. UA001881-701-933
- SUDS - refer to drg no. UA001881-701-811
- Exemplar boundary line
- Adoption boundary line
- Perimeter planting extents
- Light column

**Planting Plan 14 - Species List**

Plant type	Common name	Reference
<b>Non edible Shrubs</b>		
Cornus sanguinea	Dogwood	COR SAN
Mahonia nervosa	Dwarf Oregon grape	MAH NER
Carpinus betulus	Hornbeam	CAR BET hedge
<b>Herbs</b>		
Lavendula augustifolia	Lavender	LAV AUG
<b>Herbaceous/Perennial</b>		
Lamium maculatum	Spotted dead nettle	LAM MAC
<b>Ground Cover</b>		
Bergenia cordifolia	Bergenia	BER COR
Liriope muscari	Big Blue Lily turf	LIO MUS

**Planting Plan 14**

Tree Species	Common name	Reference
Carpinus betulus Fastigiata	Fastigiata Hornbeam	CAR BET FF
'Franz Fontaine'	'Franz Fontaine'	CAR BET FF

For detailed Plant Schedule, refer to:  
 UA001881-701-1102 Infrastructure Planting Schedule  
 UA001881-701-1103 Phase 1 Planting Schedule  
 For Topsoiling plans, refer to: UA001881-701-114 to 116

Tree locations and planting areas layout by ICS.  
 Root barrier & tree pits - locations to be checked on site in line with drawings UA001881-701-800/801

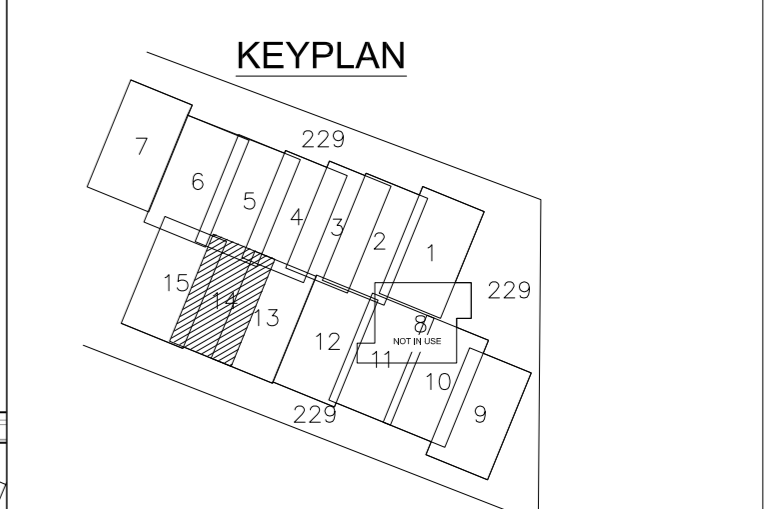

05	Planting revised to align with scheme revisions, revisions to root barriers.	21-10-15
04	'DRAFT' removed, note and tree pits added minor amends 29-08-14 Key revised	
03	Drawing updated to CIS layout and WDH comments	14-05-14
02	General Amendments. Issue for planning condition discharge	21-12-12
V	Initial Draft	31-08-12
Issue Description		Date

Status: **PLANNING**

Scale	1:100 @ A1	Current Issue Signatures	
Original Size	A1	Author	A.VICTORY
Height Datum	O.S.	Checker	A.VICTORY
Grid	O.S.	Approver	A.ZORLUTUN
© Copyright reserved			



**HYDER CONSULTING (UK) Limited**  
 5th Floor, The Pithay  
 All Saints Street  
 Bristol, England  
 BS1 2NL  
 Tel: +44 (0)870 000 3003  
 Fax: +44 (0)870 000 3903

Project: **Bicester Eco Development**

Title: **Planting Plan 14 - Phase 1**

Drawing No.	Project No.	Issue
701-918	UA001881	05

01-929

SEE DRAWING: PERIMETER PLANTING PLAN UA001881-701-929

