

**KEY**

- Existing Existing tree and hedge
- Proposed Proposed tree
- Proposed hedge
- Amenity grass - Emorsgate EG22 Lawn Mixture - refer to schedule UA001881-701-1103
- Planting area
- EM6 Meadow mix for chalk and limestone soils (Perimeter planting) refer to schedule UA001881-701-1103.
- EH1 Hedgerow mix (shade tolerant) refer to schedule UA001881-701-1103.
- Proposed tree grille - refer to drg no. UA001881-701-800
- Proposed tree pit. Refer to drg no. UA001881-701-800/801
- Green Roofs - refer to drg no. UA001880-701-933
- SUDS - refer to drg no. UA001881-701-811
- Exemplar boundary line
- Adoption boundary line
- Root Protection Barriers as per specification; located as indicated, to be min 600mm depth adjacent to boundaries, kerbs & surfaces, min 1.0m depth adjacent to buildings.
- Perimeter planting extents
- Light column

**Planting Plan 5 - Species List**

Plant type	Common name	Reference
<b>Non-edible shrub</b>		
Carpinus betulus	Hornbeam	CAR BET hedge
Corylus avellana	Hazel	COR AVE
<b>Herbs</b>		
Lavendula augustifolia	Lavender	LAV AUG
<b>Ground Cover</b>		
Berginea cordifolia	Berginea	BER COR
Liorope muscari	Big Blue Lily turf	LIO MUS

  

Tree Species*	Common name	Reference
Betula pendula	Silver Birch	BET PEN
Sorbus aria	Common Whitebeam	SOR ARI s

\*Where a tree species is specified in both standard and extra heavy standard size, an affix of 'S' denotes standard size

For detailed Plant Schedule, refer to:  
 UA001881-701-1102 Infrastructure Planting Schedule  
 UA001881-701-1103 Phase 1 Planting Schedule  
 For Topsoiling plans, refer to: UA001881-701-114 to 116

Tree locations and planting areas layout by ICS.  
 Root barrier & tree pits - locations to be checked on site in line with drawings UA001881-701-800/801

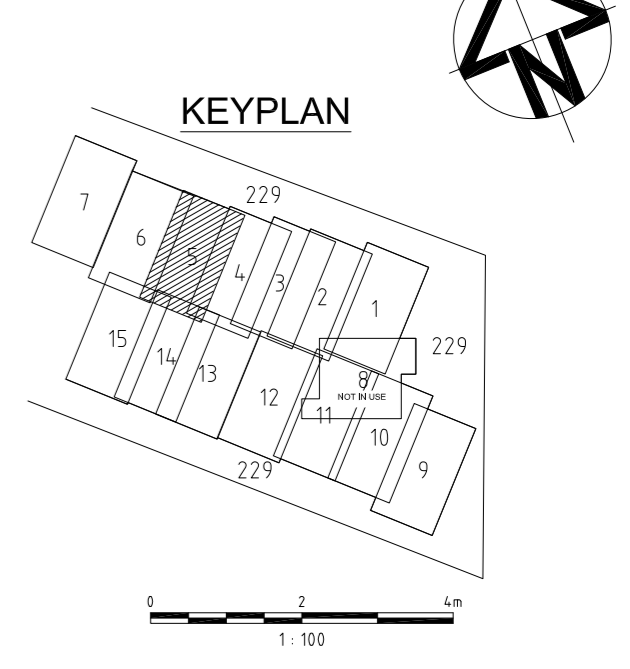

06	Planting revised following CDC comments and discussion	11-03-16
05	Planting revised to align with scheme revisions & revised root barriers	21-10-15
04	'DRAFT' removed, tree pits and note added, key revised shade tolerant hatch revised	29-08-14
03	Drawing updated to ICS layout and WDR comments	14-05-14
02	General Amendment: Issue for planning condition discharge	21-12-12
V	Initial Draft	31-08-12
Issue	Description	Date
Status	PLANNING	
Scales	1:100 @ A1	Current Issue Signatures
Original Size	A1	Author: R. BouSaleh
Height Datum	0.5	Checker: B. Pope
Grid	0.5	Approver: A.ZORLUTUNA
© Copyright reserved		

Filename: UA001881-701-900 SERIES - PLANTING PLAN (ADJUSTED) 03.08.16

Client:

HYDER CONSULTING (UK) Limited  
 5th Floor, The Pithay  
 All Saints Street  
 Bristol, England  
 BS1 2NL  
 Tel: +44 (0)870 000 3003  
 Fax: +44 (0)870 000 3903

Project: Bicester Eco Development

Title: Planting Plan 5 - Phase 1

Drawing No. 701-909 | Project No. UA001881 | Issue 06