

**notes**

- The contractor is responsible for checking dimensions, tolerances and references. Any discrepancy to be verified with the Architect before proceeding with the works.
- Where an item is covered by drawings to different scales the larger scale drawing is to be worked to.
- Do not scale drawing. Figured dimensions to be worked to in all cases.

CDM Regulations 2007

ALL current drawings and specifications for the project must be read in conjunction with the Designer's Hazard and Environmental Assessment Record.

**Notes:**  
For elevations please refer to drawing AA2699C/4.1/203

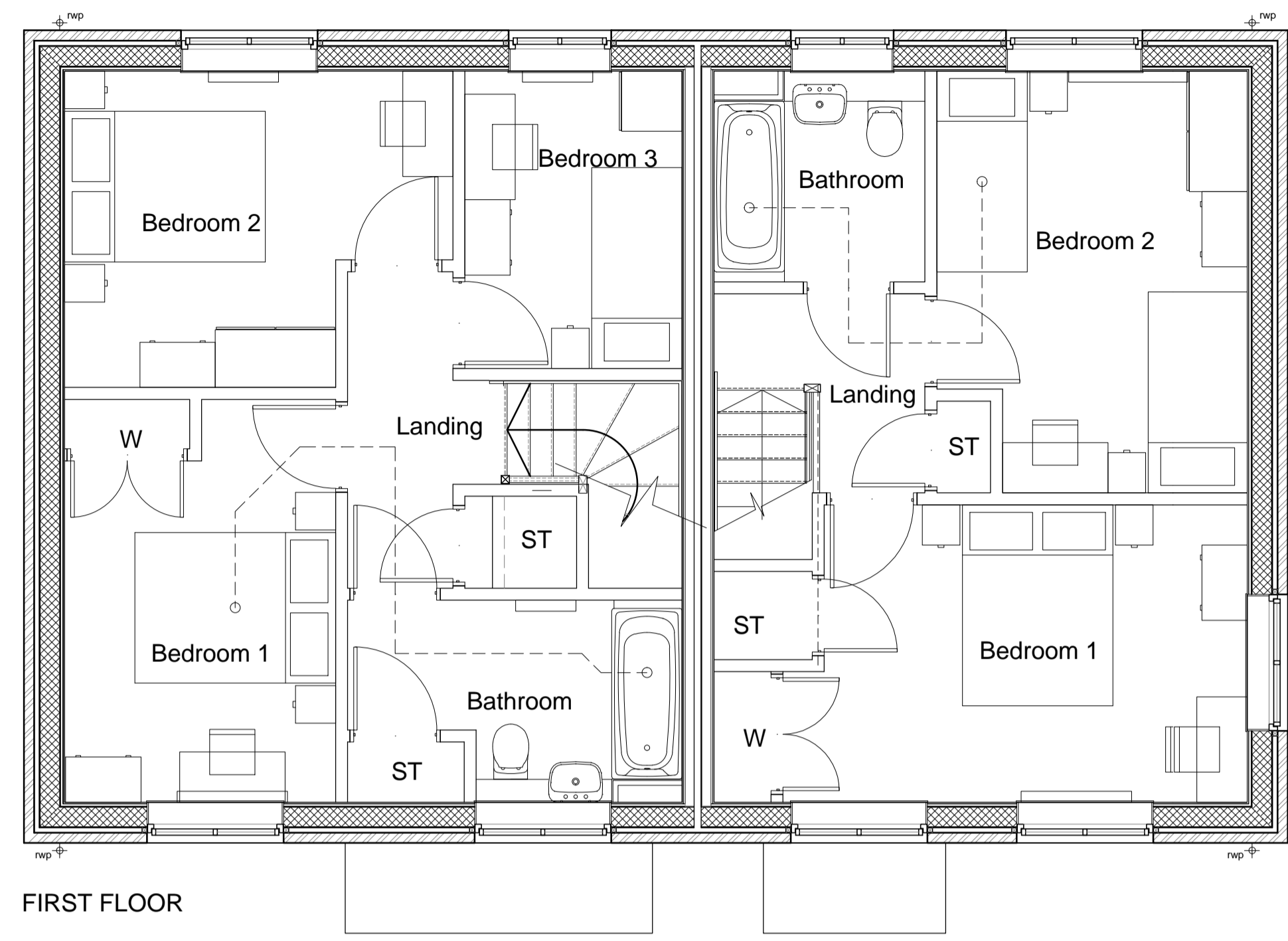
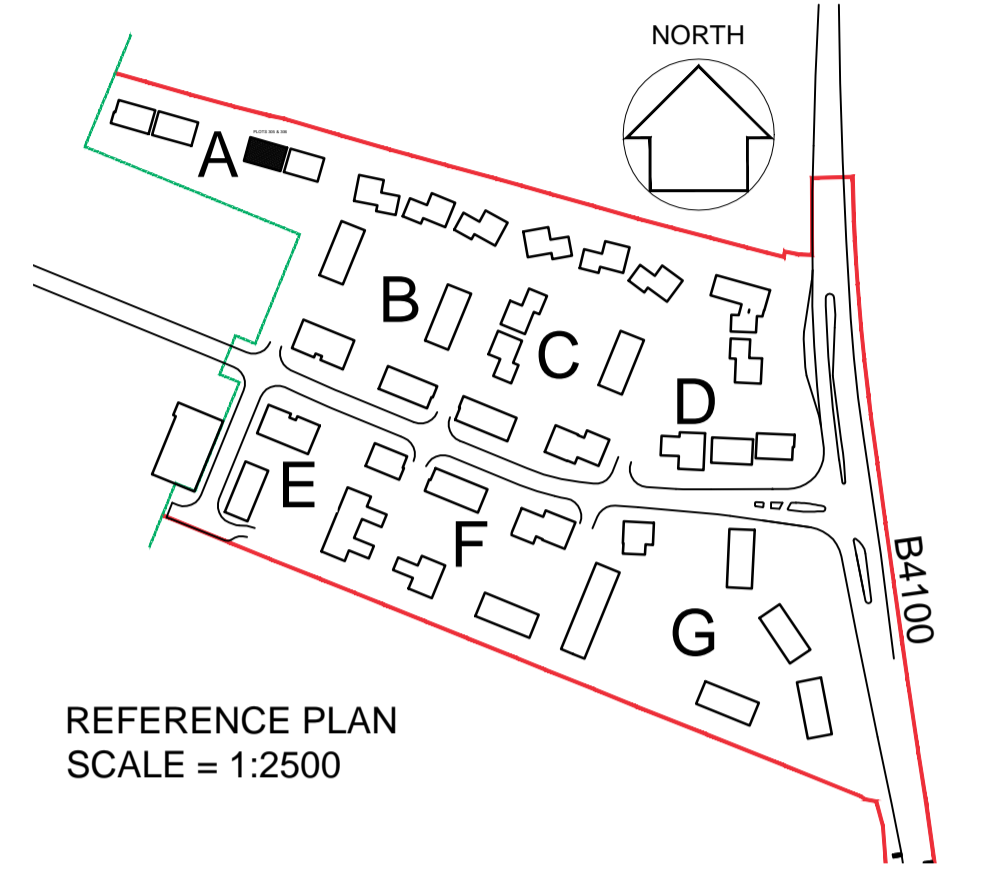

Rear

12590

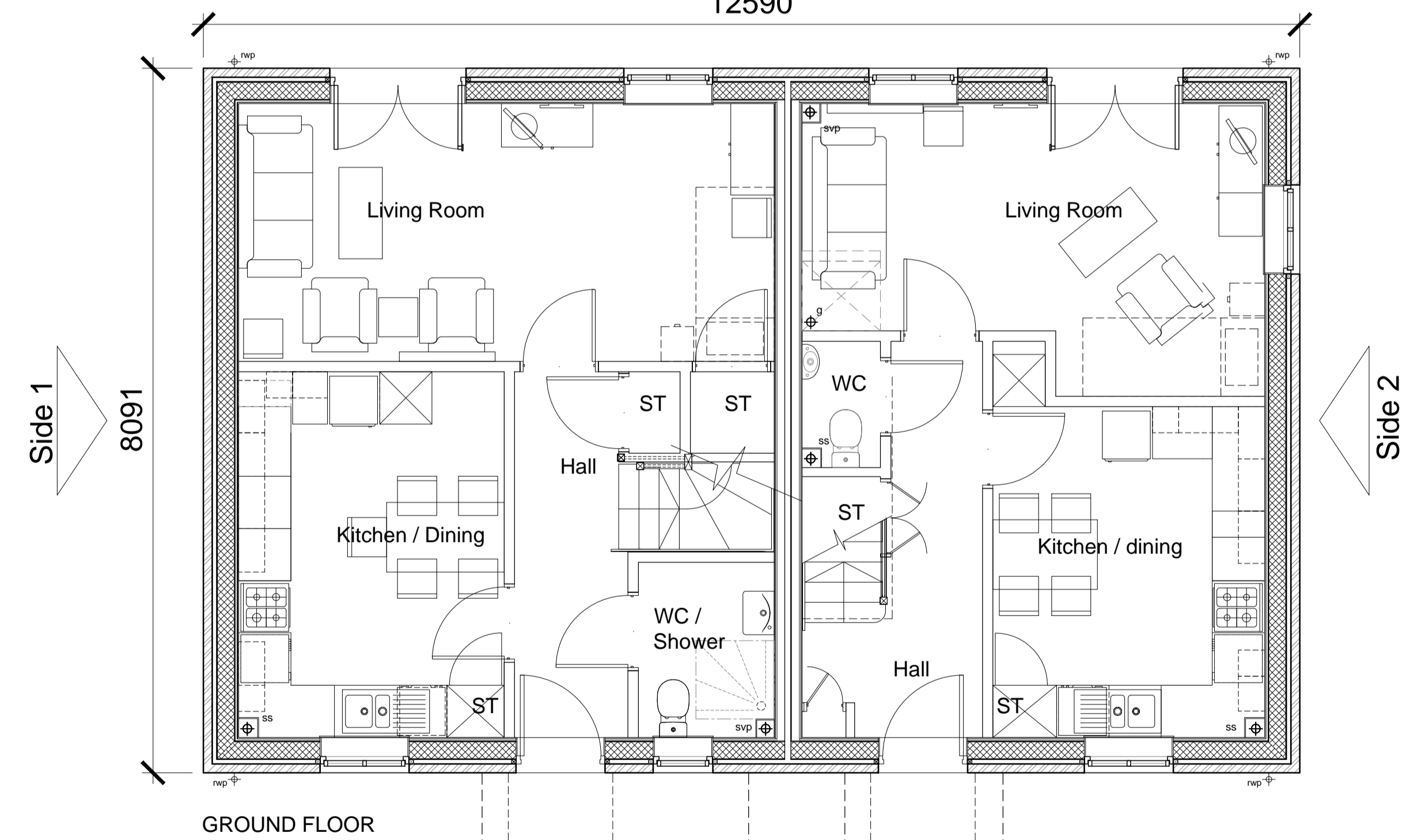

Side 1

8091

Side 2

Front

**Plot 306**  
3 Bed 5 Person - Affordable  
TYPE - 1  
WALLS - Bekstone  
ROOF - Linear [Bekstone]

**Plot 305**  
3 Bed 5 Person - Affordable

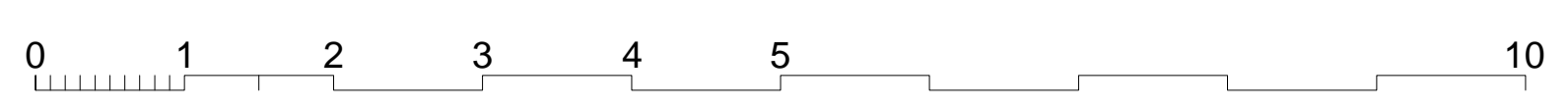

date	rev	revision/author/checker
20-02-13	B	Window omitted from Bed 2 plot 305 DGH/JW
22-01-13	A	Minor amendments status changed to planning DGH/JW

purpose of issue <b>PLANNING</b>	
project <b>BICESTER ECO TOWN EXEMPLAR SITE</b>	
drawing <b>GA FLOOR PLANS PLOTS 305 &amp; 306</b>	

drawing no <b>AA2699C/4.1/303</b>	rev <b>B</b>
drawn JW	checked
scale @ A1 1:50	date DEC 2012

PRP Architects ©  
10 Lindsey Street  
Smithfield  
London  
EC2A 9EP  
T +44 (0)20 7653 1200  
F +44 (0)20 7653 1201  
lon.prp@prparchitects.co.uk