

WILLMOTT DIXON HOUSING
REVIEWED

PRELIMINARY	STATUS
FOR COMMENT	A
FOR CONSTRUCTION	B
SIGNED ND	C
DATE 20.05.15	

notes

- The contractor is responsible for checking dimensions, tolerances and references. Any discrepancy to be verified with the Architect before proceeding with the works.
- Where an item is covered by drawings to different scales the larger scale drawing is to be worked to.
- Do not scale drawing. Figured dimensions to be worked to in all cases.

CDM Regulations 2007

ALL current drawings and specifications for the project must be read in conjunction with the Designer's Hazard and Environmental Assessment Record.

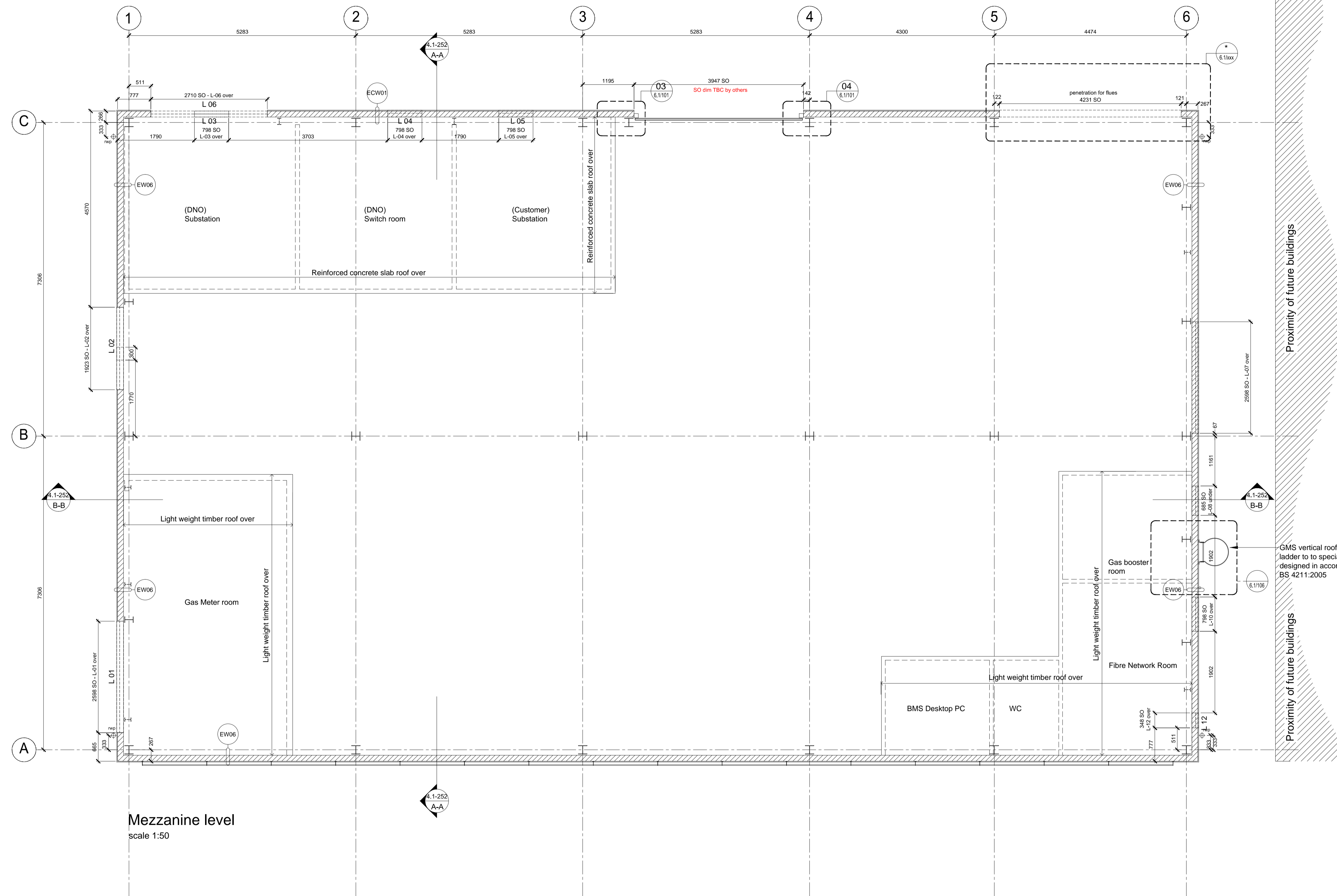

Mezzanine level
scale 1:50

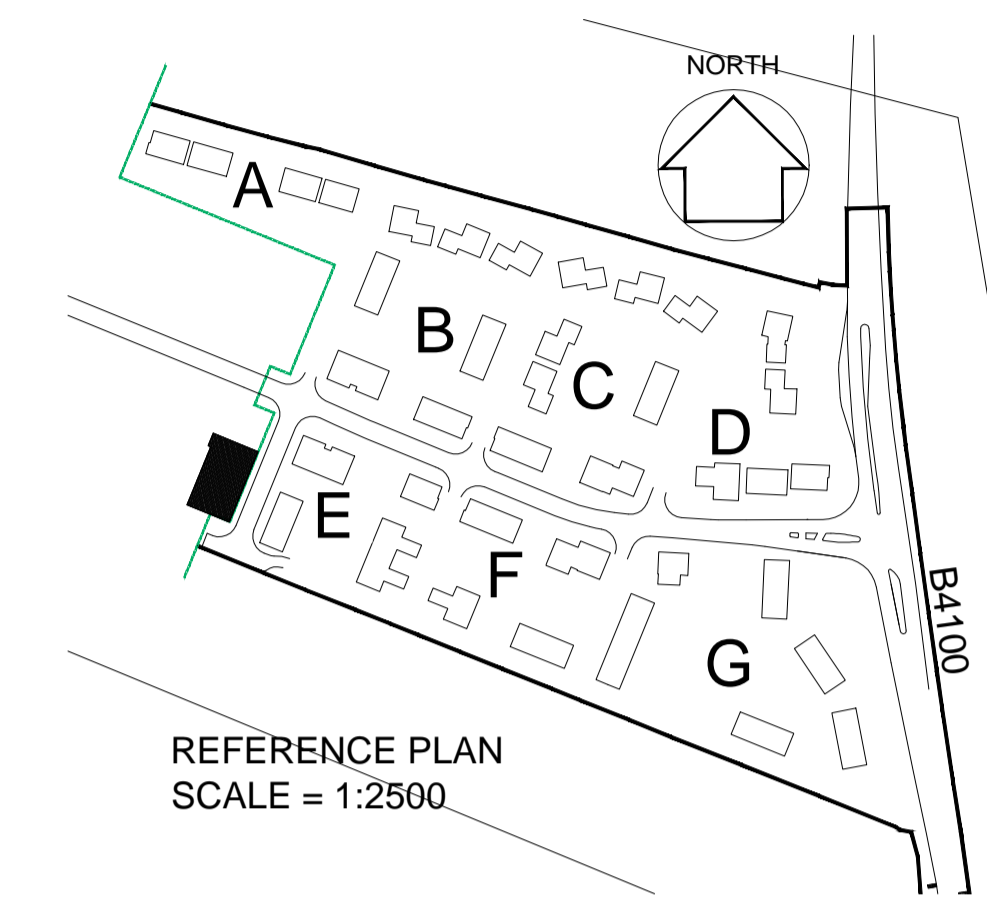

Note
This drawing to be read in conjunction with all relevant structural engineers, mechanical and electrical engineers drawings.

For details of equipment in this area see Vital Energy drawing M-372-C-13

For details of substructure and foundation details please refer to drawing UA004014-0100
 For details of superstructure and roof please refer to drawing UA004014-0101 & 0102
 For details of internal slabs, walls & ducts please refer to drawing UA004014-0103

06-05-2015	F	Amended to WDH comments; IM/CL
28-04-2015	E	Secondary steel locations + louvre dims amended in line with ground floor. Issued for Construction; IM/CL
07-08-2014	D	Drawing updated in line with current engineer's information; JW/MH
19-07-2014	C	GA layout updated in accordance with HCL drawing UA004014-0101-3 & Vital energy drawing D-144-C-150-D - JW/MH
19-02-2013	B	Additional information added - ILA
12-02-2013	A	First Issue

date	rev	revision/author/checker
------	-----	-------------------------

purpose of issue
CONSTRUCTION

project
BICESTER ECO TOWN EXEMPLAR SITE

drawing
ENERGY CENTRE Mezzanine Floor Plan

drawing no AA2699C/4.1/351	rev F
drawn DGH	checked MDB
scale @ A1 1:50	date Jan 2013