

- 1. Contractors must check all dimensions on site. Only figured dimensions are to be worked from. Discrepancies must be reported to the Architect or Engineer before proceeding. © This drawing is copyright
- 2. Reproduced from OS Sitemap © by permission of Ordnance Survey® on behalf of The Controller of Her Majesty's Stationary Office. © Crown copyright 2008. All rights reserved. Licence number 100007126.
- 3. Subject to detailed design. Adoptable highway materials subject Section 38 / 278 approval by Oxfordshire County Council as required.

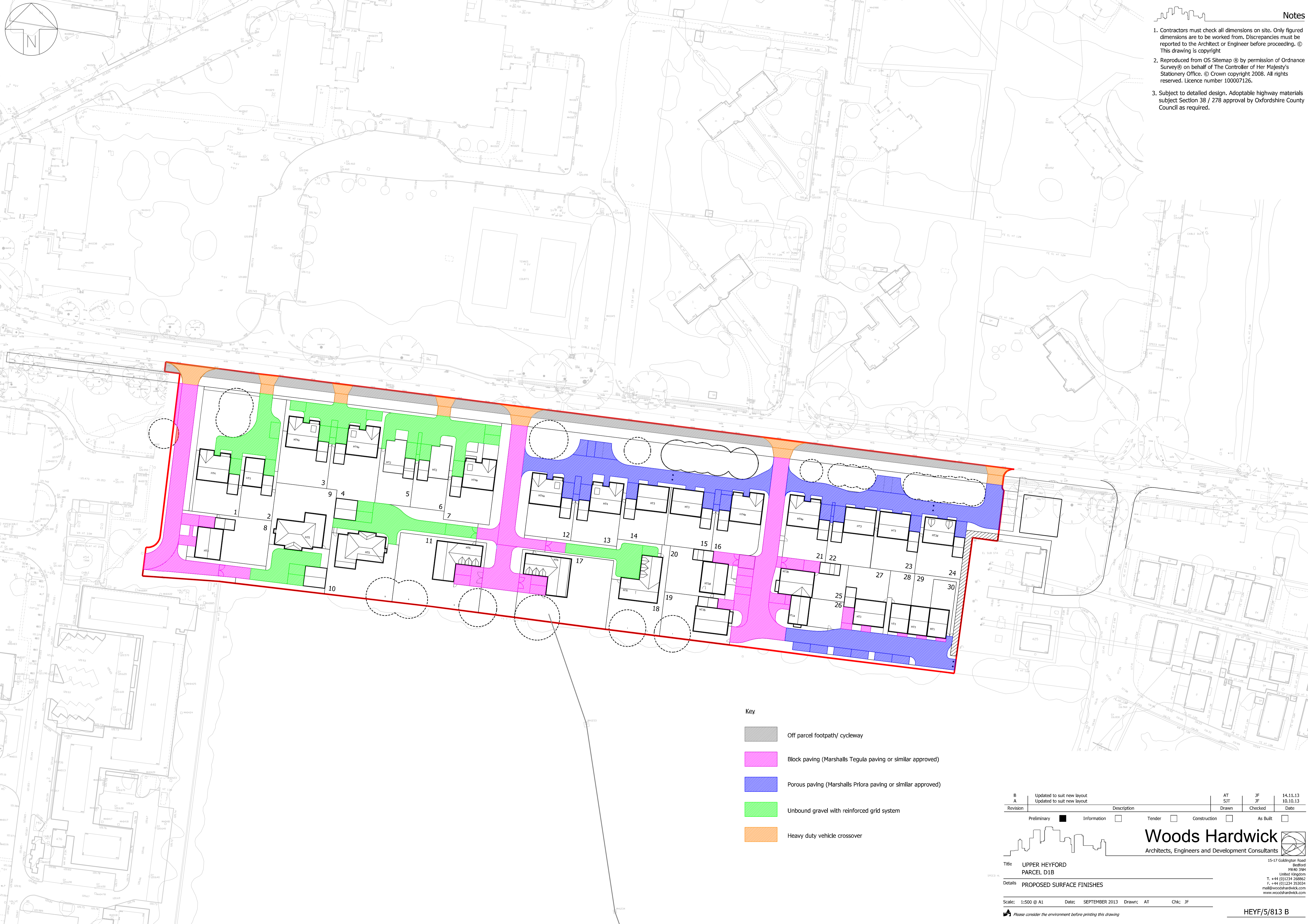

- Key**
- Off parcel footpath/ cycleway
  - Block paving (Marshalls Tegula paving or similar approved)
  - Porous paving (Marshalls Piora paving or similar approved)
  - Unbound gravel with reinforced grid system
  - Heavy duty vehicle crossover

Revision	Description	Drawn	Checked	Date
B	Updated to suit new layout	AT	JF	14.11.13
A	Updated to suit new layout	SJT	JF	10.10.13
	Preliminary <input checked="" type="checkbox"/> Information <input type="checkbox"/> Tender <input type="checkbox"/> Construction <input type="checkbox"/> As Built <input type="checkbox"/>			

**Woods Hardwick**  
Architects, Engineers and Development Consultants

15-17 Gokington Road  
Bedford  
MK40 3JH  
United Kingdom  
T. +44 (0)1234 268862  
F. +44 (0)1234 353034  
mail@woodshardwick.com  
www.woodshardwick.com

Title: UPPER HEYFORD  
PARCEL D1B

Details: PROPOSED SURFACE FINISHES

Scale: 1:500 @ A1 Date: SEPTEMBER 2013 Drawn: AT Chk: JF