

Notes

- 1. Contractors must check all dimensions on site. Only figured dimensions are to be worked from. Discrepancies must be reported to the Architect or Engineer before proceeding. © This drawing is copyright
- 2. Reproduced from OS Sitemap © by permission of Ordnance Survey® on behalf of The Controller of Her Majesty's Stationary Office. © Crown copyright 2008. All rights reserved. Licence number 100007126.
- 3. Masterplan reference 14272-01-dw-411-030 illustrative masterplan by Scott Brownrigg

Key

- DEVELOPER 1 PHASE 1 START 2014
- DEVELOPER 1 PHASE 2 START 2014
- DEVELOPER 1 PHASE 3 START 2015
- DEVELOPER 2 PHASE 1 START 2014
- DEVELOPER 2 PHASE 2 START 2014
- DEVELOPER 2 PHASE 3 START 2015
- DEVELOPER 2 PHASE 4 START 2016
- DEVELOPER 2 PHASE 5 START 2017

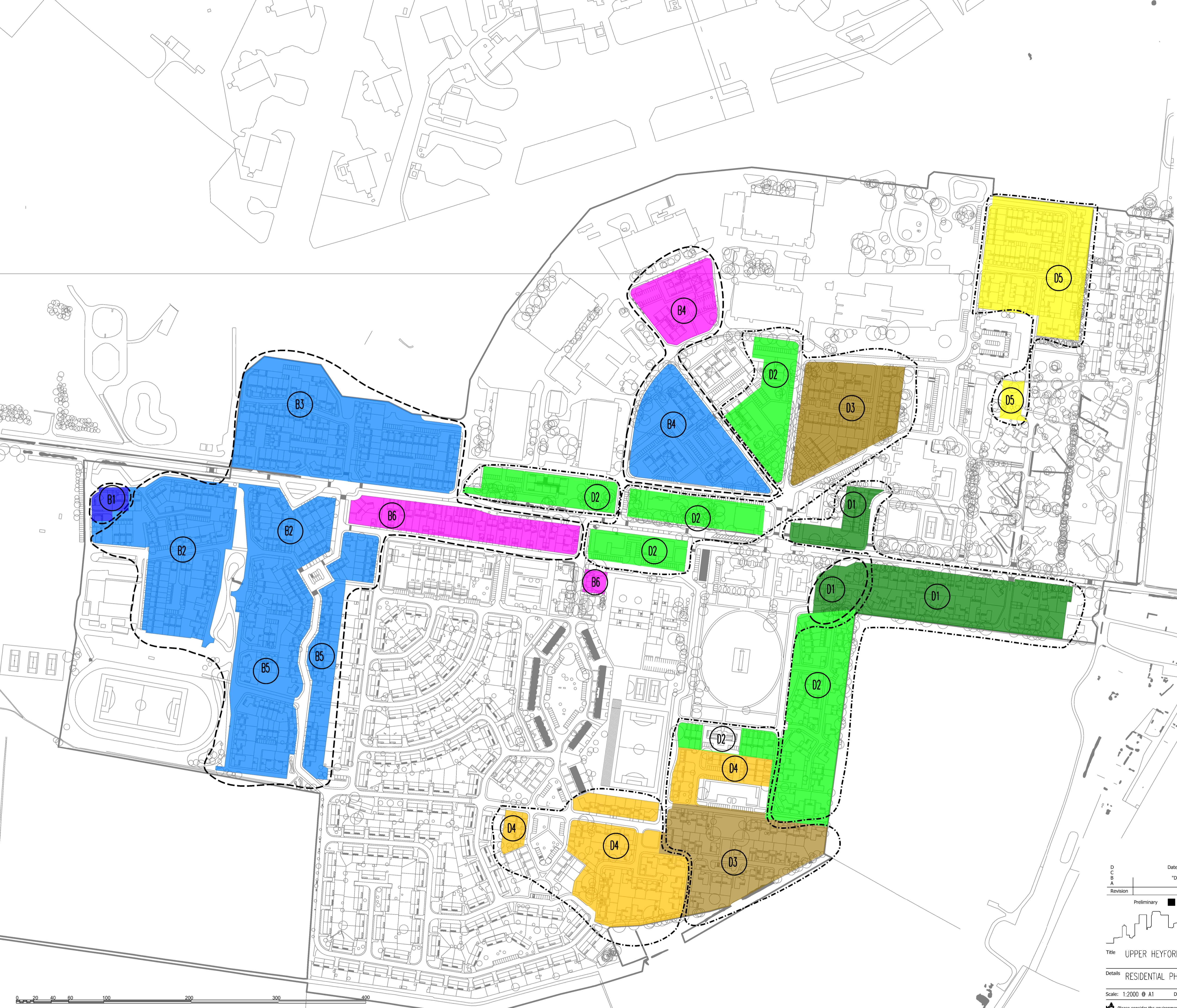

Revision	Description	Drawn	Checked	Date
D	Dates removed from layout. Phase 1 key amended to start in 2014	AT	JF	16.01.14
C	"Developer 1" phase colours amended.	AT	JF	20.12.13
B	"Developer 2" phase colours amended. Phase names amended	AT	JF	18.12.13
A	Start for B6 added, Start for B4a brought forwards	AT	JF	22.11.13

Preliminary  
  Information  
  Tender  
  Construction  
  As Built

**Woods Hardwick**  
Architects, Engineers and Development Consultants

Title: UPPER HEYFORD

Details: RESIDENTIAL PHASING PLAN

Scale: 1:2000 @ A1   Date: June 2013   Drawn: JGF   Chk: IDB

15-17 Goldington Road  
MK40 3JH  
Bedford  
United Kingdom  
T: +44 (0)1234 268862  
F: +44 (0)1234 353034  
mail@woodshardwick.com  
www.woodshardwick.com

Please consider the environment before printing this drawing