

Do not scale this drawing.  
All dimensions to be checked on site.

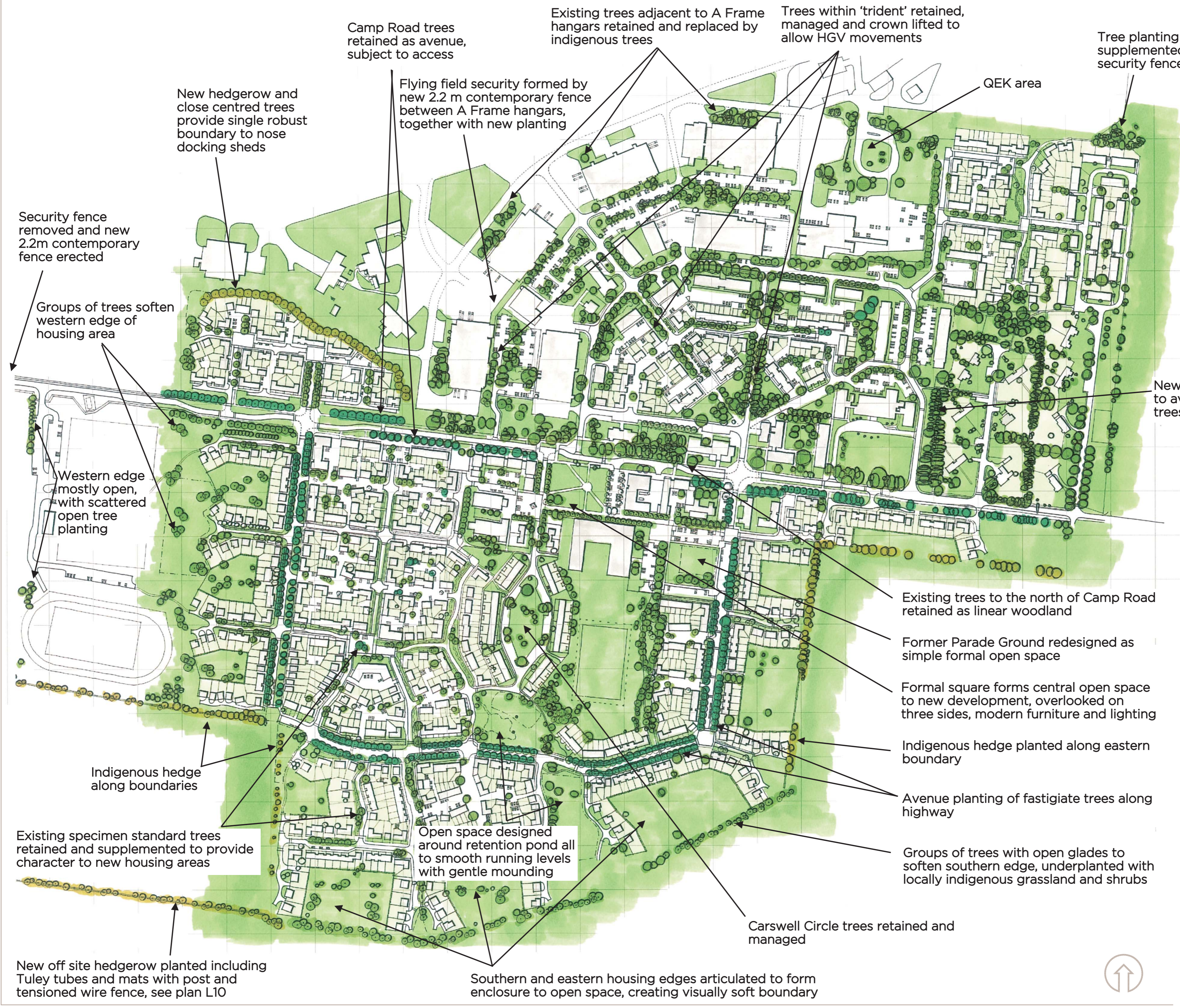

Camp Road trees retained as avenue, subject to access

Existing trees adjacent to A Frame hangars retained and replaced by indigenous trees

Trees within 'trident' retained, managed and crown lifted to allow HGV movements

Tree planting supplemented within security fence

New hedgerow and close centred trees provide single robust boundary to nose docking sheds

Flying field security formed by new 2.2 m contemporary fence between A Frame hangars, together with new planting

QEK area

Security fence removed and new 2.2m contemporary fence erected

Groups of trees soften western edge of housing area

New access located to avoid existing trees

Western edge mostly open, with scattered open tree planting

Notes:  
Please refer to the plan L10 Landscape Keyplan for more details

# Plan L14

Existing trees to the north of Camp Road retained as linear woodland

Former Parade Ground redesigned as simple formal open space

Formal square forms central open space to new development, overlooked on three sides, modern furniture and lighting

Indigenous hedge planted along eastern boundary

Avenue planting of fastigate trees along highway

Groups of trees with open glades to soften southern edge, underplanted with locally indigenous grassland and shrubs

Indigenous hedge along boundaries

Existing specimen standard trees retained and supplemented to provide character to new housing areas

Open space designed around retention pond all to smooth running levels with gentle mounding

Carswell Circle trees retained and managed

New off site hedgerow planted including Tuley tubes and mats with post and tensioned wire fence, see plan L10

Southern and eastern housing edges articulated to form enclosure to open space, creating visually soft boundary

**COOPER PARTNERSHIP**

T 0117 946 7488  
F 0117 946 7478  
mail@cooperpartnership.com  
www.cooperpartnership.com

Job  
**Heyford Park**

Title  
**LANDSCAPE MASTERPLAN FOR SETTLEMENT AREA**

Scale	Date	Drawn	Checked	Approved
NTS	August 07	HT	JC	JC

Drawing no  
1802-69

© Copyright

- LANDSCAPE
- TOWNSCAPE
- ENVIRONMENT

