

# Archaeological Surveys

## Geophysical Survey Upper Heyford Park

### Map of survey area

Reproduced from OS Explorer map no.191 1:25 000 by permission of Ordnance Survey on behalf of The Controller of Her Majesty's Stationery Office. © Crown copyright. All rights reserved. Licence number 100043739.



● Survey location

Site centred on OS NGR  
SP 515 266

SCALE 1:25 000



Survey location

# Archaeological Surveys

Geophysical Survey  
Upper Heyford Park

Location of Survey Areas

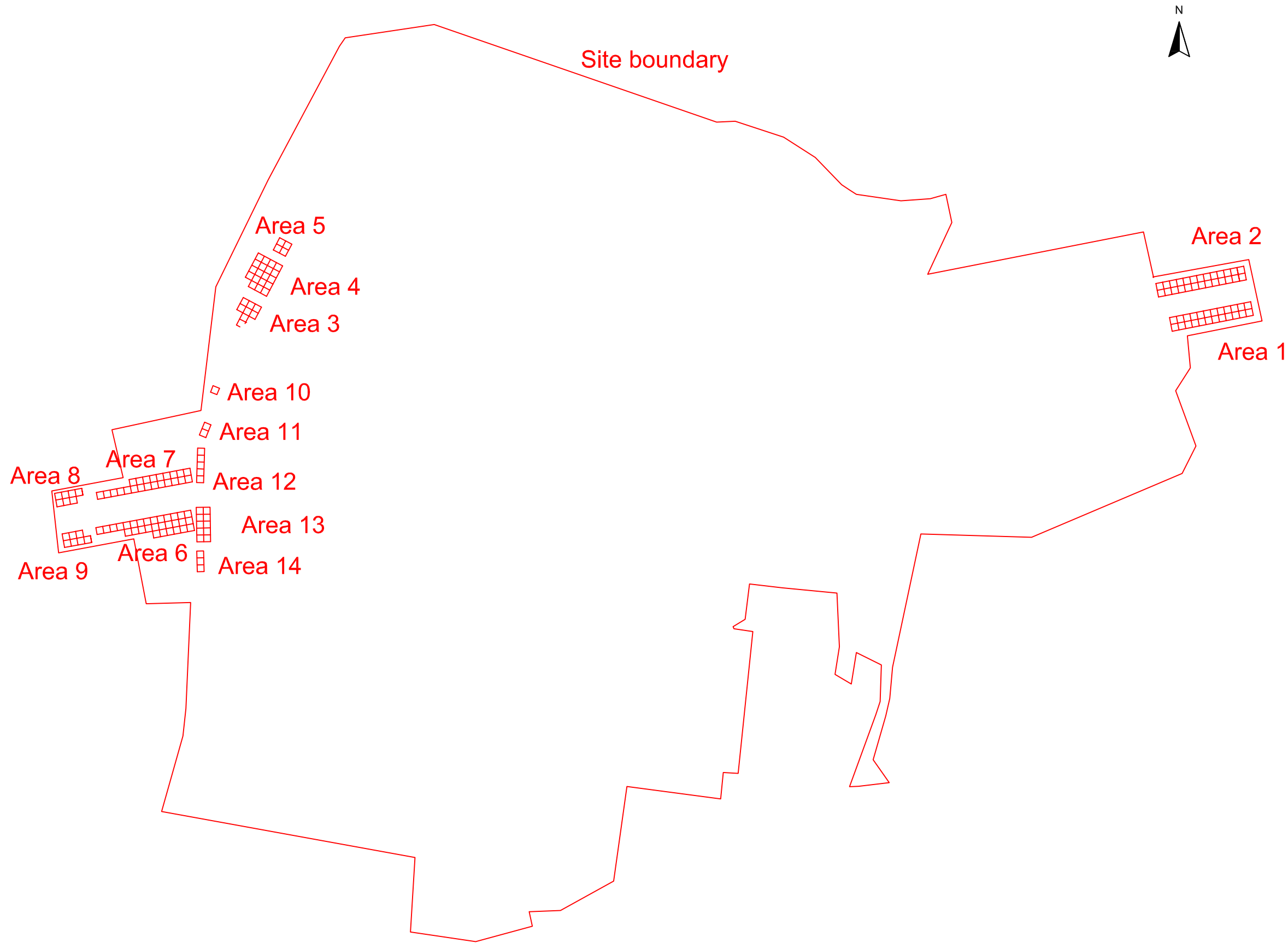

SCALE 1:12 000

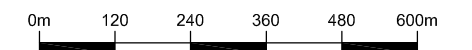

# Archaeological Surveys

## Geophysical Survey Upper Heyford Park

### Referencing information - Areas 1 & 2

Based on OS coordinates (OS GB 36)

→ Survey start and traverse direction

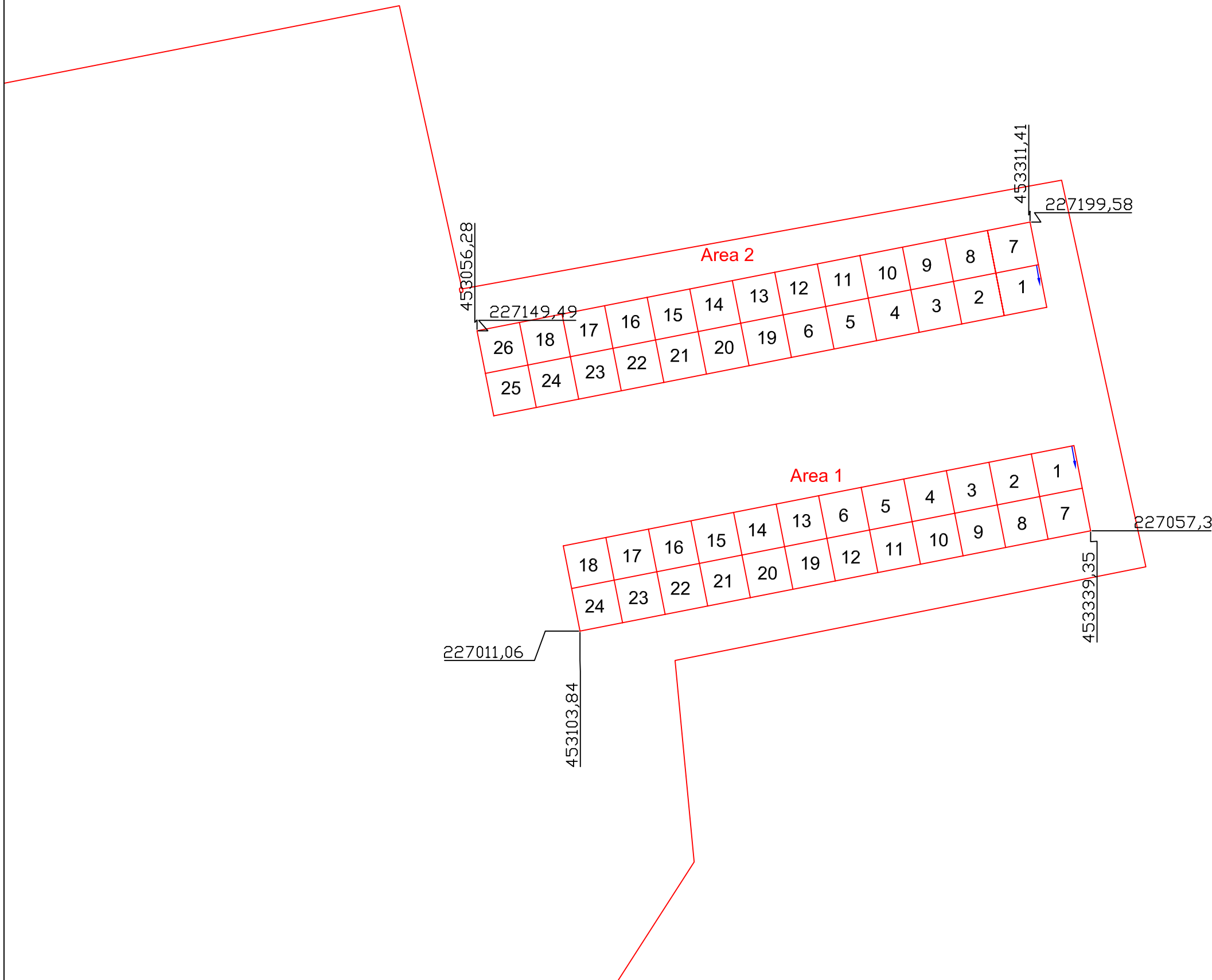

SCALE 1:2000

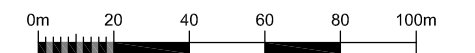

# Archaeological Surveys

## Geophysical Survey Upper Heyford Park

### Referencing information - Area 3, 4, 5 and 10

Based on OS coordinates (OSGB36)

→ Survey start and traverse direction

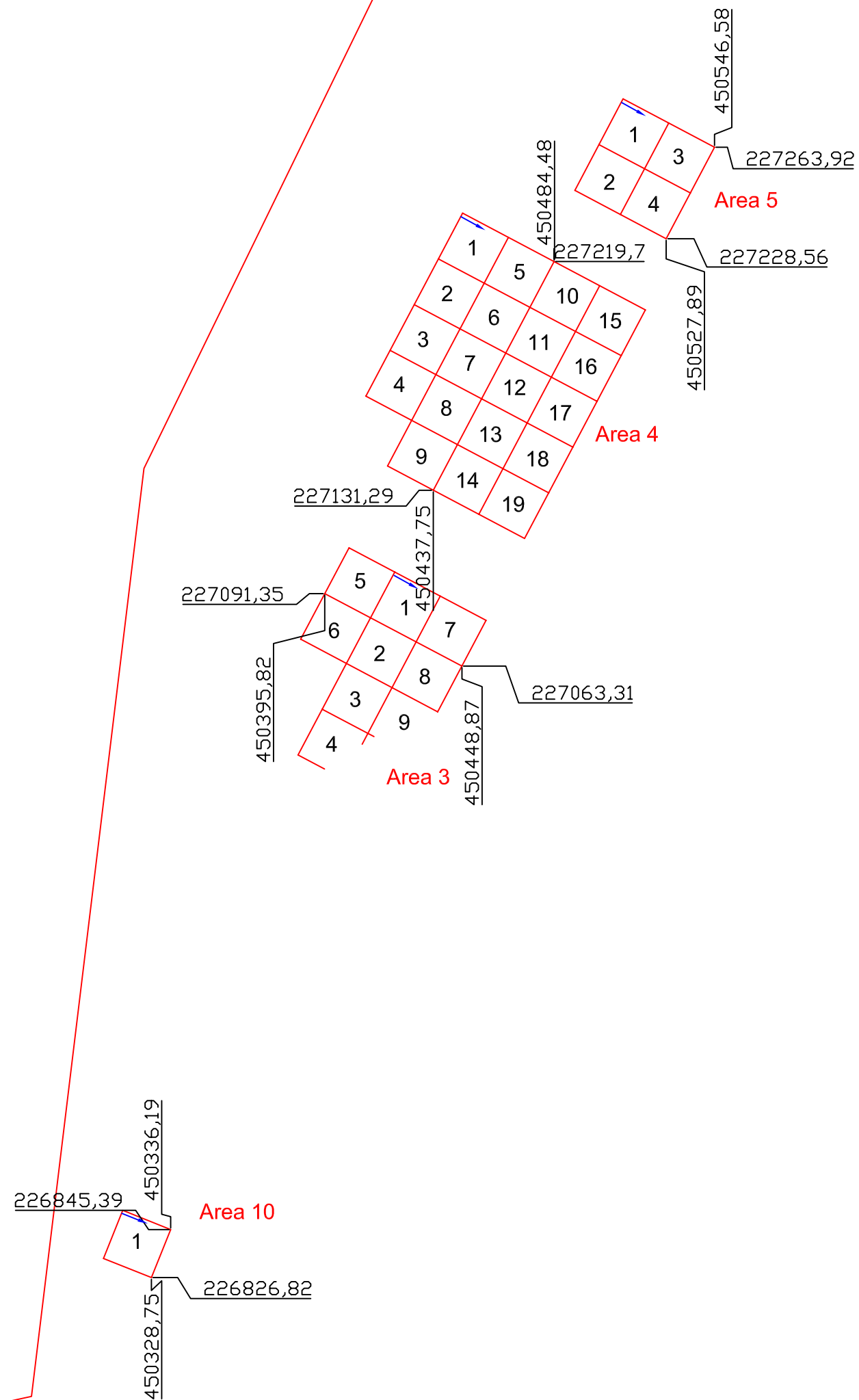

SCALE 1:2000

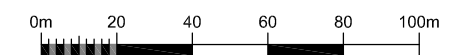

# Archaeological Surveys

## Geophysical Survey Upper Heyford Park

### Referencing information - Areas 6, 7, 8, 9, 11, 12, 13 & 14

Based on OS coordinates (OSGB36)

→ Survey start and traverse direction

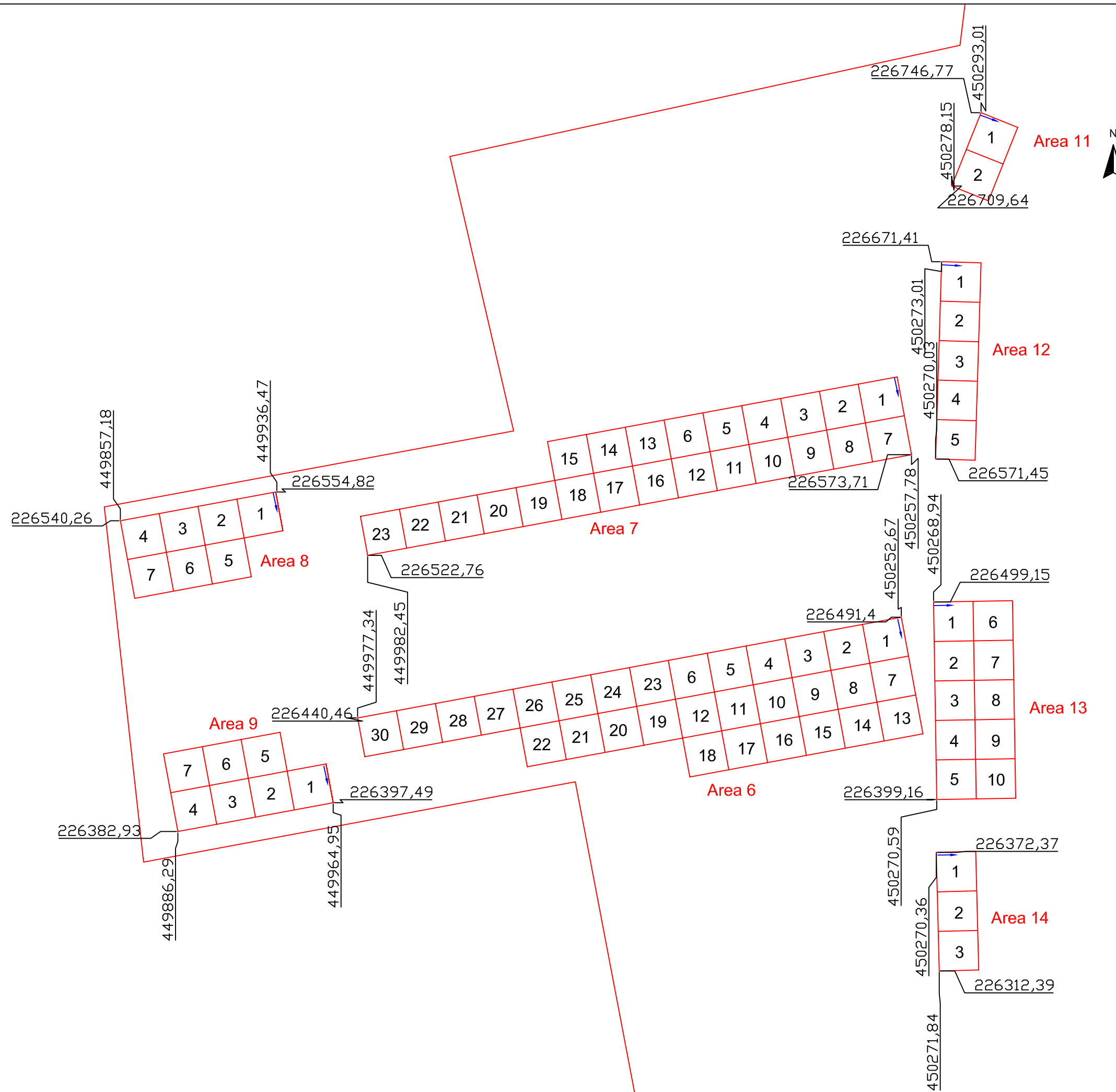

SCALE 1:2000

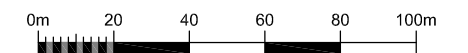

# Archaeological Surveys

## Geophysical Survey Upper Heyford Airbase

Greyscale plot of raw  
magnetometer data -  
Areas 1 and 2

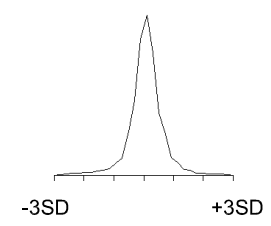
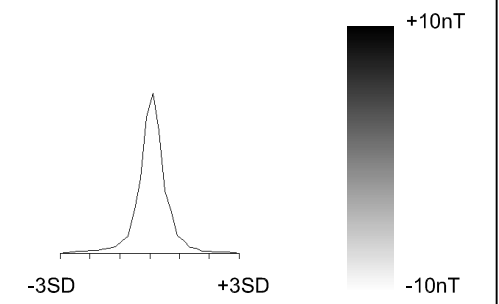

Area 1

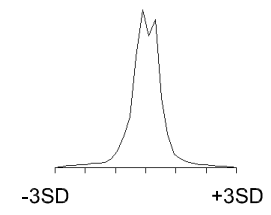

Area 2

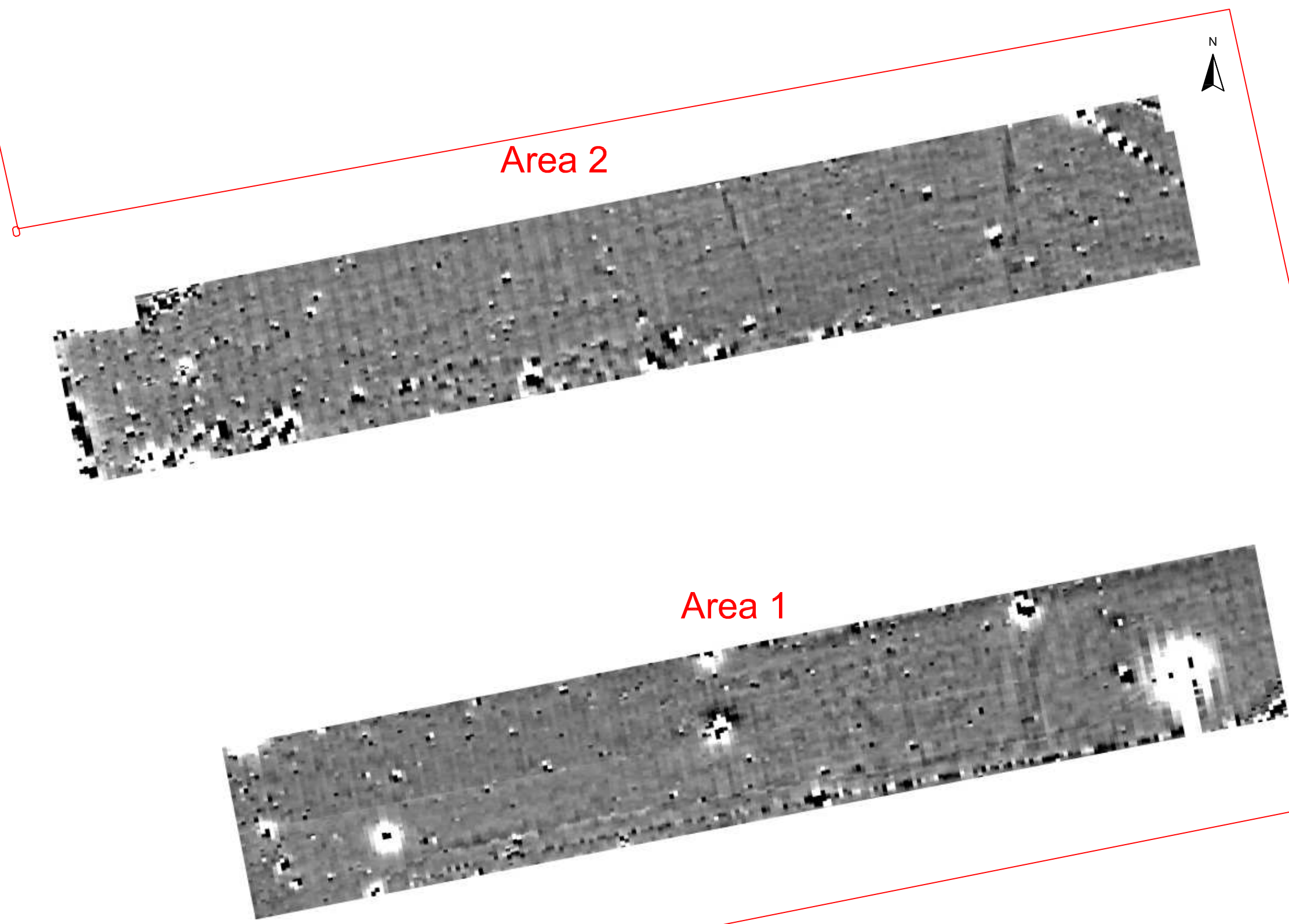

SCALE 1:1000

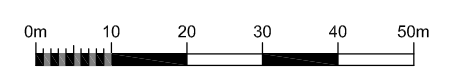

# Archaeological Surveys

## Geophysical Survey Upper Heyford Park

### Traceplot of raw magnetometer data - Areas 1 and 2

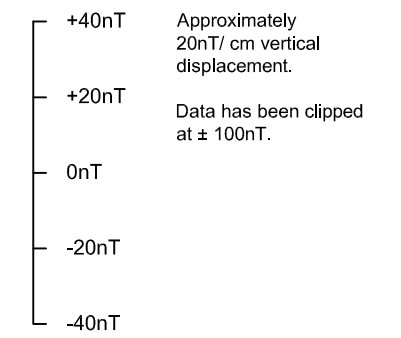

SCALE    1:1000

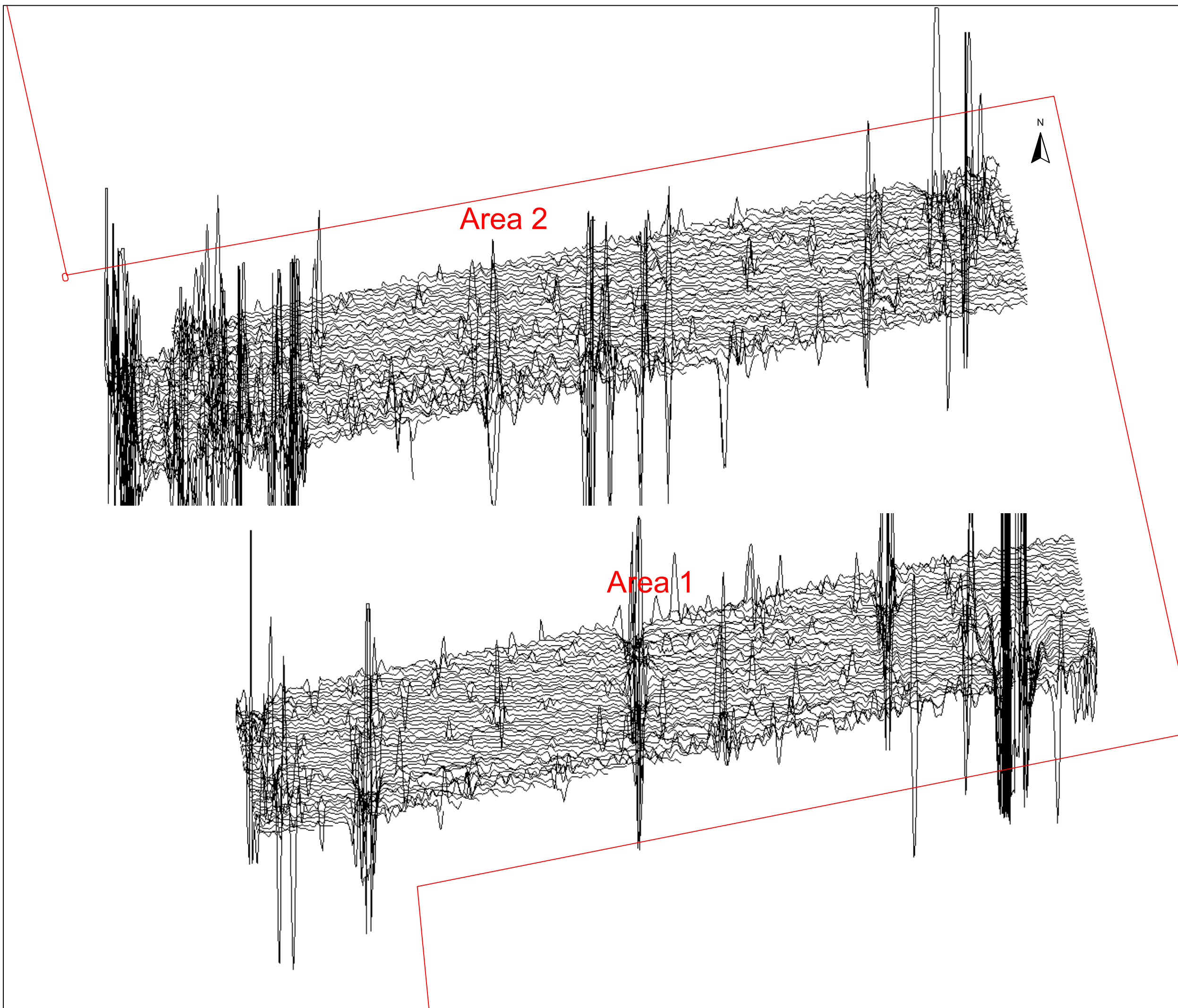

# Archaeological Surveys

Geophysical Survey  
Upper Heyford Park

Greyscale plot of processed  
magnetometer data -  
Area 1 and 2

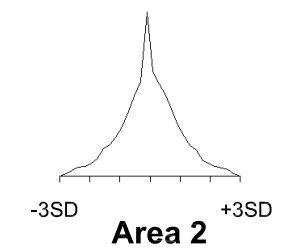
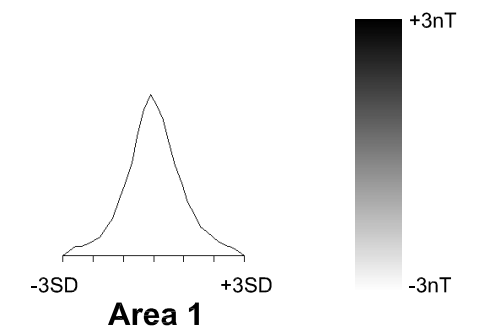

SCALE 1:1000

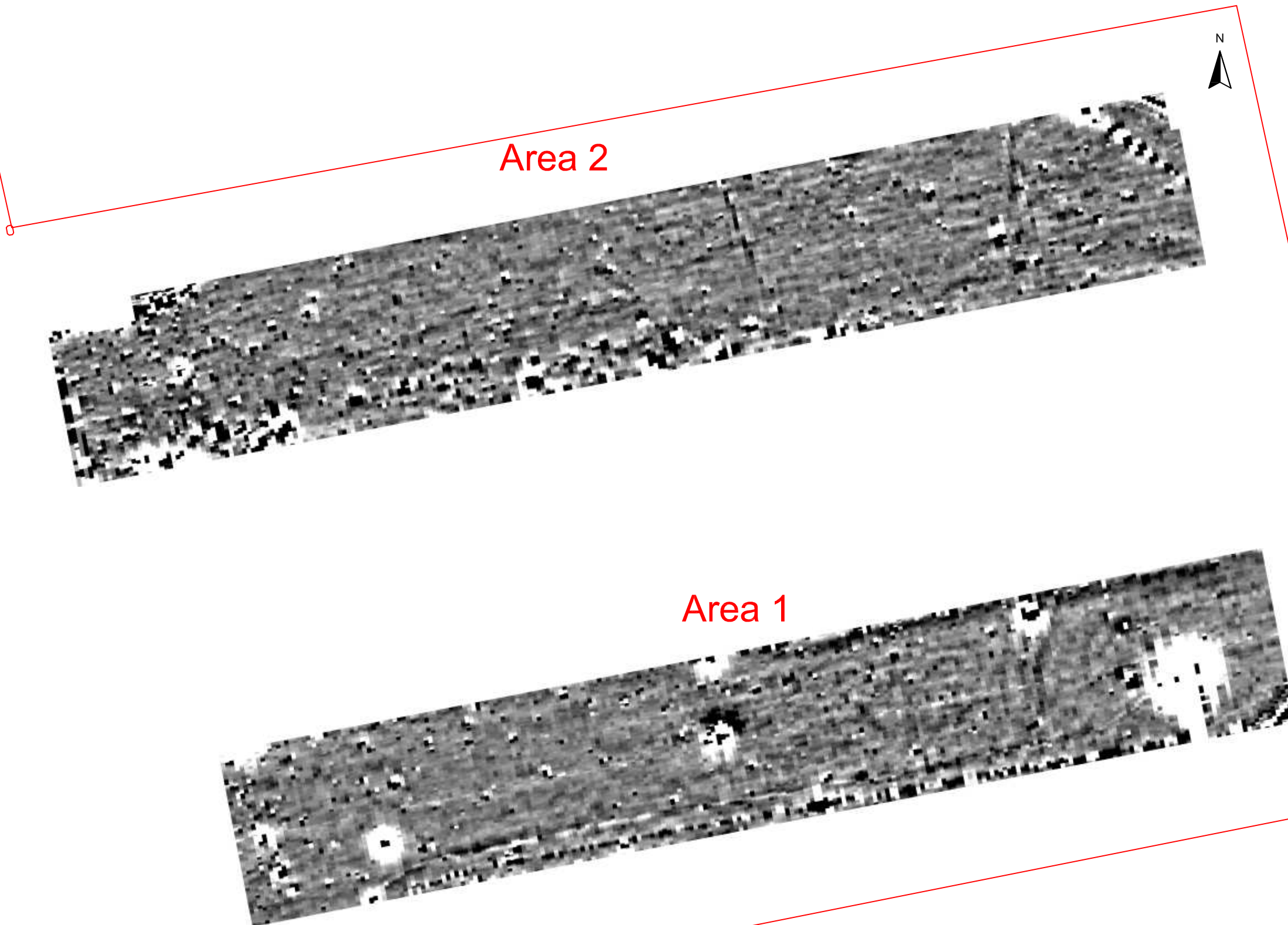



# Archaeological Surveys

## Geophysical Survey Upper Heyford Park

### Abstraction and interpretation of magnetometer anomalies - Areas 1 and 2

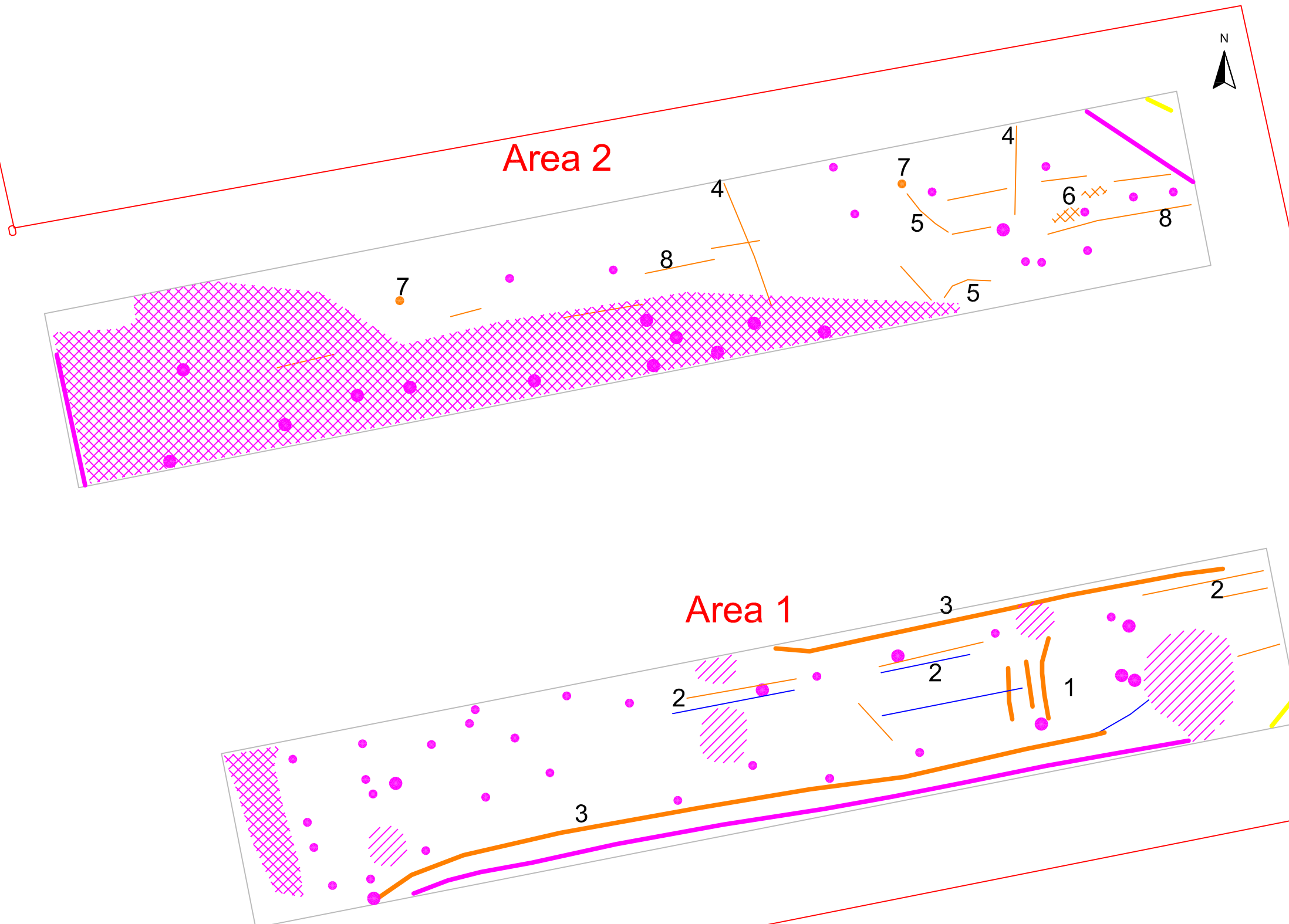

- Positive linear anomaly - of uncertain origin
- Perimeter road edge
- Negative linear anomaly - of uncertain origin
- Discrete positive response - uncertain origin
- ⊗ Positive anomaly - uncertain origin
- ⊗ Magnetic debris - spread of magnetically thermoremnant/ ferrous material
- ⊘ Magnetic disturbance from ferrous material
- Strong dipolar linear anomaly - pipeline / cable / service
- Strong dipolar anomaly - ferrous object

SCALE 1:1000



# Archaeological Surveys

Geophysical Survey  
Upper Heyford Park

Greyscale plot of raw  
magnetometer data -  
Areas 3, 4 and 5

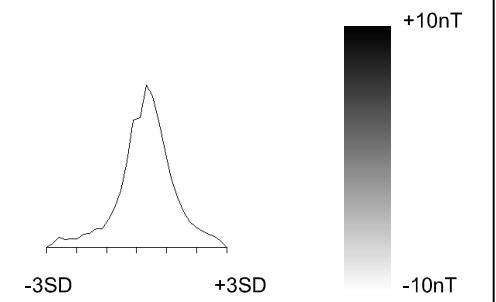

Area 3

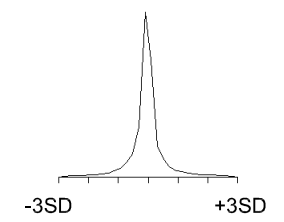

Area 4

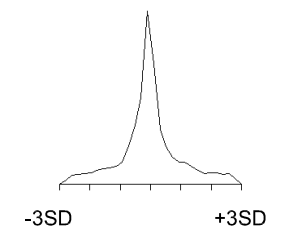

Area 5

SCALE 1:1000

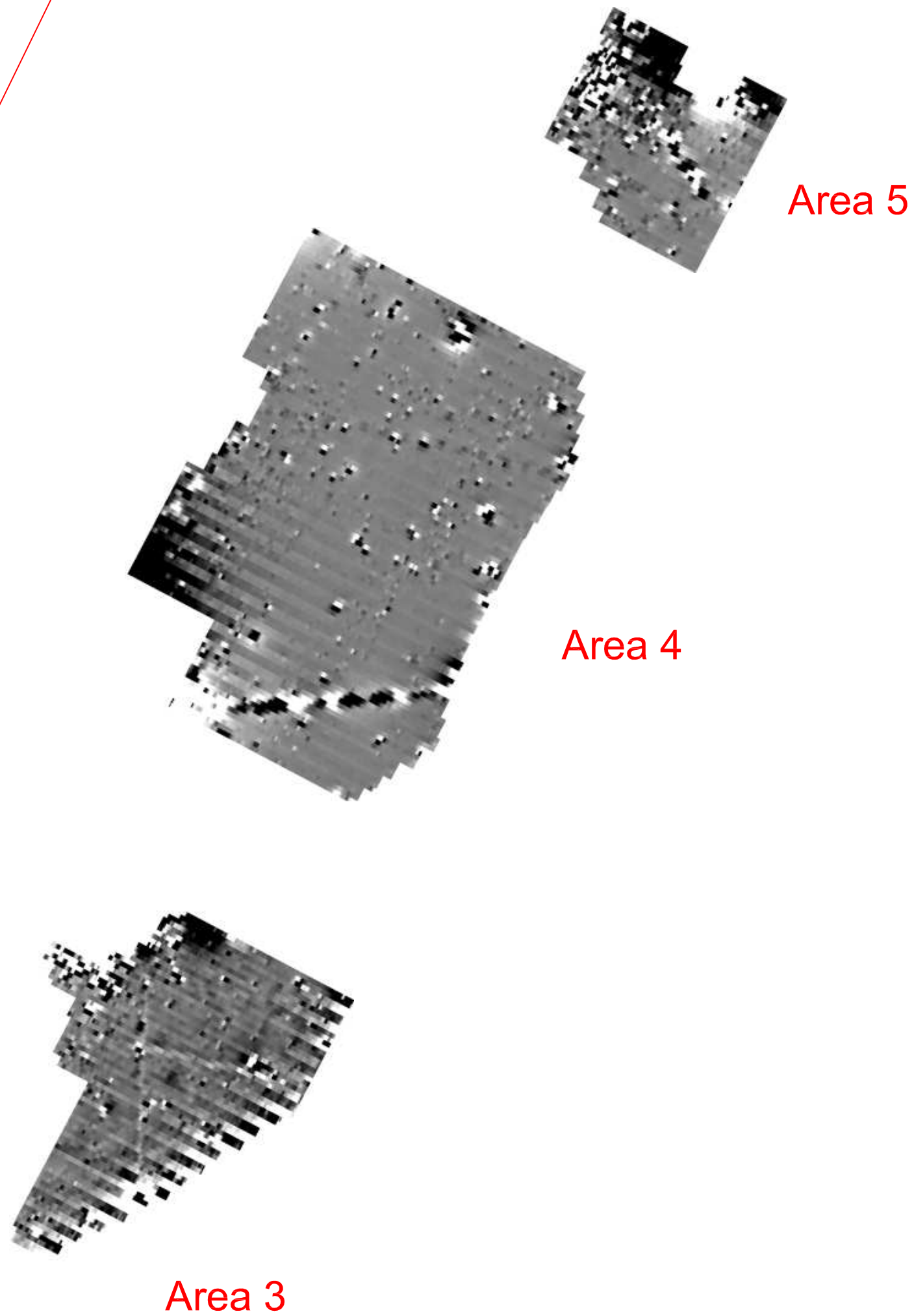
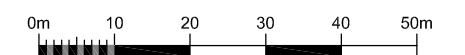

# Archaeological Surveys

## Geophysical Survey Upper Heyford Park

### Traceplot of raw magnetometer data - Areas 3, 4 and 5

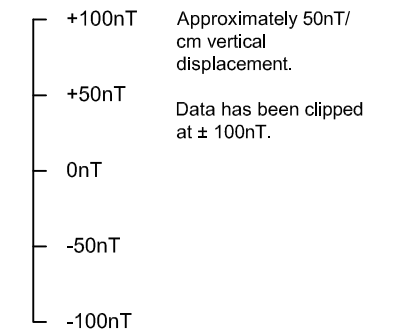

SCALE    1:1000

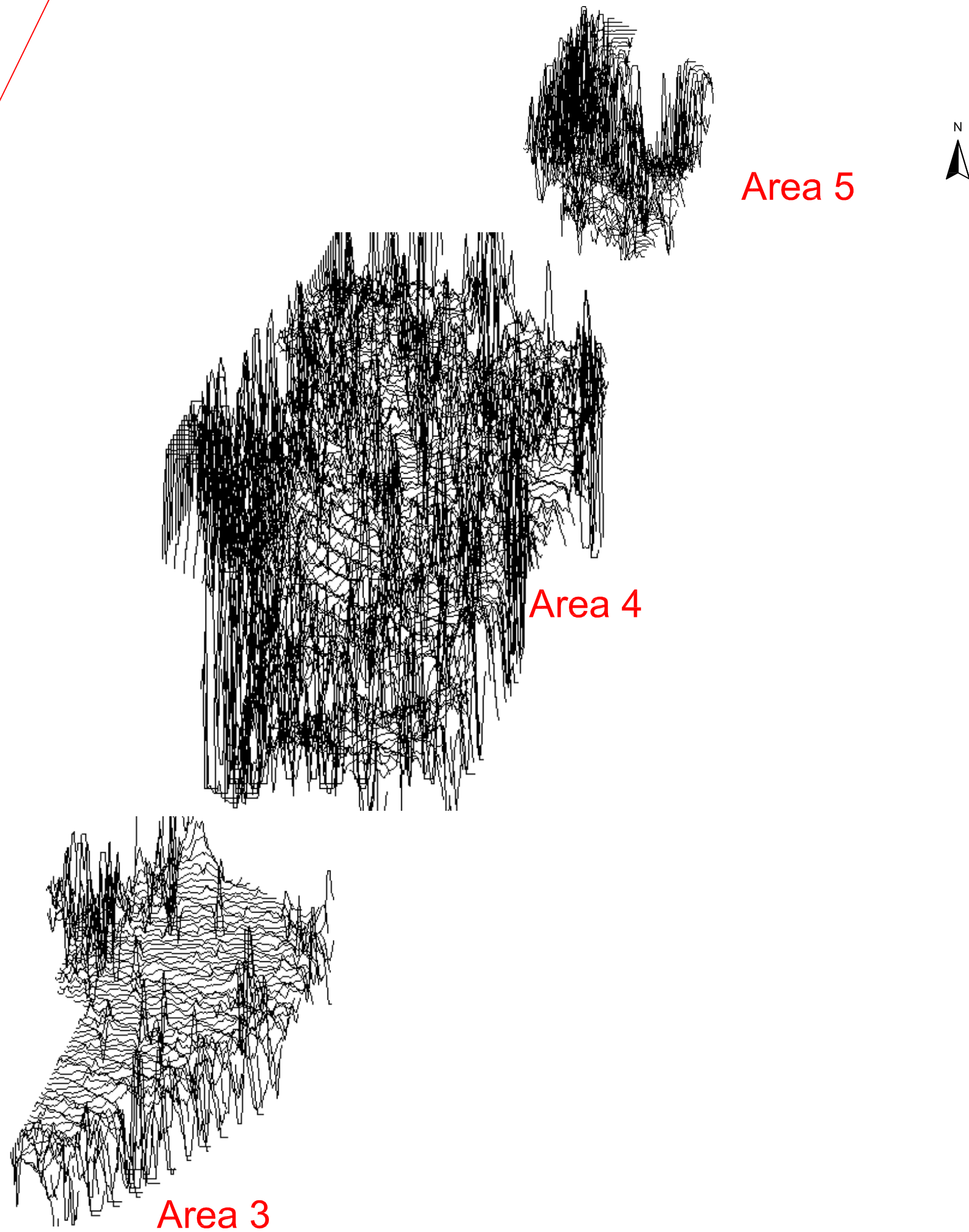
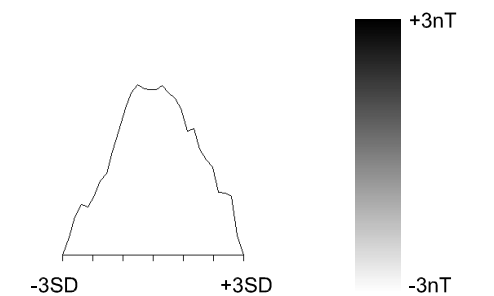

FIG 11

# Archaeological Surveys

Geophysical Survey  
Upper Heyford Park

Greyscale plot of processed  
magnetometer data -  
Areas 3, 4 and 5



Area 3

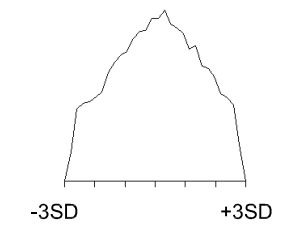

Area 4

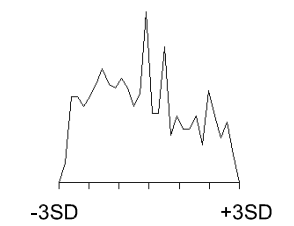

Area 5



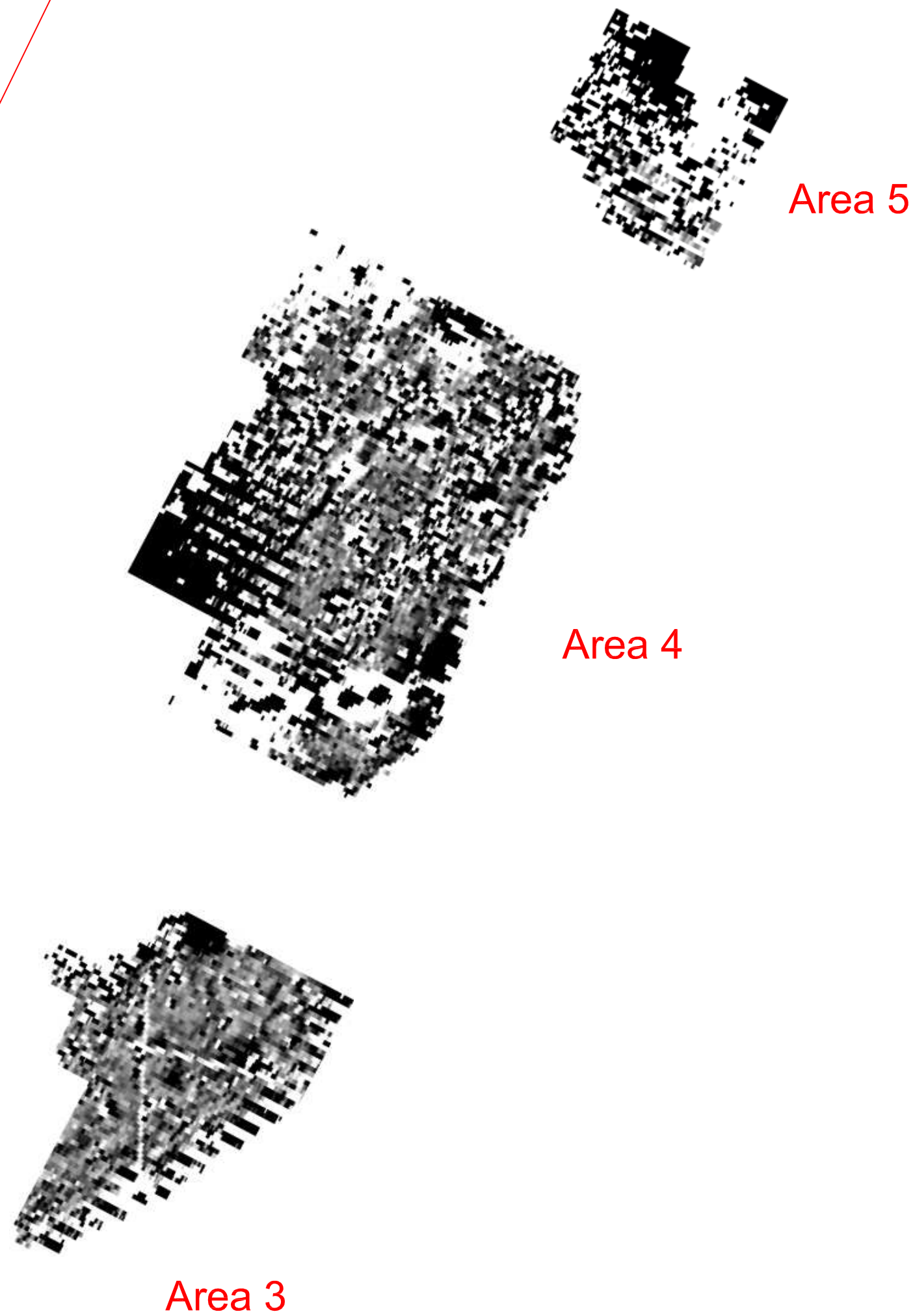





SCALE 1:1000



# Archaeological Surveys

## Geophysical Survey Upper Heyford Park

### Abstraction and interpretation of magnetometer anomalies - Areas 3, 4 and 5

-  Positive linear anomaly - of uncertain origin
-  Negative linear anomaly - of uncertain origin
-  Discrete positive response - uncertain origin
-  Positive response - of uncertain origin
-  Magnetic debris - spread of magnetically thermoremnant/ ferrous material
-  Magnetic disturbance from ferrous material
-  Strong dipolar linear anomaly - pipeline / cable / service
-  Strong dipolar anomaly - ferrous object

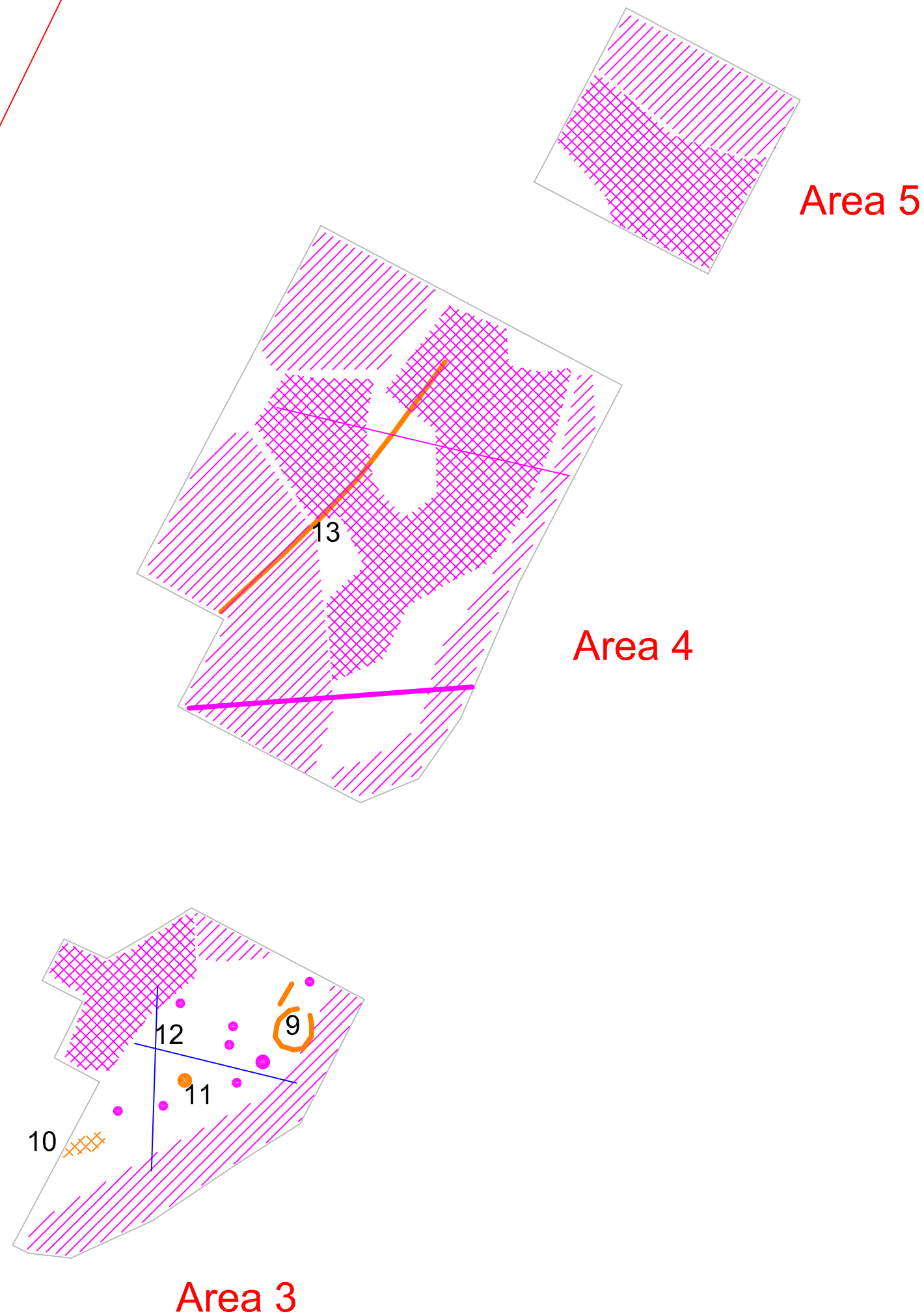
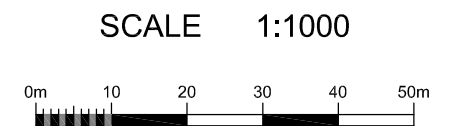
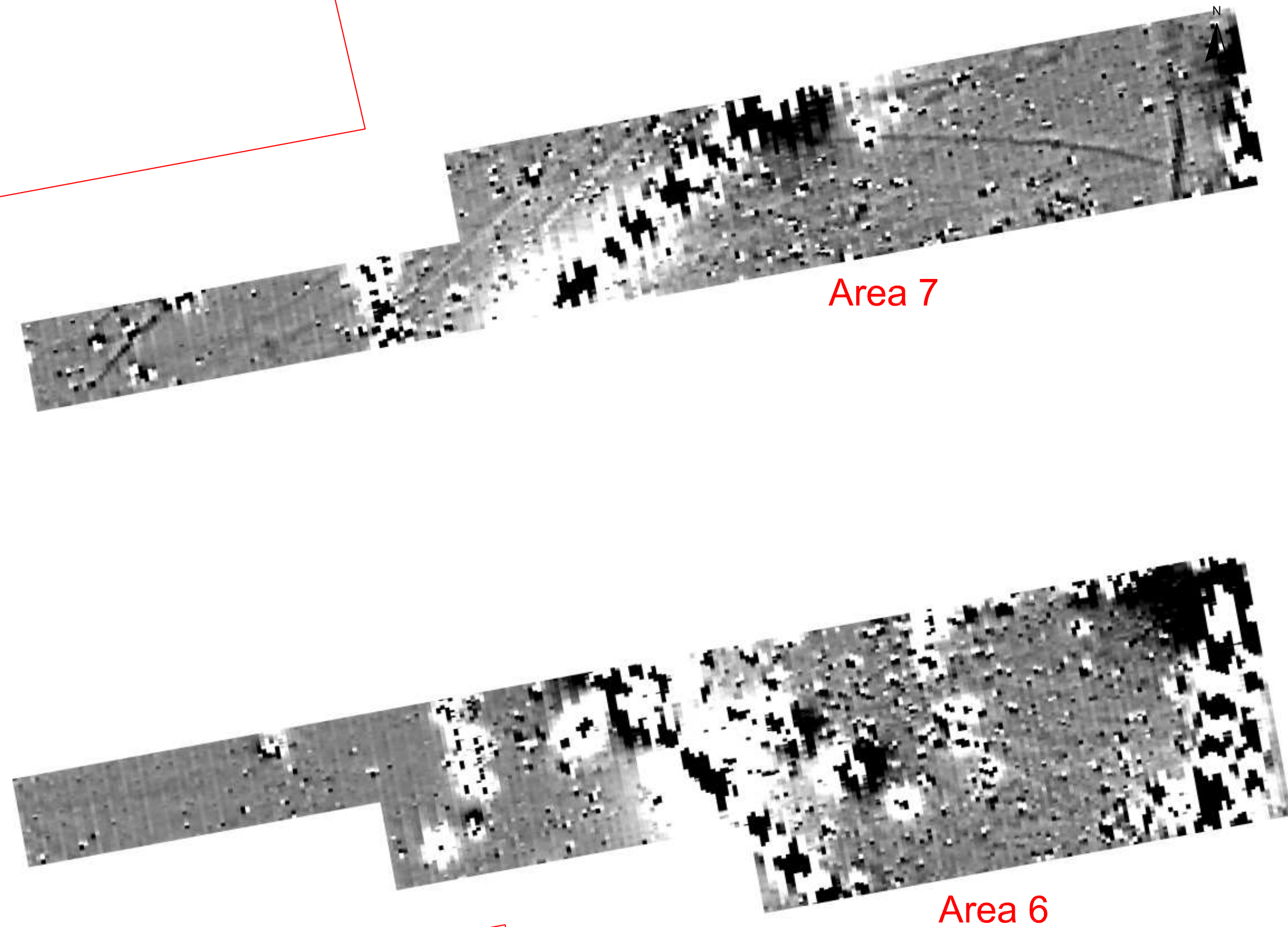
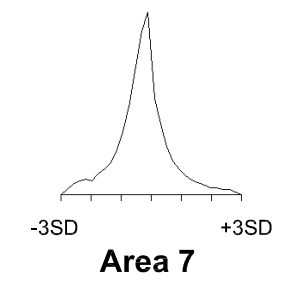
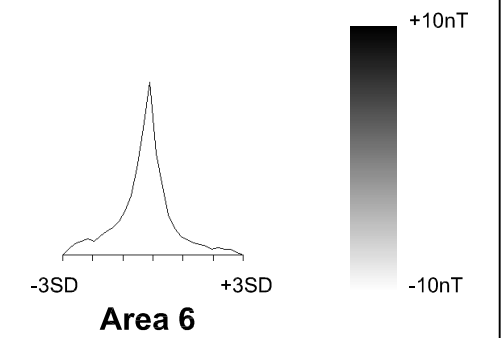

FIG 13

# Archaeological Surveys

Geophysical Survey  
Upper Heyford Park

Greyscale plot of raw  
magnetometer data -  
Areas 6 and 7



# Archaeological Surveys

## Geophysical Survey Upper Heyford Park

### Traceplot of raw magnetometer data - Areas 6 and 7

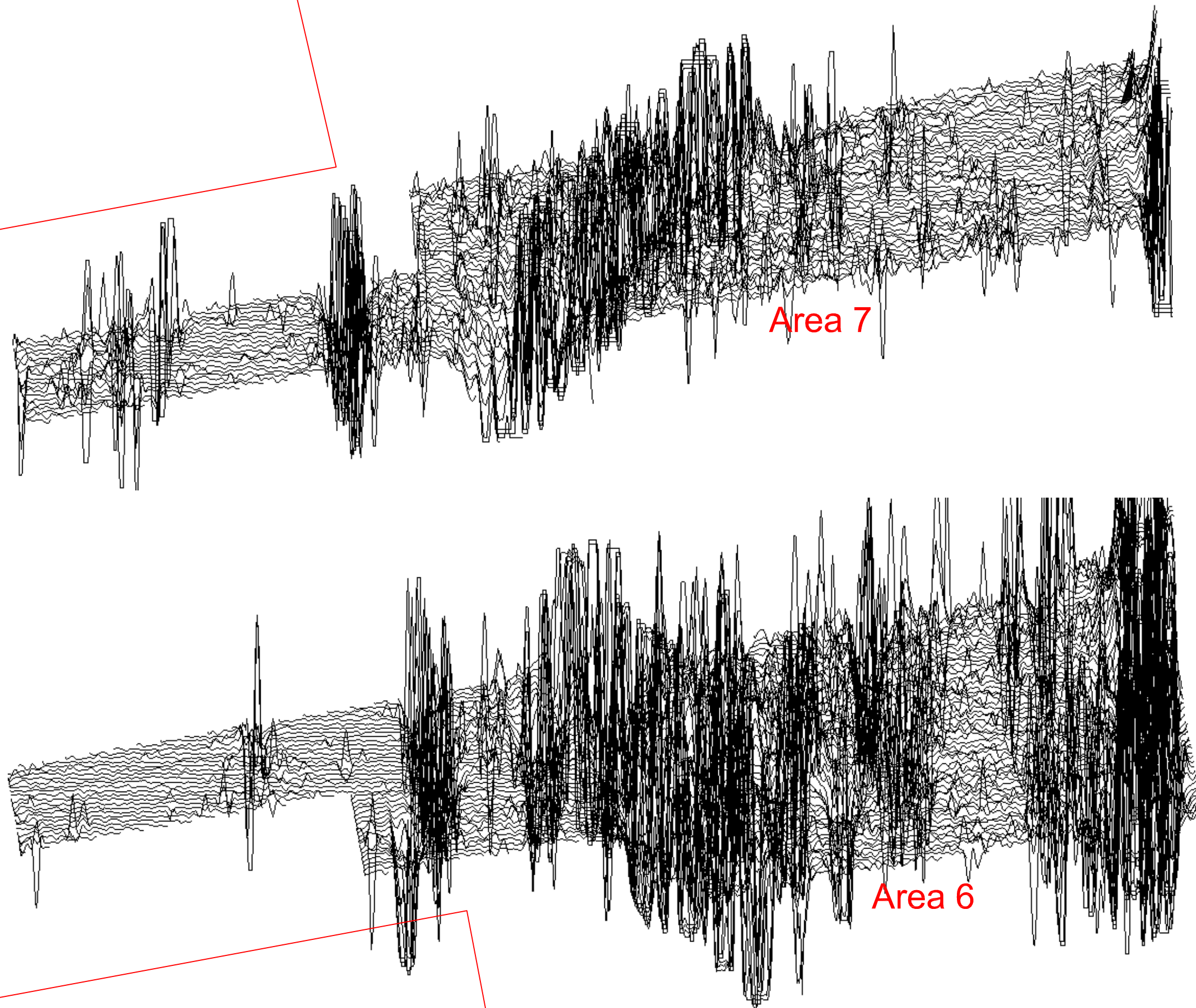

+70nT    Approximately 35nT/  
                  cm vertical  
                  displacement.  
+35nT    Data has been clipped  
                  at  $\pm 100$ nT.  
0nT  
-35nT  
-70nT

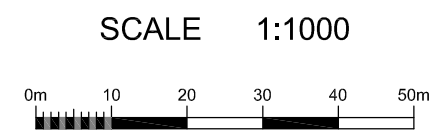

# Archaeological Surveys

Geophysical Survey  
Upper Heyford Park

Greyscale plot of processed  
magnetometer data -  
Areas 6 and 7

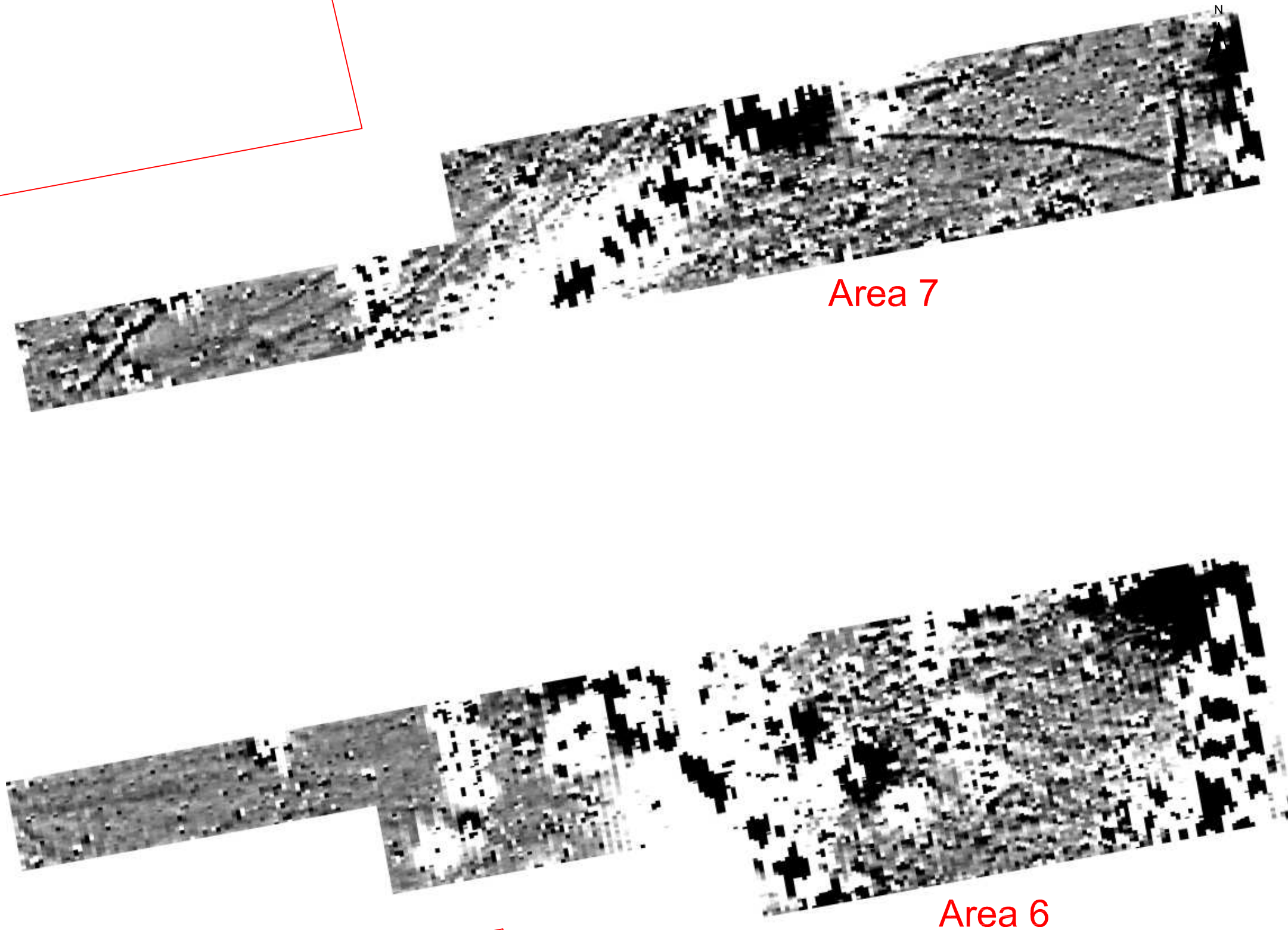

Area 7

Area 6

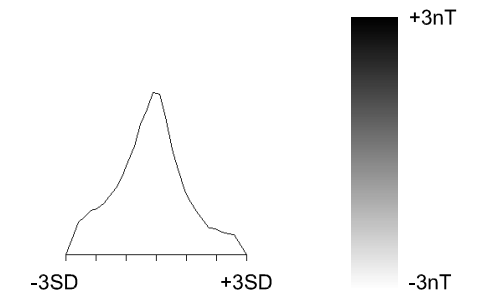

Area 6

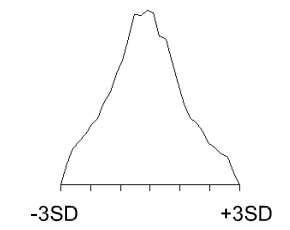

Area 7

SCALE 1:1000





# Archaeological Surveys

## Geophysical Survey Upper Heyford Park

### Abstraction and interpretation of magnetometer anomalies - Areas 6 and 7

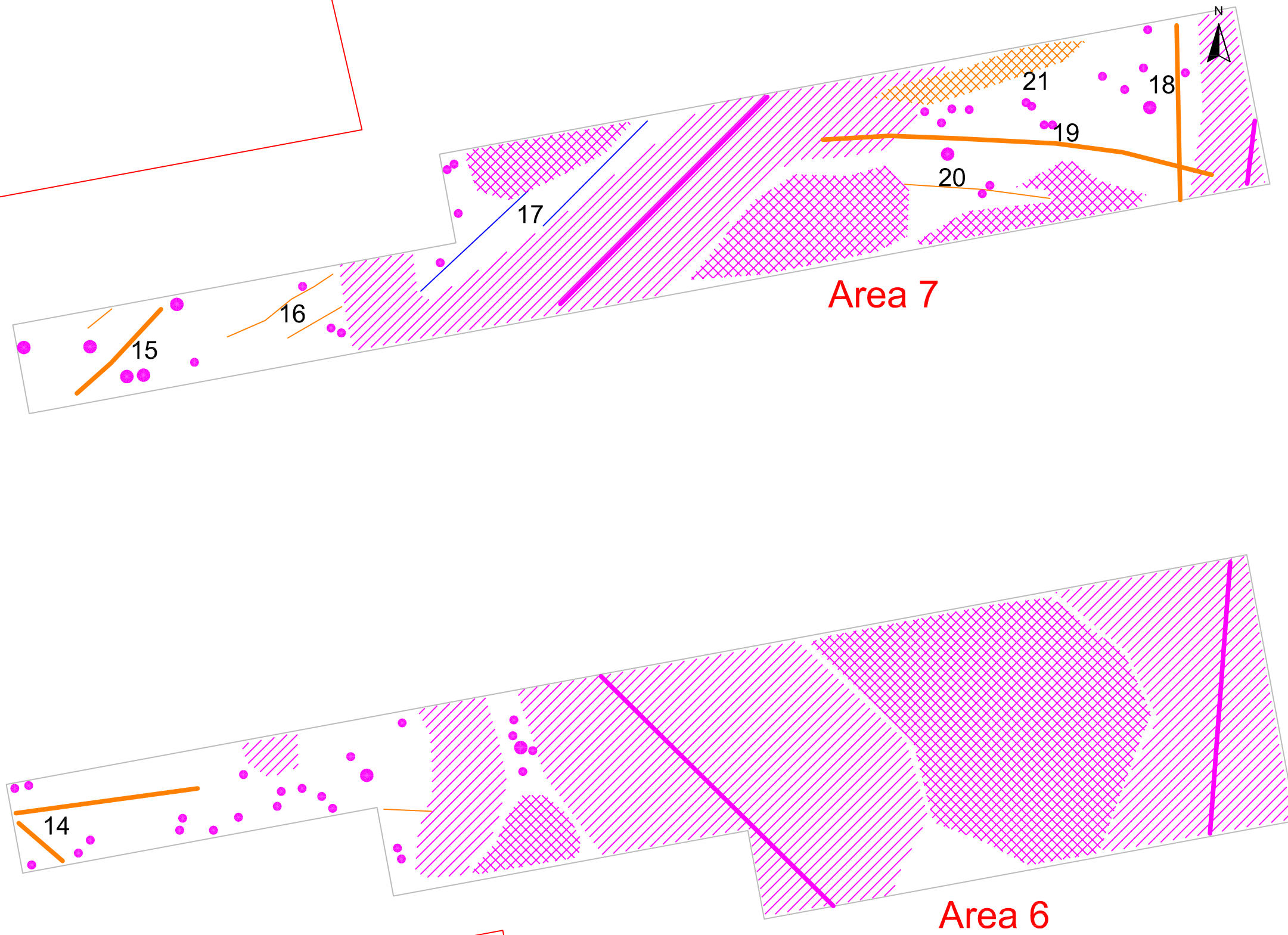

- Positive linear anomaly - of uncertain origin
- Negative linear anomaly - of uncertain origin
- Positive area - uncertain origin
- Magnetic debris - spread of magnetically thermoremnant/ ferrous material
- Magnetic disturbance from ferrous material
- Strong dipolar linear anomaly - pipeline / cable / service
- Strong dipolar anomaly - ferrous object

SCALE 1:1000



# Archaeological Surveys

## Geophysical Survey Upper Heyford Park

### Greyscale plot of raw magnetometer data - Areas 8 and 9

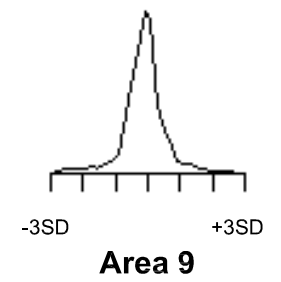
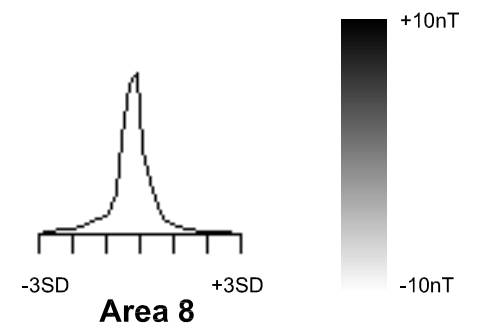
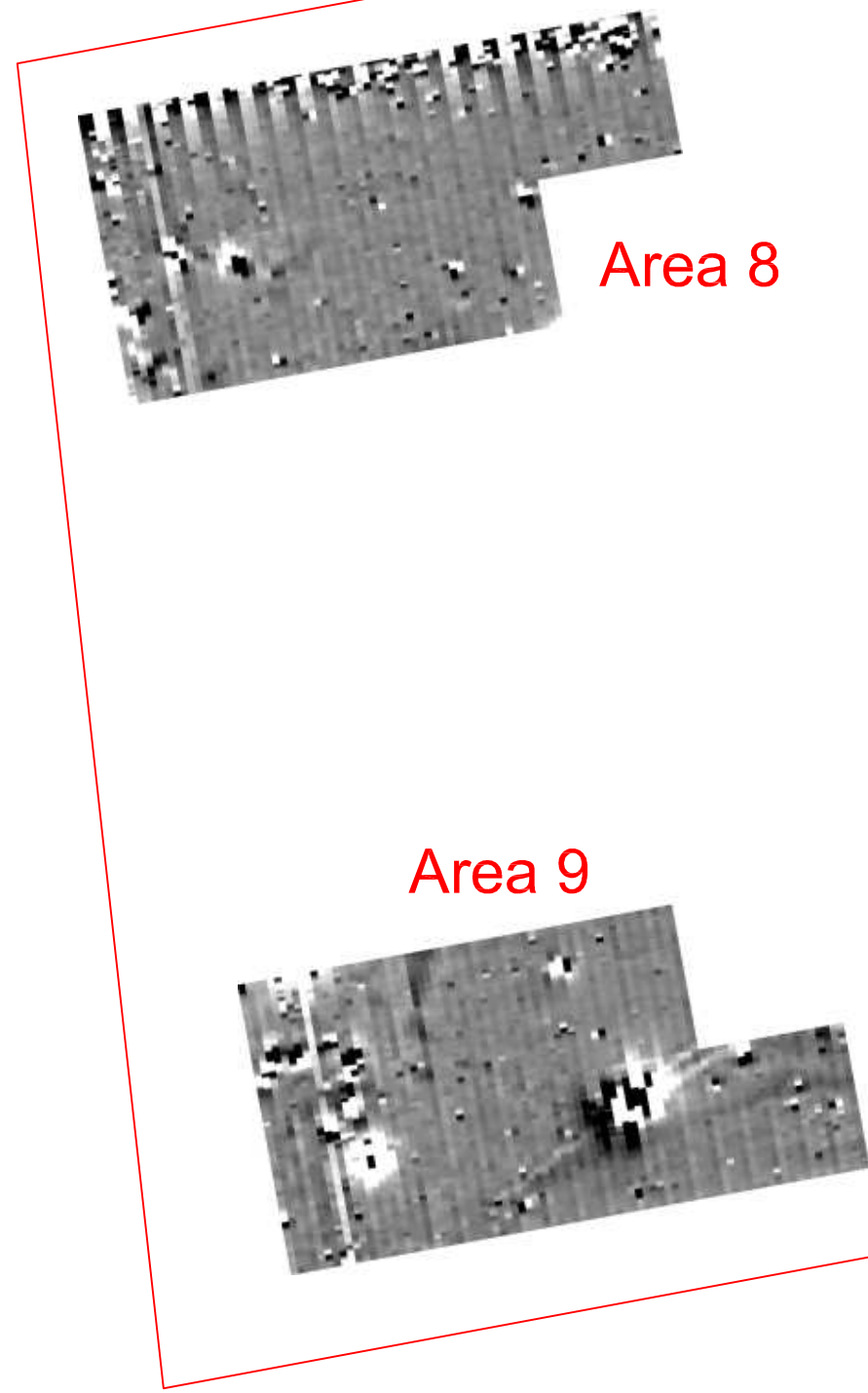

SCALE 1:1000

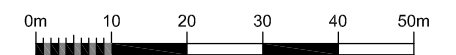

FIG 18

# Archaeological Surveys

## Geophysical Survey Upper Heyford Park

### Traceplot of raw magnetometer data - Areas 8 and 9

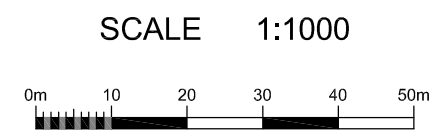
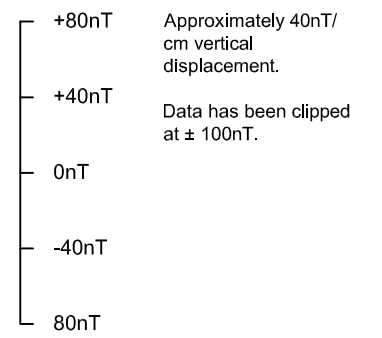
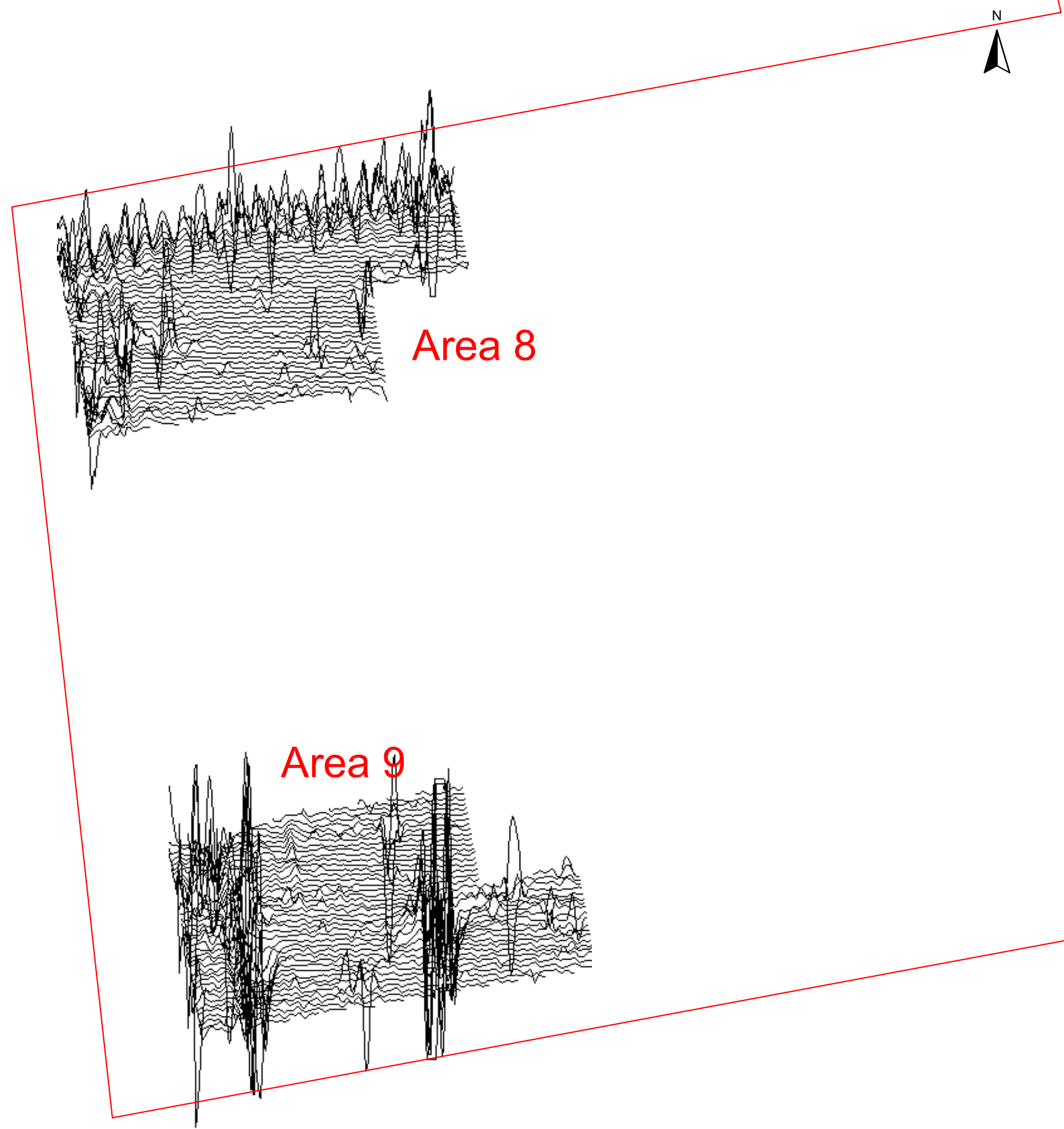
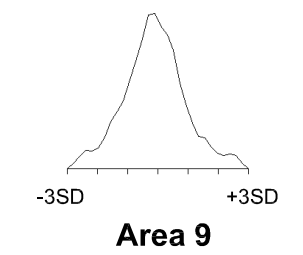
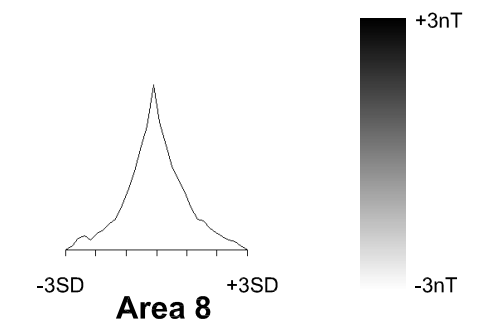
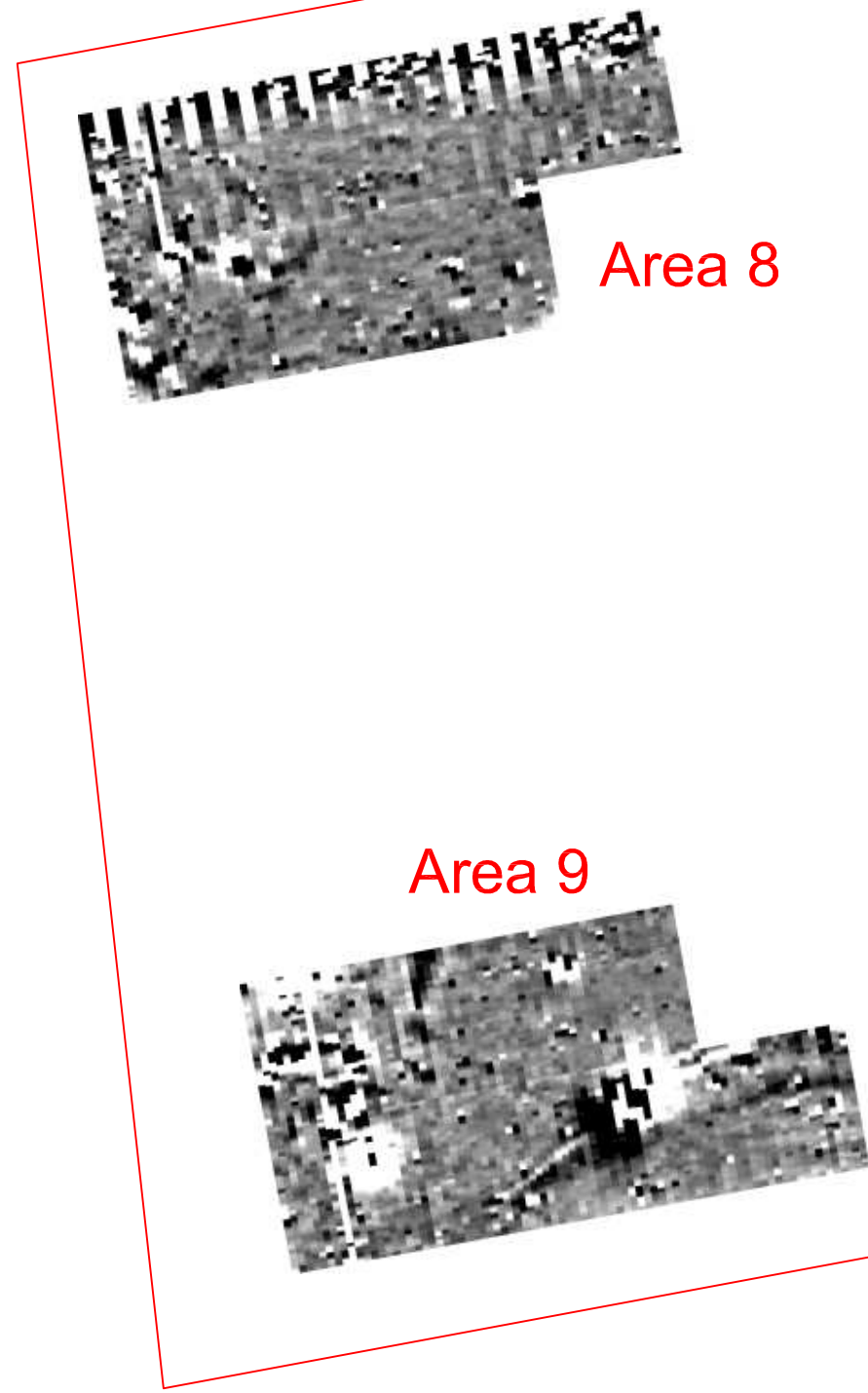

FIG 19

# Archaeological Surveys

## Geophysical Survey Upper Heyford Park

### Greyscale plot of processed magnetometer data - Areas 8 and 9



SCALE 1:1000

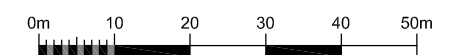

# Archaeological Surveys

## Geophysical Survey Upper Heyford Park

### Abstraction and interpretation of magnetometer anomalies - Areas 8 and 9

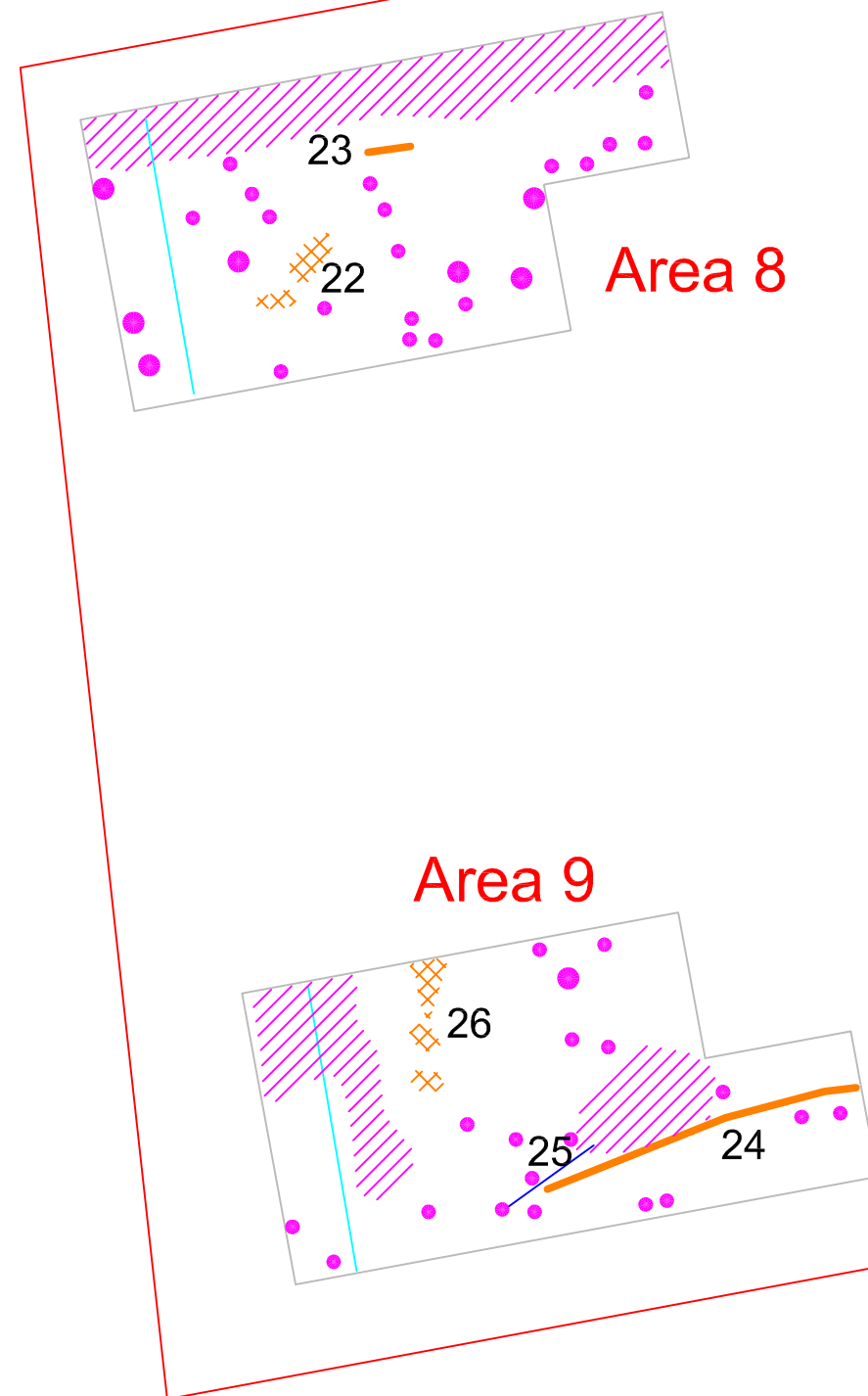

- Positive linear anomaly - of uncertain origin
- Linear anomaly - drain
- Negative linear anomaly - of uncertain origin
- Positive area - uncertain origin
- Magnetic debris - spread of magnetically thermoremanent/ ferrous material
- Magnetic disturbance from ferrous material
- Strong dipolar linear anomaly - pipeline / cable / service
- Strong dipolar anomaly - ferrous object

SCALE 1:1000



# Archaeological Surveys

## Geophysical Survey Upper Heyford Park

### Greyscale plot of raw magnetometer data - Areas 10 and 11

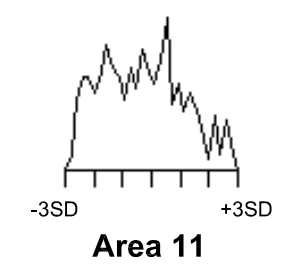
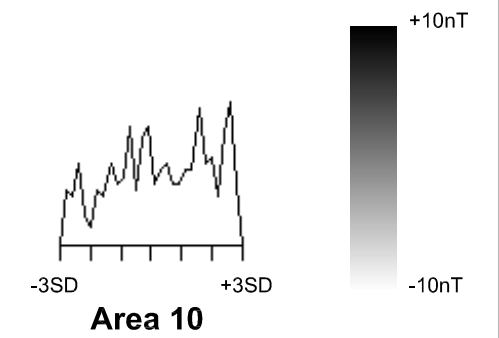

SCALE 1:1000

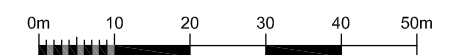

Area 10



Area 11



# Archaeological Surveys

## Geophysical Survey Upper Heyford Park

### Traceplot of raw magnetometer data - Areas 10 and 11

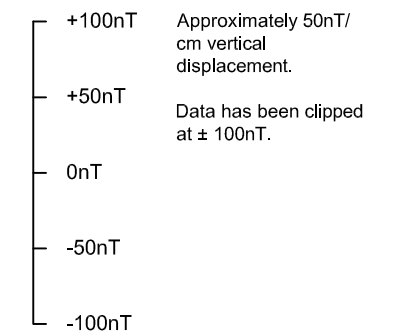

Area 10



Area 11



SCALE 1:1000



# Archaeological Surveys

## Geophysical Survey Upper Heyford Park

### Greyscale plot of processed magnetometer data - Areas 10 and 11

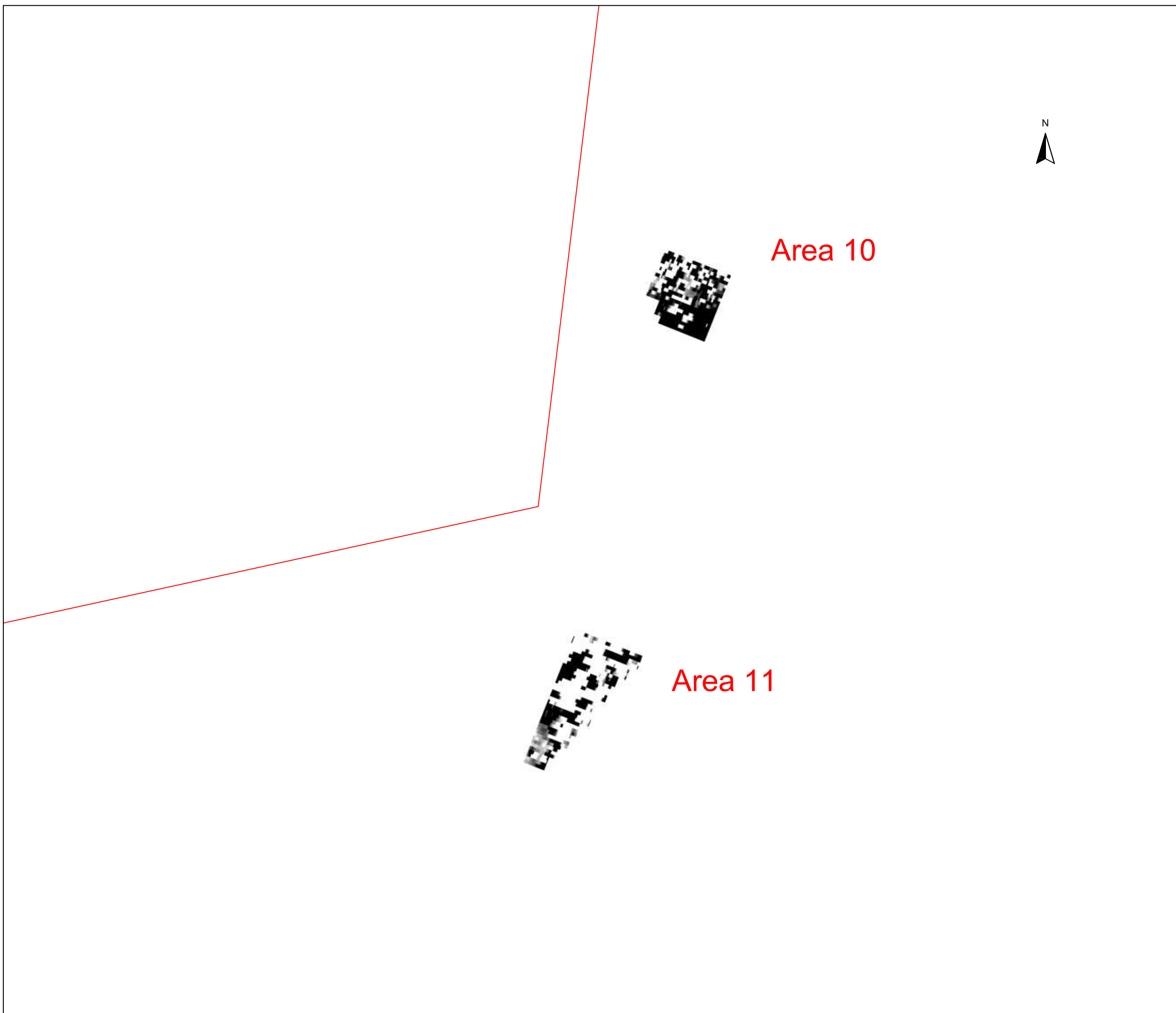
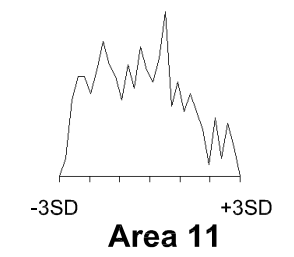
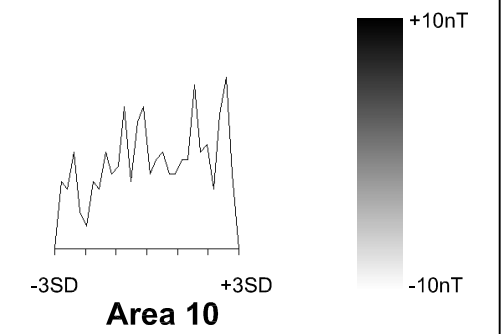

SCALE 1:1000





# Archaeological Surveys

**Geophysical Survey  
Upper Heyford Park**

**Abstraction and interpretation of  
magnetometer anomalies -  
Areas 10 and 11**

 Magnetic disturbance from ferrous material



**Area 10**

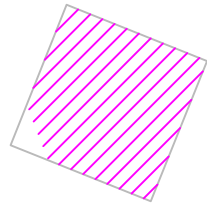

**Area 11**

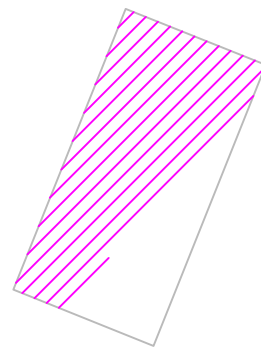

SCALE 1:1000

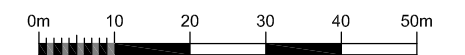

# Archaeological Surveys

## Geophysical Survey Upper Heyford Park

### Greyscale plot of raw magnetometer data - Areas 12 and 13



Area 12

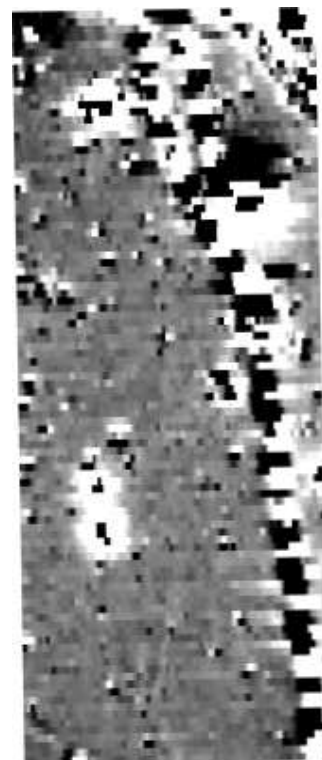

Area 13

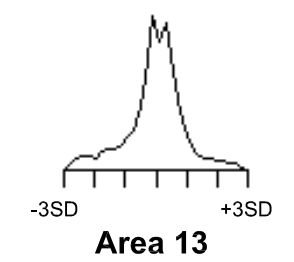
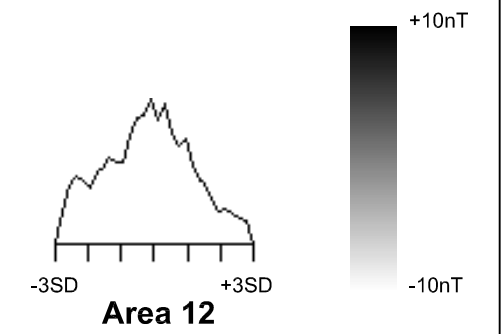

SCALE 1:1000



# Archaeological Surveys

## Geophysical Survey Upper Heyford Park

### Traceplot of raw magnetometer data - Areas 12 and 13

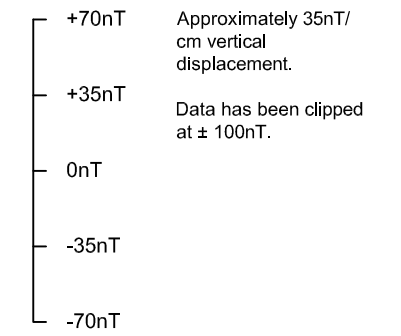

SCALE 1:1000

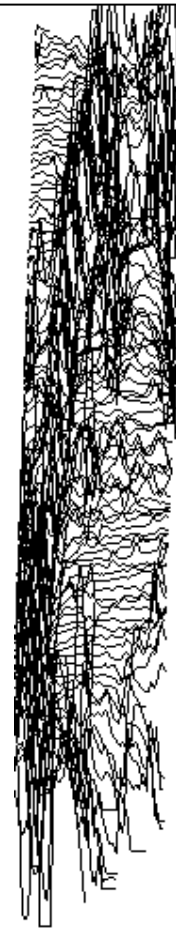

Area 12

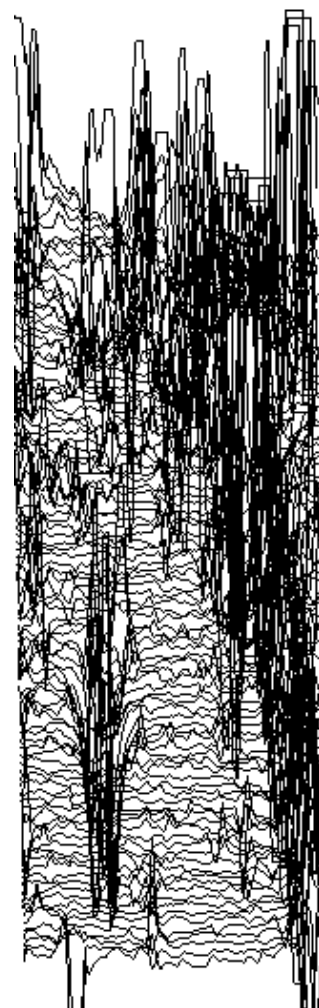

Area 13

# Archaeological Surveys

Geophysical Survey  
Upper Heyford Park

Greyscale plot of processed  
magnetometer data -  
Areas 12 and 13

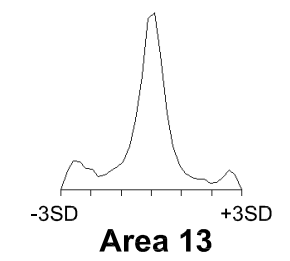
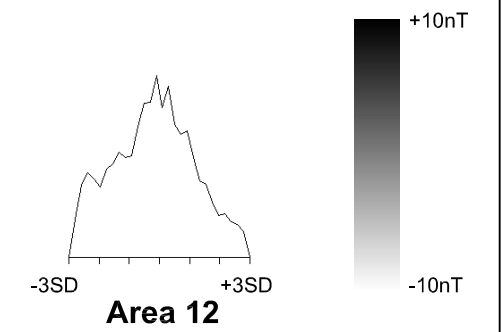

SCALE 1:1000



Area 12

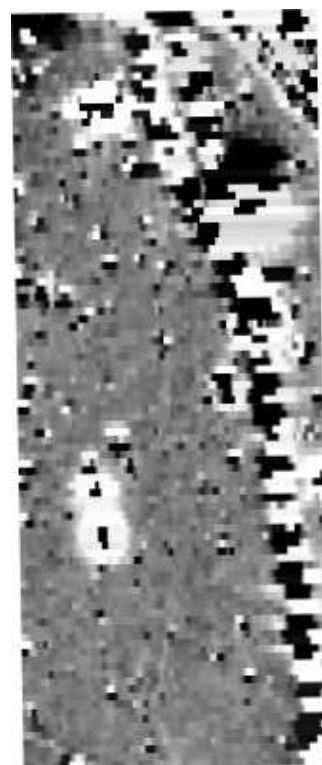

Area 13

# Archaeological Surveys

## Geophysical Survey Upper Heyford Park

### Abstraction and interpretation of magnetometer anomalies - Areas 12 and 13

- Positive linear anomaly - of uncertain origin
- ⊗ Magnetic debris - spread of magnetically thermoremanent/ferrous material
- /// Magnetic disturbance from ferrous material
- Strong dipolar linear anomaly - pipeline / cable / service
- Strong dipolar anomaly - ferrous object in topsoil

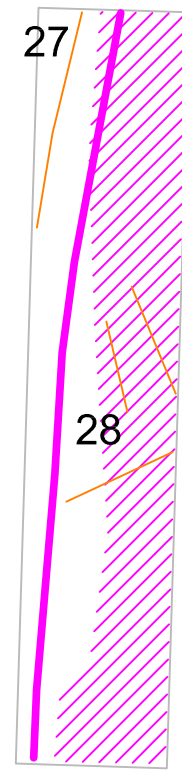

Area 12

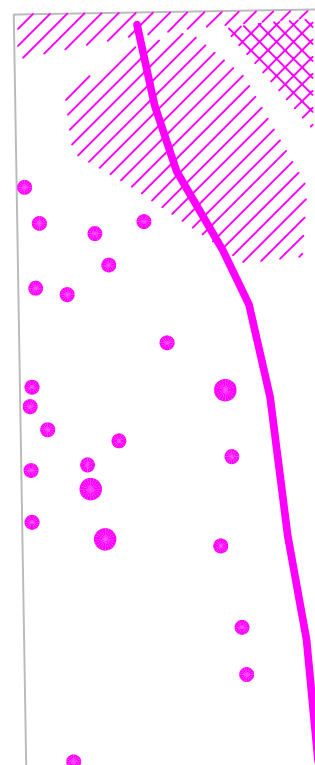

Area 13

SCALE 1:1000



# Archaeological Surveys

Geophysical Survey  
Upper Heyford Park

Greyscale plot of raw  
magnetometer data - Area 14

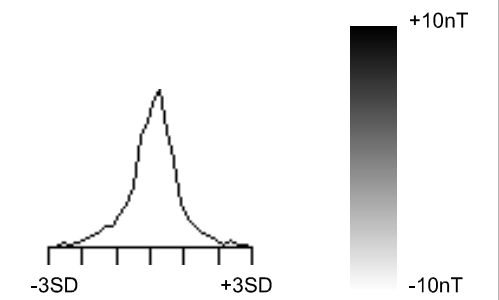

Area 13



Area 6



Area 14

SCALE 1:1000

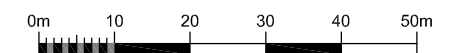

# Archaeological Surveys

## Geophysical Survey Upper Heyford Park

### Traceplot of raw magnetometer data - Area 14

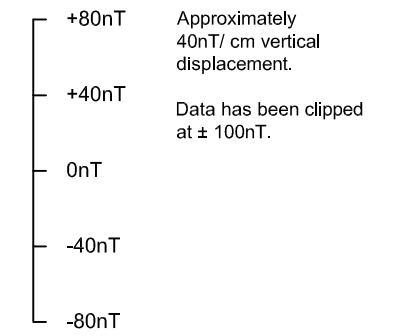

SCALE 1:1000



FIG 31

Area 13



Area 6



Area 14

**Archaeological Surveys**

**Geophysical Survey  
Upper Heyford Park**

**Greyscale plot of processed  
magnetometer data -  
Area 14**

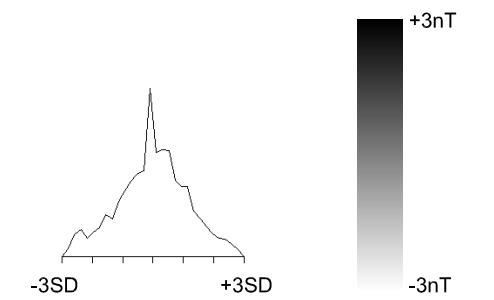

**Area 13**



**Area 6**



**Area 14**

**SCALE 1:1000**







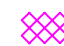

# Archaeological Surveys

## Geophysical Survey Upper Heyford Park

### Abstraction and interpretation of magnetometer anomalies - Area 14

-  Negative linear anomaly - of uncertain origin
-  Magnetic debris - spread of magnetically thermoremnant/ ferrous material
-  Magnetic disturbance from ferrous material
-  Strong dipolar linear anomaly - pipeline / cable / service
-  Strong dipolar anomaly - ferrous object



Area 13

Area 6

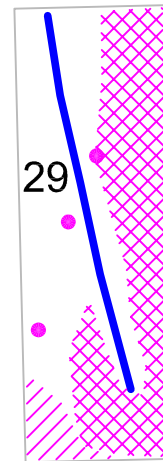

Area 14

SCALE 1:1000

