

EXISTING VEGETATION OUTSIDE OF THE RED LINE BOUNDARY TO BE RETAINED.

EXISTING DITCH NOTED ON THE NORTHERN BOUNDARY. ENHANCEMENT PROPOSED.

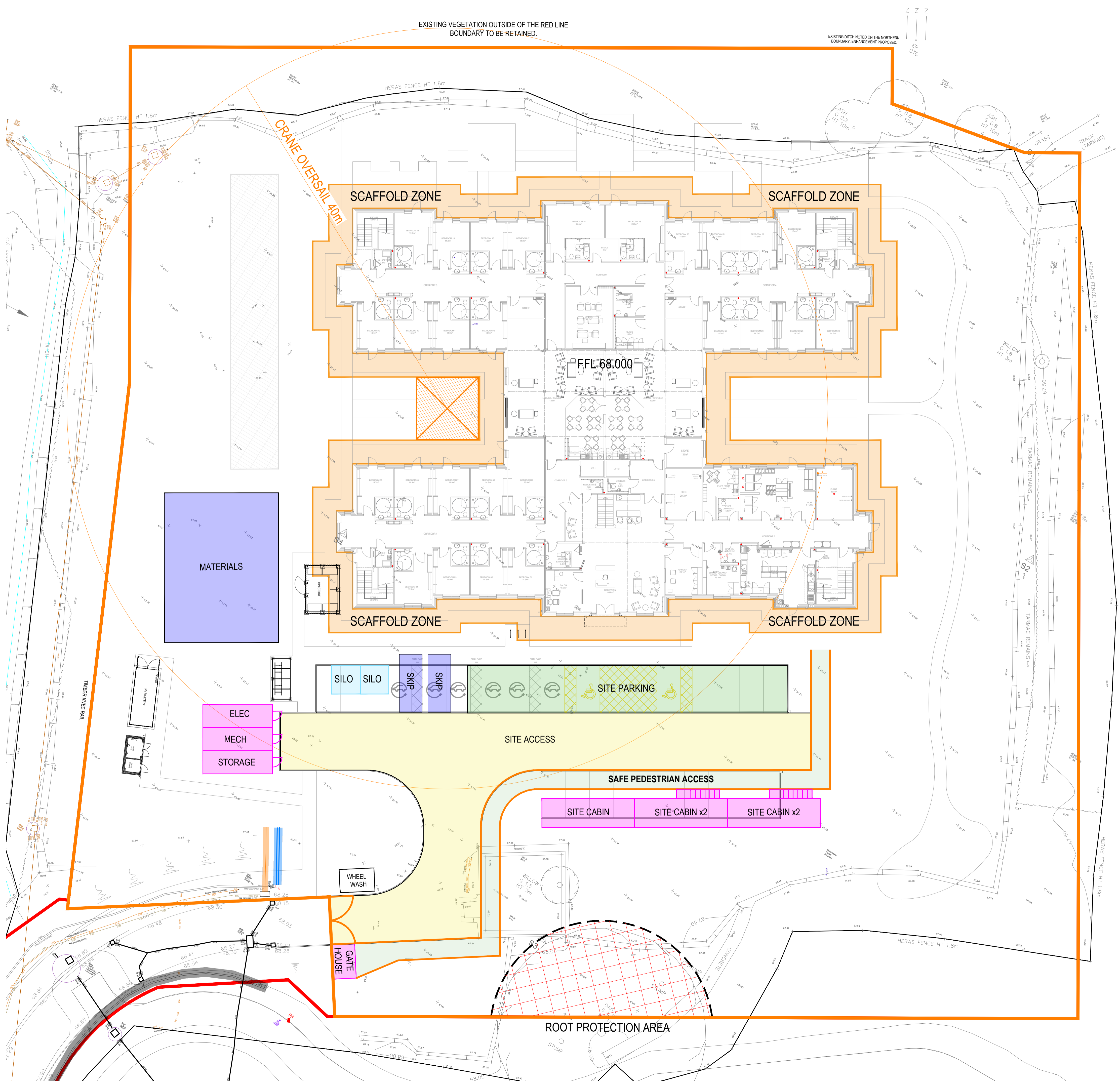

REV	DATE	DETAILS OF AMENDMENTS	DRAWN

LNT Construction
 Unit 2, Helios 47, Isabella Road, Garforth, Leeds, LS25 2DY
 Tel: 0113 385 3850

SITE: GRAVEN HILL
 BICESTER

TITLE: SITE SETUP

SCALE: 1:200 @ A1 DRAWN: DB DATE: 30.04.25

DRAWING NO: 416 B-10 REVISION: -

DRAWING STATUS: CONSTRUCTION