

Refer to drawing: 11386214-WAT-XX-XX-DR-N-741001

Refer to drawing: 11386214-WAT-XX-XX-DR-N-741002

Refer to drawing: 11386214-WAT-XX-XX-DR-N-741007

Refer to drawing: 11386214-WAT-XX-XX-DR-N-741010

SUDs Planting Mix:
51 No. CAR PEN
51 No. JUN EFF
101 No. PHR AUS

Native Hedge Mix:
126 No. COR AVE
126 No. CRA MON
251 No. FAG SYL

Native Hedge Mix:
2 No. COR AVE
2 No. CRA MON
3 No. FAG SYL

Native Hedge Mix:
5 No. COR AVE
5 No. CRA MON
10 No. FAG SYL

Native Hedge Mix:
7 No. COR AVE
7 No. CRA MON
14 No. FAG SYL

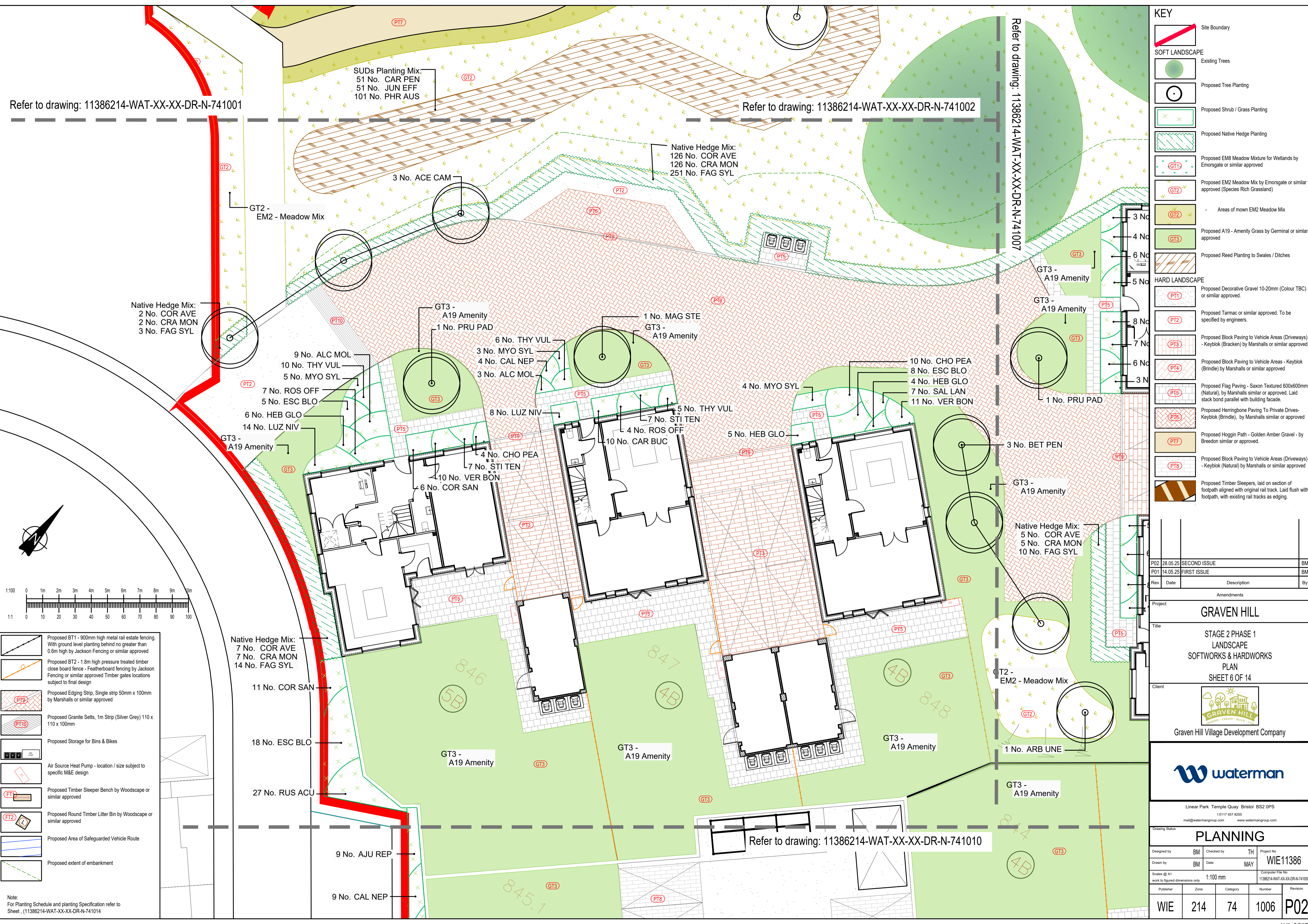

KEY

	Site Boundary
	Existing Trees
	Proposed Tree Planting
	Proposed Shrub / Grass Planting
	Proposed Native Hedge Planting
	Proposed EM8 Meadow Mixture for Wetlands by Emorsgate or similar approved
	Proposed EM2 Meadow Mix by Emorsgate or similar approved (Species Rich Grassland)
	Areas of mown EM2 Meadow Mix
	Proposed A19 - Amenity Grass by Germinal or similar approved
	Proposed Reed Planting to Swales / Ditches
	HARD LANDSCAPE
	Proposed Decorative Gravel 10-20mm (Colour TBC) or similar approved.
	Proposed Tarmac or similar approved. To be specified by engineers.
	Proposed Block Paving to Vehicle Areas (Driveways) - Keyblok (Bracken) by Marshalls or similar approved
	Proposed Block Paving to Vehicle Areas - Keyblok (Brindle) by Marshalls or similar approved
	Proposed Flag Paving - Saxon Textured 600x600mm (Natural), by Marshalls similar or approved. Laid stack bond parallel with building facade.
	Proposed Herringbone Paving to Private Drives - Keyblok (Brindle), by Marshalls similar or approved
	Proposed Hoggin Path - Golden Amber Gravel - by Breeden similar or approved.
	Proposed Block Paving to Vehicle Areas (Driveways) - Keyblok (Natural) by Marshalls or similar approved
	Proposed Timber Sleepers, laid on section of footpath aligned with original rail track. Laid flush with footpath, with existing rail tracks as edging.

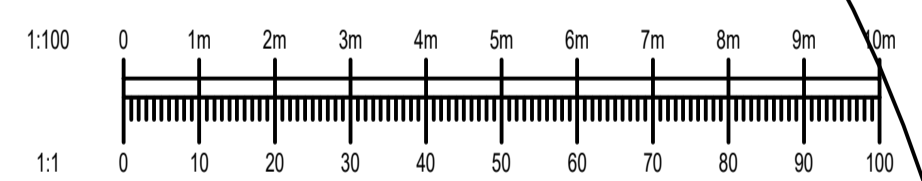

- Proposed BT1 - 900mm high metal rail estate fencing. With ground level planting behind no greater than 0.6m high by Jackson Fencing or similar approved
- Proposed BT2 - 1.8m high pressure treated timber close board fence - Featherboard fencing by Jackson Fencing or similar approved Timber gates locations subject to final design
- Proposed Edging Strip, Single strip 50mm x 100mm by Marshalls or similar approved
- Proposed Granite Setts, 1m Strip (Silver Grey) 110 x 110 x 100mm
- Proposed Storage for Bins & Bikes
- Air Source Heat Pump - location / size subject to specific M&E design
- Proposed Timber Sleeper Bench by Woodscape or similar approved
- Proposed Round Timber Litter Bin by Woodscape or similar approved
- Proposed Area of Safeguarded Vehicle Route
- Proposed extent of embankment

Note:
For Planting Schedule and planting Specification refer to Sheet, (11386214-WAT-XX-XX-DR-N-741014

Rev	Date	Description	By
P02	28.05.25	SECOND ISSUE	BM
P01	14.05.25	FIRST ISSUE	BM

GRAVEN HILL

STAGE 2 PHASE 1
LANDSCAPE
SOFTWARES & HARDWORKS
PLAN
SHEET 6 OF 14

Client

Graven Hill Village Development Company

Linear Park Temple Quay Bristol BS2 0PS
1 0117 937 8200
mail@watermangroup.com www.watermangroup.com

PLANNING

Designed by	BM	Checked by	TH	Project No	WIE11386
Drawn by	BM	Date	MAY	Computer File No	11386214-WAT-XX-XX-DR-N-741000
Scales @ A1 work to figured dimensions only		1:100 mm	Computer File No 11386214-WAT-XX-XX-DR-N-741000		
Publisher	Zone	Category	Number	Revision	
WIE	214	74	1006	P02	

File Path: \\waterman-consulting-servers\server\WIE\Projects\11386_214_WAT-XX-XX-DR-N-741001-27_CAD\14_Landscape