

Rachel Tibbetts

From: Joyce Christie
Sent: 06 May 2025 16:34
To: Shona King
Cc: DC Support; Nathanael Stock
Subject: RE: 25/00527/DISC North Arms

Hi Shona

Can you please check they are changing the block to brick as described as the site photo shows a block pier.



Best wishes

Joyce Christie
Conservation Officer
Planning Policy and Conservation
Communities Directorate
Cherwell District Council
01295 227006
Direct Dial 01295 221608
joyce.christie@cherwell-dc.gov.uk

www.cherwell.gov.uk

39 Castle Quay, Banbury, OX16 5FD

[Facebook](#) | [LinkedIn](#) | [Instagram](#) | Subscribe to [Cherwell Link](#) | [Bluesky](#) | [Nextdoor](#)

You will appreciate that the above views are those of Council Officers and though given in good faith, cannot prejudice any decision which the Council, as the Local Planning Authority, may make.

Planning and Development services can be contacted as follows:

Development Management - planning@cherwell-dc.gov.uk

Building Control - building.control@cherwell-dc.gov.uk

Planning Policy - planning.policy@cherwell-dc.gov.uk

Conservation - design.conservation@cherwell-dc.gov.uk

For the latest information on Planning and Development please visit www.cherwell.gov.uk

From: Joyce Christie

Sent: 06 May 2025 15:30

To: Shona King

Cc: DC Support ; Nathanael Stock

Subject: 25/00527/DISC North Arms

Hi Shona

Discharge of Condition 9 (details of structural opening) of 24/01880/LB

Queries:

P11D shows the whole floor plan. Drawings 12C and 13B were also submitted but these are not relevant to Condition 9 of 24/01880/LB.

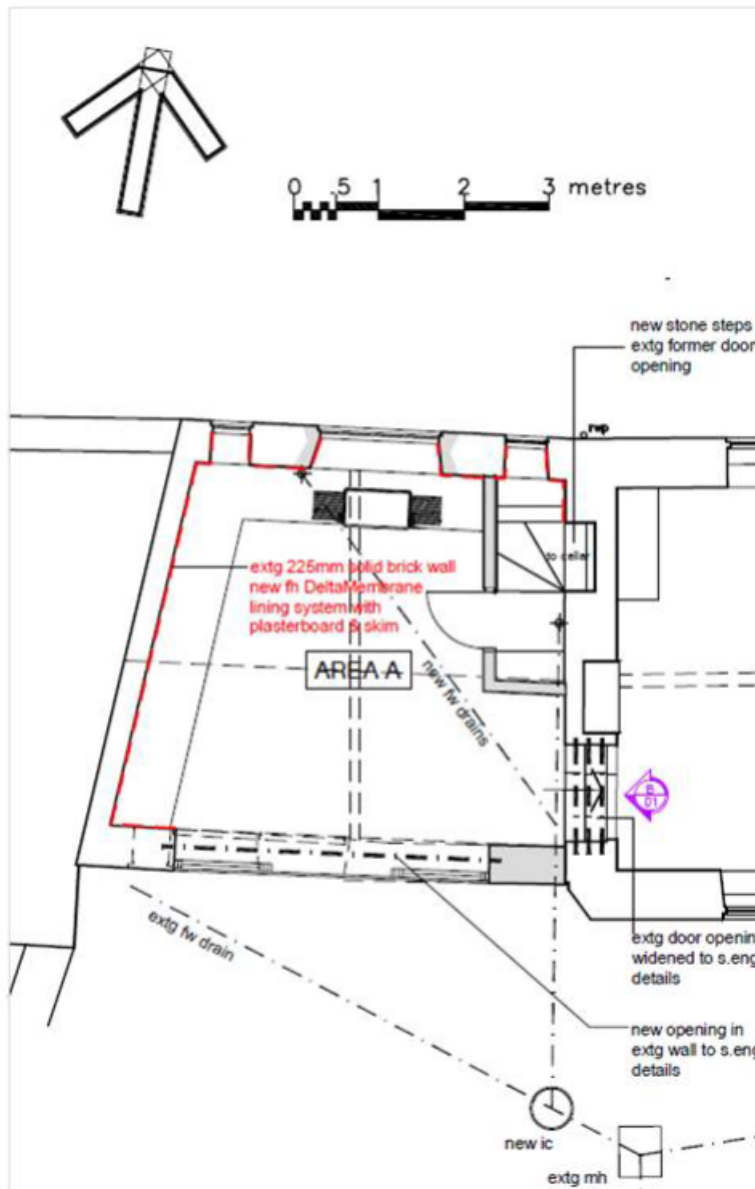

Extract P11D

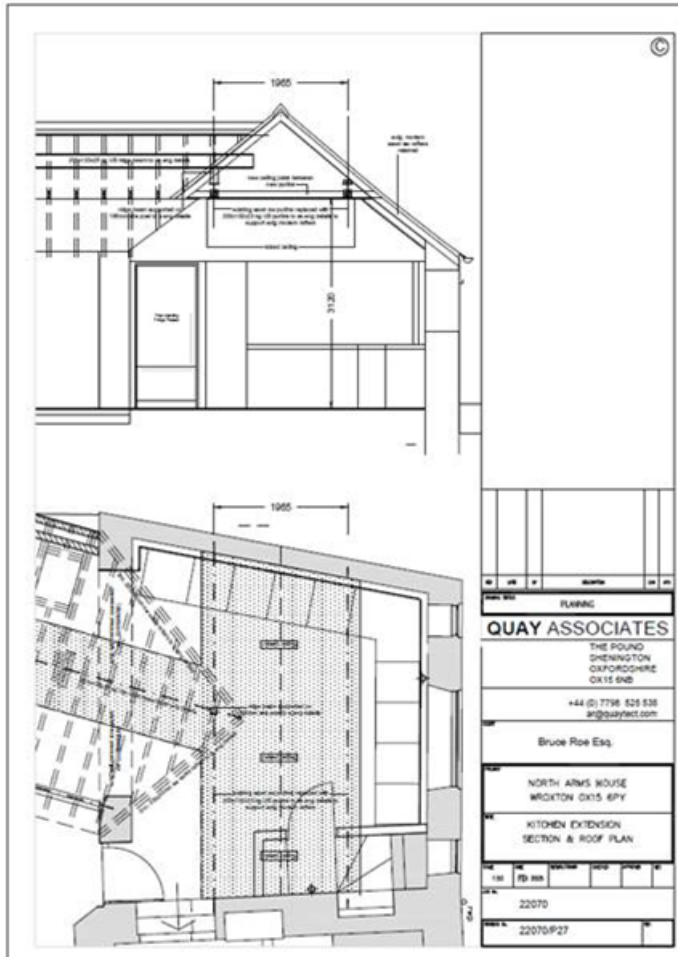

P27

Please ask for a bit more information on Drg P27 to show the existing floor slab junction with the new floor slab and how the ceiling finishes between the existing and proposed relate to one another. Please also confirm how the new steel that is to be inserted to support the ridge of the new roof will be embedded in the masonry. Can they supply further detail on the junction between the extension roof and the stone pier between the large opening and the door. Please note Drg P11D and P27 are different as P11 doesn't show a door and appears to show a wider opening?

Agent's Response:

I can respond as follows:

The existing modern floor slab of concrete on brick hardcore was impacted by the former brick partitions of the pub wc provision and also the introduction of the cellar steps. A new wide boarded oak floor is proposed to be laid over throughout the existing and extension area.

The purlin steels will be inserted in the masonry (brick and stone) on padstones to the structural engineers' details. The junction of the extension roof and existing pier will comprise timber valley rafters resting on the new steel purlins.

Drawing P11D continues to relate to the original approval ref.: **22/03307/F & 22/03308/LB** in order to highlight the variations, as now requested. Drawing P27 relates to the subsequently Consented kitchen extension ref.: **24/01879/F & 24/01880/LB**

Response:

Floor – agreed.

Purlin steels – agreed.

P11D and P27 – noted.

***I don't think I have been consulted on any amendments to 24/01879/F & 24/01880/LB that were shown on another disc.**

Best wishes

Joyce Christie
Conservation Officer
Planning Policy and Conservation
Communities Directorate
Cherwell District Council
01295 227006
Direct Dial 01295 221608
joyce.christie@cherwell-dc.gov.uk

www.cherwell.gov.uk

39 Castle Quay, Banbury, OX16 5FD

[Facebook](#) | [LinkedIn](#) | [Instagram](#) | Subscribe to [Cherwell Link](#) | [Bluesky](#) | [Nextdoor](#)

You will appreciate that the above views are those of Council Officers and though given in good faith, cannot prejudice any decision which the Council, as the Local Planning Authority, may make.

Planning and Development services can be contacted as follows:

Development Management - planning@cherwell-dc.gov.uk

Building Control - building.control@cherwell-dc.gov.uk

Planning Policy - planning.policy@cherwell-dc.gov.uk

Conservation - design.conservation@cherwell-dc.gov.uk

For the latest information on Planning and Development please visit www.cherwell.gov.uk